

RADIAL PROPRIETARY INTERFACE ADAPTERS

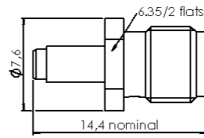

Part number	Interface
R191 366 091	MC-Card Female - SMA Female

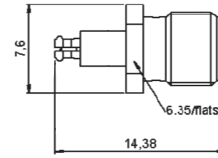

Part number	Interface
R191 366 071	MC-Card Male - SMA Female

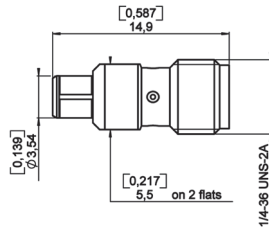

Part number	Interface
R191 857 000	Moebius Male - SMA Female

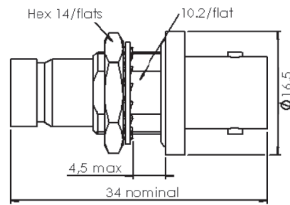

Part number	Interface	Panel drilling
R191 416 000	MQ Female - BNC Female	P06

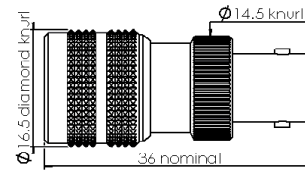

Part number	Interface
R191 413 000	MQ Male - BNC Female

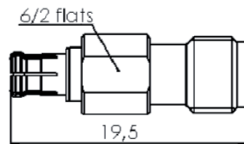

Part number	Interface
R191 976 020	R-MCX Female - SMA Female

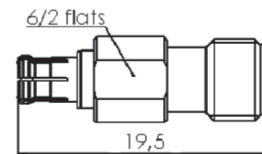

Part number	Interface
R191 977 020	R-MCX Female - SMA Male

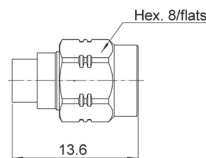

Part number	Interface
R191 984 008	R-MCX Male - SMA Male

RADIALL PROPRIETARY INTERFACE ADAPTERS

ADAPTERS 50Ω

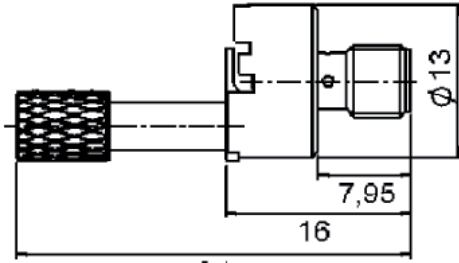

34

Part number	Interface
R107 009 901	UMP H2 - SMA Female

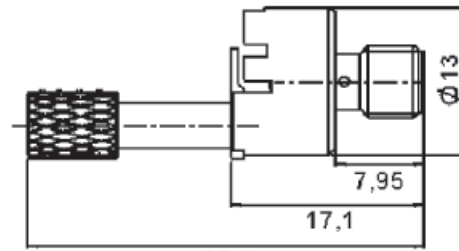

35,1

Part number	Interface
R107 009 902	UMP H2.6 - SMA Female

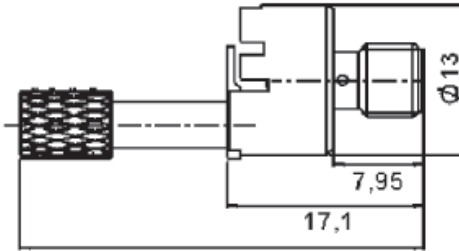

35,1

Part number	Interface
R107 009 903	UMP H3 - SMA Female

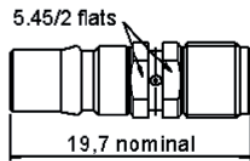

Part number	Interface
R191 913 000	QMA Female - SMA Female

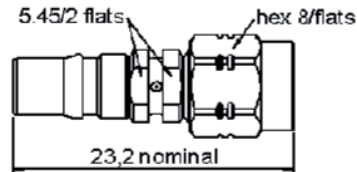

Part number	Interface
R191 912 000	QMA Female - SMA Male

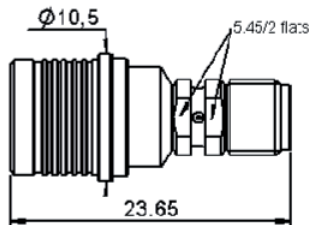

Part number	Interface
R191 911 000	QMA Female - SMA Female

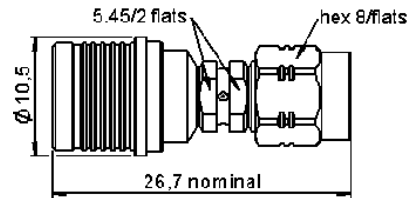

Part number	Interface
R191 910 000	QMA Male - SMA Male

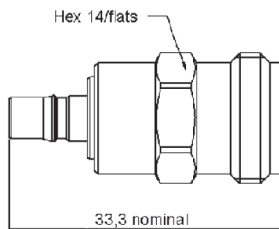

Part number	Interface
R191 764 000	QMA Female - N Female

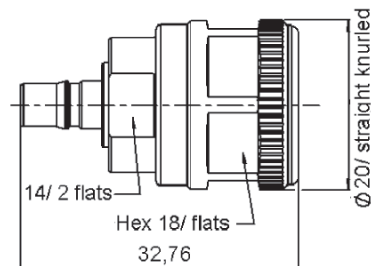

Part number	Interface
R191 762 000	QMA Female - N Male

To download data sheets and assembly instructions, visit www.radiall.com & enter the part number in the Search box. **Bold** part numbers represent products typically in stock & available for immediate shipment. See page 8 and 9 for packaging information.

RADIAL PROPRIETARY INTERFACE ADAPTERS

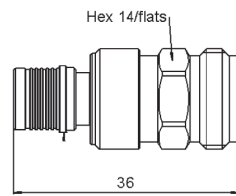

Part number	Interface
R191 763 000	QMA Male - N Female

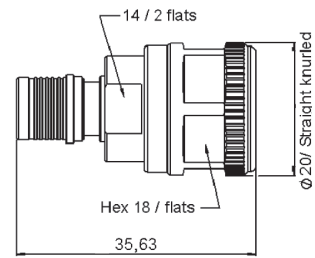

Part number	Interface
R191 765 000	QMA Male - N Male

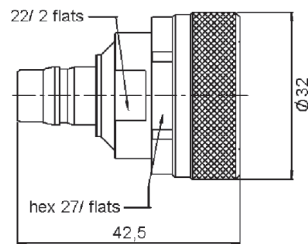

Part number	Interface
R191 923 000	QN Female - 7/16 Male

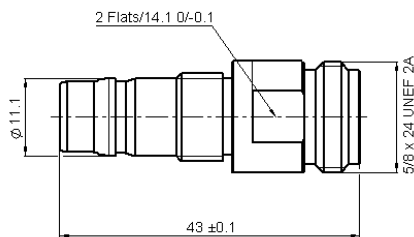

Part number	Interface
R191 760 010	QN Female - N Female

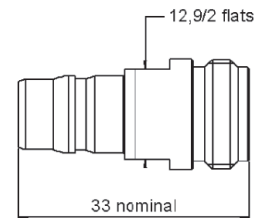

Part number	Interface
R191 760 000	QN Female - N Female

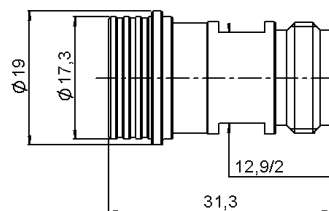

Part number	Interface
R191 759 000	QN Male - N Female

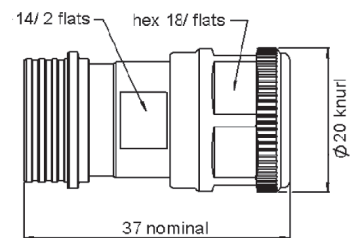

Part number	Interface
R191 757 000	QN Male - N Male

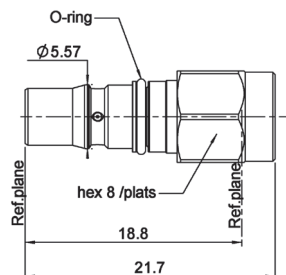

Part number	Interface
R191 927 L01	QRE Female - SMA Male

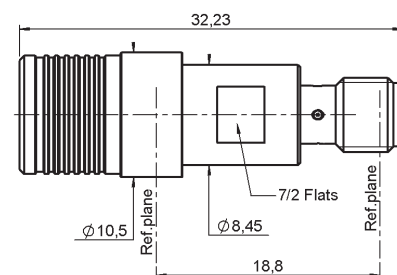

Part number	Interface
R191 926 L01	QRE Male - SMA Female

X-ON Electronics

Largest Supplier of Electrical and Electronic Components

Click to view similar products for [radiall](#) manufacturer:

Other Similar products are found below :

[F760858219](#) [R296701967](#) [8959-1511-004](#) [5919-1503-000](#) [5938-1503-000](#) [7101-1541-010](#) [7105-1561-010](#) [MD11-035](#) [81-6201-0450](#) [9074-9513-000](#) [9620-9003-151](#) [R113425097](#) [R114305000W](#) [R124075210](#) [R125055000](#) [R125512000W](#) [R141154000W](#) [R141572000](#) [R143012000](#) [R143235161W](#) [R166268000](#) [R176019000](#) [R191841001W](#) [R282102000](#) [R282744220](#) [R282918120](#) [R404770000](#) [R414430150](#) [R414520150](#) [R433514700](#) [R570022105](#) [R570123005](#) [R570363010](#) [R570442000](#) [R570E52010](#) [R574402410](#) [R577443000](#) [R585423230](#) [R114425000](#) [R124510000](#) [R125052500](#) [R125320020W](#) [R127.870.001](#) [R141331500W](#) [R162017000W](#) [R176404000](#) [R191970091](#) [R213665000](#) [R282120010](#) [R282750000](#)