

SSMB P.C. Board Receptacles

Straight P.C. Board Receptacles

Standard legs

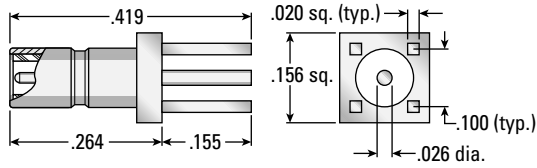

LEG FINISH	AEP P/N
GOLD	7209-1511-000

LEG FINISH	AEP P/N
PRETINNED	7209-1511-012

Standoff legs

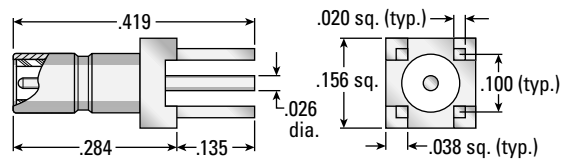

LEG FINISH	AEP P/N
GOLD	7209-1511-011

LEG FINISH	AEP P/N
PRETINNED	7209-1511-040

Straight P.C. Board Receptacles—Surface Mount

Top mount

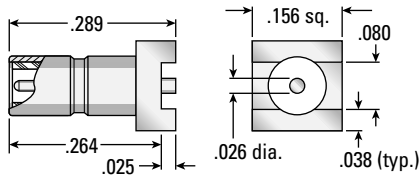

LEG FINISH	AEP P/N
GOLD	7209-1511-015

Edge mount

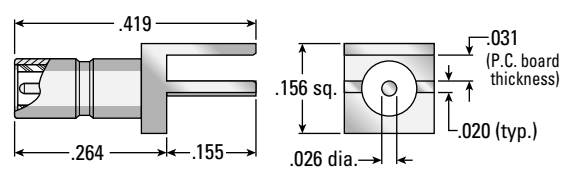

LEG FINISH	AEP P/N
GOLD	7209-1511-023

LEG FINISH	AEP P/N
PRETINNED	7209-1511-061

Right Angle P.C. Board Receptacles

Standard legs

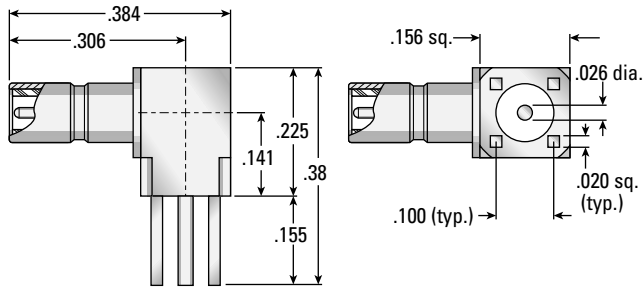

LEG FINISH	AEP P/N
GOLD	7210-1511-000

LEG FINISH	AEP P/N
PRETINNED	7210-1511-012

Standoff legs

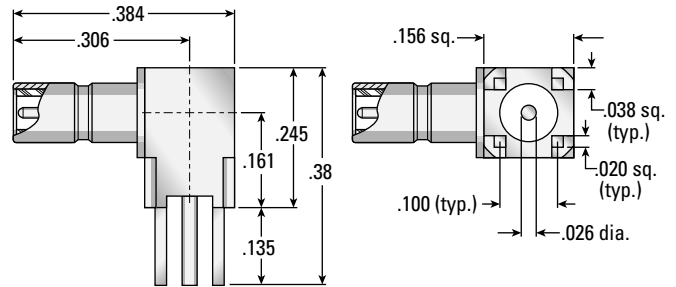

LEG FINISH	AEP P/N
GOLD	7210-1511-050

LEG FINISH	AEP P/N
PRETINNED	7210-1511-040

Right Angle P.C. Board Receptacles—Surface Mount

Top mount

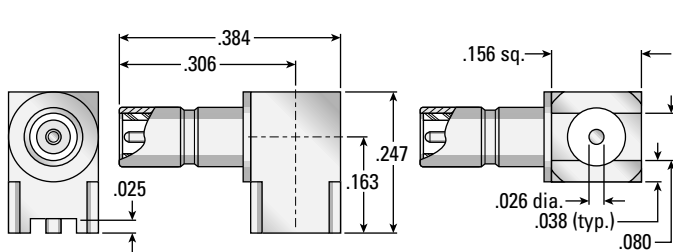

LEG FINISH	AEP P/N
GOLD	7210-1511-015

Edge mount

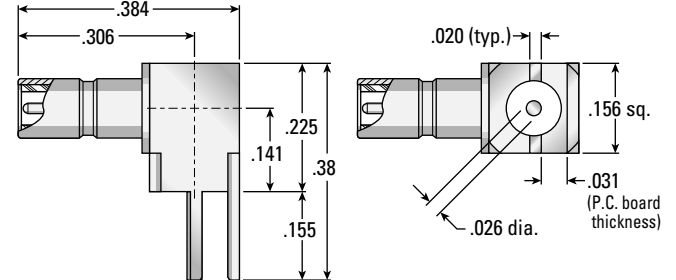

LEG FINISH	AEP P/N
GOLD	7210-1511-060

LEG FINISH	AEP P/N
PRETINNED	7210-1511-061



APPLIED ENGINEERING PRODUCTS

(203) 776-2813 • FAX (203) 776-8294

www.aepconnectors.com • aepsales@aepconnectors.com

X-ON Electronics

Largest Supplier of Electrical and Electronic Components

Click to view similar products for [RF Connectors / Coaxial Connectors](#) category:

Click to view products by [Radiall](#) manufacturer:

Other Similar products are found below :

[R125315120](#) [8915-1511-000](#) [89674-0827](#) [5916-1103-603](#) [0106-001-000](#) [6-0001-3](#) [6001-7071-019](#) [6002-7051-003](#) [6002-7551-202](#) [6059674-1](#) [619550-1](#) [630059-000](#) [M39012/25-0021](#) [M39012/79-3008](#) [M39030/3-01N](#) [M39030/3-03N](#) [M3933/25-29N](#) [M3933/25-36N](#) [6500-7071-046](#) [6501-1071-002](#) [M83723/72W24576](#) [M83723/72W2457N](#) [6769](#) [CX050L2AQ](#) [7002-1541-010](#) [7003-1572-002](#) [7004-1512-000](#) [7009-1511-004](#) [7010-1511-000](#) [7029-1511-060](#) [7101-1541-010](#) [7101-1571-002](#) [7105-1521-002](#) [7145-1521-002](#) [7209-1511-011](#) [7210-1511-012](#) [7210-1511-015](#) [7210-1511-019](#) [7210-1511-040](#) [7225-1512-050](#) [7242-1511-000](#) [73137-5015](#) [73216-2241](#) [73251-0111](#) [73251-0672](#) [73276-1501](#) [73366-0013](#) [73404-2300](#) [73413-6080](#) [734151610](#)