

DATA SHEET

**Classic**  
SURGE PROTECTOR

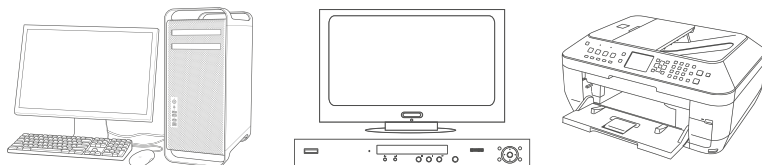

The new **CLASSIC surge protector** provides effective protection to the connected household or office devices against surges in the mains. The protector is dedicated for devices such as **desktop PCs and notebooks, peripherals, audio/video and multimedia devices**.

The protector features five grounded mains sockets with Child Protection system, preventing children from tampering with live elements. The protector's other functions include an LED indicating whether the surge protection is active, an automatic fuse for quick and easy re-activation of the protector and an illuminated, two-pole switch.

FEATURES

- Five grounded mains sockets. All sockets have interlocks that prevent children from accessing live components (Child Protection System).
- Automatic fuse - for restarting the protector in case of short circuit or overload, once the cause of the fault has been removed.
- Signaling of correct operation of the surge protection feature (LED).
- Illuminated, two-pole mains switch secured against accidental triggering.
- Holders for fixing the protector to the wall (fixing template can be downloaded from [www.ever.eu](http://www.ever.eu))
- The power cord can be placed in various directions.
- 10-year warranty.
- Insurance of connected device up 1500 EUR.



POWER CORD LENGTH <b>1,5m</b>	POWER CORD LENGTH <b>3m</b>	POWER CORD LENGTH <b>5m</b>	5 x FRENCH OUTPUT OUTLETS 
ENERGY ABSORPTION UP TO <b>175J</b>	INSURANCE OF CONNECTED DEVICE UP <b>1500 EUR</b>	WARRANTY <b>10 YEAR</b>	OUTLETS WITH CHILD PROTECTION SYSTEM 

# Classic

SURGE PROTECTOR



## TECHNICAL DATA

PARAMETERS \ NAME	CLASSIC		
	Classic 1,5 m	Classic 3,0 m	Classic 5,0 m
Part number	T/LZ09-CLA015/0000	T/LZ09-CLA030/0000	T/LZ09-CLA050/0000
Type	Surge protector		
Rated voltage and frequency	~ 250 V / 50 Hz		
Maximum current (total)	10 A		
Single outlet maximum load	10 A		
Maximum power (total)	2500 W		
Number and type of power outlets	5; in accordance with NF C 61-314; System Child Protection		
Circuit breaker	1 x automatic fuse 10 A		
Type of surge protection	SPD type 3		
Protected lines	L – N		
Energy absorption (total)	175 J		
Test voltage $U_{OC(L-N)}$	6 kV		
Voltage protection level $U_{P(L-N)}$	≤ 1,3 kV		
Continuous operating voltage $U_c$	~ 275 V		
Impulse discharge current $I_{MAX(L-N)}$	6 kA		
Indicators	1x LED (surge protector indicator)		
Plug	NF C 61-314		
Power switch	2-pole lighted		
Dimensions [W x D x H]	64 x 345 x 50 mm		
Power cord length	1,5 m	3 m	5 m
Net weight	463 g	577 g	727 g
Warranty	10 years		
Insurance	1500 EUR		

Note: The manufacturer reserves the right to modify the above parameters without prior notification.

Product complies with CE.

## APPLICATION:

### DESKTOP AND MOBILE COMPUTERS



### PERIPHERAL DEVICES



### RTV EQUIPMENT



### OTHER EQUIPMENT



## STRUCTURE

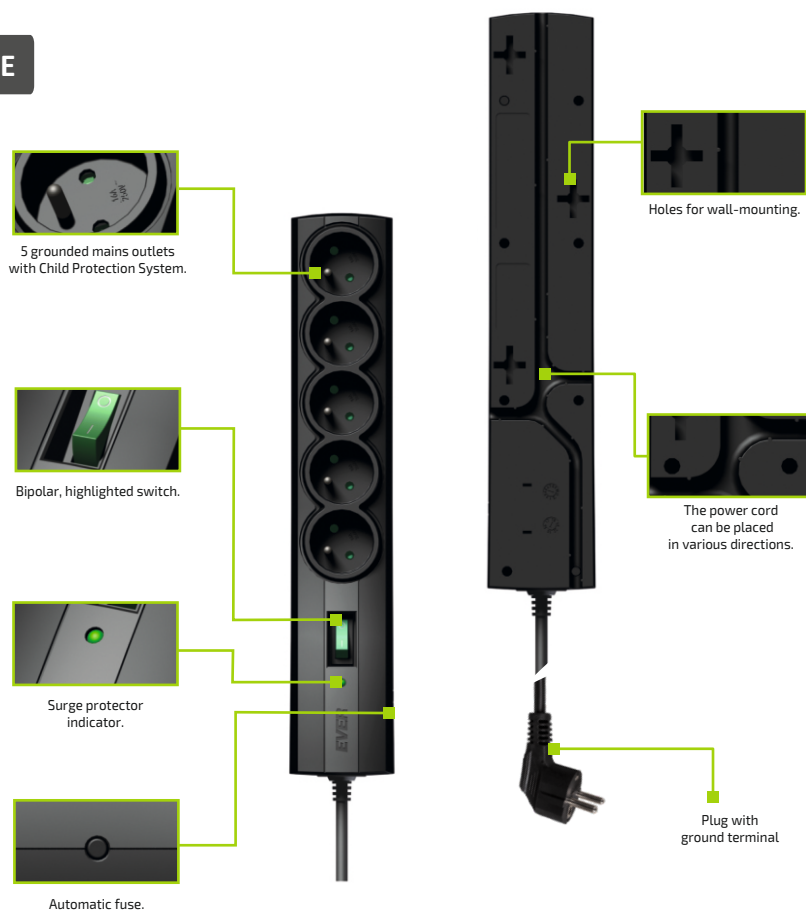

**Be ECO**

If a device connected to a surge protector is in stand-by, switch it off

**EVER**<sup>®</sup>  
POWER SYSTEMS

EVER Sp. z o.o.  
ul. Wołczyńska 19, 60-003 Poznań, Poland  
tel. +48 61 6500 400, fax +48 61 6510 927,  
e-mail: ups@ever.eu

[www.ever.eu](http://www.ever.eu)

## X-ON Electronics

Largest Supplier of Electrical and Electronic Components

*Click to view similar products for [Headers & Wire Housings](#) category:*

*Click to view products by [Ever](#) manufacturer:*

Other Similar products are found below :

[95000-104TRLF](#) [10135584-644402LF](#) [DF62W-EP2022PCA](#) [95000-106TRLF](#) [DF62W-2022SCA](#) [DF62W-EP2022PC](#) [2203348](#) [DF62W-2022SC](#) [1084018](#) [1029039](#) [1084017](#) [802-10-012-10-002000](#) [1112640](#) [1112639](#) [891-007-9SS-BST1T](#) [000-34000](#) [0008550134](#) [0009482033](#) [0009507031](#) [57102-F02-18ULF](#) [57102-S06-03LF](#) [57202-S52-04LF](#) [PCN6-15S-2.5E](#) [0039019024](#) [58102-G61-06LF](#) [582553-1](#) [0009485154](#) [0009508121](#) [0022285053](#) [0050291907](#) [018731A](#) [LY20-4P-DT1-P1E-BR](#) [02.125.8002.8](#) [60101931](#) [60598-1 \(Cut Strip\)](#) [M1625-3R/100](#) [61062-3](#) [61082-181009](#) [636-1427](#) [638009-1](#) [641938-9](#) [641991-4](#) [644168-1](#) [644827-2](#) [647662-1](#) [65039-019ELF](#) [65692-001LF](#) [65781-018](#) [65781-047](#) [65817-002LF](#)