

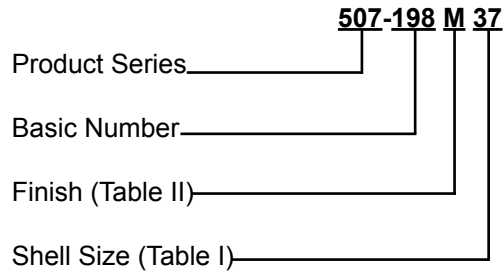

507-198 Micro-D Backshell Assembly with Strain-Relief for Un-Jacketed Wire Bundles

For Use with
Un-Jacketed
Wire Bundles



Shell Size
09 thru 31

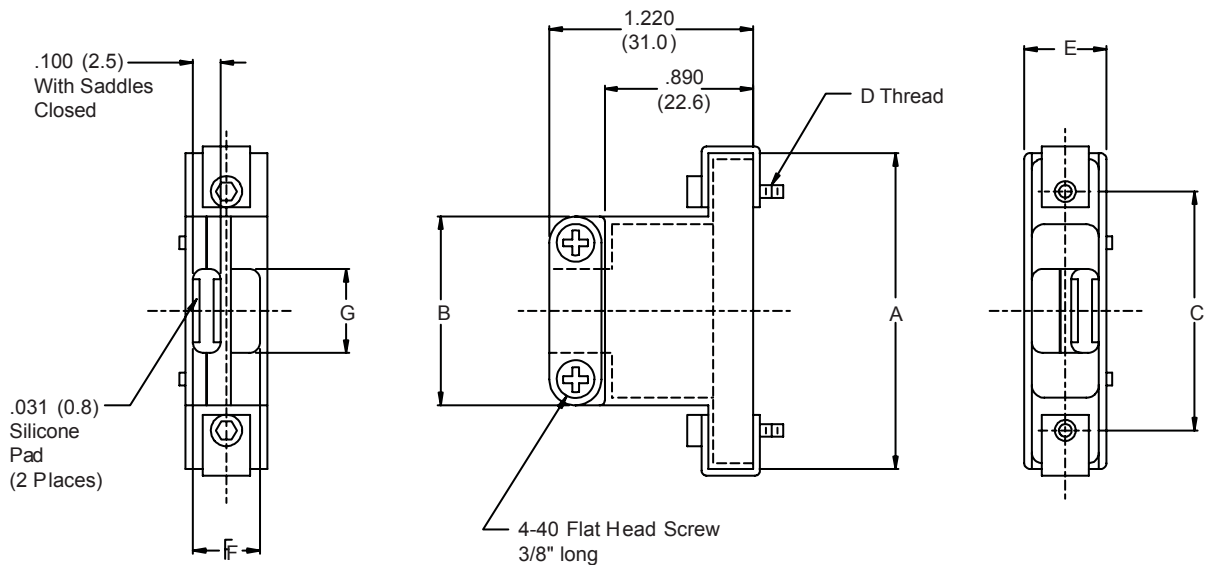
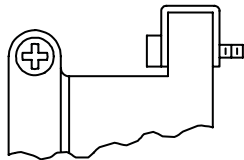

Metric dimensions (mm) are indicated in parentheses

TABLE I: SHELL SIZE & CONNECTOR INTERFACE DIMENSIONS

Shell Size	A Dim	B Dim	C Dim	D Thread	E Dia	F Dim	G Dim
09	.770 (19.6)	.810 (20.6)	.565 (14.4)	2-56 UNC-2A	.400 (10.2)	.310 (7.9)	.310 (7.9)
15	.920 (23.4)	.880 (22.4)	.715 (18.2)	2-56 UNC-2A	.400 (10.2)	.310 (7.9)	.380 (9.7)
21	1.070 (27.2)	.940 (23.9)	.865 (22.0)	2-56 UNC-2A	.400 (10.2)	.310 (7.9)	.440 (11.2)
25	1.170 (29.7)	1.000 (25.4)	.965 (24.5)	2-56 UNC-2A	.400 (10.2)	.310 (7.9)	.500 (12.7)
31	1.320 (33.5)	1.050 (26.7)	1.115 (28.3)	2-56 UNC-2A	.400 (10.2)	.310 (7.9)	.550 (14.0)
37	1.470 (37.3)	1.100 (27.9)	1.265 (32.1)	2-56 UNC-2A	.400 (10.2)	.310 (7.9)	.600 (15.2)
51	1.420 (36.1)	1.050 (26.7)	1.215 (30.9)	2-56 UNC-2A	.450 (11.4)	.360 (9.1)	.550 (14.0)
100	2.170 (55.1)	1.620 (41.1)	1.800 (45.7)	2-40 UNC-2A	.490 (12.4)	.400 (10.2)	1.000 (25.4)

TABLE III:
FINISH OPTIONS

Symbol	Finish
B	Cadmium Plate/Olive Drab
C*	Black Anodize
G*	Anodic Hard Coat
J	Gold Iridite over Cadmium Plate over Electroless Nickel
LF	Cadmium Plate/Bright over Electroless Nickel
M	Electroless Nickel
N	Cadmium Plate/Olive Drab over Electroless Nickel
NC	Zinc Cobalt/Dark Olive Drab
NF	Cadmium Plate/Olive Drab over Electroless Nickel
T	Cadmium Plate/Bright over Electroless Nickel
U**	Cadmium Plate/Black
ZN	Zinc-Nickel Alloy/Olive Drab

*Anodize finish is not suitable for EMI shielding or grounding applications.

**Applicable to corrosion resisting steel backshells and accessories. Consult factory for other available finishes.

Metric dimensions (mm) are indicated in parentheses

X-ON Electronics

Largest Supplier of Electrical and Electronic Components

Click to view similar products for [D-Sub Backshells](#) category:

Click to view products by [Glenair](#) manufacturer:

Other Similar products are found below :

[173114-0084](#) [173112-1658](#) [600X51137X](#) [600X54009X](#) [66241-12A](#) [M85049/48-1-2](#) [M85049/48-3-5F](#) [M85049/6-38N](#) [M85049/86-12N03](#)
[70.350.0636.4](#) [70.350.2435.1](#) [72.350.1035.2](#) [72.352.2435.1](#) [73.359.4035.3](#) [799-015TMH07M](#) [799-015TMH08N](#) [FKH1RE](#) [829472-1](#) [F-](#)
[PHG-1E](#) [F-PHG-3E](#) [F-PHG-4E](#) [F-PHR-4E](#) [PCS-E20W](#) [8655MHRA0901KLF](#) [8655MHRA2501KLF](#) [958-009-010R011](#) [970-015-040R011](#)
[970-025-030R121](#) [970-025-040R011](#) [971-009-030R121](#) [971-009-040R011](#) [971-015-040R011](#) [971-025-040R011](#) [GS85049/38-25M](#) [975T009-](#)
[020R121](#) [975T015-020R121](#) [1-21986-2](#) [1-21986-5](#) [DB-20962](#) [DE-C8-J9-F4-1R](#) [DE-C8-J9-F5-1R](#) [DPH-B-003](#) [1437013-9](#) [1484402-8](#)
[MS3057-10A](#) [156-3025-EX](#) [MS3417-16C](#) [16-500800](#) [165X02659X](#) [165X03329A](#)