

## SKINDICHT® KU, KUS, KUK

SKINDICHT® KU, KUS, KUK, polyamide, glass fibre-reinforced reducers for maximum mechanical stability, with PG connection thread

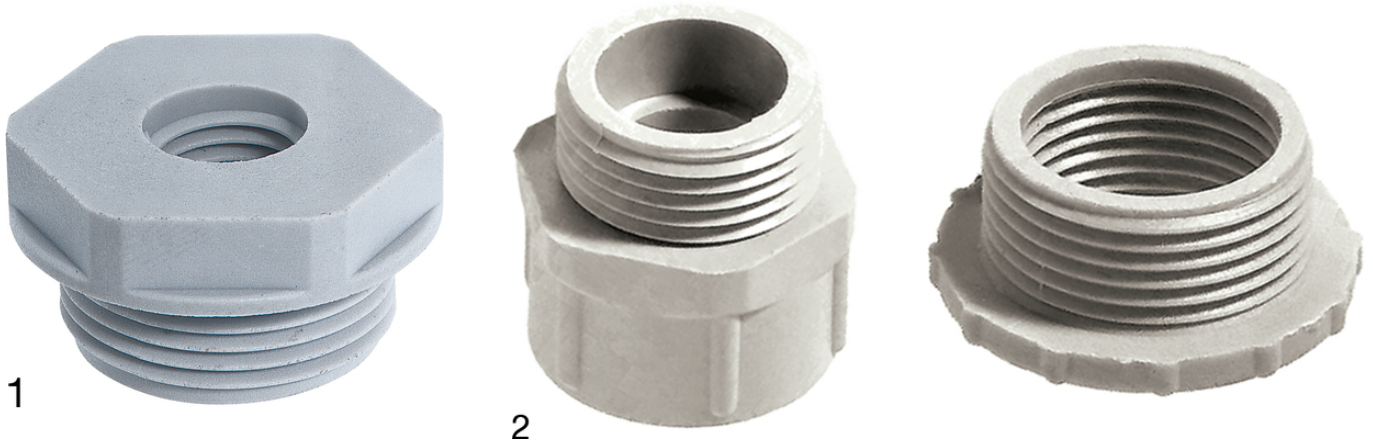

Space requirement

### Benefits

Enables the use of cable glands with smaller connection threads than the existing threaded holes  
Glass fibre-reinforced for maximum mechanical stability

### Application range

Machines  
Devices  
Housings

### Product Make-up

PG connection thread

### Product Make-up

SKINDICHT® KU with hexagon and flat design (1)  
SKINDICHT® KUS with hexagon and larger height (2)  
SKINDICHT® KUK with knurled heads (3)

### Technical Data

Classification ETIM 5:

ETIM 5.0 Class-ID: EC000441

ETIM 5.0 Class-Description: Cable screw gland

Classification ETIM 6:

ETIM 6.0 Class-ID: EC000441

ETIM 6.0 Class-Description: Cable screw gland

Colour delivered:

Light grey (RAL 7035)

Material:

Polyamide, glass fibre-reinforced

Temperature range:

-40°C to +100°C

Last Update (22.02.2018)

©2018 Lapp Group - Technical changes reserved

Product Management [www.lappkabel.de](http://www.lappkabel.de)

You can find the current technical data in the corresponding data sheet.

PN 0456 / 02\_03.16

## SKINDICHT® KU, KUS, KUK

### Note

Photographs and graphics are not to scale and do not represent detailed images of the respective products.  
Prices are net prices without VAT and surcharges. Sale to business customers only.

| Article number | Article designation / size |
|----------------|----------------------------|
| SKINDICHT® KU  |                            |
| 51730010       | KU 11/7                    |
| 52025100       | KU 13,5/7                  |
| 52025110       | KU 16/9                    |
| 52025120       | KU 21/11                   |
| 51730040       | KU 21/13,5                 |
| 52025130       | KU 29/13,5                 |
| 51730050       | KU 29/16                   |
| 52025140       | KU 36/16                   |
| 52025150       | KU 36/21                   |
| 52025050       | KU 36/29                   |
| 52025160       | KU 42/21                   |
| 52025170       | KU 42/29                   |
| 52025060       | KU 42/36                   |
| 52025180       | KU 48/29                   |
| 52025190       | KU 48/36                   |
| 52025070       | KU 48/42                   |
| SKINDICHT® KUS |                            |
| 52025040       | KUS 9/7                    |
| 51730060       | KUS 11/9                   |
| 51730070       | KUS 13,5/11                |
| 51730080       | KUS 16/13,5                |
| SKINDICHT® KUK |                            |
| 51730020       | KUK 13,5/9                 |
| 51730025       | KUK 16 /9                  |
| 51730030       | KUK 16/11                  |
| 51730035       | KUK 21/13,5                |
| 51730090       | KUK 21/16                  |
| 51730100       | KUK 29/21                  |
| 51730110       | KUK 36/29                  |

Last Update (22.02.2018)  
 ©2018 Lapp Group - Technical changes reserved  
 Product Management www.lappkabel.de  
 You can find the current technical data in the corresponding data sheet.  
 PN 0456 / 02\_03.16

## X-ON Electronics

Largest Supplier of Electrical and Electronic Components

*Click to view similar products for [Cable Glands, Strain Reliefs & Cord Grips](#) category:*

*Click to view products by [Lapp Kabel](#) manufacturer:*

Other Similar products are found below :

[120-116-1-1-20BP](#) [120-116-1-1-32BE](#) [120-117-40](#) [120-123-14](#) [120-123-16](#) [120-125-16](#) [120-125-16R](#) [120-125-16Y](#) [120-125-24Y](#) [120-125-28](#) [120-125-28R](#) [120-125-32](#) [120-125-32R](#) [120-125-40](#) [120-125-56](#) [120-126-14](#) [120-126-16](#) [120-126-20](#) [120-126-20BL](#) [120-126-20R](#) [120-126-24](#) [120-126-28](#) [120-126-32](#) [120-126-40BL](#) [120-116-1-1-06BP-509](#) [120-116-1-1-06CP](#) [120-116-1-1-16BE](#) [120-116-1-1-28BP](#) [120-123-20](#) [120-123-24](#) [120-123-32](#) [120-125-20](#) [120-125-20Y](#) [120-125-24](#) [120-125-24R](#) [120-125-28Y](#) [120-126-14BL](#) [120-126-16R](#) [120-126-16Y](#) [120-126-24BL](#) [120-126-28BL](#) [120-126-32BL](#) [120-126-40](#) [120-126-48](#) [120-126-48BL](#) [1300980012](#) [1300980105](#) [DBZM-6828](#) [1498](#) [15190-103 R2](#)