

Toggle shown in pos. 1

P.C. MOUNTING

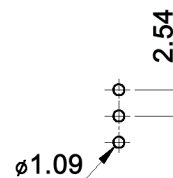

CONTACT ARRANGEMENT:

code for x	function	toggle in position 1	toggle opposite to pos. 1
D	On-On	2-3	1-2
F	On-Mom		

code for x	function	toggle in position 1	toggle in center	toggle opposite
E	On-Off-On	2-3	open	1-2
G	Mom-Off-Mom			
H	On-Off-Mom			

Specifications:

- Contact resistance: 20mOhm max. at 2-4V DC
- Insulation resistance: 1 000MOhm min.
- Dielectric strength: 1 000V RMS
- Operating temperature: -30°C to +85°C
- Mechanical life: 30 000 make-and-break cycles
- Material: Case / bushing: PA66, UL94V-0
Actuator: brass, chrome plated
- IP rating: IP67



Tolerances:	Date	Name
0.00: ±0.25mm 0.0: ±0.40mm	06/07	dr

TST 1 x y

Revised	01/14	dr	knitter-switch	30 11 41	Page
IP rating	04/12	dr			1/2
Revised	10/09	dr			
Modifications	Date	Name			

RATING AND CONTACT/TERMINAL SURFACE

y	contacts	terminals	rating
Q	Ag over Ni	Ag over Ni	28 VDC / 3 A 125 VAC / 3 A 250 VAC / 1 A
empty	Au over Ni	Au over Ni	0.4 VA, max. 20 V AC/DC
G	Au over Ag over Ni	Au over Ag over Ni	28 VDC / 3 A 125 VAC / 3 A 250 VAC / 1 A
T	Au over Ag over Ni	Sn	28 VDC / 3 A 125 VAC / 3 A 250 VAC / 1 A
X	Au over Ni	Sn	0.4 VA, max. 20 V AC/DC



Tolerances: 0.00: ±0.25mm 0.0: ±0.40mm		Date	Name	TST 1 x y
		06/07	dr	
			knitter-switch	30 11 41
Modifications		Date	Name	Page 2/2

X-ON Electronics

Largest Supplier of Electrical and Electronic Components

Click to view similar products for [Toggle Switches](#) category:

Click to view products by [Knitter-Switch](#) manufacturer:

Other Similar products are found below :

[8A1-C-222](#) [60012L](#) [6006L](#) [6663](#) [7101MD9V30GE](#) [7101SPDV30BE](#) [7103SDV30BE](#) [7105D](#) [7108P3YAV2BE](#) [71YY50282](#)
[7201MD9AVBE](#) [7301K38](#) [7306K36](#) [7310K36](#) [7314K36](#) [7506K4](#) [7592K6](#) [7691K14](#) [7700K1](#) [8396K108](#) [8824K14](#) [8828K13](#) [G2VX](#) [G3VX](#)
[PS83-121G](#) [A101MD9AB04](#) [A101SD9AB04](#) [A101SDCQ04](#) [A103SD9AQ04](#) [A107TZB04](#) [A123P32YZQ](#) [A123S1YZG](#) [A127S1YCQ](#) [1-](#)
[1825192-0](#) [A131S1YZQ](#) [A201SCWZB04](#) [A207SYCB04](#) [A208J61ZQ0004](#) [A221K12KAG](#) [A221S1YZQ](#) [A221T1TCQ](#) [A232K12KZQ](#)
[A232M1YCQ](#) [A323S1CWZQ](#) [A423S1CWZG-M8](#) [A423S1YZQ](#) [12149A-3V](#) [12156AX408](#) [12147AGKX679](#) [12149AD2G0383VX408](#)