

REV	ZONE	DESCRIPTION\PCR REQUEST\DATE

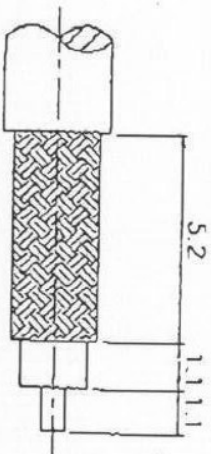

RECOMMENDED
CABLE STRIPPING DIM'S
(建議剝線尺寸)

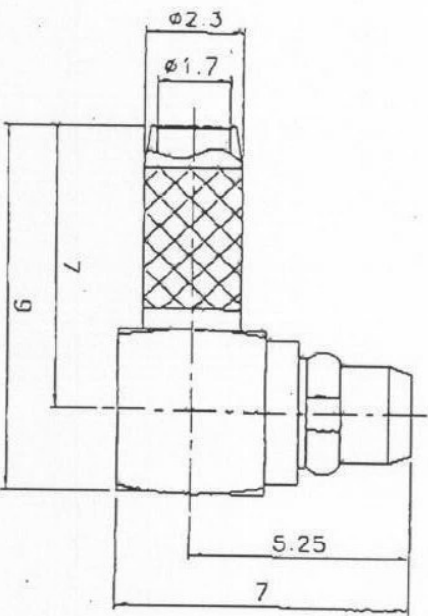
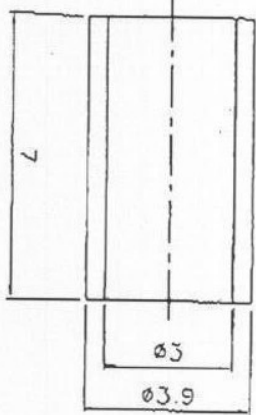

1. CRIMPED FERRULE
HEX CRIMP SIZE .128"
2. CONTACT PIN TO SOLDER

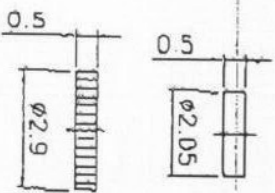

NO.	DESCRIPTION	MATERIAL	FINISH	QTY	DRAWING NO
7	CAP	BRASS	GOLD	1	CV01-0001G-0
6	INSULATOR	POH	NATURAL	1	NS01-0002W-0
5	FERRULE	BRASS	GOLD	1	FR00-0001G-0
4	RING	BERYLLIUM COPPER	GOLD	1	LR01-0001G-0
3	CONTACT PIN	BRASS	GOLD 3u"	1	CP01-0001G-0
2	INSULATOR	PIRE	NATURAL	1	NS01-0001W-0
1	BODY	BRASS	GOLD	1	DP01-0001G-0

DIMENSIONS ARE IN MILLIMETERS
THICKNESS DIMENSIONS SPECIFIED
TOLERANCES

ANGLES = 2.5°
UP TO 6 = ±0.1
6-40 = ±0.2
40-120 = ±0.6
120-315 = ±1.1
ABOVE 315 = ±1.6

TITLE MMXX R/A PLUG CRIMP
(FOR RG-174/U, 316/U) MS2306 P

DRAWING NO MMXXPRA-1

CUSTOMER NO TC-1403-TBGC\11 02-18-13

REV 0

REV 0

X-ON Electronics

Largest Supplier of Electrical and Electronic Components

Click to view similar products for [RF Connectors](#) / [Coaxial Connectors](#) category:

Click to view products by [Ninigi](#) manufacturer:

Other Similar products are found below :

[R125315120](#) [8915-1511-000](#) [89674-0827](#) [5916-1103-603](#) [0106-001-000](#) [6-0001-3](#) [6001-7071-019](#) [6002-7051-003](#) [6002-7551-202](#) [6059674-1](#) [619550-1](#) [630059-000](#) [M39012/25-0021](#) [M39012/79-3008](#) [M39030/3-01N](#) [M39030/3-03N](#) [M3933/25-29N](#) [M3933/25-36N](#) [6500-7071-046](#) [6501-1071-002](#) [M83723/72W24576](#) [M83723/72W2457N](#) [6769](#) [CX050L2AQ](#) [7002-1541-010](#) [7003-1572-002](#) [7004-1512-000](#) [7009-1511-004](#) [7010-1511-000](#) [7029-1511-060](#) [7101-1541-010](#) [7101-1571-002](#) [7105-1521-002](#) [7145-1521-002](#) [7209-1511-011](#) [7210-1511-012](#) [7210-1511-015](#) [7210-1511-019](#) [7210-1511-040](#) [7225-1512-050](#) [7242-1511-000](#) [73137-5015](#) [73251-0111](#) [73251-0672](#) [73276-1501](#) [73366-0013](#) [73404-2300](#) [73413-6080](#) [734151610](#) [73415-5721](#)