

FIG 1:

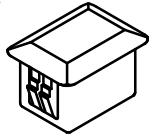

FIG 2:

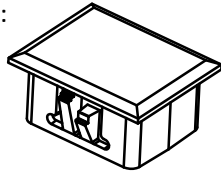
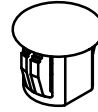

FIG 3:



REV.	MODIFICATION.	DATE	DRN
01	C0-2010730	15/07/09	OW
02	C0-2010780	25/08/09	OW
03	C0-2010881	05/02/10	OW
04	C0-2010984	07/09/10	SF
05	C0-2011040	19/01/11	SF

PART No.	"A"	"B"	"C"	"D"	"E"	"L1"	"L2"	PANEL THICKNESS	FIG	COLOUR
BPE-SC-1-01	21.5 +0.6 -0 [.85 +.024 -0]	12.8 [.50]	12 [.47]	9.3 [.37]	1.5 [.059]	13 [.512]	9.5 [.374]	1.4 - 3.5 [.550 - .138]	1	BLACK
BPE-SC-2-01	16 [.63]									
BPE-SC-3-01	34.8 [1.37]	25.8 [1.02]				26 [1.024]				
BPE-RJ45-01	17.7 [.70]	14.7 [.58]	22 [.87]	19.1 [.75]		19.3-20 [.760-.787]	14.9-15 [.587-.591]	0.75 [.030], 1.2 [.050], 1.6 [.060], 2.7 [.110], 3.5 [.140]	2	GREY
BPE-LC-D-01	15 [.59]	13.2 [.52]	15 [.59]	13.2 [.52]	2 [.078]	13.5 [.532]	13.5 [.532]	0.75 [.030], 1.2 [.050], 1.6 [.060], 2.7 [.110], 3.75 [.148]	1	BLACK
BPE-ST-1-01	Ø12 [.47]	Ø9.2 [.36]	Ø12 [.47]	7.7 [.30]	1.5 [.059]	Ø9.4 [.370]	7.9 [.311]	1.4 - 3.5 [.055 - .138]	3	

FIG 1:

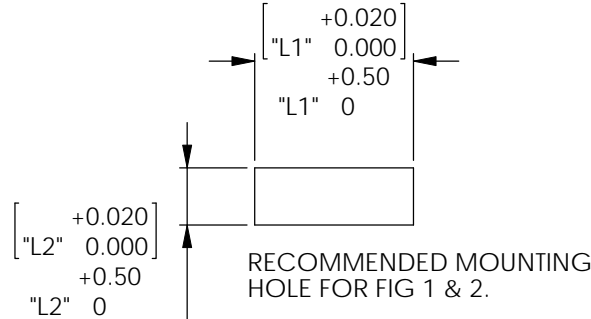
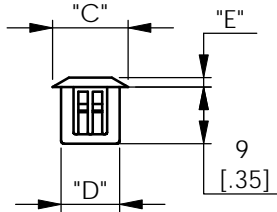
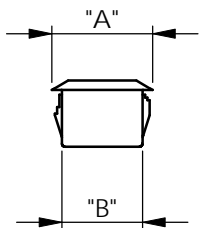

- NOTES:  
 1) ALTERNATE UNITS FOR REFERENCE ONLY  
 2) PARTS AVAILABLE IN OTHER COLOURS BY SPECIAL ORDER  
 3) PARTS AVAILABLE IN NYLON 6/6 UL94 V-0(RMS-19) BY SPECIAL ORDER, REPLACE -01 WITH -19 AT END OF PART NUMBER

FIG 2:

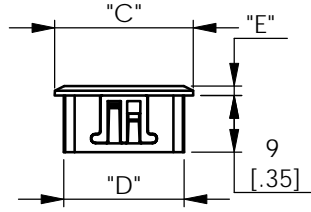
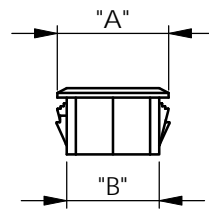
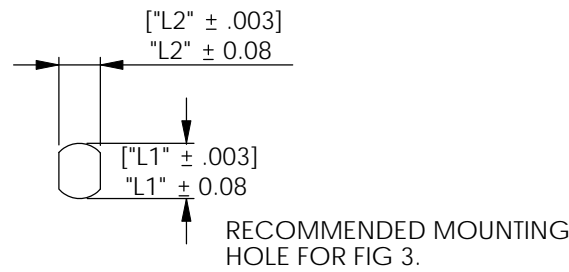
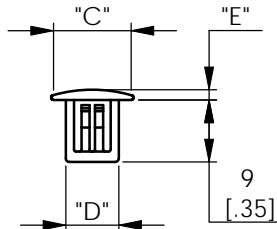
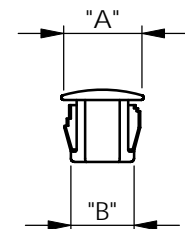

FIG 3:



INFORMATION CONTAINED IN THIS DOCUMENT IS CONFIDENTIAL TO RICHCO INTERNATIONAL Co. Ltd. AND MAY NOT BE DISCLOSED OR REPRODUCED IN WHOLE OR PART WITHOUT THEIR WRITTEN CONSENT.

**RICHCO, INC.**  
 WWW.RICHCO-INC.COM

ALL DIMENSIONS IN mm  
 GENERAL TOLERANCES ±0.25  
 UNLESS OTHERWISE STATED  
 1 DECIMAL PLACE ±  
 2 DECIMAL PLACES ±  
 ANGULAR ±1°

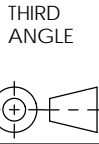

MATERIAL: NYLON 6/6 UL94 V-2 (RMS-01)				COLOUR: SEE TABLE	
DESCRIPTION: BLANKING PLUGS				PART No: SEE TABLE	
DRG No: 09-071		NPR No: N/A		SHEET SIZE A4	
DRN OW	DATE 15/07/09	CHKD TC	DATE 15/07/09	SCALE NTS	SHEET No. 1 OF 1

## X-ON Electronics

Largest Supplier of Electrical and Electronic Components

*Click to view similar products for [Enclosures, Boxes, & Cases](#) category:*

*Click to view products by [Richco](#) manufacturer:*

Other Similar products are found below :

[CR-425 PAINTED](#) [585-R-WH-PK](#) [M-10-PLATED](#) [60221-01](#) [60566-01-000](#) [HPL-9VB BATT DOOR](#) [M-16-LID-PLATED](#) [M18-PLTD](#) [M-21-LID-PLATED](#) [M-21-PLATED](#) [M-23-PLATED](#) [CU-281-MB](#) [6711GSKT](#) [71884-29-028](#) [LH45-100 Black](#) [7200B](#) [72868-510-000](#) [CNS-0000 Black](#) [72883-510-000](#) [CNS-0101 Black](#) [72906-510-000](#) [CNS-0407 Black](#) [73091-510-000](#) [CNM-0000-BLACK Kit](#) [73092-510-000](#) [CNM-0101 Black](#) [73108-510-000](#) [CNL-0303 Black](#) [73395-510-039](#) [CNS-0006 Bone](#) [74257-510-000](#) [CNL-0004](#) [MDC-1183-PLAIN-ALUM](#) [MDC-1183-PTD](#) [MDC-13104-PLAIN-ALUM](#) [MDC-211 - PAINTED IVORY/BEIGE](#) [MDC-321-PTD](#) [MDC-432-PLAIN-ALUM](#) [MDC-973-PTD](#) [76](#) [77153-01-028](#) [FLX6030](#) [83535-01-508](#) [PS-11296-G](#) [PS-11298-B](#) [116-508](#) [120-407](#) [120-412](#) [120-909](#) [120-455](#) [R272-100-000](#) [120-910](#) [R501-001-010](#) [R508-080-000](#) [R508-160-000](#) [R530-120-000](#) [R530-122-000](#) [R530-200-000](#) [R531-160-000](#) [R531-200-000](#) [R582-080-100](#)