

High Current Chokes

Special Features

- Very high current capacity
- Low DCR
- Ferrite bobbin core
- VW-1 rated shrink tubing to cover winding
- Fixed lead spacing
- Operating temperature -55 to +105 °C

Notes

* Current to cause 5 % max. inductance drop or 35 °C max. temperature rise

† RoHS Directive 2002/95/EC Jan 27 2003 including Annex.

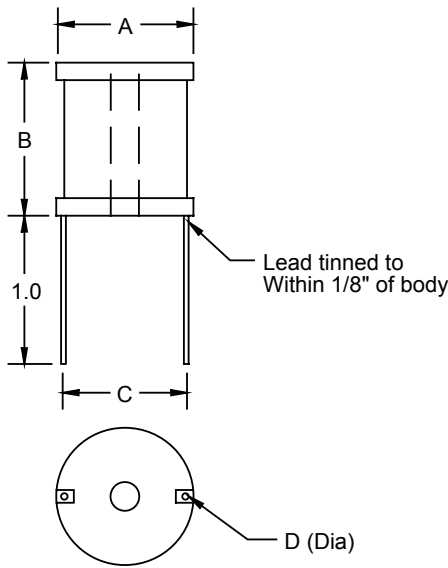

Dimensions: Inches

| 5600 Series | | | | | | | |
|-------------|----------------------------|------------------|---------------|-------------------|-------------------|-------------------|--------------------|
| Part Number | L (μH) ±10 % @ 1 KHz | DCR Ω Max. | I, DC* (A) | Dim. A Max. | Dim. B Max. | Dim. C ±.06 | Dim. D ±.005 |
| 5601-RC | 5 | 0.007 | 15 | 0.83 | 0.91 | 0.59 | 0.065 |
| 5602-RC | 10 | 0.008 | 14 | 0.83 | 0.91 | 0.60 | 0.065 |
| 5603-RC | 25 | 0.023 | 8 | 0.83 | 0.91 | 0.57 | 0.042 |
| 5604-RC | 50 | 0.034 | 6.6 | 0.83 | 0.91 | 0.65 | 0.042 |
| 5605-RC | 100 | 0.072 | 4.5 | 0.83 | 0.91 | 0.69 | 0.042 |
| 5606-RC | 250 | 0.173 | 2.9 | 0.83 | 0.91 | 0.65 | 0.042 |
| 5607-RC | 500 | 0.378 | 2 | 0.83 | 0.91 | 0.68 | 0.042 |
| 5608-RC | 1000 | 0.801 | 1.3 | 0.83 | 0.91 | 0.66 | 0.042 |
| 5609-RC | 2500 | 2.040 | .85 | 0.83 | 0.91 | 0.71 | 0.042 |
| 5610-RC | 5 | 0.005 | 20 | 1.22 | 1.11 | 0.94 | 0.082 |
| 5611-RC | 10 | 0.006 | 17 | 1.22 | 1.11 | 0.95 | 0.082 |
| 5612-RC | 25 | 0.009 | 14 | 1.22 | 1.11 | 0.93 | 0.082 |
| 5613-RC | 50 | 0.017 | 10 | 1.22 | 1.11 | 0.99 | 0.065 |
| 5614-RC | 100 | 0.034 | 7 | 1.22 | 1.11 | 0.85 | 0.053 |
| 5615-RC | 250 | 0.083 | 4.6 | 1.22 | 1.11 | 0.97 | 0.053 |
| 5616-RC | 500 | 0.129 | 3.7 | 1.22 | 1.11 | 1.12 | 0.053 |
| 5617-RC | 1000 | 0.279 | 2.5 | 1.22 | 1.11 | 1.05 | 0.053 |
| 5618-RC | 2500 | 0.690 | 1.6 | 1.22 | 1.11 | 1.05 | 0.053 |
| 5619-RC | 50 | 0.012 | 14 | 1.50 | 1.11 | 1.23 | 0.082 |
| 5620-RC | 100 | 0.027 | 9.8 | 1.50 | 1.11 | 1.12 | 0.065 |
| 5621-RC | 250 | 0.059 | 6.4 | 1.50 | 1.11 | 1.10 | 0.053 |
| 5622-RC | 500 | 0.090 | 5 | 1.50 | 1.11 | 1.14 | 0.053 |
| 5623-RC | 1000 | 0.195 | 3.5 | 1.50 | 1.11 | 1.36 | 0.053 |
| 5624-RC | 2500 | 0.499 | 2.2 | 1.50 | 1.11 | 1.32 | 0.053 |
| 5625-RC | 5000 | 1.080 | 1.5 | 1.50 | 1.11 | 1.27 | 0.053 |
| 5626-RC | 100 | 0.018 | 14 | 1.50 | 1.50 | 1.18 | 0.082 |
| 5627-RC | 250 | 0.040 | 9 | 1.50 | 1.50 | 1.12 | 0.065 |
| 5628-RC | 500 | 0.085 | 6.5 | 1.50 | 1.50 | 1.06 | 0.053 |
| 5629-RC | 1000 | 0.183 | 4.4 | 1.50 | 1.50 | 1.23 | 0.053 |
| 5630-RC | 2500 | 0.464 | 2.8 | 1.50 | 1.50 | 1.21 | 0.053 |
| 5631-RC | 5000 | 0.714 | 2.2 | 1.50 | 1.50 | 1.63 | 0.053 |
| 5632-RC | 10,000 | 1.560 | 1.5 | 1.62 | 1.50 | 1.25 | 0.053 |

"-RC" suffix indicates RoHS compliance.

X-ON Electronics

Largest Supplier of Electrical and Electronic Components

Click to view similar products for [Fixed Inductors](#) category:

Click to view products by [Johanson](#) manufacturer:

Other Similar products are found below :

[MLZ1608M6R8WTD25](#) [MLZ1608N6R8LT000](#) [MLZ1608N3R3LTD25](#) [MLZ1608N3R3LT000](#) [MLZ1608N150LT000](#)

[MLZ1608M150WTD25](#) [MLZ1608M3R3WTD25](#) [MLZ1608M3R3WT000](#) [MLZ1608M150WT000](#) [MLZ1608A1R5WT000](#)

[MLZ1608N1R5LT000](#) [B82432C1333K000](#) [PCMB053T-1R0MS](#) [PCMB053T-1R5MS](#) [PCMB104T-1R5MS](#) [CR32NP-100KC](#) [CR32NP-](#)

[151KC](#) [CR32NP-180KC](#) [CR32NP-181KC](#) [CR32NP-1R5MC](#) [CR32NP-390KC](#) [CR32NP-3R9MC](#) [CR32NP-680KC](#) [CR32NP-820KC](#)

[CR32NP-8R2MC](#) [CR43NP-390KC](#) [CR43NP-560KC](#) [CR43NP-680KC](#) [CR54NP-181KC](#) [CR54NP-470LC](#) [CR54NP-820KC](#) [CR54NP-8R5MC](#)

[MGDQ4-00004-P](#) [MGDU1-00016-P](#) [MHL1ECTTP18NJ](#) [MHL1JCTTD12NJ](#) [PE-51506NL](#) [PE-53601NL](#) [PE-53630NL](#) [PE-53824SNLT](#) [PE-](#)

[62892NL](#) [PE-92100NL](#) [PG0434.801NLT](#) [PG0936.113NLT](#) [PM06-2N7](#) [PM06-39NJ](#) [HC2LP-R47-R](#) [HC2-R47-R](#) [HC3-2R2-R](#) [HC8-1R2-R](#)