

SNAP ACTION SWITCH

Features

- Auxiliary Actuators for type VS and VT Micro Switches.
- Metal and Plastic material are both available.
- Many options of the button are available.
- Easy to install.



Specifications

Item	Standard
Rating	10A 125VAC /15 250 VAC UL1054
Conduit Resistance	50mΩ max. (Initial)
Dielectric Resistance	AC 1000V (50/60 Hz for 1minute)
Insulation Resistance	100MΩ, min (at 500 VDC)
Electrically Life	100,000 Cycle min
Mechanically Life	1,000,000 Cycle min

Product selection

VAQ-4 - - - -

1 2 3 4 5

1. ACTUATOR TYPE

VAQ-4: Nylon(φ 13mm)

VAQ-5: Nylon(φ 19mm)

AB5151: Metal(φ 13mm)

AB6161: Metal(φ 19mm)

2. BUTTON COLOR

R: Red

Y: Yellow

G: Green

3. CURRENT RATING

10: 10A 250VAC VS SERIES(S)

16: 16A 250VAC VT SERIES(C)

_: WITHOUT (S)

4. CONTACT

1: 1 NC & 1NO(S)

2: NC(C)

3: NO(C)

5. TERMINAL

VS SERIES (10A)

A: Solder(C)

B: Screw(C)

C: 250 Quick Connect (C)

C2: 187 Quick Connect (S)

VT SERIES(16A)

A: Solder (C)

C: 250 Quick Connect (C)

C2: 187 Quick Connect (C)

* (S)=Standard (C) =Customization

HIGHLY

B21

Design, specifications are subject to change without notice.

SNAP ACTION SWITCH

Dimensions

Unit: mm

Item No.

Dimensions

VAQ-4

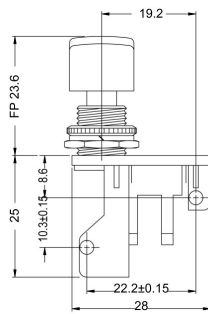

Assembly VS Series switch

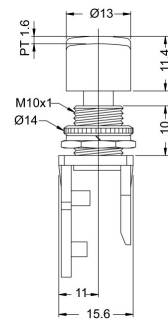

ZVAQ-5

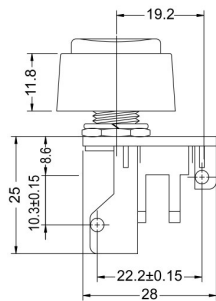

Assembly VS Series switch

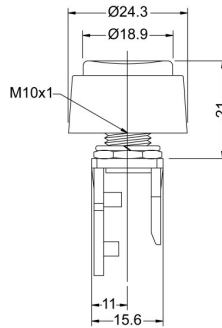

AB5151

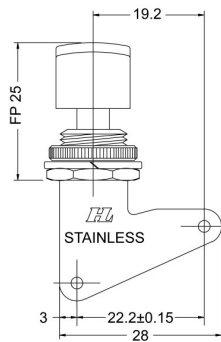

Assembly VS Series switch

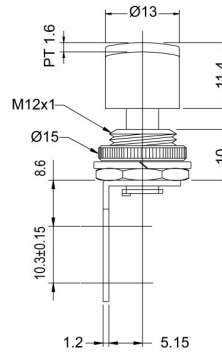

AB6161

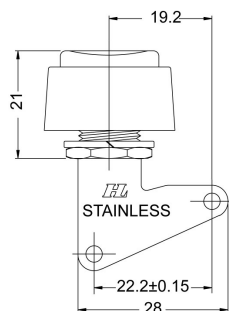

Assembly VS Series switch

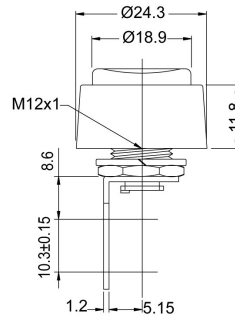

HIGHLY

B22

Design, specifications are subject to change without notice.

X-ON Electronics

Largest Supplier of Electrical and Electronic Components

Click to view similar products for [Pushbutton Switches](#) category:

Click to view products by [Highly manufacturer](#):

Other Similar products are found below :

[LW1L-M1C10V-A](#) [LW2L-A1C20M-GD](#) [LW2L-M1C20M-A](#) [60324L](#) [M7E-HRN2](#) [67021K512](#) [67081K512X](#) [701PB580](#) [719-5504-000](#)
[MDPSSGLFS](#) [810KSV30B](#) [MML21KA3ABK](#) [MML23KA3AC05K-001](#) [MML23KW3AA01W](#) [8418K2](#) [8646AB6X718UL](#) [8646ABUL](#)
[FSDWH](#) [9001KXRK](#) [9001T8BK](#) [9533CD4+U574+U4922](#) [1203MRA](#) [A22EM01S](#) [A595](#) [1202A6](#) [12037A2ULCSA](#) [1203A2UL](#) [ABD122N-](#)
[B](#) [1211390004](#) [ABN111-Y](#) [ABN400-R](#) [1211500044](#) [1211580012](#) [1212MRA](#) [1232A6NF](#) [RA3CSH6A](#) [1241.1183.7047](#) [1241.2511](#)
[1241.3428](#) [1223A2ULCSA](#) [1223MRA](#) [1232AX2119](#) [1241.1183.8000](#) [1241.1183.8029](#) [1241.2506](#) [1241.2606](#) [12MA6](#) [1301940184](#)
[RELBARF6X10\(PLASTIC\)](#) [13435AG](#)