

# SNAP ACTION SWITCH

## Features

- Reliability is excellent.
- It's has long life and more operating force can be applied such as lightly force.
- Good feeling and more levers are applied.

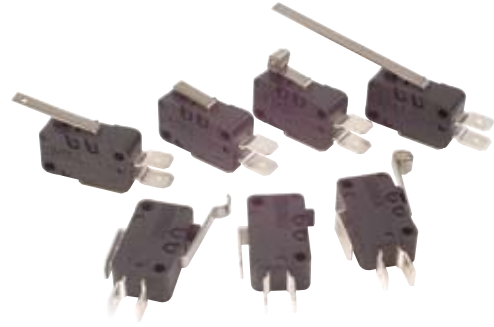

## Applications

- Joystick , TV game , Time recorder , Air conditioner , Food processor , Juice maker , Alarm , Mixer , Shredder machine , etc.

## Specifications

Item	Standard	
Rating	14(4)A 250V AC	15A 250V AC
Conforming to standards	UL 61058-1	UL 1054
Contact Resistance	15 mΩ max. (initial)	
Insulation Resistance	100MΩ min. (at 500V DC)	
Dielectric Strength	Between terminals of same polarity AC 1000V (50/60Hz for 1minute)	
	Between each terminal and non-current-carrying rind parts AC 2000V ( 50/60Hz for 1 minute)	
Electrically Life	100,000 cycles	
Mechanically Life	1,000,000 cycles	

## Product Selection

VT16     
 1 2 3

### 1. ACTUATOR TYPES

<b>00:</b> Pin plunger	<b>04:</b> Simulated roller lever
<b>01:</b> Short hinge lever	<b>05:</b> Short hinge roller lever
<b>02:</b> Hinge lever	<b>06:</b> Hinge roller lever
<b>03:</b> Long hinge lever	

### 2. CONTACT FORM & COMMON TERMINAL POSITION

Contact form	1: SPDT	2: SPST-NC	3: SPST-NO
Common terminal position	button 	button 	button 

### Mounting Holes

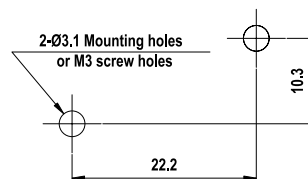

### 3. Terminal Type

Solder terminal (-A)		Quick-connect terminal 6.4x0.8 (-C)		Quick-connect terminal 4.8x0.8 (-C2)	

**HIGHLY**

B10

Design, specifications are subject to change without notice.

# SNAP ACTION SWITCH

## Operating Characteristics

Unit: mm

Item Operating Characteristics Dimensions

### VT1600



OF	max	250g.
RF	min	30g
PT	max..	1.4 mm
OT	min.	0.8 mm
MD	max.	0.4 mm
OP		14.7±0.4 mm

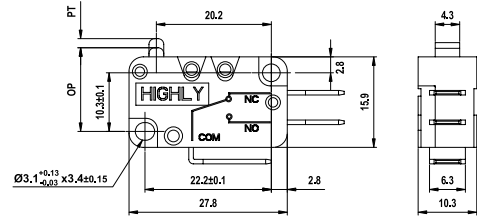

### VT1601



OF	max.	250g
RF	min.	20g
PT	max.	1.6 mm
OT	min.	0.8 mm
MD	max.	0.4 mm
OP		15.2±0.6 mm

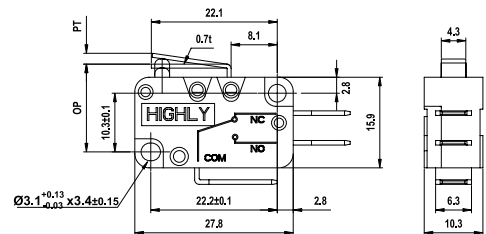

### VT1602



OF	max.	120g
RF	min.	10g
PT	max.	3.2 mm
OT	min.	1.8 mm
MD	max.	1.0 mm
OP		15.2±1.5 mm

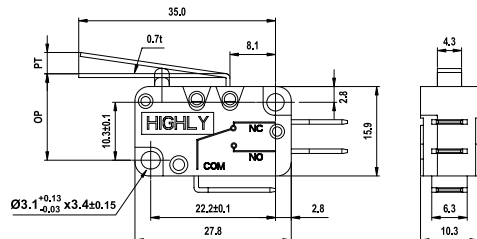

### VT1603



OF	max.	60g
RF	min.	5g
PT	max.	8.0 mm
OT	min.	3.0 mm
MD	max.	2.2 mm
OP		15.2±2.6 mm

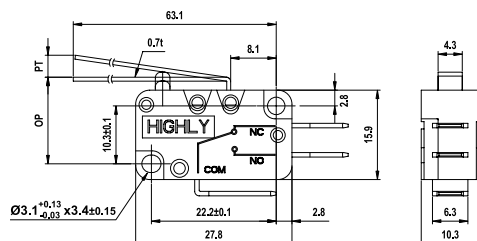

**HIGLY**

B11

Design, specifications are subject to change without notice.

# SNAP ACTION SWITCH

## Operating Characteristics

Unit: mm

Item Operating Characteristics Dimensions

### VT1604



OF	max.	120g
RF	min.	10g
PT	max.	3.2 mm
OT	min.	1.8 mm
MD	max.	1.0 mm
OP		18.7 ± 1.2 mm

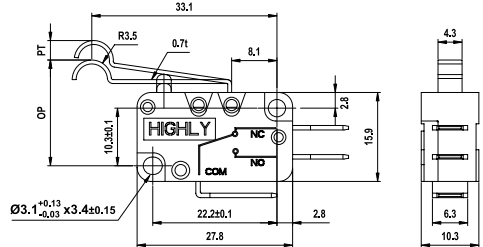

### VT1605



OF	max.	250g
RF	min.	30g
PT	max.	14 mm
OT	min.	0.8 mm
MD	max.	0.4 mm
OP		20.7 ± 0.6 mm

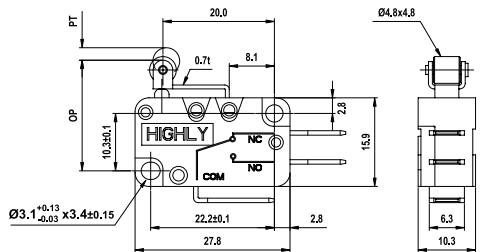

### VT1606

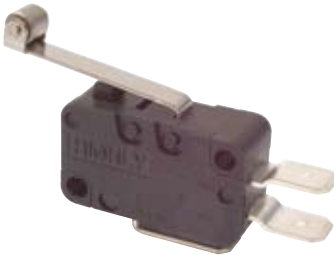

OF	max.	120g
RF	min.	10g
PT	max.	3.2 mm
OT	min.	1.8 mm
MD	max.	1.0 mm
OP		20.7 ± 1.5 mm

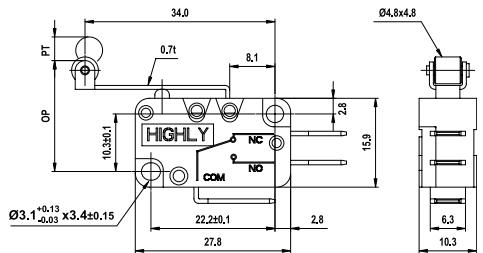

## X-ON Electronics

Largest Supplier of Electrical and Electronic Components

*Click to view similar products for [Basic / Snap Action Switches](#) category:*

*Click to view products by [Highly manufacturer](#):*

Other Similar products are found below :

[83228001](#) [01.098.1358.1](#) [602EN1-6B](#) [602EN532](#) [602EN535-RB](#) [602HE5-RB1](#) [604HE162](#) [604HE223-6B](#) [624HE17-RB](#) [6HM89](#) [6PA78-JM](#)  
[6SE1](#) [6SX1-H58](#) [70500840](#) [MBD5B1](#) [MBH2731](#) [73-316-0012](#) [79211759](#) [79211923](#) [79218589](#) [7AS12](#) [ML-1155](#) [ML-1376](#) [831010C3.0](#)  
[831060C3.TL](#) [831090C2.EL](#) [83131904](#) [84212012](#) [8AS239](#) [8HM73-3](#) [903VB1-PG](#) [914CE1-6G](#) [PL-100](#) [11SM1077-H4](#) [11SM1077-H58](#)  
[11SM1-TN107](#) [11SM405](#) [11SM703-T](#) [11SM8423-H2](#) [11SX37-T](#) [11SX48-H58](#) [11SX55-H58](#) [11SM2442-T](#) [11SM76-T](#) [11SM77-H58](#)  
[11SM77-T](#) [11SM863-T](#) [11SM866](#) [11SX47-H58](#) [A7CN-1M-1-LEFT](#)