

	Scanning distance
	3...200/5...400/ 10...800 mm
	Photoelectric proximity switch

- Energetic scanner, also with large scanning distances for standard applications
- 3 scanning distance options:
SD 1 = 200 mm
SD 2 = 400 mm
SD 3 = 800 mm
- Optionally VT 18-3 in 3-line model or VT 18-4 with light/dark control line
- Many other options

Dimensional drawing

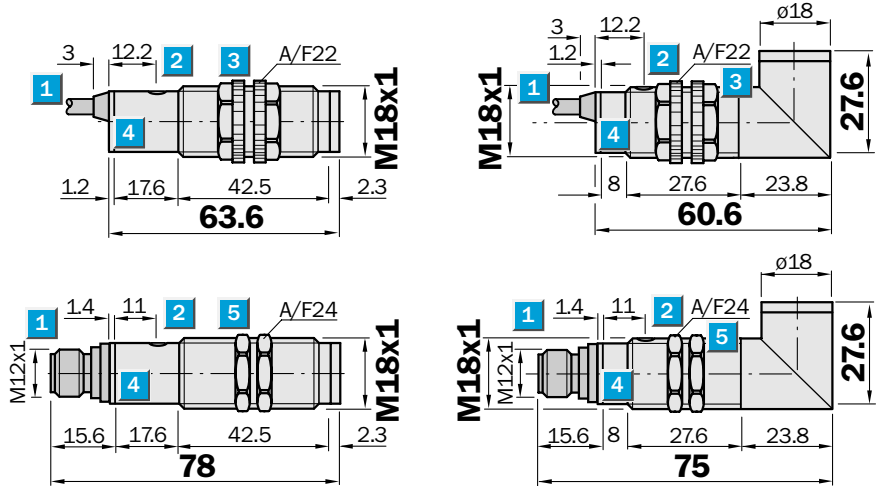

Adjustments possible

See selection table on page 367–369

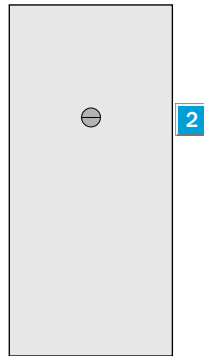

- 1** Connecting cable or plug
- 2** Sensitivity control
- 3** Fastening nut, width across 22 mm, made of plastic for equipment with plastic housing
- 4** Signal strength indicator, LED, yellow
- 5** Fastening nut, width across 24 mm, made of metal for equipment with metal housing



Connection types

VTE 18-3

VTE 18-4

Variants, equipment options: See selection table on pages 367 – 369 for type name and part no.

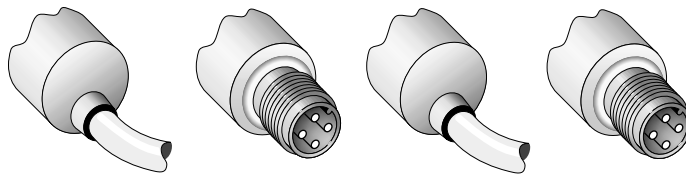

3 x 0.14 mm²

4-pin, M 12

4 x 0.14 mm²

4-pin, M 12

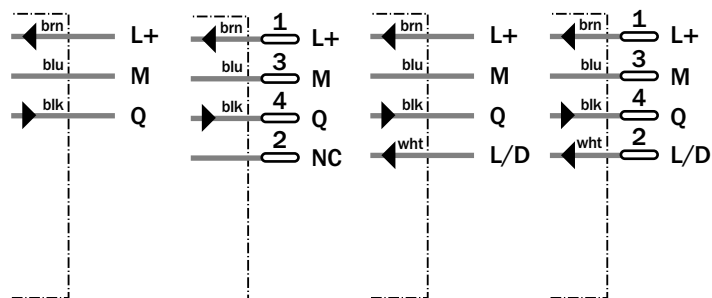

Accessories	page
Cable receptacle	496
Reflectors	520



Technical data		VTE 18-	3x2...	4x2...	3x4...	4x4...	3x8...	4x8...				
Housing	Straight											
	Angled, 90°											
VTE 18 Scanning distance 200 mm												
Scanning distance , max. typical ¹⁾	3...200 mm											
Scanning distance ¹⁾	3...170 mm											
Light spot diameter	Approx. 10 mm at a dist. of 200 mm											
VTE 18 Scanning distance 400 mm												
Scanning distance , max. typical ¹⁾	5...400 mm											
Scanning distance ¹⁾	5...350 mm											
Light spot diameter	Approx. 20 mm at a dist. of 400 mm											
VTE 18 Scanning distance 800 mm												
Scanning distance , max. typical ¹⁾	10...800 mm											
Scanning distance ¹⁾	10...700 mm											
Light spot diameter	Approx. 40 mm at a dist. of 800 mm											
Sensitivity adjustable (optional)	Potentiometer 270°											
Light source ²⁾ , light type	LED, infrared light											
Angle of dispersion of sender	2.8°											
Supply voltage V_S	10...30 V DC ³⁾											
Ripple ⁴⁾	± 10 %											
Current consumption ⁵⁾	≤ 30 mA											
Switching outputs (optional)	PNP/NPN; open collector: Q											
Switching mode	Q, light-/dark-switching											
	Q, light-switching											
via control wire L/D ⁶⁾	Q, light-/dark-switching											
	+ V _S = light-switching											
	0 V = dark-switching											
Output current I _A max.	100 mA											
Response time ⁷⁾	≤ 2 ms											
Max. switching frequency ⁸⁾	250/s											
Connection types												
cable 2 m ⁹⁾	PVC, 3 x 0.14 mm ² , Ø 3.1 mm											
	PVC, 4 x 0.14 mm ² , Ø 5 mm											
plug	4 pin, M 12											
VDE protection class ¹⁰⁾	□											
Circuit protection ¹¹⁾	A, B, C, D											
Enclosure rating	IP 67											
Ambient temperature T_A	- 25 °C... + 70 °C											
Weight	metal housing	Approx. 120 g										
	plastic housing	Approx. 100 g										
Housing material												
metal housing	Nickel-plated brass; PBT/PC											
plastic housing	PBT/PC											
optic	PMMA											

1) Object with 90 % reflectance (referred to standard white DIN 5033)

2) Average service life 100,000 h at T_A = + 25 °C

3) Limit values

4) Must be within V_S tolerances

5) Without load

6) Control wire open:
NPN: light-switching
PNP: dark-switching

7) With resistive load

8) With light/dark ratio 1:1

9) Do not bend below 0 °C

10) Reference voltage 50 V DC

11) A = V_S connections reverse-polarity protected

B = Inputs/outputs reverse-polarity protected

C = Interference suppression

D = Outputs overcurrent and short-circuit protected

Order information

See selection table on page 367 – 369

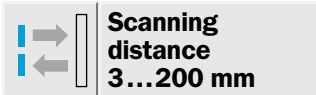

VTE 18-3, VTE 18-4 selection table, photoelectric proximity switch, energetic

Switching mode	Connection type
----------------	-----------------

Without sensitivity control				With sensitivity control			
NPN output		PNP output		NPN output		PNP output	
Type	Part no.	Type	Part no.	Type	Part no.	Type	Part no.

3 wire

VTE 18-3 Q = D.ON	Cable 2 m
	M 12 plug, 4-pin

VTE 18-3 Q = L.ON	Cable 2 m
	M 12 plug, 4-pin

4 wire, L/D control wire

VTE 18-4 L.ON/D.ON	Cable 2 m
	M 12 plug, 4-pin

3 wire

VTE 18-3 Q = D.ON	Cable 2 m
	M 12 plug, 4-pin

VTE 18-3 Q = L.ON	Cable 2 m
	M 12 plug, 4-pin

4 wire, L/D control wire

VTE 18-4 L.ON/D.ON	Cable 2 m
	M 12 plug, 4-pin

3 wire

VTE 18-3 Q = D.ON	Cable 2 m
	M 12 plug, 4-pin

VTE 18-3 Q = L.ON	Cable 2 m
	M 12 plug, 4-pin

4 wire, L/D control wire

VTE 18-4 L.ON/D.ON	Cable 2 m
	M 12 plug, 4-pin

3 wire

VTE 18-3 Q = D.ON	Cable 2 m
	M 12 plug, 4-pin

VTE 18-3 Q = L.ON	Cable 2 m
	M 12 plug, 4-pin

4 wire, L/D control wire

VTE 18-4 L.ON/D.ON	Cable 2 m
	M 12 plug, 4-pin

Housing material: metal

Optical axis: axial

VTE 18-3 N 2112	6 013 372	VTE 18-3 P 2112	6 013 381	VTE 18-3 N 2212	6 013 390	VTE 18-3 P 2212	6 013 399
VTE 18-3 N 2140	6 013 374	VTE 18-3 P 2140	6 013 383	VTE 18-3 N 2240	6 013 392	VTE 18-3 P 2240	6 013 401
VTE 18-3 E 2112	6 013 375	VTE 18-3 F 2112	6 013 384	VTE 18-3 E 2212	6 013 393	VTE 18-3 F 2212	6 013 402
VTE 18-3 E 2140	6 013 377	VTE 18-3 F 2140	6 013 386	VTE 18-3 E 2240	6 013 395	VTE 18-3 F 2240	6 013 404

VTE 18-4 N 2112	6 013 378	VTE 18-4 P 2112	6 013 387	VTE 18-4 N 2212	6 013 396	VTE 18-4 P 2212	6 013 405
VTE 18-4 N 2140	6 013 380	VTE 18-4 P 2140	6 013 389	VTE 18-4 N 2240	6 013 398	VTE 18-4 P 2240	6 013 407

Optical axis: 90°

VTE 18-3 N 2312	6 013 408	VTE 18-3 P 2312	6 013 417	VTE 18-3 N 2412	6 013 426	VTE 18-3 P 2412	6 013 435
VTE 18-3 N 2340	6 013 410	VTE 18-3 P 2340	6 013 419	VTE 18-3 N 2440	6 013 428	VTE 18-3 P 2440	6 013 437
VTE 18-3 E 2312	6 013 411	VTE 18-3 F 2312	6 013 420	VTE 18-3 E 2412	6 013 429	VTE 18-3 F 2412	6 013 438
VTE 18-3 E 2340	6 013 413	VTE 18-3 F 2340	6 013 422	VTE 18-3 E 2440	6 013 431	VTE 18-3 F 2440	6 013 440

VTE 18-4 N 2312	6 013 414	VTE 18-4 P 2312	6 013 423	VTE 18-4 N 2412	6 013 432	VTE 18-4 P 2412	6 013 441
VTE 18-4 N 2340	6 013 416	VTE 18-4 P 2340	6 013 425	VTE 18-4 N 2440	6 013 434	VTE 18-4 P 2440	6 013 443

Housing material: plastic

Optical axis: axial

VTE 18-3 N 2612	6 013 444	VTE 18-3 P 2612	6 013 453	VTE 18-3 N 2712	6 013 462	VTE 18-3 P 2712	6 013 471
VTE 18-3 N 2640	6 013 446	VTE 18-3 P 2640	6 013 455	VTE 18-3 N 2740	6 013 464	VTE 18-3 P 2740	6 013 473
VTE 18-3 E 2612	6 013 447	VTE 18-3 F 2612	6 013 456	VTE 18-3 E 2712	6 013 465	VTE 18-3 F 2712	6 013 474
VTE 18-3 E 2640	6 013 449	VTE 18-3 F 2640	6 013 458	VTE 18-3 E 2740	6 013 467	VTE 18-3 F 2740	6 013 476

VTE 18-4 N 2612	6 013 450	VTE 18-4 P 2612	6 013 459	VTE 18-4 N 2712	6 013 468	VTE 18-4 P 2712	6 013 477
VTE 18-4 N 2640	6 013 452	VTE 18-4 P 2640	6 013 461	VTE 18-4 N 2740	6 013 470	VTE 18-4 P 2740	6 013 479

Optical axis: 90°

VTE 18-3 N 2812	6 013 480	VTE 18-3 P 2812	6 013 489	VTE 18-3 N 2912	6 013 498	VTE 18-3 P 2912	6 013 507
VTE 18-3 N 2840	6 013 482	VTE 18-3 P 2840	6 013 491	VTE 18-3 N 2940	6 013 500	VTE 18-3 P 2940	6 013 509
VTE 18-3 E 2812	6 013 483	VTE 18-3 F 2812	6 013 492	VTE 18-3 E 2912	6 013 501	VTE 18-3 F 2912	6 013 510
VTE 18-3 E 2840	6 013 485	VTE 18-3 F 2840	6 013 494	VTE 18-3 E 2940	6 013 503	VTE 18-3 F 2940	6 013 512

VTE 18-4 N 2812	6 013 486	VTE 18-4 P 2812	6 013 495	VTE 18-4 N 2912	6 013 504	VTE 18-4 P 2912	6 013 513
VTE 18-4 N 2840	6 013 488	VTE 18-4 P 2840	6 013 497	VTE 18-4 N 2940	6 013 506	VTE 18-4 P 2940	6 013 515

Operating distance and function reserve

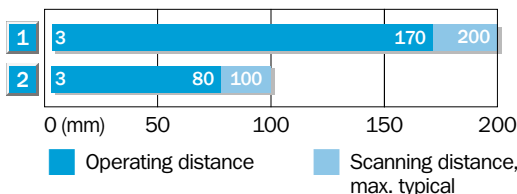

- 1 Scanning range on white, 90 % remission
- 2 Scanning range on black, 6 % remission

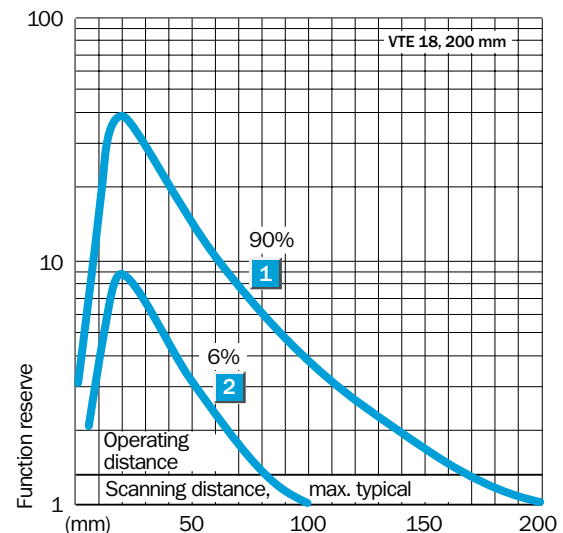

V 18 selection table



VTE 18-3, VTE 18-4 selection table, photoelectric proximity switch, energetic

Switching mode	Connection type
----------------	-----------------

Without sensitivity control				With sensitivity control			
NPN output		PNP output		NPN output		PNP output	
Type	Part no.	Type	Part no.	Type	Part no.	Type	Part no.

Housing material: metal

Optical axis: axial

VTE 18-3 N 4112	6 013 228	VTE 18-3 P 4112	6 013 237	VTE 18-3 N 4212	6 013 246	VTE 18-3 P 4212	6 013 255
VTE 18-3 N 4140	6 013 230	VTE 18-3 P 4140	6 013 239	VTE 18-3 N 4240	6 013 248	VTE 18-3 P 4240	6 013 257
VTE 18-3 E 4112	6 013 231	VTE 18-3 F 4112	6 013 240	VTE 18-3 E 4212	6 013 249	VTE 18-3 F 4212	6 013 258
VTE 18-3 E 4140	6 013 233	VTE 18-3 F 4140	6 013 242	VTE 18-3 E 4240	6 013 251	VTE 18-3 F 4240	6 013 260

VTE 18-4 N 4112	6 013 234	VTE 18-4 P 4112	6 013 243	VTE 18-4 N 4212	6 013 252	VTE 18-4 P 4212	6 013 261
VTE 18-4 N 4140	6 013 236	VTE 18-4 P 4140	6 013 245	VTE 18-4 N 4240	6 013 254	VTE 18-4 P 4240	6 013 263

Optical axis: 90°

VTE 18-3 N 4312	6 013 264	VTE 18-3 P 4312	6 013 273	VTE 18-3 N 4412	6 013 282	VTE 18-3 P 4412	6 013 291
VTE 18-3 N 4340	6 013 266	VTE 18-3 P 4340	6 013 275	VTE 18-3 N 4440	6 013 284	VTE 18-3 P 4440	6 013 293
VTE 18-3 E 4312	6 013 267	VTE 18-3 F 4312	6 013 276	VTE 18-3 E 4412	6 013 285	VTE 18-3 F 4412	6 013 294
VTE 18-3 E 4340	6 013 269	VTE 18-3 F 4340	6 013 278	VTE 18-3 E 4440	6 013 287	VTE 18-3 F 4440	6 013 296

VTE 18-4 N 4312	6 013 270	VTE 18-4 P 4312	6 013 279	VTE 18-4 N 4412	6 013 288	VTE 18-4 P 4412	6 013 297
VTE 18-4 N 4340	6 013 272	VTE 18-4 P 4340	6 013 281	VTE 18-4 N 4440	6 013 290	VTE 18-4 P 4440	6 013 299

Housing material: plastic

Optical axis: axial

VTE 18-3 N 4612	6 013 300	VTE 18-3 P 4612	6 013 309	VTE 18-3 N 4712	6 013 318	VTE 18-3 P 4712	6 013 327
VTE 18-3 N 4640	6 013 302	VTE 18-3 P 4640	6 013 311	VTE 18-3 N 4740	6 013 320	VTE 18-3 P 4740	6 013 329
VTE 18-3 E 4612	6 013 303	VTE 18-3 F 4612	6 013 312	VTE 18-3 E 4712	6 013 321	VTE 18-3 F 4712	6 013 330
VTE 18-3 E 4640	6 013 305	VTE 18-3 F 4640	6 013 314	VTE 18-3 E 4740	6 013 323	VTE 18-3 F 4740	6 013 332

VTE 18-4 N 4612	6 013 306	VTE 18-4 P 4612	6 013 315	VTE 18-4 N 4712	6 013 324	VTE 18-4 P 4712	6 013 333
VTE 18-4 N 4640	6 013 308	VTE 18-4 P 4640	6 013 317	VTE 18-4 N 4740	6 013 326	VTE 18-4 P 4740	6 013 335

Optical axis: 90°

VTE 18-3 N 4812	6 013 336	VTE 18-3 P 4812	6 013 345	VTE 18-3 N 4912	6 013 354	VTE 18-3 P 4912	6 013 363
VTE 18-3 N 4840	6 013 338	VTE 18-3 P 4840	6 013 347	VTE 18-3 N 4940	6 013 356	VTE 18-3 P 4940	6 013 365
VTE 18-3 E 4812	6 013 339	VTE 18-3 F 4812	6 013 348	VTE 18-3 E 4912	6 013 357	VTE 18-3 F 4912	6 013 366
VTE 18-3 E 4840	6 013 341	VTE 18-3 F 4840	6 013 350	VTE 18-3 E 4940	6 013 359	VTE 18-3 F 4940	6 013 368

VTE 18-4 N 4812	6 013 342	VTE 18-4 P 4812	6 013 351	VTE 18-4 N 4912	6 013 360	VTE 18-4 P 4912	6 013 369
VTE 18-4 N 4840	6 013 344	VTE 18-4 P 4840	6 013 353	VTE 18-4 N 4940	6 013 362	VTE 18-4 P 4940	6 013 371

Operating distance and function reserve

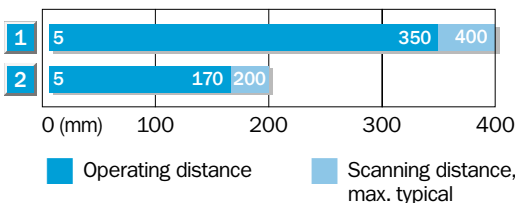

- 1 Scanning range on white, 90 % remission
- 2 Scanning range on black, 6 % remission

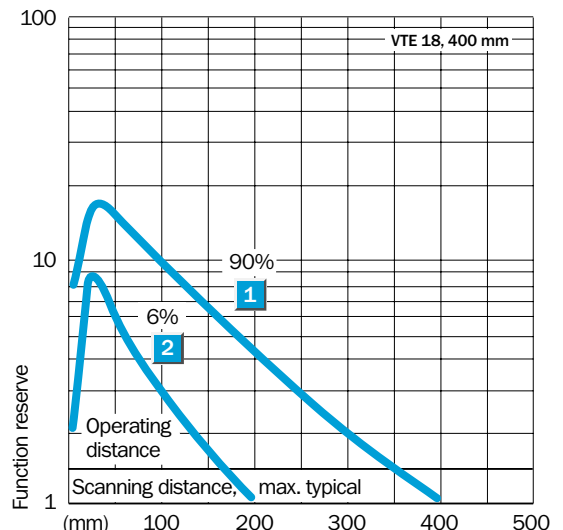

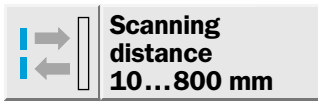

VTE 18-3, VTE 18-4 selection table, photoelectric proximity switch, energetic

Switching mode	Connection type
----------------	-----------------

Without sensitivity control				With sensitivity control			
NPN output		PNP output		NPN output		PNP output	
Type	Part no.	Type	Part no.	Type	Part no.	Type	Part no.

3 wire	
VTE 18-3 Q = D.ON	Cable 2 m M 12 plug, 4-pin
VTE 18-3 Q = L.ON	Cable 2 m M 12 plug, 4-pin

Housing material: metal							
Optical axis: axial							
VTE 18-3 N 8112	6 013 084	VTE 18-3 P 8112	6 013 093	VTE 18-3 N 8212	6 013 102	VTE 18-3 P 8212	6 013 111
VTE 18-3 N 8140	6 013 086	VTE 18-3 P 8140	6 013 095	VTE 18-3 N 8240	6 013 104	VTE 18-3 P 8240	6 013 113
VTE 18-3 E 8112	6 013 087	VTE 18-3 F 8112	6 013 096	VTE 18-3 E 8212	6 013 105	VTE 18-3 F 8212	6 013 114
VTE 18-3 E 8140	6 013 089	VTE 18-3 F 8140	6 013 098	VTE 18-3 E 8240	6 013 107	VTE 18-3 F 8240	6 013 116

4 wire, L/D control wire	
VTE 18-4 L.ON/D.ON	Cable 2 m M 12 plug, 4-pin

VTE 18-4 N 8112	6 013 090	VTE 18-4 P 8112	6 013 099	VTE 18-4 N 8212	6 013 108	VTE 18-4 P 8212	6 013 117
VTE 18-4 N 8140	6 013 092	VTE 18-4 P 8140	6 013 101	VTE 18-4 N 8240	6 013 110	VTE 18-4 P 8240	6 013 119

3 wire	
VTE 18-3 Q = D.ON	Cable 2 m M 12 plug, 4-pin
VTE 18-3 Q = L.ON	Cable 2 m M 12 plug, 4-pin

Optical axis: 90°							
VTE 18-3 N 8312	6 013 120	VTE 18-3 P 8312	6 013 129	VTE 18-3 N 8412	6 013 138	VTE 18-3 P 8412	6 013 147
VTE 18-3 N 8340	6 013 122	VTE 18-3 P 8340	6 013 131	VTE 18-3 N 8440	6 013 140	VTE 18-3 P 8440	6 013 149
VTE 18-3 E 8312	6 013 123	VTE 18-3 F 8312	6 013 132	VTE 18-3 E 8412	6 013 141	VTE 18-3 F 8412	6 013 150
VTE 18-3 E 8340	6 013 125	VTE 18-3 F 8340	6 013 134	VTE 18-3 E 8440	6 013 143	VTE 18-3 F 8440	6 013 152

4 wire, L/D control wire	
VTE 18-4 L.ON/D.ON	Cable 2 m M 12 plug, 4-pin

VTE 18-4 N 8312	6 013 126	VTE 18-4 P 8312	6 013 135	VTE 18-4 N 8412	6 013 144	VTE 18-4 P 8412	6 013 153
VTE 18-4 N 8340	6 013 128	VTE 18-4 P 8340	6 013 137	VTE 18-4 N 8440	6 013 146	VTE 18-4 P 8440	6 013 155

3 wire	
VTE 18-3 Q = D.ON	Cable 2 m M 12 plug, 4-pin
VTE 18-3 Q = L.ON	Cable 2 m M 12 plug, 4-pin

Housing material: plastic							
Optical axis: axial							
VTE 18-3 N 8612	6 013 156	VTE 18-3 P 8612	6 013 165	VTE 18-3 N 8712	6 013 174	VTE 18-3 P 8712	6 013 183
VTE 18-3 N 8640	6 013 158	VTE 18-3 P 8640	6 013 167	VTE 18-3 N 8740	6 013 176	VTE 18-3 P 8740	6 013 185
VTE 18-3 E 8612	6 013 159	VTE 18-3 F 8612	6 013 168	VTE 18-3 E 8712	6 013 177	VTE 18-3 F 8712	6 013 186
VTE 18-3 E 8640	6 013 161	VTE 18-3 F 8640	6 013 170	VTE 18-3 E 8740	6 013 179	VTE 18-3 F 8740	6 013 188

4 wire, L/D control wire	
VTE 18-4 L.ON/D.ON	Cable 2 m M 12 plug, 4-pin

VTE 18-4 N 8612	6 013 162	VTE 18-4 P 8612	6 013 171	VTE 18-4 N 8712	6 013 180	VTE 18-4 P 8712	6 013 189
VTE 18-4 N 8640	6 013 164	VTE 18-4 P 8640	6 013 173	VTE 18-4 N 8740	6 013 182	VTE 18-4 P 8740	6 013 191

3 wire	
VTE 18-3 Q = D.ON	Cable 2 m M 12 plug, 4-pin
VTE 18-3 Q = L.ON	Cable 2 m M 12 plug, 4-pin

Optical axis: 90°							
VTE 18-3 N 8812	6 013 192	VTE 18-3 P 8812	6 013 201	VTE 18-3 N 8912	6 013 210	VTE 18-3 P 8912	6 013 219
VTE 18-3 N 8840	6 013 194	VTE 18-3 P 8840	6 013 203	VTE 18-3 N 8940	6 013 212	VTE 18-3 P 8940	6 013 221
VTE 18-3 E 8812	6 013 195	VTE 18-3 F 8812	6 013 204	VTE 18-3 E 8912	6 013 213	VTE 18-3 F 8912	6 013 222
VTE 18-3 E 8840	6 013 197	VTE 18-3 F 8840	6 013 206	VTE 18-3 E 8940	6 013 215	VTE 18-3 F 8940	6 013 224

4 wire, L/D control wire	
VTE 18-4 L.ON/D.ON	Cable 2 m M 12 plug, 4-pin

VTE 18-4 N 8812	6 013 198	VTE 18-4 P 8812	6 013 207	VTE 18-4 N 8912	6 013 216	VTE 18-4 P 8912	6 013 225
VTE 18-4 N 8840	6 013 200	VTE 18-4 P 8840	6 013 209	VTE 18-4 N 8940	6 013 218	VTE 18-4 P 8940	6 013 227

Operating distance and function reserve

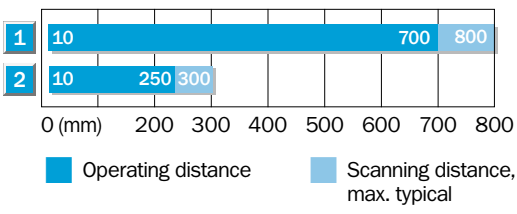

- 1 Scanning range on white, 90 % remission
- 2 Scanning range on black, 6 % remission

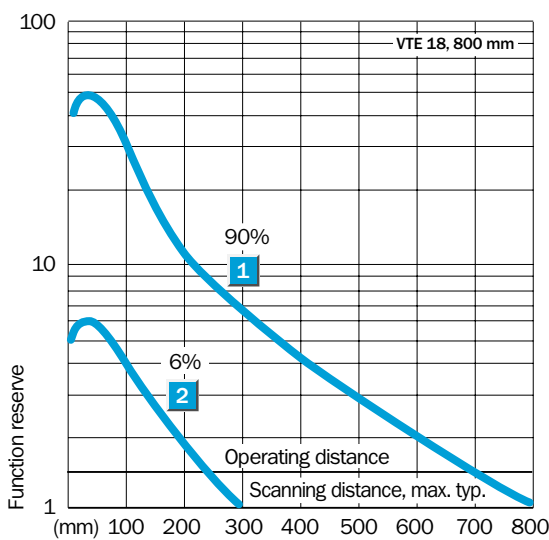



Scanning distance
100/200/400 mm

Photoelectric proximity switch

- Photoelectric proximity switch, energetic, 3 scanning ranges can be selected: 100 mm, 200 mm or 400 mm
- Voltage supply 20...253 V AC; triac switching output
- Cable or plug M 12, 4-pin

Dimensional drawing

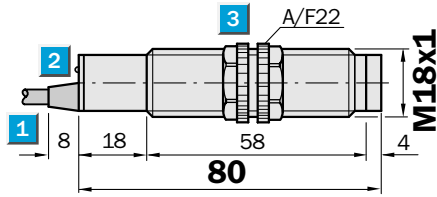
VT 18-2T 1112
VT 18-2T 1132
VT 18-2T 1152



VT 18-2T 1410
VT 18-2T 1430
VT 18-2T 1450

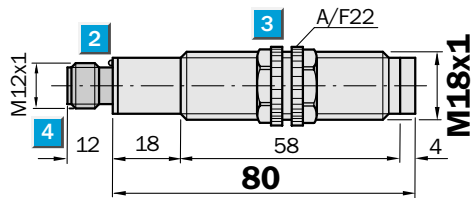

- 1** Connecting cable
- 2** Signal strength indicator
- 3** Fastening nuts, width across 22 mm, (included)
- 4** Equipment plug M 12, 4-pin



Connection types

VT 18-2T 1112	VT 18-2T 1410
VT 18-2T 1132	VT 18-2T 1430
VT 18-2T 1152	VT 18-2T 1450

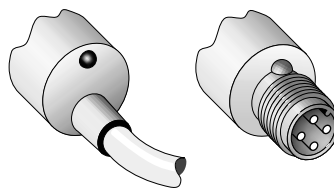

Accessories	page
Cable receptacle	496
Mounting brackets	510

3 x 0.34 mm ²	4-pin, M 12
--------------------------	-------------

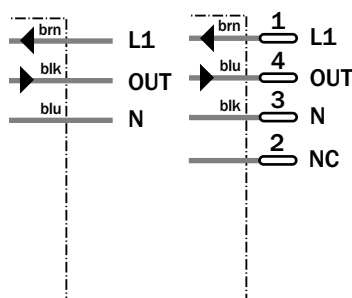

Technical data		VT 18-2T	1112	1410	1132	1430	1152	1450				
Housing	Straight											
Scanning distance , max. typical	2 mm... 100 mm ¹⁾											
Recommended operating distance	3 mm... 90 mm ¹⁾											
Light source ²⁾ , light type	LED, infrared light											
Light spot diameter	Approx. 12 mm at 100 mm											
Angle of dispersion of sender	Approx. 3.5°											
Scanning distance , max. typical	2 mm... 200 mm ¹⁾											
Recommended operating distance	3 mm... 180 mm ¹⁾											
Light source ²⁾ , light type	LED, infrared light											
Light spot diameter	Approx. 24 mm at 200 mm											
Angle of dispersion of sender	Approx. 3.5°											
Scanning distance , max. typical	2 mm... 400 mm ¹⁾											
Recommended operating distance	3 mm... 360 mm ¹⁾											
Emetteur ²⁾ , type	LED, infrared light											
Light spot diameter	Approx. 48 mm at 400 mm											
Angle of dispersion of sender	Approx. 3.5°											
Supply voltage V _S ³⁾	20... 253 V AC/50... 60 Hz											
Current consumption ⁴⁾	≤ 30 mA											
Switching output	TRIAC											
Switching current I _A max.	5... 300 mA											
voltage drop	3 V max. (U = 250 V AC)											
max. switching current	6 A/10 ms; f = 10 Hz											
leakage current	max. 1.5 mA (V _S = 250 V AC)											
Switching voltage	V _S											
Light receiver, switching mode	Light-switching											
Response time ⁵⁾	≤ 20 ms											
Max. switching frequency ⁶⁾	25/s											
Connection types cable	PVC, 2 m ⁷⁾ ; 3 x 0.34 mm ² , ∅ 4.7 mm											
plug	M 12, 4-pin											
VDE protection class ⁸⁾	□											
Circuit protection ⁹⁾	C											
Enclosure rating	IP 67											
Ambient temperature T _A	- 25 °C... + 70 °C											
Weight with connection cable	Approx. 95 g											
with equipment plug	Approx. 30 g											
Housing material	Housing: PBT/PC; optic: PMMA											

- 1) Object with 90 % reflectance (referred to standard white DIN 5033)
- 2) Average service life 100,000 h at T_A = + 25 °C

- 3) Limit values
- 4) Without load
- 5) With resistive load
- 6) With light/dark ratio 1:1

- 7) Do not bend below 0 °C
- 8) Reference voltage 250 V AC
- 9) C = Interference suppression

Scanning distance

Scanning distance 100 mm

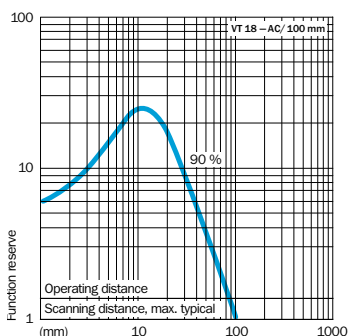

Scanning distance 200 mm

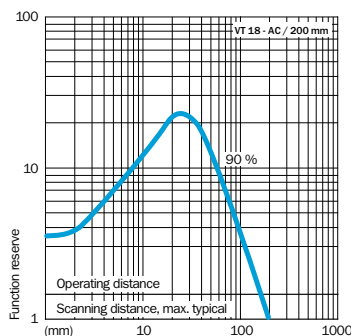

Scanning distance 400 mm

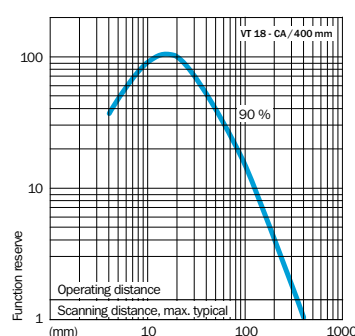

Order information

Type	Part no.
VT 18-2T 1112	6 011 370
VT 18-2T 1410	6 011 373
VT 18-2T 1132	6 011 371
VT 18-2T 1430	6 011 374
VT 18-2T 1152	6 011 372
VT 18-2T 1450	6 011 375

X-ON Electronics

Largest Supplier of Electrical and Electronic Components

Click to view similar products for [Photoelectric Sensors](#) category:

Click to view products by [Sick](#) manufacturer:

Other Similar products are found below :

[E3JM-DS70R4T-US](#) [E3L2DC4](#) [E3RA-DN12 2M](#) [E3RA-DP12 2M](#) [E3S5LE4S](#) [E3S-AD38](#) [E3S-CR11 5M](#) [E3SCT11D5M](#) [E3SCT11M1J03M](#)
[E3T-SL14R](#) [E3T-SL24 5M](#) [E3T-ST12R](#) [E3X-CN02](#) [E3X-CN11 5M](#) [E3X-CN21 10M](#) [E3ZM-B66](#) [E3ZM-CL81H 2M](#) [E3Z-T62 2M](#)
[NJL5303R-TE1](#) [PB10CNT15PO](#) [PD60CNX20BP](#) [CX-491-P-J](#) [CX-491-Z](#) [XUM2BKCNL2T](#) [XUM2BKCNL2T](#) [XUM2BNANL2R](#) [Y92E-](#)
[ES30M](#) [Y92E-GS08SS](#) [ZXTDS04T](#) [ZX-XC4A 4M](#) [E3E23Y2US](#) [E3JM-DS70S4-US](#) [E3RA-RN11 2M](#) [E3S5LE42M](#) [E3S-LS20XB4 5M](#)
[E3TFD14N](#) [E3T-FD14R](#) [E3T-SL21 5M](#) [E3T-SL21M](#) [E3T-ST11R](#) [E3T-ST12 5M](#) [E3X-DA41-S-M1J 0.3M](#) [E3X-DAB6](#) [E3X-DAG8](#) [E3ZM-](#)
[B86](#) [E3ZM-CR81 2M](#) [E3ZM-CR86](#) [E3Z-T61A-L 2M](#) [ZX-XGC2R](#) [ZX-XB1A](#)