

Encapsulated autotransformer, IP20

Type LFA

Single-phase short circuit proof autotransformer designed and tested according to EN61558-2-13. Portable design. Insulated windings moulded in self extinguishing Polyurethane and capsulated in plastic.

For fixed installation, simple and easy mounting. Short circuit protected with glass tube fuse and overload protected with "cut out" fuse on primary side.

Applications:

Portable transformer for changing system voltage from 230 Volts to 115 Volts or vice versa.

Technical specifications

- Input voltage: 115V, 230V
- Frequency: 230V, 115V
- Output voltage: 50-60 Hz
230V, 115V
- According to: EN61558-2-13
- Test/insulating voltage: 2kV AC RMS
- Construction class: II
- Insulation class: B (130°C)
- Ambient temp. (t_a): 40°C
- Degree of protection: IP20

Wiring diagram

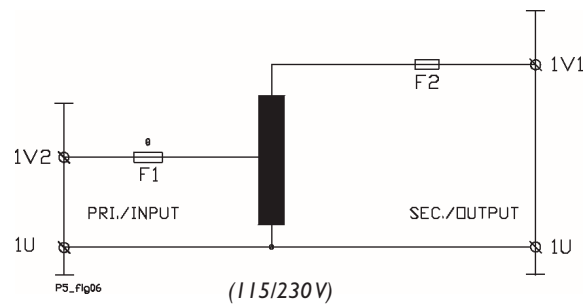
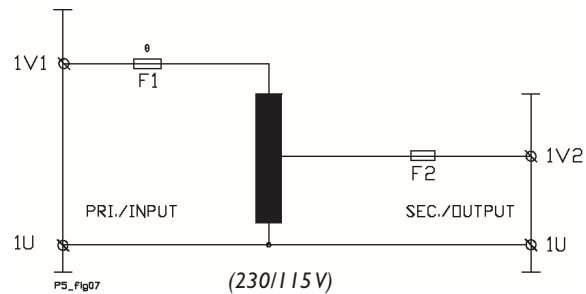

Dimensions

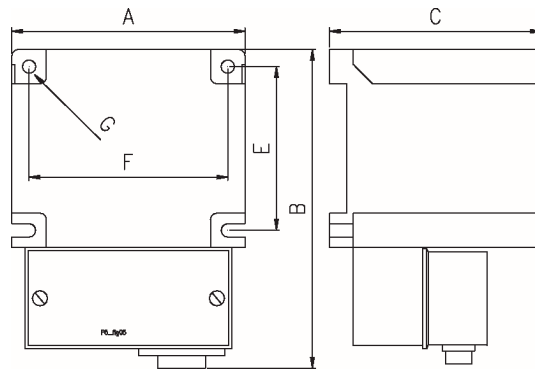

Type	Voltage Pri. (V)	Voltage Sec. (A)	Current (A)	Power (VA)	Dimensions AxBxC (mm)	Weight (Kg)	Art. no.
230/115V							
LFA36-01	230	115	0,609	70	66x93x59	1,2	4-058-120071
LFA157-01	230	115	2,09	240	92x130x87	2,6	4-058-120241
LFA179-01	230	115	4,17	480	106x153x98	4,2	4-058-120481
LFA193-01	230	115	8,35	960	130x202x115	7,8	4-058-121001
LFA218-01	230	115	15	1720	162x235x140	15,1	4-058-121801
115/230V							
LFA150-04	115	230	0,65	150	83x108x78	1,8	4-058-120154
LFA157-04	115	230	1,04	240	92x130x87	2,6	4-058-120244
LFA179-04	115	230	2,09	480	106x153x98	4,2	4-058-120484
LFA193-04	115	230	4,17	960	130x202x115	7,8	4-058-121004
LFA218-04	115	230	7,4	1700	162x235x140	15,1	4-058-121804

X-ON Electronics

Largest Supplier of Electrical and Electronic Components

Click to view similar products for [Autotransformers](#) category:

Click to view products by [Noratel](#) manufacturer:

Other Similar products are found below :

[ARM-2.0/3](#) [ESS 104](#) [ESS 120](#) [ARM-3.0/1](#) [ARM-5.0/1](#) [ATS1000VA-230/110V U](#) [ATS1500VA-230/110V U](#) [ATS1500VA-230/110V U+UMS](#) [ATS200VA-230/110V](#) [ATS300VA-230/110V](#) [ATS50VA-230/110V](#) [ATS600VA-230/110V](#) [TS50-230V/115V-001](#) [TS90-230V/115V-002](#) [VP-500VA](#) [OIEA1](#) [OIEA15](#) [OIEA3](#) [OIEA8](#) [VP-2000VA](#) [VP-1000VA](#) [N-1000MG](#) [N-3MG](#) [N-5MG](#) [N-6U](#) [N-150MG](#) [N-2X](#) [N-9MG](#) [110-0F](#) [120-0F](#) [1150-0F](#) [1100-0F](#) [130-0F](#) [125-0F](#) [175-0F](#) [150-0F](#) [115-0F](#) [112-0F](#) [ATS100-230V/115V-001](#) [ATS25-230V/115V-001](#) [ATST1000-230V/115V-001](#) [ATST1000-230V/115V-002](#) [ATST100-230V/115V-001](#) [ATST100-230V/115V-002](#) [ATST1500-230V/115V-002](#) [ATST2000-230V/115V-001](#) [ATST2000-230V/115V-002](#) [ATST200-230V/115V-001](#) [ATST3000-230V/115V-001](#) [ATST3000-230V/115V-002](#)