

**M12-Receptacle Connectors In Accordance With IEC 61076-2-101**

PRSFM/0.5 M | PRKFM/0.5 M



**Male, 4-, 5- and 8-Pole**

M12 Receptacle connector, M12 male connector for front mounting, housing of stainless steel, assembled stranded wire, solder contacts potted with epoxy, chassis side thread M16 x 1.5 (panel nut RSKFM 16)

– especially designed for use in food processing equipment –

**PRSFM/0.5 M**

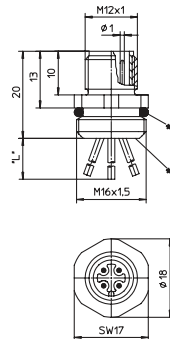

\*a O-ring enclosed separately  
\*b solder contacts potted with epoxy  
\*L\*0.5 m



**Female, 4-, 5- and 8-Pole**

M12 Receptacle connector, M12 female connector for front mounting, housing of stainless steel, assembled stranded wire, solder contacts potted with epoxy, chassis side thread M16 x 1.5 (panel nut RSKFM 16)

– especially designed for use in food processing equipment –

**PRKFM/0.5 M**

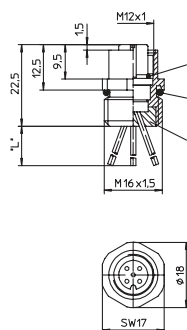

\*a O-Ring  
\*b O-ring enclosed separately  
\*c solder contacts potted with epoxy  
\*L\*0.5 m

**Pin Assignments**

Face Views / M12, Male / Female

**4 pole**

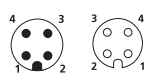

1 = brown  
2 = white  
3 = blue  
4 = black

**5 pole**

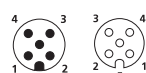

1 = brown  
2 = white  
3 = blue  
4 = black  
5 = green/yellow

**8 pole**

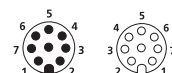

1 = white  
2 = brown  
3 = green  
4 = yellow  
5 = grey  
6 = pink  
7 = blue  
8 = red



Be Certain with Belden

**M12-Receptacle Connectors In Accordance With IEC 61076-2-101**  
 PRSFM/0.5 M | PRKFM/0.5 M

**Technical Data**

**Environmental**







Degree of protection IP 67 / NEMA 6P  
 Operating temperature range -25°C (-13°F) / +70°C (+158°F)

**Mechanical**

Housing / Molded body stainless steel  
 Insert PBT  
 Contact CuZn, pre-nickel and 0.8 microns gold-plated  
 O-ring EPDM

**Electrical**

Contact resistance ≤ 5 mΩ  
 Nominal current at 40°C 4–5 poles 4 A  
 8 poles 2 A  
 Nominal voltage 4 poles 240 V  
 5 poles 60 V  
 8 poles 30 V  
 Rated voltage 4 poles 250 V  
 5 poles 63 V  
 8 poles 36 V  
 Test voltage 4 poles 2.0 kV eff. / 60 s  
 5–8 poles 1.5 kV eff. / 60 s  
 Insulation resistance > 10<sup>9</sup> Ω  
 Pollution degree 3

Part Number	Pins	Lead (mm <sup>2</sup> )	Characteristics
PRSFM 4/0,5 M    PRKFM 4/0,5 M	3	0.34 (22 AWG)	 
PRSFM 5/0,5 M    PRKFM 5/0,5 M	5	1 x 0.5 / 4 x AWG 22	 
PRSFM 8/0,5 M    PRKFM 8/0,5 M	8	0.22 (24 AWG)	 

## X-ON Electronics

Largest Supplier of Electrical and Electronic Components

*Click to view similar products for [Standard Circular Connector](#) category:*

*Click to view products by [Lumberg](#) manufacturer:*

Other Similar products are found below :

[C015 10F006 001 1](#) [5M2530B10P](#) [600247N007](#) [600259N006](#) [600273N007](#) [600432N009](#) [6280-2PG-519](#) [6280-3PG-311](#) [6280-3SG-311](#)  
[6280-7SG-3DC](#) [6280-7SG-522](#) [6282-5PG-311](#) [6282-6PG-519](#) [6282-8SG-311](#) [6283-11](#) [6283-15](#) [6290](#) [6293](#) [6382-2PG-311](#) [6382-2PG-3DC](#)  
[6382-2SG-321](#) [6382-2SG-3DC](#) [6382-4SG-516](#) [67-03E20-37P](#) [681-PMG](#) [CXS3102A14S2P](#) [CXS3102A181S](#) [CXS3106A14S6S](#)  
[D38999/20FC8SA L/C](#) [MB12P-1](#) [MB12R-6](#) [7251-2PG-300](#) [7251-2SG-300](#) [7251-4PG-300](#) [7251-4SG-300](#) [7251-5PG-300](#) [7251-5SG-300](#)  
[7251-6SG-300](#) [7251-7PG-300](#) [7251-8PG-300](#) [7271-6SG-300](#) [7282-3PG-300-CH3](#) [73000005663](#) [75-190011-03P](#) [75-190216-08S](#) [75-190218-](#)  
[10P](#) [75-214636-52P](#) [75-474118-10P](#) [75-474211-03P](#) [75-474218-19S](#)