

DETAILS

Product Number	FCA14405_G2-NIS033U-M
Family	Rose
Type	Assembly
Color	black
Diameter	21,6 + 21,6 mm
Height	12,9 mm
Style	square
Optic Material	Silicone
Holder Material	PC
Fastening	tape
Status	ready
ROHS Compliant	Yes
Date Updated	14/09/2015



OPTICAL PROPERTIES

LED	Viewing	Light	Effi-		Connector
	Angle	Beam	ciency	cd/lm	
NCSU034B	21 deg	Medium	93 %	sim: 0.000	-
NCSU033B	24 deg	Medium	sim: 93 %	sim: 0.000	-
NC4U133A	25 deg	Medium	90 %	sim: 0.000	-
6868 4in1 (UV)	25 deg	Medium	-	sim: 0.000	-
NC4U134A	27 deg	Medium	90 %	sim: 0.000	-

Relative intensity of FCA14405_G2-NIS033U-M_(NCS

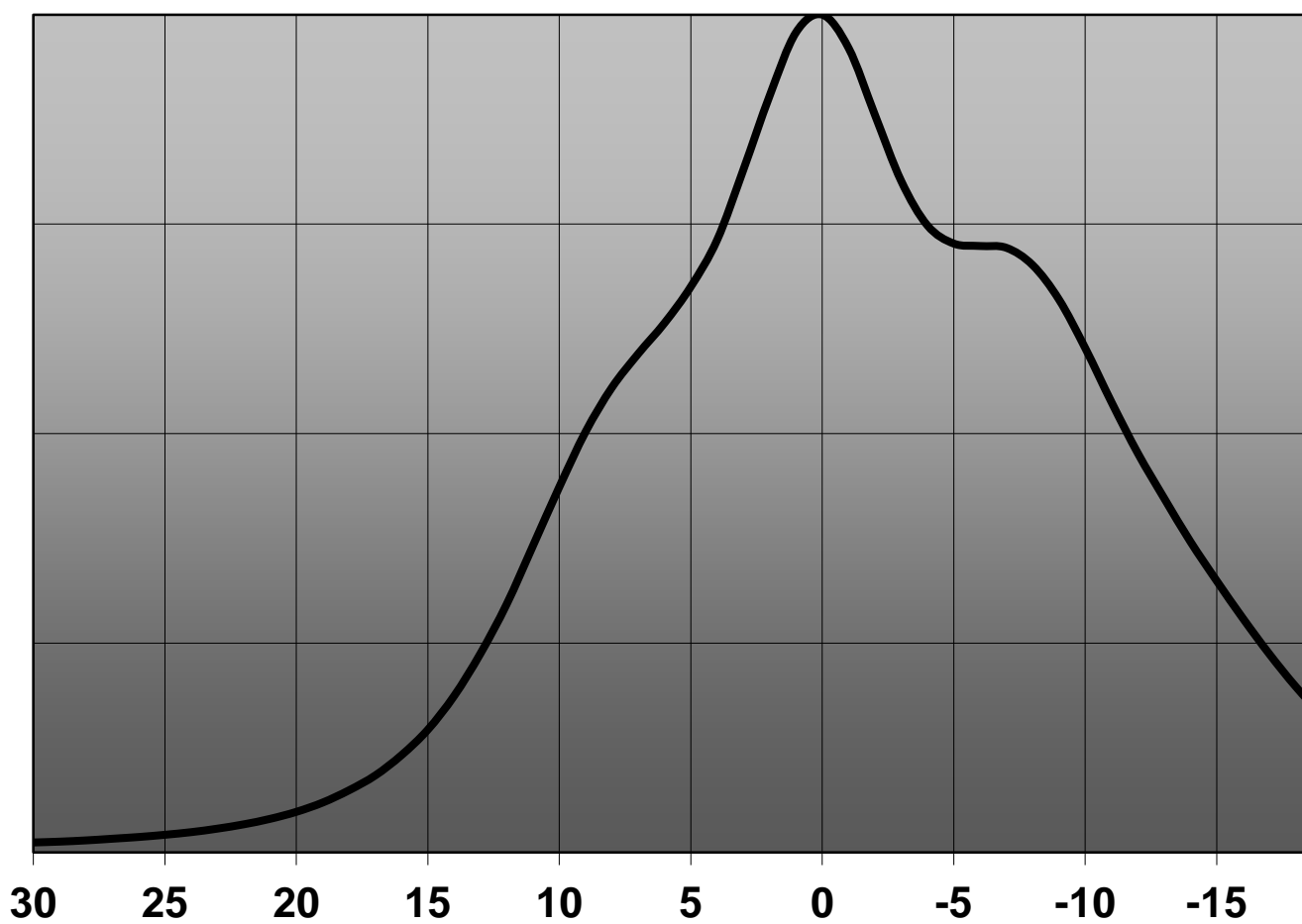

—1

Relative intensity of FCA14405_G2-NIS033U-M_(N

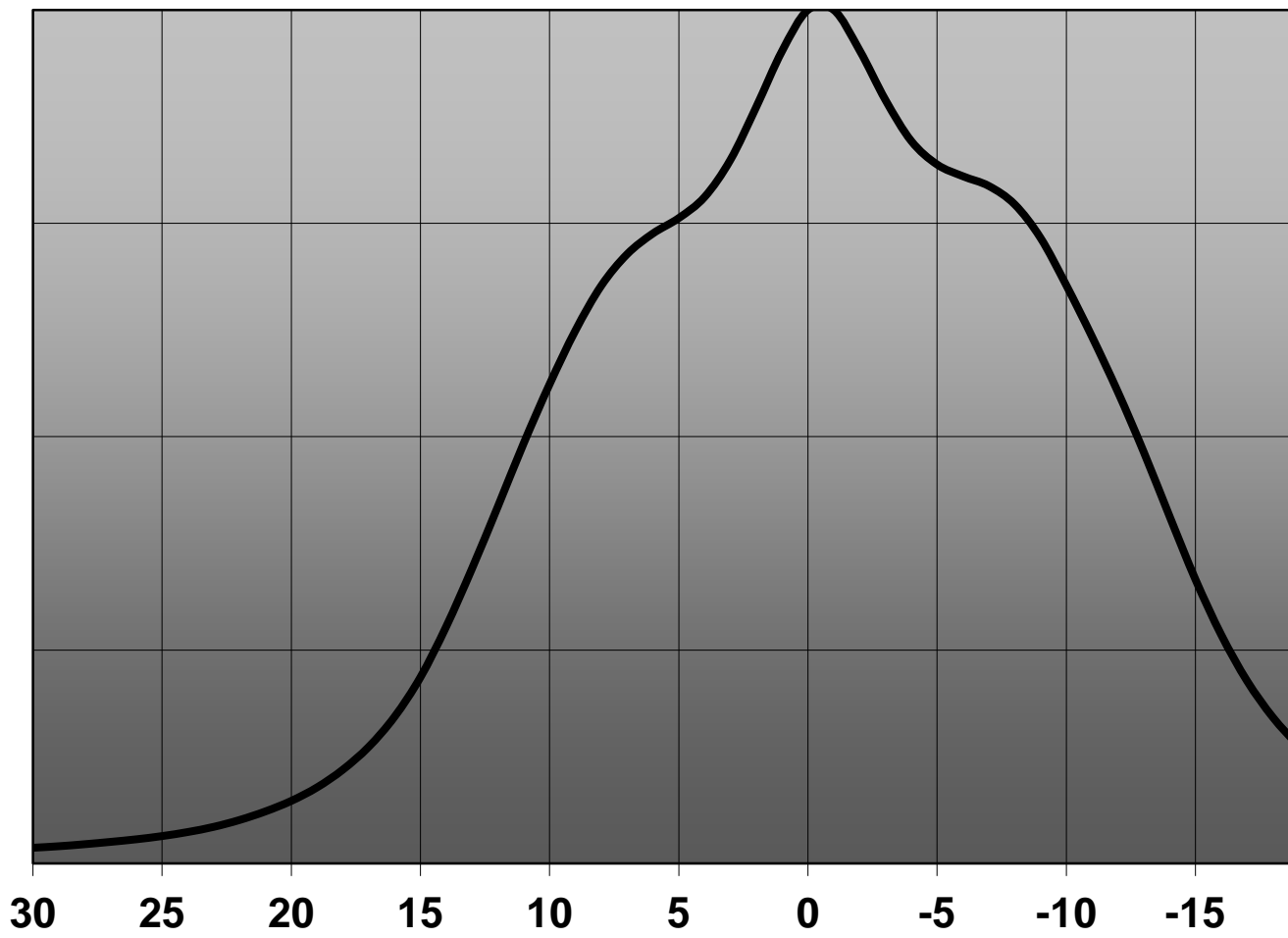

Relative intensity of FCA14405_G2-NIS033U-M_(NC4U

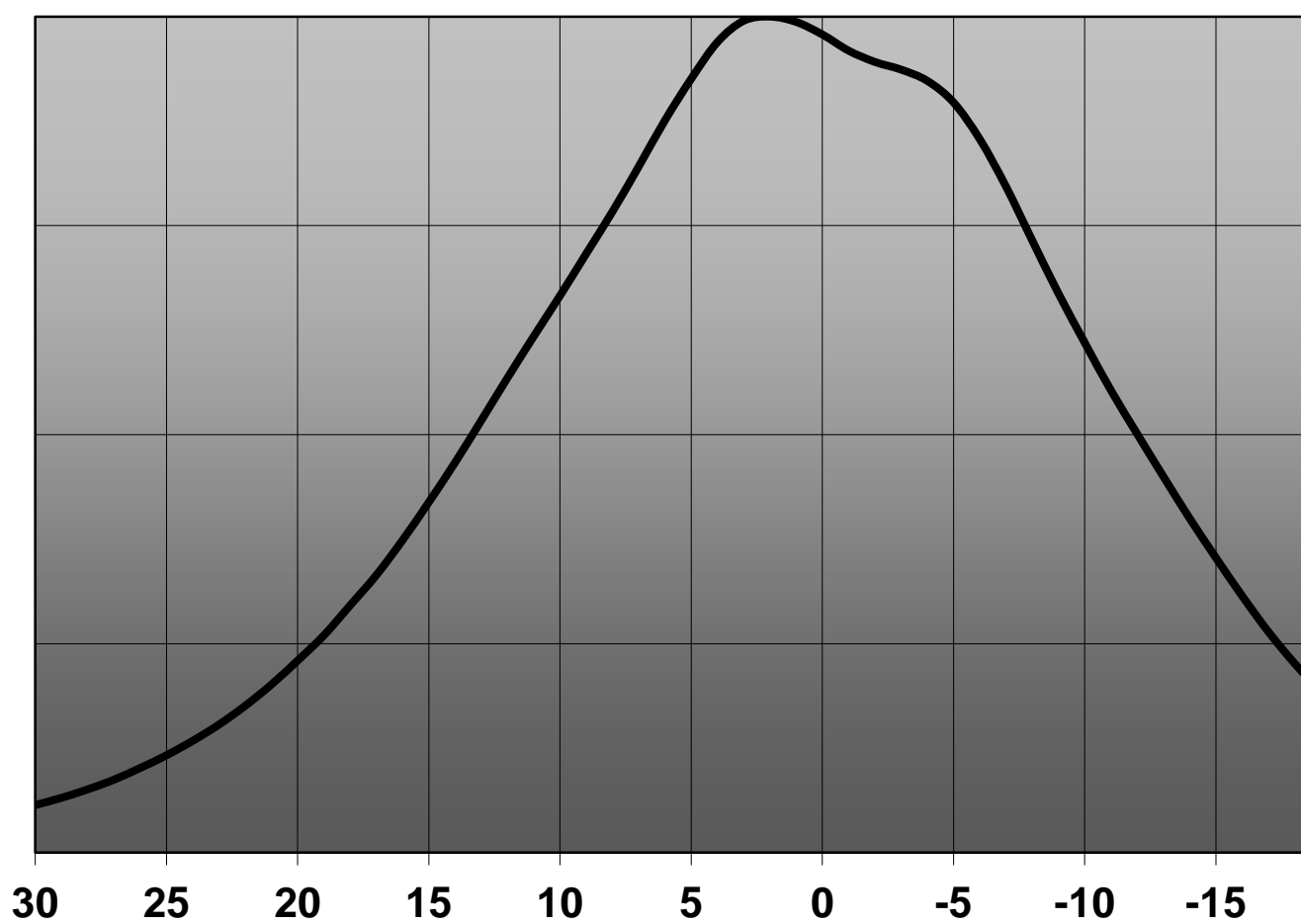

—1

Relative intensity of FCA14405_G2-NIS033U-M_LG_686

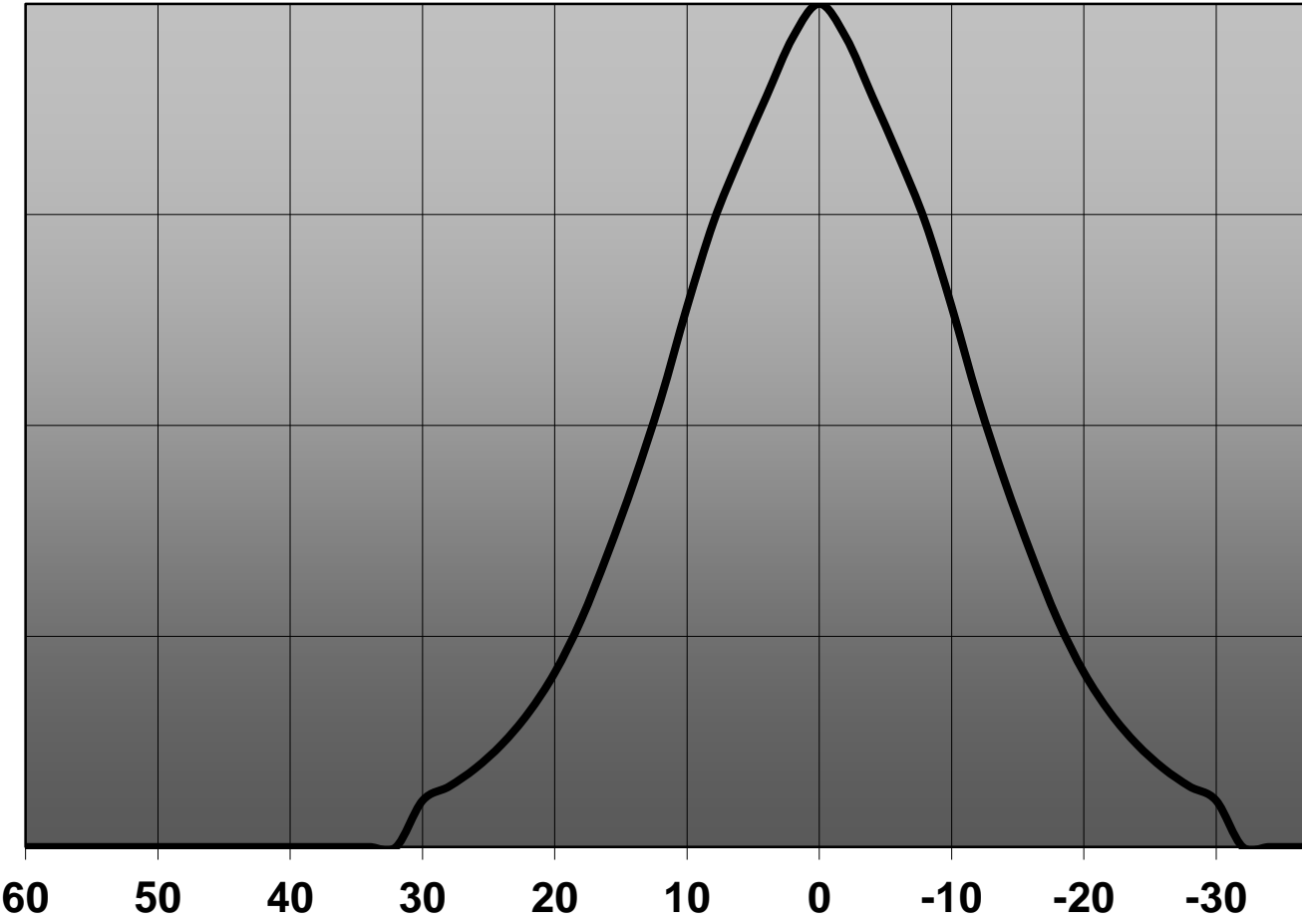

— 0,041 W/m² @ 100mA

Relative intensity of FCA14405_G2-NIS033U-M_(NC4

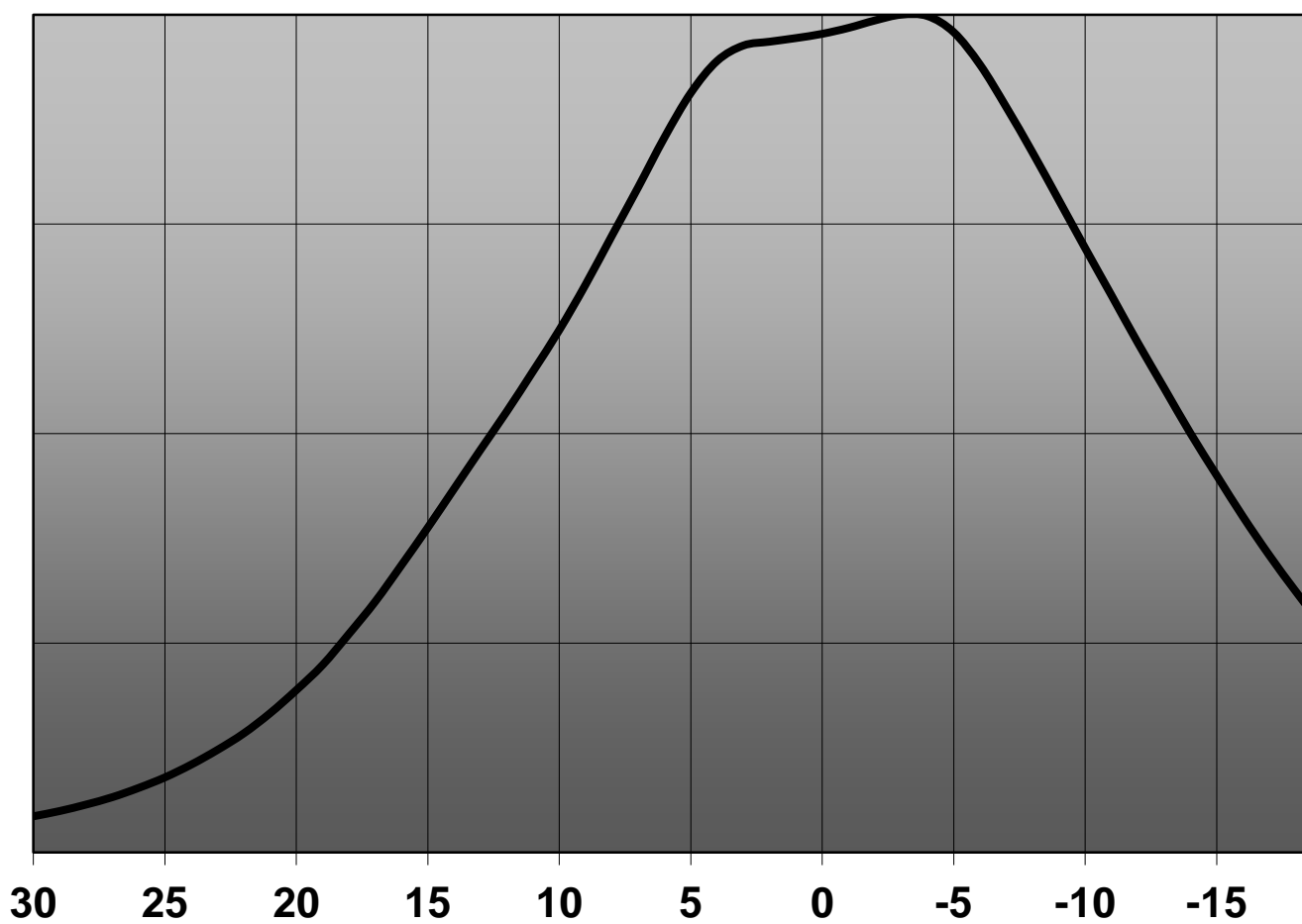

—1

H G F E

4

0.4
(fixing tape)

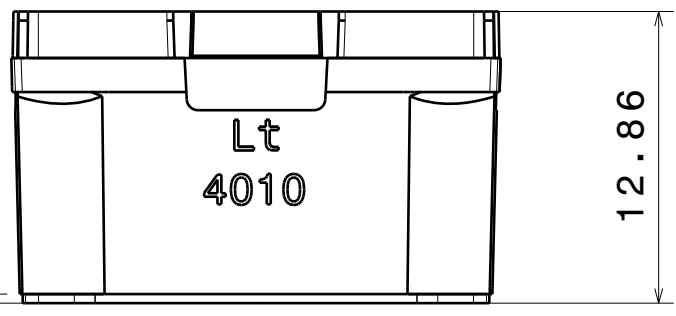

3

A

21.57

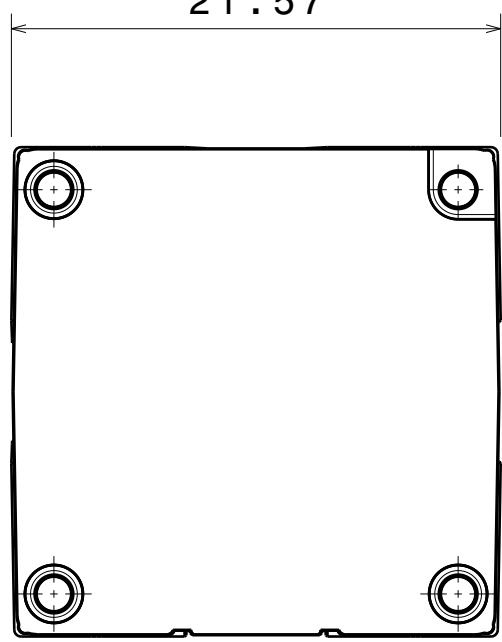

2

6.91

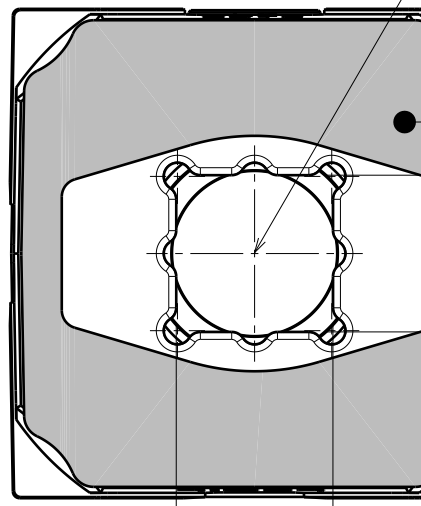

Direction A

1

H G

NOTE: The typical divergence will be changed by different color, chip size and chip position tolerance. The typical total divergence is the full angle measured where the luminous intensity is half of the peak value.

GENERAL INFORMATION

- Product series especially designed & optimized for series of LEDs.
- Special care taken to make light distribution as uniform as possible.
- Fastening to heat sink with a PU foam adhesive tape of automotive grade. Please find fastening details by clicking link: http://www.ledil.com/datasheets/DataSheet_TAPE.pdf

NOTE 1: We advise customer to ensure the suitability and sufficiency of the bond in the end product. For example, mechanical stress, vibration and holes on the surface of the circuit board weaken the strength of the tape.

NOTE 2: Assembly to the surface must be made straight, so the tape bonds constant and balanced with fastening surface. Slanted assembly might cause unbalanced bond to the surface. All surfaces where tape is applied must be clean, dry and free from grease and dirt.

If cleaning of PCB surfaces is needed, please follow strictly the cleaning instructions of your LED manufacturer - this is important as cleaning shall under no circumstances damage LEDs or other electronics components on the PCB.

Further note that optical components shall not be cleaned with any chemicals - only micro fiber cloth may be used to remove fingerprints or other traces from handling.

X-ON Electronics

Largest Supplier of Electrical and Electronic Components

Click to view similar products for [Complete Assemblies for Panel Mount Indicator Lamps](#) category:

Click to view products by [Ledil](#) manufacturer:

Other Similar products are found below :

[177-8430-0932-503](#) [250-7558-3331-504](#) [177-8430-0931-503](#) [249-7841-0937-574](#) [270-1930-0272-702](#) [367-8430-0933-503](#) [367-8430-0931-503](#) [367-8430-0973-503](#) [450-01RB](#) [803-1710-0333-805](#) [39-1752-24](#) [50-2101CR](#) [39-5644-05](#) [50-682SF](#) [803-1710-0333-504](#) [19-3206-05-303](#) [50-2100LN](#) [249-7841-1433-574](#) [LC12CN2](#) [50-2100MR](#) [1132937200](#) [13788360931552](#) [095042809201](#) [13788360937552](#) [0510111303](#) [0510135203](#) [24978661435514](#) [27018300171702](#) [27019300111702](#) [27018300111702](#) [27019303111702](#) [80317100337504](#) [80417100333504](#) [80317100332804](#) [930404X724WN](#) [047-0901-2900-201](#) [051-3502-0137-203](#) [103-3527-05-103](#) [249-7841-0933-544](#) [249-7841-0933-574](#) [249-7841-0935-574](#) [249-7841-1433-544](#) [249-7841-1435-574](#) [249-7841-1436-574](#) [249-7841-1437-544](#) [249-7841-1437-574](#) [249-7866-0331-514](#) [249-7866-0931-514](#) [249-7866-1433-514](#) [249-7866-1437-514](#)