

TERMINAL BLOCKS

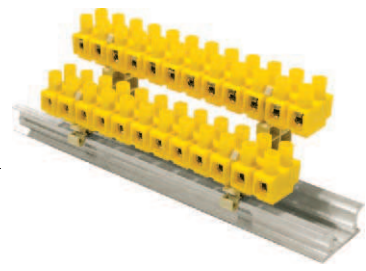
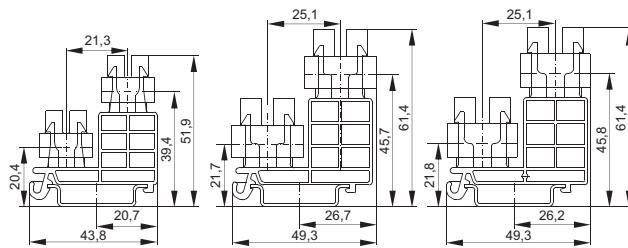

P2, ZKU, ZKR

TYPE	P2-4N	P2-10N	P2-16N
Catalogue number	45-272	45-274	45-276
Colour	yellow-1 ● white-2 ○ black-3 ● grey-8 ●	yellow-1 ● white-2 ○ black-3 ● grey-8 ●	yellow-1 ● white-2 ○ black-3 ● grey-8 ●
Use	TLZ-4N on TS35 rail assembly	TLZ-10N on TS35 rail assembly	TLZ-16N on TS35 rail assembly
Insulating material	polyamide	polyamide	polyamide
Ambient temperature	-25...+100°C	-25...+100°C	-25...+100°C
Package	10pcs.	10pcs.	10pcs.

ZKU complete short-circuiting connectors

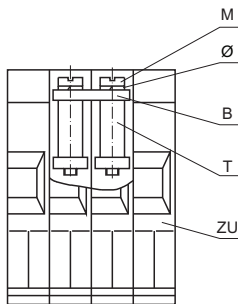

- B - bar
- T - sleeve
- Ø - spring washer
- M - screw
- ZU - terminal

A complete short-circuiting connector is used for short-circuiting current circuits of the ZUG-G and ZG-G thread terminal blocks installed on the TS mounting rails. The ZKM short-circuiting connector is used for short circuiting the current circuits of the BM terminal blocks.

ZKR-10 complete, movable short-circuiting connectors

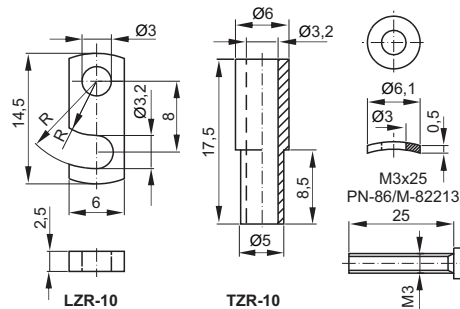

The short circuiting connector fits the terminals ZUG-G10, ZUG-G/P, ZUG-G/PG, ZUG-G/D, ZUG-G/DG. Package: 50pcs.

ZKU complete short-circuiting connectors

The type of the complete short-circuiting connector depends on the number of terminal blocks, e.g. ZKU4/2 is used for short circuiting two adjacent ZUG-G4 terminal blocks. ZKU-10/5 is a short circuiting connector for five ZUG-G10 terminal blocks. Material - copper.



No. of short circuited lines

Size		2,5	4	10	16	25	35	70	120	ZKM	ZKR
Type	2	ZKU-2,5/2	ZKU-4/2	ZKU-10/2	ZKU-16/2	ZKU-25/2	ZKU-35/2	ZKU-70/2	ZKU-120/2	ZKM-4/2	ZKR-10
Catalogue number		42-0020	42-0120	42-0220	42-0320	42-0420	42-0520	42-0620	42-0720	42-1120	42-2290
Package		50	50	50	50	20	20	10	5	50	50
Type	3	ZKU-2,5/3	ZKU-4/3	ZKU-10/3	ZKU-16/3	ZKU-25/3	ZKU-35/3	—	—	ZKM-4/3	—
Catalogue number		42-0030	42-0130	42-0230	42-0330	42-0430	42-0530	—	—	42-1130	—
Package		25	25	25	25	10	10	—	—	25	—
Type	4	ZKU-2,5/4	ZKU-4/4	ZKU-10/4	ZKU-16/4	—	—	—	—	ZKM-4/4	—
Catalogue number		42-0040	42-0140	42-0240	42-0340	—	—	—	—	42-1140	—
Package		25	25	25	25	—	—	—	—	25	—
Type	5	ZKU-2,5/5	ZKU-4/5	ZKU-10/5	ZKU-16/5	—	—	—	—	ZKM-4/5	—
Catalogue number		42-0050	42-0150	42-0250	42-0350	—	—	—	—	42-1150	—
Package		20	20	20	20	—	—	—	—	20	—
Type	10	ZKU-2,5/10	ZKU-4/10	ZKU-10/10	ZKU-16/10	—	—	—	—	ZKM-4/10	—
Catalogue number		42-0000	42-0100	42-0200	42-0300	—	—	—	—	42-1100	—
Package		10	10	10	10	—	—	—	—	10	—

* Note: We offer only full packages

X-ON Electronics

Largest Supplier of Electrical and Electronic Components

Click to view similar products for [DIN Rail Terminal Blocks](#) category:

Click to view products by [POKOJ](#) manufacturer:

Other Similar products are found below :

[1045932](#) [00110420202](#) [00110430402](#) [5724.2/L](#) [592808-3](#) [CTS25U/BL](#) [CTS2.5U-N/Y](#) [90.080](#) [91.010](#) [91.040](#) [DP25-GY-ND](#) [15288](#) [90.070](#)
[90.202](#) [90.905](#) [91.001](#) [91.020](#) [91.201](#) [91.340](#) [2713793](#) [280-331](#) [283-317](#) [283-607](#) [2909044](#) [2909798](#) [29-2052](#) [SRT2-OD08CL-1](#)
[CDL4U\(E\)MOV](#) [2757801](#) [2794660](#) [284-317](#) [2890975](#) [2907033](#) [3048496](#) [CTS2.5U-N/O](#) [5542152](#) [5602077](#) [0709880](#) [5520682](#) [5607102](#)
[EPUSC](#) [SRT2-OD16P](#) [2901288](#) [591620-2](#) [1-591651-1](#) [NRA37-1/2](#) [592814-1](#) [592814-3](#) [SRT2-ID16P](#) [NRA37-12](#)