

SKINDICHT® KU, KUS, KUK

SKINDICHT® KU, KUS, KUK, polyamide, glass fibre-reinforced reducers for maximum mechanical stability, with PG connection thread

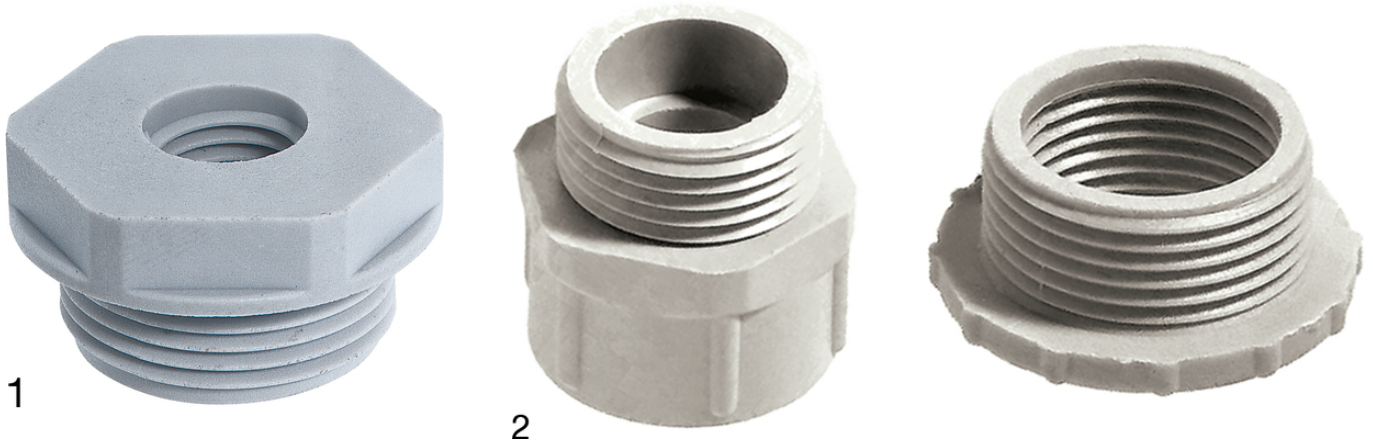

Space requirement

Benefits

Enables the use of cable glands with smaller connection threads than the existing threaded holes
Glass fibre-reinforced for maximum mechanical stability

Application range

Machines
Devices
Housings

Product Make-up

PG connection thread

Product Make-up

SKINDICHT® KU with hexagon and flat design (1)
SKINDICHT® KUS with hexagon and larger height (2)
SKINDICHT® KUK with knurled heads (3)

Technical Data

Classification ETIM 5:

ETIM 5.0 Class-ID: EC000441

ETIM 5.0 Class-Description: Cable screw gland

Classification ETIM 6:

ETIM 6.0 Class-ID: EC000441

ETIM 6.0 Class-Description: Cable screw gland

Colour delivered:

Light grey (RAL 7035)

Material:

Polyamide, glass fibre-reinforced

Temperature range:

-40°C to +100°C

Last Update (22.02.2018)

©2018 Lapp Group - Technical changes reserved

Product Management www.lappkabel.de

You can find the current technical data in the corresponding data sheet.

PN 0456 / 02_03.16

SKINDICHT® KU, KUS, KUK

Note

Photographs and graphics are not to scale and do not represent detailed images of the respective products.
Prices are net prices without VAT and surcharges. Sale to business customers only.

Article number	Article designation / size
SKINDICHT® KU	
51730010	KU 11/7
52025100	KU 13,5/7
52025110	KU 16/9
52025120	KU 21/11
51730040	KU 21/13,5
52025130	KU 29/13,5
51730050	KU 29/16
52025140	KU 36/16
52025150	KU 36/21
52025050	KU 36/29
52025160	KU 42/21
52025170	KU 42/29
52025060	KU 42/36
52025180	KU 48/29
52025190	KU 48/36
52025070	KU 48/42
SKINDICHT® KUS	
52025040	KUS 9/7
51730060	KUS 11/9
51730070	KUS 13,5/11
51730080	KUS 16/13,5
SKINDICHT® KUK	
51730020	KUK 13,5/9
51730025	KUK 16 /9
51730030	KUK 16/11
51730035	KUK 21/13,5
51730090	KUK 21/16
51730100	KUK 29/21
51730110	KUK 36/29

Last Update (22.02.2018)
 ©2018 Lapp Group - Technical changes reserved
 Product Management www.lappkabel.de
 You can find the current technical data in the corresponding data sheet.
 PN 0456 / 02_03.16

X-ON Electronics

Largest Supplier of Electrical and Electronic Components

Click to view similar products for [Cable Glands, Strain Reliefs & Cord Grips](#) category:

Click to view products by [Lapp Kabel](#) manufacturer:

Other Similar products are found below :

[120-116-1-1-20BP](#) [120-116-1-1-32BE](#) [120-117-40](#) [120-123-14](#) [120-123-16](#) [120-125-16](#) [120-125-16R](#) [120-125-16Y](#) [120-125-24Y](#) [120-125-28](#) [120-125-28R](#) [120-125-32](#) [120-125-32R](#) [120-125-40](#) [120-125-56](#) [120-126-14](#) [120-126-16](#) [120-126-20](#) [120-126-20BL](#) [120-126-20R](#) [120-126-24](#) [120-126-28](#) [120-126-32](#) [120-126-40BL](#) [120-116-1-1-06BP-509](#) [120-116-1-1-06CP](#) [120-116-1-1-16BE](#) [120-116-1-1-28BP](#) [120-123-20](#) [120-123-24](#) [120-123-32](#) [120-125-20](#) [120-125-20Y](#) [120-125-24](#) [120-125-24R](#) [120-125-28Y](#) [120-126-14BL](#) [120-126-16R](#) [120-126-16Y](#) [120-126-24BL](#) [120-126-28BL](#) [120-126-32BL](#) [120-126-40](#) [120-126-48](#) [120-126-48BL](#) [1300980012](#) [1300980105](#) [DBZM-6828](#) [1498](#) [15190-103 R2](#)