

APPROVED: \_\_\_\_\_  
 DATE: \_\_\_\_\_ TITLE: \_\_\_\_\_

Rev	AWO #	Description	Date	Appr
-		RELEASED	11/18/04	
A		ADDED LATCH HEIGHT	03/08/05	

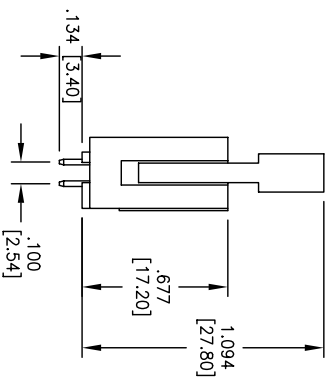
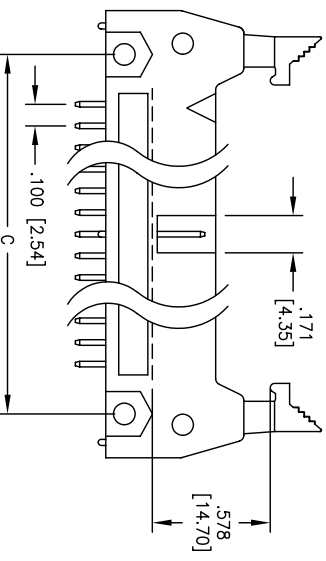
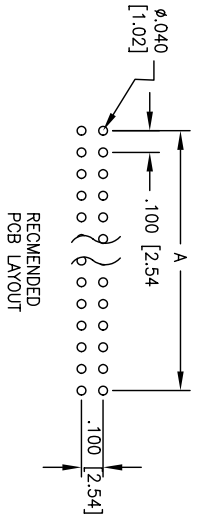
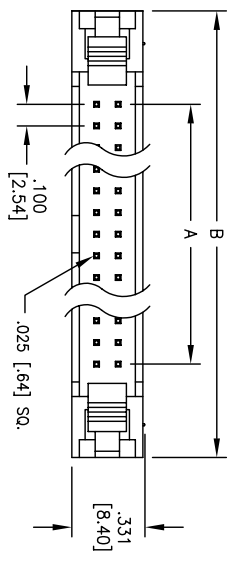

POSITION	A	B	C
10	.400 [10.16]	1.26 [32.00]	.860 [21.84]
14	.600 [15.24]	1.46 [37.08]	1.060 [26.92]
16	.700 [17.78]	1.56 [39.62]	1.160 [29.46]
20	.900 [22.86]	1.76 [44.70]	1.360 [34.54]
24	1.100 [27.94]	1.96 [49.78]	1.560 [39.62]
26	1.200 [30.48]	2.06 [52.32]	1.660 [42.16]
30	1.400 [35.56]	2.26 [57.40]	1.860 [47.24]
34	1.600 [40.64]	2.46 [62.48]	2.060 [52.32]
40	1.900 [48.26]	2.76 [70.10]	2.360 [59.94]
50	2.400 [60.96]	3.26 [82.80]	2.860 [72.64]
60	2.900 [73.66]	3.76 [95.50]	3.360 [85.34]
64	3.100 [78.74]	3.96 [100.58]	3.560 [90.42]

**SPECIFICATIONS:**

Material: PBT, glass reinforced, rated UL 94V-0  
 Insulator color: Black  
 Contacts: Brass

Plating: Gold Flash over Nickel underplate overall

**Electrical:**

Operating voltage: 250 VAC max  
 Current rating: 3 Amps max

Contact resistance: 20 mohms max

Insulation resistance: 5000 Mohms min @ 500 VDC

Dielectric withstanding voltage: 1000 VAC for 1 minute

**Temperature Rating:**

Operating temperature: -55°C to +105°C

**Environmental:**

Lead free, RoHS compliant



**ADAM TECH**

909 Rahway Avenue, Union, NJ 07083  
 Phone: 908-687-5000 Fax: 908-687-5710

TITLE: LATCHING HEADER, .100 [2.54], LONG LATCHES, STRAIGHT PCB

UNLESS OTHERWISE SPECIFIED ALL DIMENSIONS ARE INCHES [MM]		TOLERANCES: EXCEPT AS NOTED INCHES		HOLE SIZES	
.X	± .10	Ø.X	± .10	Ø.X	± .10
.XX	± .020	Ø.XX	± .015	Ø.XX	± .015
.XXX	± .015	Ø.XXX	± .010	Ø.XXX	± .010
APPROVALS		DATE		TITLE	
DRAWN	SS		11/18/04	LATCHING HEADER, .100 [2.54], LONG LATCHES, STRAIGHT PCB	
CHECKED				SIZE	PART NO.
APPROVED				X	MHR-XX-VUAL
				SCALE:	NTS
				SHEET:	1 OF 1

## X-ON Electronics

Largest Supplier of Electrical and Electronic Components

*Click to view similar products for [Headers & Wire Housings](#) category:*

*Click to view products by [Adam](#) manufacturer:*

Other Similar products are found below :

[95000-104TRLF](#) [10135584-644402LF](#) [DF62W-EP2022PCA](#) [95000-106TRLF](#) [DF62W-2022SCA](#) [DF62W-EP2022PC](#) [2203348](#) [DF62W-2022SC](#) [1084018](#) [1029039](#) [1084017](#) [802-10-012-10-002000](#) [1112640](#) [1112639](#) [891-007-9SS-BST1T](#) [000-34000](#) [0008550134](#) [0009482033](#) [0009507031](#) [57102-F02-18ULF](#) [57102-S06-03LF](#) [57202-S52-04LF](#) [PCN6-15S-2.5E](#) [0039019024](#) [58102-G61-06LF](#) [582553-1](#) [0009485154](#) [0009508121](#) [0022285053](#) [0050291907](#) [018731A](#) [LY20-4P-DT1-P1E-BR](#) [02.125.8002.8](#) [60101931](#) [60598-1 \(Cut Strip\)](#) [M1625-3R/100](#) [61062-3](#) [61082-181009](#) [CSU011177004](#) [636-1427](#) [638009-1](#) [641938-9](#) [641991-4](#) [644168-1](#) [644827-2](#) [647662-1](#) [65039-019ELF](#) [65692-001LF](#) [65781-018](#) [65781-047](#)