

### Color-Keyed®

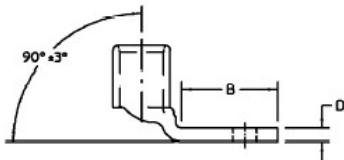

**T&B Catalog Number:** 54112UBB  
**UPC Number:** 78621019541  
**Description:** Copper One-Hole Lug - 90 degree Standard Barrel - max 35KV, 4/0 AWG Wire, 3/8" Bolt Size, Tin Plated with Inspection Hole, Bottom Stacking, Purple 54  
**Status:** Active

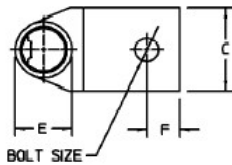

#### General

-Material	Copper
-Finish	Tin Plated
-Wire Size	4/0 AWG
-Number of Studs	1
-Stud Size	3/8
-Tongue Angle	90
-Barrel Length	Standard
-Barrel Shape	Standard
-Tongue Width	Standard
-Peep Hole	Y
-Stacking	Bottom
-Marking	Standard
-Hole Shape	Round
-Die Color	Purple
-Die Code	54

#### Packaging

-Package in Units	10
-T&B Sold in UOM	Each
-T&B Weight Per UOM	12.5 lbs. per 100

#### Application Support

-Overview	Available on Website
-Connector & Tooling Chart	Available on Website

#### Notes

- Dimensions given for reference only. Dimensions may vary up to

#### Certifications

-RoHS Compliance	Yes
------------------	-----

#### Certifications



File Nbr:  
E9809

**For further technical assistance, please contact us...**

Thomas & Betts - USA  
 8155 T&B Blvd.  
 Memphis, TN 38125  
 www.tnb.com

T&B Technical Support  
 MS 3B-50  
 8155 T&B Blvd.  
 Memphis, TN 38125

Hours: 7AM - 6PM CDT  
 Monday-Friday  
 Phone: (888) 862-3289  
 Fax: (901) 252-1321  
 Email:techsupport@tnb.com

## X-ON Electronics

Largest Supplier of Electrical and Electronic Components

*Click to view similar products for [Terminals](#) category:*

*Click to view products by [ABB](#) manufacturer:*

Other Similar products are found below :

[HT-13-10](#) [71M-250-32-NB](#) [01-2065-1-0216](#) [00581P0075](#) [M10-10RX](#) [M10BCK](#) [60205-1](#) [604200-1](#) [60598-1-CUT-TAPE](#) [60617-1-C](#) [60873-1](#) [M14-516R/SK](#) [M14-6RSX](#) [M18-10FLX](#) [M18-8FBX](#) [M18-8R/LX](#) [M18BCK](#) [61314-6-C](#) [61-S](#) [61-SN-A](#) [62-NBM-A](#) [63-S](#) [640179-1](#) [640917-2-CUT-TAPE](#) [6501550002](#) [66107-2-C](#) [66107-4-C](#) [696683-1](#) [696834-1](#) [696861-1](#) [696931-1](#) [696999-1](#) [M8-516RK](#) [M86700006](#) [MA250DMFMX-A](#) [701-2007](#) [701-2307](#) [701-7761-03](#) [70F-110-32-PB](#) [718-N-A](#) [71M-187-20-NBL](#) [71M-250-32-NBL](#) [72F-187-20-NBL](#) [72M-250-32-NBL](#) [7310](#) [73F-250-32](#) [73F-250-32-NBL](#) [73F-250-32-NL](#) [F14-10C](#) [F-1M](#)