

Rev	AWO #	Description	Date	Appr
A		UPDATED SPEC.	7/20/15	HR/AY
-		RELEASED	08/01/13	

APPROVED: _____
DATE: _____ TITLE: _____

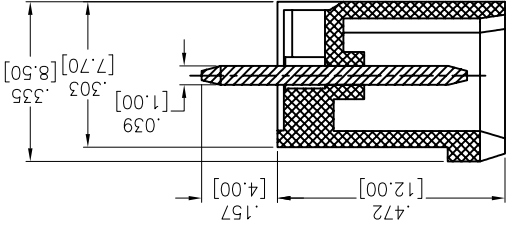
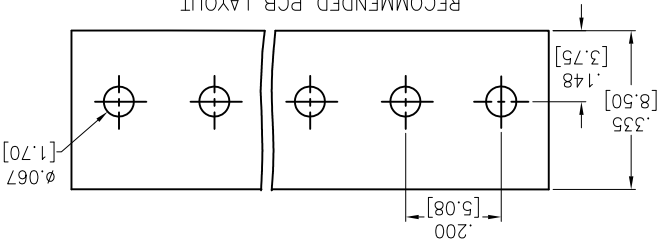
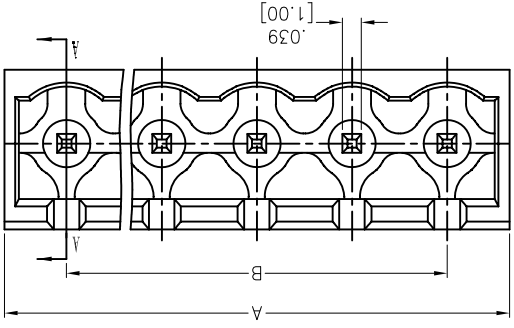

SPECIFICATIONS:

Material: PA66, rated UL 94V-0

Insulator color: Green

Contact: Brass, Tin plated.

Operation voltage: 300 VAC max

Current rating: 15 Amps

Contact resistance: 20 mohms max

Insulation resistance: 500 Mohms min @ 500 VDC

Dielectric withstanding voltage: 2,000 VAC for 1 minute

Temperature Rating:

Operating temperature: -40°C to +105°C

Environmental:

Lead free, RoHS compliant.



Positions: 02 thru 24
A = .200 [5.08] x No. of Positions + .055 [1.40]
B = .200 [5.08] x No. of Spaces

UNLESS OTHERWISE SPECIFIED		TOLERANCES ARE MM [INCHES]		INCHES	
X	±.10	ØX	±.10	X	±.10
XX	±.020	ØXX	±.015	XX	±.020
XXX	±.015	ØXXX	±.010	XXX	±.015
APPROVALS		DATE		DRAWN	
		10/17/13		AY	
		10/17/13		NP	
		10/17/13		CHECKED	
				APPROVED	
TITLE		PART NO.		SIZE	
TERMINAL BLOCK, SOCKETS .200 [5.08] PITCH		EBPA-XX-D-C		X	
909 Rahway Avenue, Union, NJ 07083		Phone: 908-687-5000 Fax: 908-687-5710		ADAM TECH	

1 2 3 4 5 6

A A B B C C D D

X-ON Electronics

Largest Supplier of Electrical and Electronic Components

Click to view similar products for [Pluggable Terminal Blocks](#) category:

Click to view products by [Adam](#) manufacturer:

Other Similar products are found below :

[57.404.7553](#) [57.504.0053.7](#) [57.510.0053](#) [57.910.6153](#) [01.112.1453](#) [CTB932VE/6](#) [MC 1.5/ 6-ST-3.5 GY AU](#) [ET02015000J0G](#) [734-104](#) [734-302](#) [734-304](#) [8-141-P](#) [FKCT 2.5/ 3-ST KMGY](#) [860505](#) [860508](#) [860516](#) [860810](#) [861908](#) [GBPACX-12](#) [93.731.4953.0](#) [PV05-5,08-K](#) [PVP02-5,00](#) [PVP04-3,50](#) [PVS02-5,00](#) [1-1986160-3](#) [H-10](#) [1546228-5](#) [ELFH09150](#) [ELFH16150](#) [ELFP03110](#) [ELFT06250](#) [ELFT07250](#) [ELVF09400](#) [ELVP03100](#) [ELXH03100](#) [ELXH071G0E](#) [ELXP041G0](#) [ELXT046G0](#) [1700101](#) [1700410](#) [1700425](#) [1703176](#) [1705229](#) [1710175](#) [1714537](#) [1717806](#) [1719600](#) [1729386](#) [1734692](#) [1734795](#)