



Zakład Mechaniki i Elektroniki
ZAMEL sp.j.
J.W. Dzida, K. Łodzińska

zAMEL

ul. Zielona 27, 43-200 Pszczyna, Poland
Tel. +48 (32) 210 46 65, Fax +48 (32) 210 80 04
www.zamelcet.com, e-mail: marketing@zamel.pl

DESCRIPTION

The EDM-01 signalling module may be used in various systems, where acoustic alarm is needed, e.g. as an alarm signalling device. The module is very flexible and applicable in many circuits owing to the fact that it is supplied directly from 230 V AC network.

FEATURES

- ☞ Applicable in signalling systems,
- ☞ Continuous duty acoustic module,
- ☞ Supplied directly from 230 V AC network,
- ☞ High sound level,
- ☞ Single-module casing,
- ☞ Mounted on TH 35 rail.

TECHNICAL DATA

EDM - 01	
Power terminals:	L, N
Rated voltage:	230 V~
Rated voltage tolerance:	-15 ÷ +10 %
Rated frequency:	50 / 60 Hz
Rated current:	15 mA
Load supply indicator:	piezoelectric loudspeaker
Connection terminals quantity:	2
Connection wire section:	0,2 ÷ 2,50 mm ²
Operating temperature:	-20 ÷ +45 °C
Operating position:	optional
Casing fastening:	TH 35 rail (according to PN-EN 60715)
Casing IP:	IP20 (PN-EN 60529)
Protection class:	II
Overvoltage category:	II
Pollution level:	2
Dimensions:	single-module (17,5 mm) 90x17,5x66 mm
Weight:	51 g
Standard conformity:	PN-EN 60669-1; PN-EN 60669-2-1 PN-EN 61000-4-2,3,4,5,6,11



CAUTION

The device should be connected to a single-phase system accordingly to current standards. The device connections will be described in this manual. Only qualified electricians are allowed to mount, connect and adjust the bell. It is necessary to read this manual before the device mounting. Do not disassembly the timer casing or you will lose any warranty rights and expose yourself to the electric shock hazard. Before mounting operation make sure of disconnecting the connection wires from the electric network. Use a cross-head screwdriver of 3.5 mm diameter to mount the device. The bell should be carried, stored and used in an appropriate way. Do not mount the bell in case of any device parts lack, damage or deformation. In case of malfunction please notify the manufacturer.

APPEARANCE

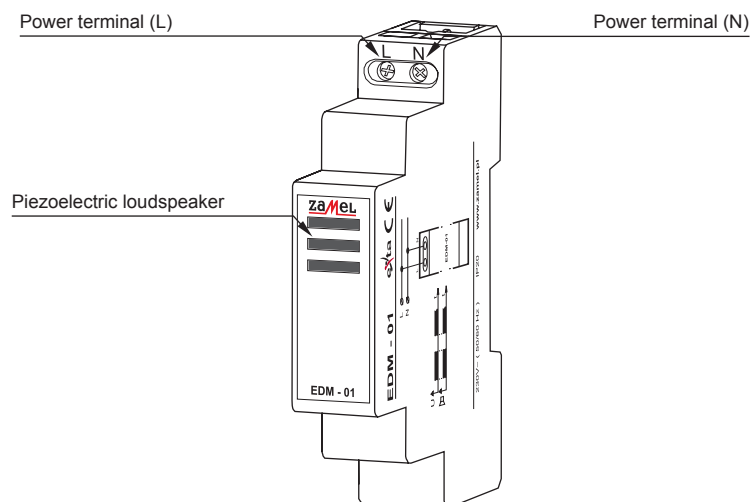

ASSEMBLY, OPERATION

1. Disconnect the electric network by means of an appropriate cut-off, current-limiting circuit-breaker or separator.
2. Check if there is no any voltage between power leads by means of an appropriate gauge.
3. Mount the **EDM-01** module on TH - 35 rail.
4. Connect the system leads according to the electrical diagram.
5. Connect power supply circuit.

The device is ready to work just right after its appropriate connecting. An internal piezoelectric loudspeaker is ON after the module supplying with 230 V~ voltage. The speaker is OFF when power supply is OFF.

CONNECTIONS

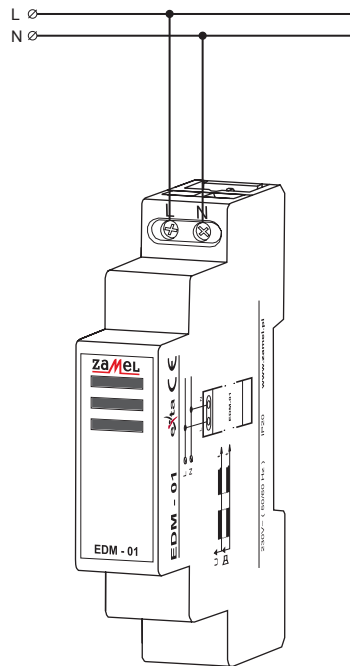

TIME DIAGRAMMS



UNIT DIAGRAM

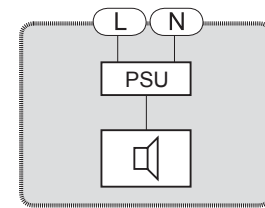

CASING DIMENSIONS

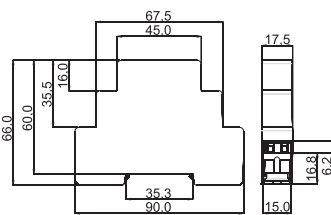

APPLICATION

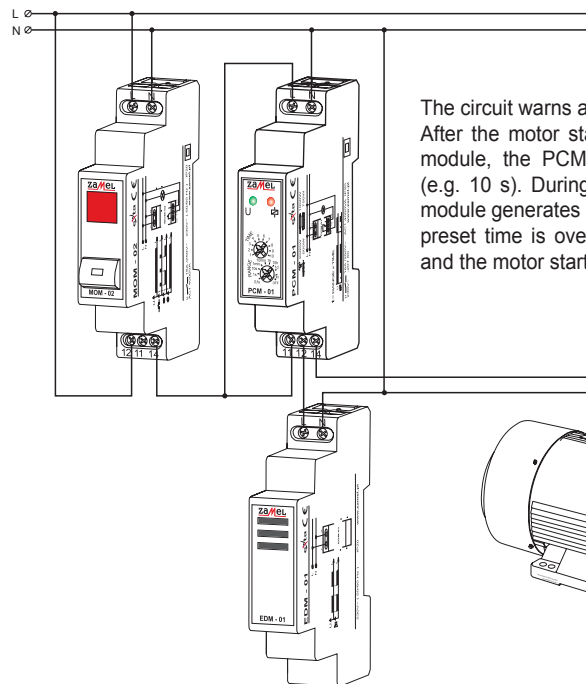

The circuit warns against motor switch-OFF. After the motor star by means of MOM-02 module, the PCM-01 counts preset time (e.g. 10 s). During this period the EDM-01 module generates acoustic signal. When the preset time is over, the sound will be OFF and the motor starts.

PRODUCT FAMILY

The EDM-01 signalling module is a member of the EDM family.

EDM - xx

Device version:
01 - continuous op
02 - resettable
03 - bell

Device type

WARRANTY

The product warranty is for a period of 24 months

1. ZMIE ZAMEL SP. J. assures 24 months guarantee for the product.
2. The manufacturer's guarantee does not cover any of the following actions:
 - a) mechanical damage during transport, loading / unloading or under other circumstances,
 - b) damage caused by incorrect product mounting or misuse,
 - c) damage caused by unauthorised modifications made by the PURCHASER or any third parties to the product or any other devices needed for the product functioning,
 - d) damage caused by Act of God or any other incidents independent of the manufacturer.
3. The PURCHASER shall lay any claims in writing to the dealer or ZMIE ZAMEL SP. J.
4. ZMIE ZAMEL SP. J. is liable for processing any claim according to current Polish legislation.
5. ZMIE ZAMEL SP. J. shall process the claim at its own discretion: product repair, replacement or money return.
6. The manufacturer's guarantee is valid in the Republic of Poland.
7. The PURCHASER's statutory rights in any applicable legislation whether against the retailer arising from the purchase contract or otherwise are not affected by this warranty.

Dealer signature & stamp, purchase date

X-ON Electronics

Largest Supplier of Electrical and Electronic Components

Click to view similar products for [Mounting Fixings](#) category:

Click to view products by [Zamel](#) manufacturer:

Other Similar products are found below :

[007310](#) [007541](#) [6-141-P](#) [620HA038NF09](#) [620HA038NF11](#) [71-074914-006](#) [71-146610-6H](#) [712HA170B23128-N](#) [71-441549-19S](#) [71-490451-4H](#) [75-69211-3P](#) [75-69220-27S](#) [75-69224-5S](#) [770-006A109](#) [770-006A109R](#) [770-006A207](#) [770-006A208W1](#) [770-006A209](#) [770-006A306](#) [770-006A703W1](#) [770-006A704](#) [770-006A704W1](#) [770-006A705](#) [770-006A706](#) [770-006A706W1](#) [770-006A707](#) [770-006A709](#) [770-007A203](#) [770-007A203W1](#) [770-007A204W1](#) [770-007A207W1](#) [770-007A703](#) [770-007A704W1](#) [770-007A706](#) [770-007A707W1](#) [770-010Y208](#) [770-010Y308](#) [770-010Y705](#) [770-010Y706](#) [770-010Y707W1](#) [770-011T201](#) [770-011T203](#) [770-011T701W1](#) [770-011T702](#) [770-011T702W1](#) [770-011T703](#) [770-013210W1](#) [770-013311](#) [770-013312](#) [770-013709](#)