

Cylindrical Reed Sensors with M8 Thread



DESCRIPTION

MK7 sensors are magnetically operated Reed proximity switches in a cylindrical form with an 8 mm x 0.75 thread and connecting cable or coupler. The sensor can be screwed directly onto a fixed surface with the actuating magnet on the moving surface. The widespread termination "T" or "U" makes the MK7 series compatible with several inductive and magnetic proximity sensors.

APPLICATIONS

- **Position and limit switch**
Pneumatic or hydraulic actuator position
Indication and end travel limit switch
- **Door and window contacts**
Security system applications
- **Level sensor**
Use with magnetic floats for water level detection in coffee makers, washing machines or dishwashers

FEATURES

- Form A, B, and C available
- High power switches available
- Other cables, connectors and colors available
- Various case sizes available
- Five operate sensitivities available
- A choice of cable terminations and lengths are available

DIMENSIONS

All dimensions in mm [inches]

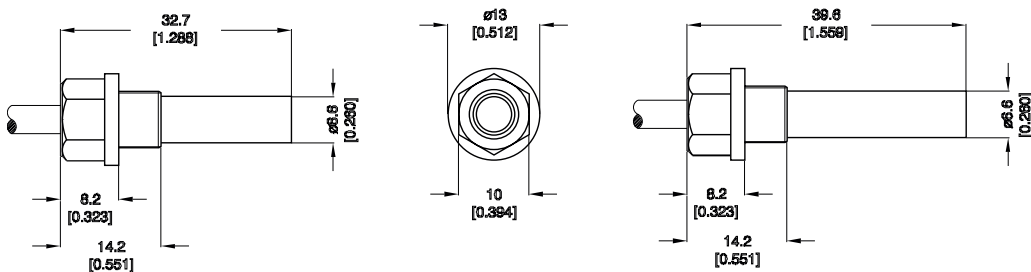

ORDER INFORMATION

Part Number Example

MK7 - 1A66 C - 500 W

1A is the contact form
66 is the switch model
C is the magnetic sensitivity
500 is the cable length (mm)
W is the termination

Series	Contact form	Switch-model	Magnetic Sensitivity	Cable Length (mm)	Termination
MK7 - MK7/1 -	XX	XX	X -	XXX	X
Options	1 Form A	66	B, C, D, E	500*	W
		51**	C, D, E		
	1 Form B 1 Form C	90			

* Other cable length available.
 ** Not available in combination with MK7/1 Sfferies.

MAGNETIC SENSITIVITY

Sensitivity Class	Pull In at Range
B	10 - 15
C	15 - 20
D	20 - 25
E	25 - 30

TERMINATION

For wire and termination details please consult factory.
 Form C version requires 3 conductors.

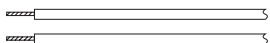
W		The cable cut length includes: 5 mm of wire stripped and tinned
----------	---	--

Cylindrical Reed Sensors with M8 Thread

CONTACT DATA

All Data at 20° C	Switch Model → Contact Form →	Switch 51 Form A			Switch 66 Form A			Units
		Min.	Typ.	Max.	Min.	Typ.	Max.	
Contact Ratings	Conditions							
Switching Power	Any DC combination of V & A not to exceed their individual max.'s			12			10	W
Switching Voltage	DC or peak AC			250			200	V
Switching Current	DC or peak AC			0.5			0.5	A
Carry Current	DC or peak AC			1.5			1.25	A
Static Contact Resistance	w/ 0.5 V & 10mA			150			150	mΩ
Dynamic Contact Resistance	Measured w/ 0.5 V & 50mA , 1.5 ms after closure			200			200	mΩ
Insulation Resistance across Contacts	100 volts applied	10 ¹¹			10 ^{10*}			Ω
Breakdown Voltage across Contact	Voltage applied for 60 sec. min.	350			225 *			VDC
Operation Time incl. Bounce	Measured w/ 100 % overdrive			1.0			0.5	ms
Release Time	Measured w/ no coil suppression			0.1			0.1	ms
Capacitance	at 10 kHz cross contact		0.2			0.2		pF
Contact Operation **								
Must Operate Condition	Steady state field	15		30	10		30	AT
Must Release Condition	Steady state field	6		27	4		27	AT
Environmental Data								
Shock Resistance	1/2 sinus wave duration 11 ms			50			50	g
Vibration Resistance	From 10 - 2000 Hz			20			20	g
Ambient Temperature	10°C/ minute max. allowable	-20		85	-20		85	°C
Stock Temperature	10°C/ minute max. allowable	-35		85	-35		85	°C
Soldering Temperature	5 sec. dwell			260			260	°C
<p>Please note: The indicated electrical data are maximum values and can vary downwards when using a more sensitive switch. * Insulation resistance of 10¹² and breakdown voltage of 480 VDC is available. ** These ranges refer to the uncut / unmodified Reed Switches described in our Reed Switch section. Consult factory if more detail is required.</p>								

CONTACT DATA

All Data at 20° C	Switch Model → Contact Form →	Switch 90 Form B / C			
Contact Ratings	Conditions	Min.	Typ.	Max.	Units
Switching Power	Any DC combination of V & A not to exceed their individual max.'s			3	W
Switching Voltage	DC or peak AC			175	V
Switching Current	DC or peak AC			0.25	A
Carry Current	DC or peak AC			1.2	A
Static Contact Resistance	w/ 0.5 V & 10mA			150	mΩ
Dynamic Contact Resistance	Measured w/ 0.5 V & 50mA , 1.5 ms after closure			250	mΩ
Insulation Resistance across Contacts	100 volts applied	10 ⁹			Ω
Breakdown Voltage across Contact	Voltage applied for 60 sec. min.	200			VDC
Operation Time incl. Bounce	Measured w/ 100 % overdrive			0.7	ms
Release Time	Measured w/ no coil suppression			1.5	ms
Capacitance	at 10 kHz cross contact		1.0		pF
Contact Operation *					
Must Operate Condition	Steady state field	15		35	AT
Must Release Condition	Steady state field	6		27	AT
Environmental Data					
Shock Resistance	1/2 sinus wave duration 11 ms			50	g
Vibration Resistance	From 10 - 2000 Hz			20	g
Ambient Temperature	10°C/ minute max. allowable	-20		85	°C
Stock Temperature	10°C/ minute max. allowable	-35		85	°C
Soldering Temperature	5 sec. dwell			260	°C
Please note: The indicated electrical data are maximum values and can vary downwards when using a more sensitive switch.					
* These ranges refer to the uncut / unmodified Reed Switches described in our Reed Switch section. Consult factory if more detail is required.					

X-ON Electronics

Largest Supplier of Electrical and Electronic Components

Click to view similar products for [Proximity Sensors](#) category:

Click to view products by [MEDER](#) manufacturer:

Other Similar products are found below :

[01.001.5653.1](#) [70.340.1028.0](#) [70.360.2428.0](#) [70.364.4828.0](#) [70.810.1053.0](#) [72.360.1628.0](#) [73.363.6428.0](#) [9221350022](#) [980659-1](#) [QT-12](#)
[E2EX10D1NN](#) [E2E-X14MD1-G](#) [E2E-X2D1-G](#) [E2EX2ME2N](#) [E2E-X3D1-N](#) [10M](#) [E2E-X4MD1-G](#) [E2FMX1R5D12M](#) [E2K-F10MC1](#) [5M](#)
[EI1204TBOSL-6](#) [EI5515NPAP](#) [BSA-08-25-08](#) [IC08ANC15PO-K](#) [IMM2582C](#) [25.161.3253.0](#) [25.332.0653.1](#) [25.352.0653.0](#) [25.352.0753.0](#)
[25.523.3253.0](#) [9151710023](#) [922FS1.5C-A4P-Z774](#) [SC606ABV0S30](#) [SM952A126100LE](#) [SM956A132600](#) [A1220EUA-T](#) [F3S-A162-U](#) [CL18](#)
[QT-08L](#) [34.110.0010.0](#) [TL-C2MF1-M3-E4](#) [IA08BLF15NOM5](#) [IA08BSF15NOM5](#) [IA12ASF04DOM1](#) [IMM32188C](#) [IS2](#) [IS31SE5000-](#)
[UTLS2-TR](#) [34.110.0021.0](#) [34.110.0022.0](#) [CA150-120VACDC](#) [VM18VA3000Q](#) [XS508BSCBL2](#)