



5SDD 0120C0400

Old part no. DS 879D-12000-04

Welding diode

Properties

- High forward current capability
- Low forward and reverse recovery losses
- High operational reliability

Applications

- Welding equipment
- High current application up to 2000 Hz

Key parameters

V_{RRM}	=	400	V
I_{FAVm}	=	11 350	A
I_{FSM}	=	85 000	A
V_{TO}	=	0.74	V
r_T	=	0.018	m Ω

Types

type	V_{RRM}
5SDD 0120C0400	400 V
Conditions: $T_j = -40 \div 170$ °C, half sine waveform, $f = 50$ Hz	

Mechanical data

F_m	Mounting force	35 ÷ 40 kN
m	Weight	0.22 kg
D_s	Surface creepage distance	4 mm
D_a	Air strike distance	4 mm

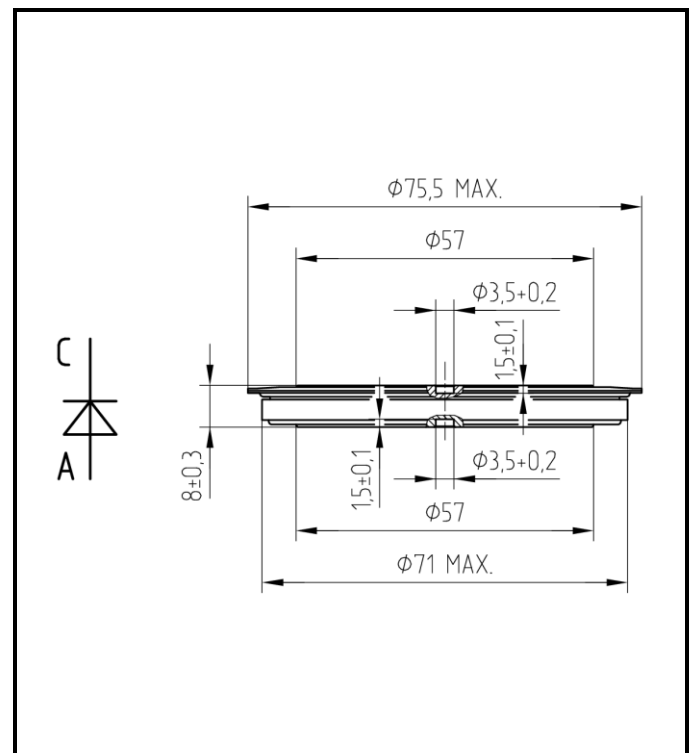

Fig. 1 Case



ABB s.r.o.

Novodvorska 1768/138a, 142 21 Praha 4, Czech Republic

tel.: +420 261 306 250, <http://www.abb.com/semiconductors>

Maximum Ratings		Maximum Limits	Unit
V_{RRM}	Repetitive peak reverse voltage $T_j = -40 \div 170 \text{ }^\circ\text{C}$	400	V
I_{FAVm}	Average forward current $T_c = 85 \text{ }^\circ\text{C}$	11 350	A
I_{FRMS}	RMS forward current $T_c = 85 \text{ }^\circ\text{C}$	17 800	A
I_R	Repetitive reverse current $V_R = V_{RRM}$	50	mA
I_{FSM}	Nonrepetitive peak surge current $t_p = 10 \text{ ms}, V_R = 0 \text{ V}, \text{ half sine pulse}$	85 000	A
I^2t	Limiting load integral $t_p = 10 \text{ ms}, V_R = 0 \text{ V}, \text{ half sine pulse}$	36 000 000	A²s
$T_{jmin} - T_{jmax}$	Operating temperature range	- 40 \div 170	$^\circ\text{C}$
$T_{stgmin} - T_{stgmax}$	Storage temperature range	- 40 \div 170	$^\circ\text{C}$

Unless otherwise specified $T_j = 170 \text{ }^\circ\text{C}$

Characteristics		Value			Unit
		<i>min</i>	<i>typ</i>	<i>max</i>	
V_{T0}	Threshold voltage			0.740	V
r_T	Forward slope resistance $I_{F1} = 8\,000 \text{ A}, I_{F2} = 18\,000 \text{ A}$			0.018	mΩ
V_{FM}	Maximum forward voltage $I_{FM} = 8000 \text{ A}$	0.83		0.88	V
Q_{rr}	Recovered charge $I_{FM} = 1000 \text{ A}, di/dt = -30 \text{ A}/\mu\text{s}, V_R = 50 \text{ V}$		350		μC

Unless otherwise specified $T_j = 170 \text{ }^\circ\text{C}$

Thermal Specifications			Value	Unit
R_{thjc}	Thermal resistance junction to case	<i>double side cooling</i>	6	K/kW
		<i>single side cooling</i>	12	
R_{thch}	Thermal resistance case to heatsink	<i>double side cooling</i>	3	K/kW
		<i>single side cooling</i>	6	

ABB s.r.o., Novodvorska 1768/138a, 142 21 Praha 4, Czech Republic

Analytical function for transient thermal impedance

$$Z_{thjc} = \sum_{i=1}^4 R_i(1 - \exp(-t / \tau_i))$$

Conditions:
 $F_m = 35 \div 40$ kN, Double side cooled

i	1	2	3	4
R_i (K/kW)	4.6507	0.8219	0.4408	0.0870
τ_i (s)	0.0830	0.0172	0.0040	0.0002

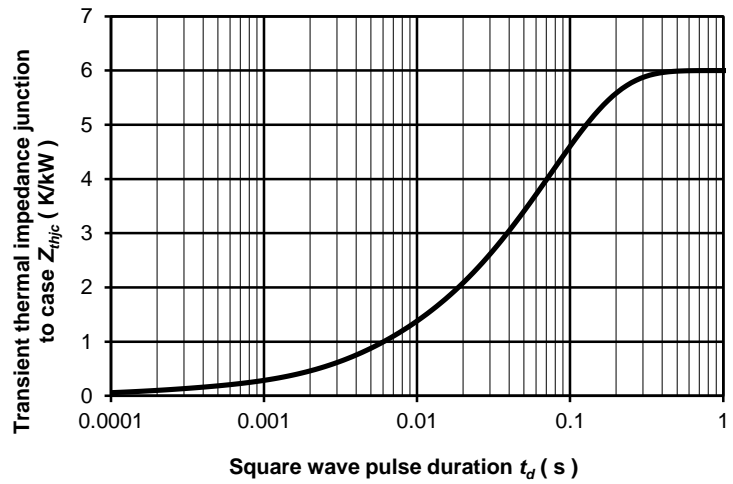

Fig. 2 Dependence transient thermal impedance junction to case on square pulse

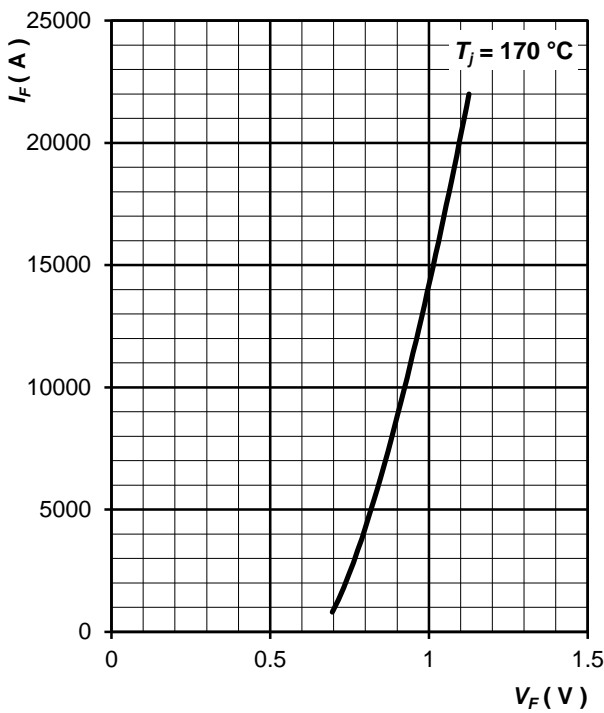

Fig. 3 Maximum forward voltage drop characteristics

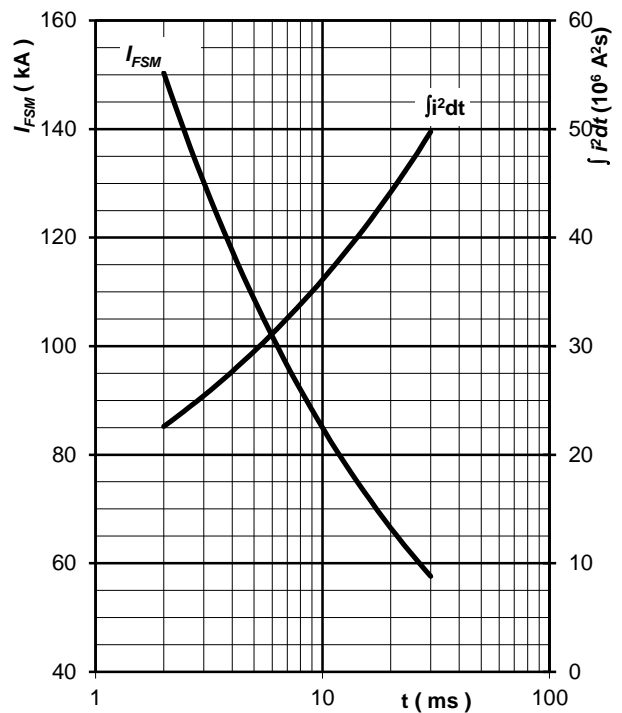

Fig. 4 Surge forward current vs. pulse length, half sine wave, single pulse, $V_R = 0$ V, $T_j = T_{jmax}$

ABB s.r.o., Novodvorska 1768/138a, 142 21 Praha 4, Czech Republic

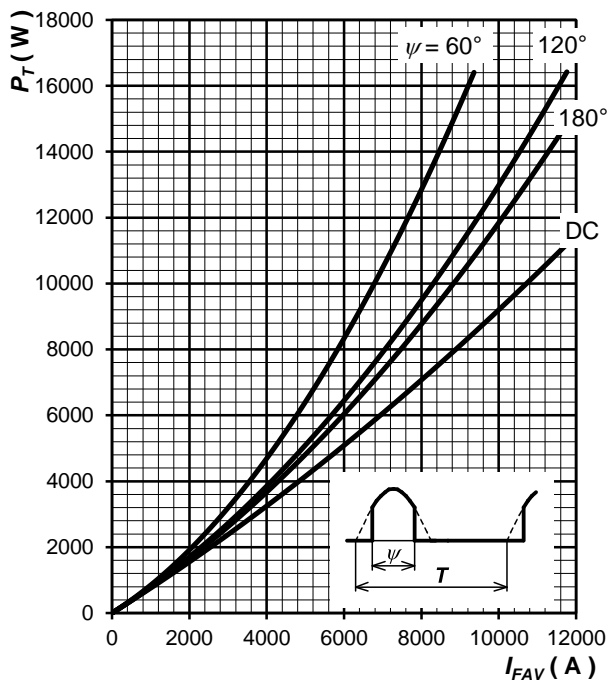

Fig. 5 Forward power loss vs. average forward current, sine waveform, $f = 50$ Hz

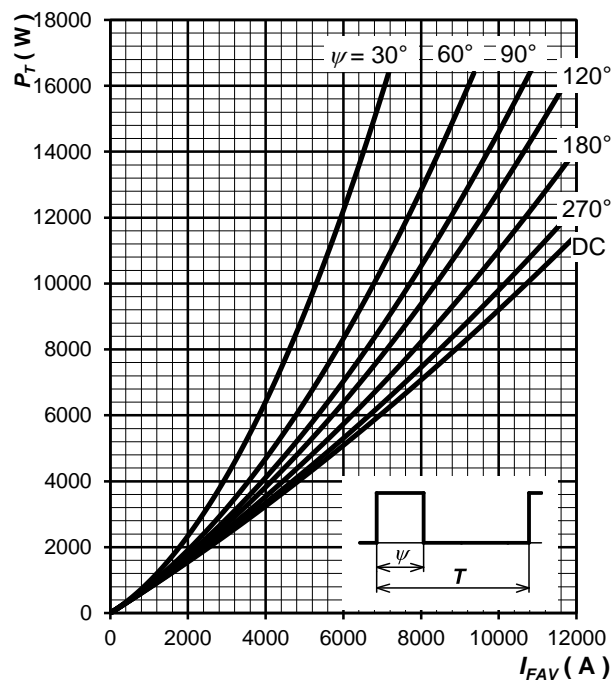

Fig. 6 Forward power loss vs. average forward current, square waveform, $f = 50$ Hz

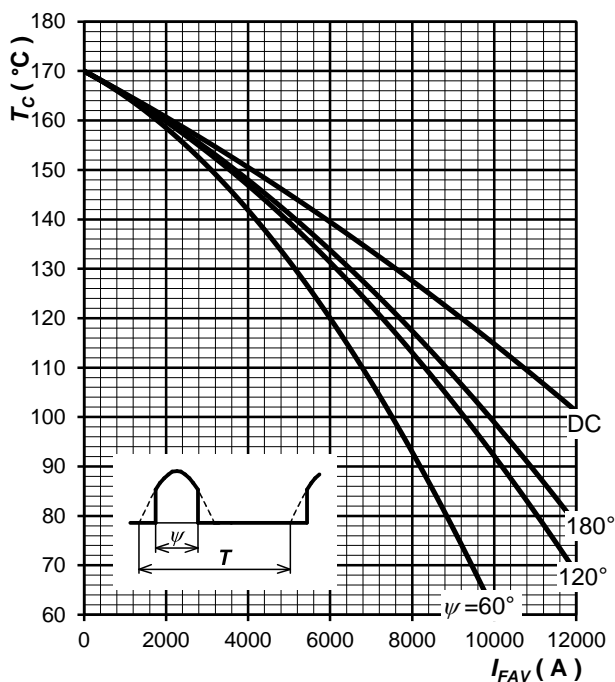

Fig. 7 Max. case temperature vs. aver. forward current, sine waveform, $f = 50$ Hz

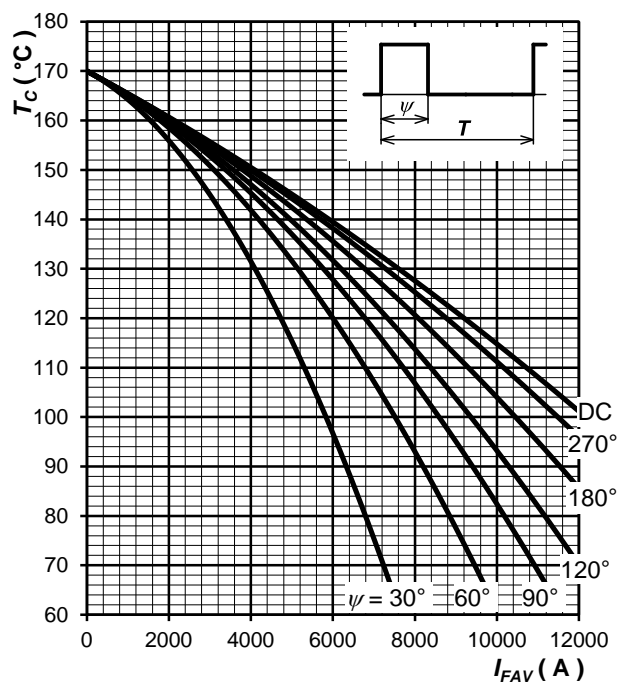

Fig. 8 Max. case temperature vs. aver. forward current, square waveform, $f = 50$ Hz

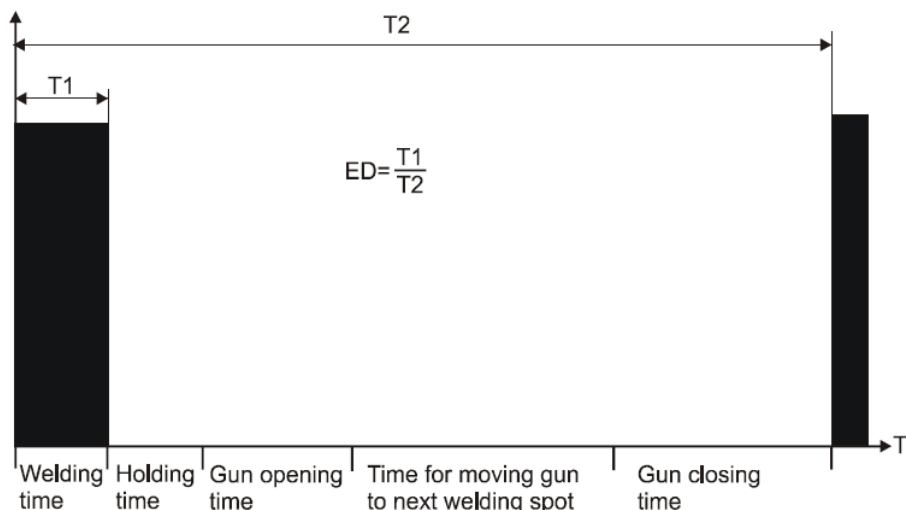

Fig. 9 Definition of ED for typical welding sequence

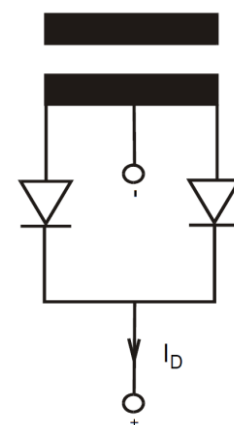

Fig. 10 Definition of I_D for single-phase centre tap

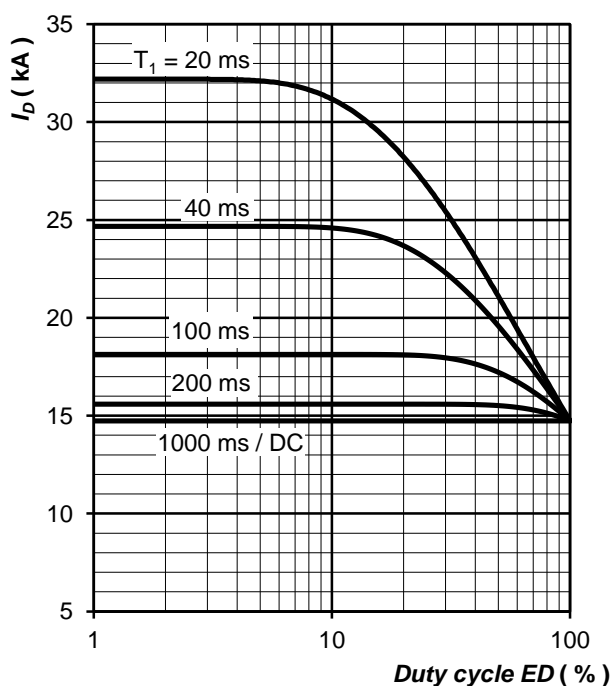

Fig. 11 Current load capacity, cont.,
DC output welding current with single-phase centre tap vs. duty cycle
 $f = 1000 \text{ Hz}$, square wave, $\Delta T_j = 80 \text{ }^\circ\text{C}$

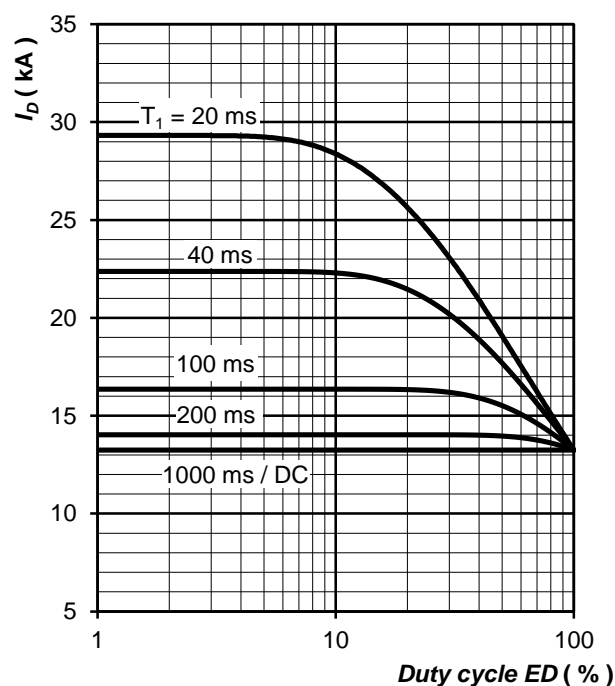

Fig. 12 Current load capacity, cont.,
DC output welding current with single-phase centre tap vs. duty cycle
 $f = 1000 \text{ Hz}$, square wave, $\Delta T_j = 70 \text{ }^\circ\text{C}$

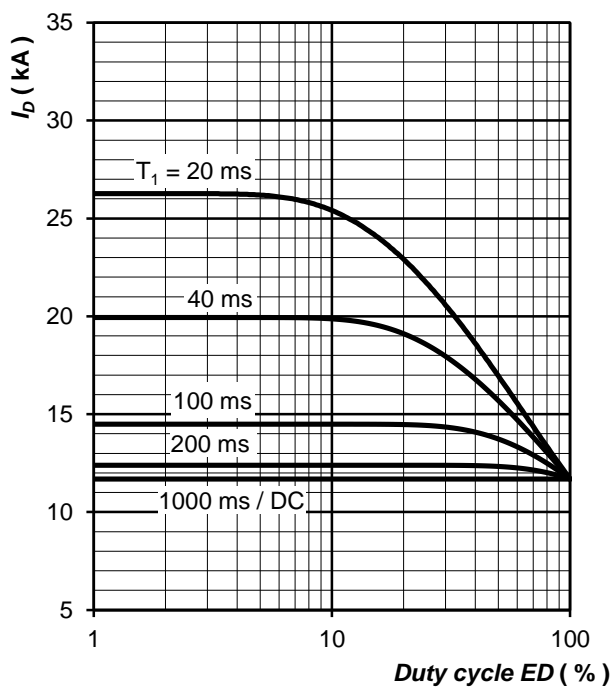

Fig. 13 Current load capacity, cont.,
DC output welding current with single-phase
centre tap vs. duty cycle
 $f = 1000$ Hz, square wave, $\Delta T_j = 60^\circ\text{C}$

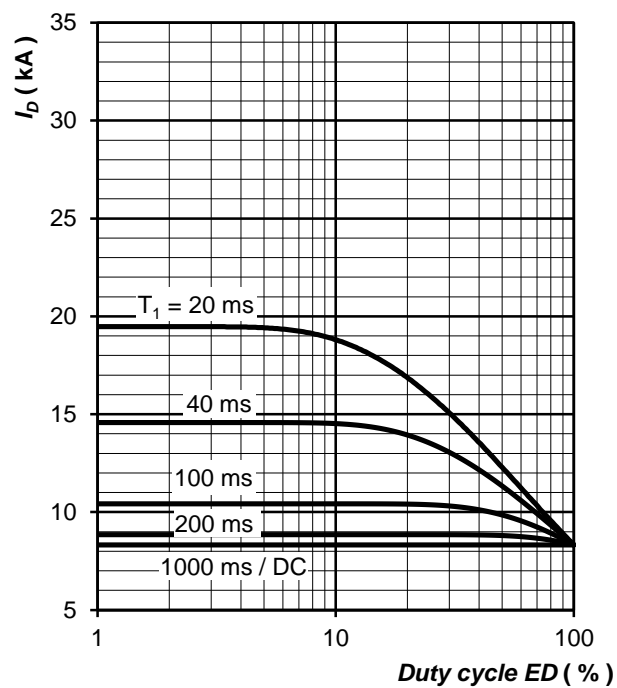

Fig. 14 Current load capacity, cont.,
DC output welding current with single-phase
centre tap vs. duty cycle
 $f = 1000$ Hz, square wave, $\Delta T_j = 40^\circ\text{C}$

Notes:

X-ON Electronics

Largest Supplier of Electrical and Electronic Components

Click to view similar products for [Diodes - General Purpose, Power, Switching category](#):

Click to view products by [ABB manufacturer](#):

Other Similar products are found below :

[MCL4151-TR3](#) [MMBD3004S-13-F](#) [RD0306T-H](#) [RGP30G-E373](#) [BAQ333-TR](#) [BAQ335-TR](#) [BAQ33-GS18](#) [BAS1602VH6327XT](#) [BAV17-TR](#) [BAV19-TR](#) [BAV301-TR](#) [BAW27-TAP](#) [NSVBAV23CLT1G](#) [NTE525](#) [1SS181-TP](#) [1SS184-TP](#) [1SS193,LF](#) [1SS193-TP](#) [1SS400CST2RA](#) [SBAV99LT3G](#) [SDAA13](#) [LL4448-GS18](#) [SHN2D02FUTW1T1G](#) [LS4150GS18](#) [LS4151GS08](#) [SMMBD7000LT3G](#) [1N4449](#) [1N4934-E3/73](#) [APT100DL60HJ](#) [RFUH20TB3S](#) [RGP30G-E354](#) [RGP30M-E3/73](#) [D291S45T](#) [MCL4151-TR](#) [BAS 16-02L E6327](#) [BAS 16-02V H6327](#) [BAS 21U E6327](#) [BAS 28 E6327](#) [BAS33-TAP](#) [BAS 70-02V H6327](#) [BAV300-TR](#) [BAV303-TR3](#) [BAW27-TR](#) [BAW56DWQ-7-F](#) [BAW56M3T5G](#) [BAW75-TAP](#) [BAW76-TR](#) [MM230L-CAA](#) [MMSD914-TP](#) [IDW40E65D1](#)