

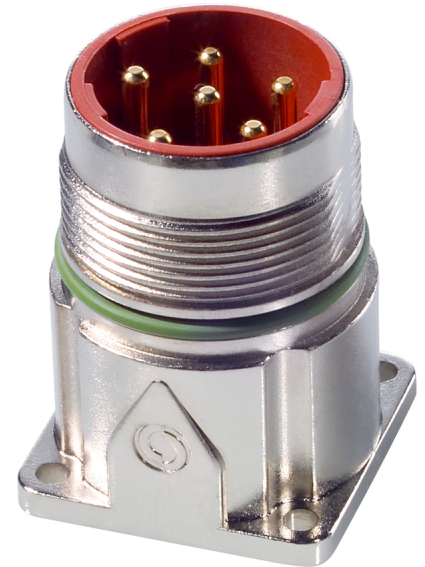











U.I. Lapp GmbH	<h1>DATASHEET</h1>	
	EPIC KIT LS1 A1 6-POL MALE	75009691 29.11.2013

Circular connectors for servomotors and power supply
 High power at smallest installation space, Optimal solution for electric motors
 EMC-optimised
 Safety use in field environment by high protection class



-  Good chemical resistance
-  Corrosion-resistant
-  Industrial machinery and plant engineering
-  Maximum vibration protection
-  Mechanical resistance
-  Assembly time
-  Space requirement
-  Robust
-  Waterproof
-  Wind Energy
-  Variety of approval certifications

Application range

Plant engineering
 Servo drives and servo assemblies

Remark

Photographs are not to scale and do not represent detailed images of the respective products.

Product Management	Document: EPIC KIT LS1 A1 6-POL MALE	1 / 3
--------------------	--------------------------------------	-------

U.I. Lapp GmbH	DATASHEET	
	EPIC KIT LS1 A1 6-POL MALE	75009691 29.11.2013

Technical Data

Article number:	75009691
Rated voltage (V):	630 V (2 mm contacts) 250 V (1 mm contacts)
Rated impulse voltage:	6 kV (2 mm contacts) 4 kV (1 mm contacts)
Rated current (A):	26A/3+PE+4, 25A/5+PE (2mm contacts) 7 A (1 mm contacts)
Contact resistance:	< 4 mOhm
Contacts:	Gold-plated brass
Number of contacts:	3 + PE + 4 5 + PE
Termination methods:	Crimp termination: 0.5 - 2.5 mm ² (2 mm contacts) Crimp termination: 0.14 - 1.0 mm ² (1 mm contacts)
Material:	Housing: nickel-plated zinc die-casting, nickel-plated brass Insert: PA, Seal: FPM
Protection rating:	IP68 (10h / 1m)
Cycle of mechanical operation:	500
Temperature range:	-25°C až +125°C
VDE-tested:	Certified production control: VDE-REG. no. B25
Degree of soiling:	3

Product Management	Document: EPIC KIT LS1 A1 6-POL MALE	2 / 3
--------------------	--------------------------------------	-------

U.I. Lapp GmbH	<h1>DATASHEET</h1>	
	EPIC KIT LS1 A1 6-POL MALE	75009691 29.11.2013

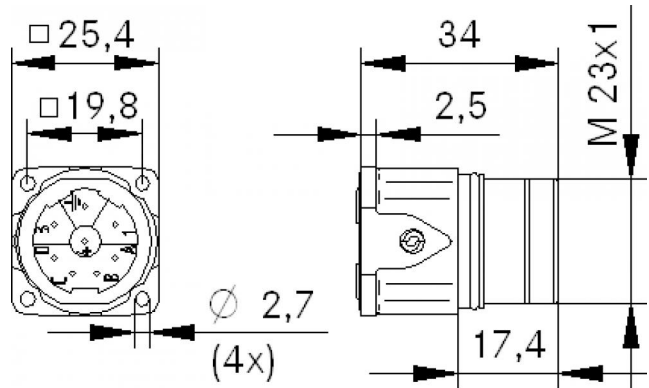

Product Management	Document: EPIC KIT LS1 A1 6-POL MALE	3 / 3
--------------------	--------------------------------------	-------

X-ON Electronics

Largest Supplier of Electrical and Electronic Components

Click to view similar products for [Circular MIL Spec Connector](#) category:

Click to view products by [Lapp Kabel](#) manufacturer:

Other Similar products are found below :

[89075GULPR](#) [0025-262-542](#) [0025-264-3014](#) [58-570121-04S](#) [0134-213-1208](#) [0134-213-2209](#) [0025-258-000](#) [60-042022-07P](#) [60-042022-19P](#)
[60-042022-23P](#) [60-042217-10P](#) [0114-201-1278](#) [012-0467-000](#) [602GB06EG24-61SN](#) [0134-201-1207](#) [0134-213-1006](#) [6104-207-2302](#) [6104-](#)
[208-1902](#) [61-168211-04P](#) [61-168617-10P](#) [6131-202-19149P](#) [6131-204-21149P](#) [6131-208-13149P](#) [6131-209-17149P](#) [6131-210-11149P](#) [6131-](#)
[211-19149P](#) [6131-216-19149P](#) [6131-259-21149P](#) [6131-259-23149P](#) [6131-265-17149P](#) [6131-265-19149P](#) [CS3100A18-1P-472](#) [CS3100A-36-](#)
[77P](#) [CS3101A-16-55P](#) [CS3102A-10SL-55P](#) [CS3102A-14S-58P](#) [CS3102A-32-17P](#) [CS3102A32-25S](#) [CS3102C18-4P-472](#)
[CS3106A10SL3S004](#) [CS3106A-18-73S](#) [CS3108A-14S-52S](#) [CS3108A-28-51S](#) [6162-233-1277](#) [6162-324-1231](#) [M243082296Z](#)
[M2884010AC1S1](#) [CT0-24-10SC](#) [CT0M20-7PCAU](#) [M28840/17AC1G3](#)