

EPR-PF

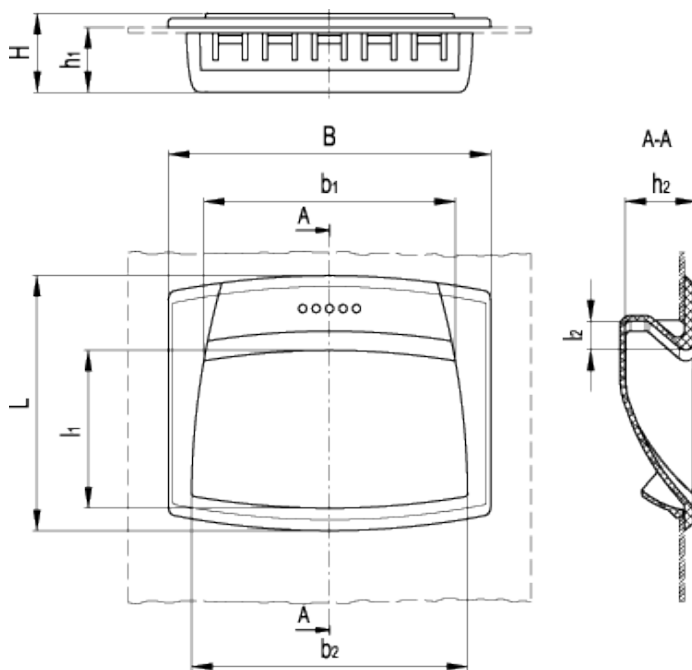

Flush pull handles
(snap-in assembly)



technical informations

Standard executions

EPR-PF: glass-fibre reinforced polyamide based (PA) technopolymer, grey-black colour, matte finish.

EPR-PF-CLEAN: glass-fibre reinforced polyamide based (PA) technopolymer, RAL 9002 white colour, matte finish.

EPR-PF-AE-VO: glass-fibre reinforced polyamide based (PA) technopolymer certified self-extinguishing UL-94 V0, grey-black colour, matte finish.

Resistant to solvents, oils, greases and other chemical agents.

Assembly

Snap-in assembly (see Assembly Instructions).

Ergonomy and design

A modern design thanks to the compact shape. The internal profile of the cavity offers a safe, comfortable and ergonomic grip. EPR-PF CLEAN is particularly suitable for application medical and hospital equipment and for food processing machines.

Technical data

The "V0" certification in accordance with UL-94 V (Underwriters Laboratories) indicates that on a plastic test sample with specific shape and dimensions, in the vertical position, the flame is extinguished within 10 seconds, without generating any incandescent drops.

The lifting (F_1) and pull out (F_2) resistance values reported in the table are the result of tests carried out in laboratory with handles assembled on strengthened metal sheet panels with thickness = 1.5 mm (strengthened for test purposes).

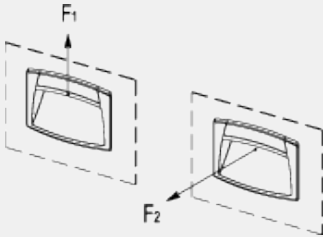

Assembly instructions

- 1) Drill the handle housing according to the template dimensions reported in the table.
- 2) Remove all drilling burrs before fitting the handle.
- 3) Fit the upper part of the handle into the housing (Fig. 1).
- 4) Press onto the lower part until the handle is completely inserted (Fig. 2).

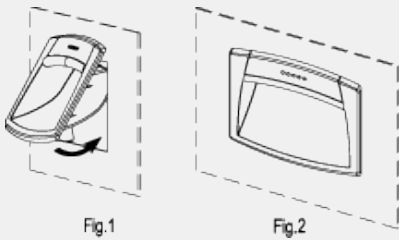

Standard Elements		Main dimensions										F_1	F_2	Weight
Code	Description	B	L	H	h_1	h_2	b_1	b_2	l_1	l_2	[N]	[N]	g	
261051-C1	EPR.90-PF-C1	90	50	19	17	17.5	76	79	28	7	1800	500	20	
261111-C1	EPR.120-PF-C1	120	95	28.5	24	26.5	94	103	58	11	1000	250	58	
151001	EPR.90-PF-CLEAN	90	50	19	17	17.5	76	79	28	7	1800	500	20	
151011	EPR.120-PF-CLEAN	120	95	28.5	24	26.5	94	103	58	11	1000	250	58	
150611-C1	EPR.90-PF-AE-V0-C1	90	50	19	17	17.5	76	79	28	7	1800	500	20	
150651-C1	EPR.120-PF-AE-V0-C1	120	95	28.5	24	26.5	94	103	58	11	1000	250	58	

Drilling template

(remove all drilling burrs before fitting the handle)

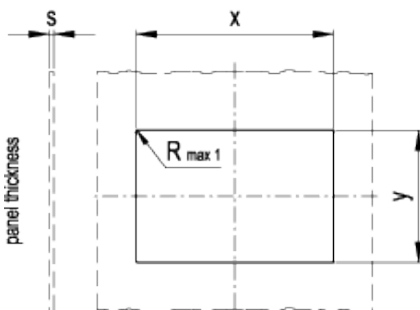

EPR.90-PF			EPR.120-PF		
panel thickness s	x	y	panel thickness s	x	y
0.7	85 ^{+0.2}	34.9 ^{±0.1}	0.7	107.5 ^{+0.2}	70.6 ^{±0.1}
1	85 ^{+0.2}	35.1 ^{±0.1}	1	107.5 ^{+0.2}	70.9 ^{±0.1}
1.5	85 ^{+0.2}	36.1 ^{±0.1}	1.5	107.5 ^{+0.2}	71.3 ^{±0.1}
2	85 ^{+0.2}	36.1 ^{±0.1}	2	107.5 ^{+0.2}	71.6 ^{±0.1}
2.2	85 ^{+0.2}	36.1 ^{±0.1}	2.2	107.5 ^{+0.2}	71.6 ^{±0.1}

This product had the following design awards:



ELESA and GANTER models all rights reserved in accordance with the law. Always mention the source when reproducing our drawings.

STANDARD MACHINE ELEMENTS WORLDWIDE

X-ON Electronics

Largest Supplier of Electrical and Electronic Components

Click to view similar products for [Mounting Fixings](#) category:

Click to view products by [Elesa & Ganter](#) manufacturer:

Other Similar products are found below :

[007310](#) [007541](#) [6-141-P](#) [620HA038NF09](#) [620HA038NF11](#) [71-074914-006](#) [71-146610-6H](#) [712HA170B23128-N](#) [71-441549-19S](#) [71-490451-4H](#) [75-69211-3P](#) [75-69220-27S](#) [75-69224-5S](#) [770-006A109](#) [770-006A109R](#) [770-006A207](#) [770-006A208W1](#) [770-006A209](#) [770-006A306](#) [770-006A703W1](#) [770-006A704](#) [770-006A704W1](#) [770-006A705](#) [770-006A706](#) [770-006A706W1](#) [770-006A707](#) [770-006A709](#) [770-007A203](#) [770-007A203W1](#) [770-007A204W1](#) [770-007A207W1](#) [770-007A703](#) [770-007A704W1](#) [770-007A706](#) [770-007A707W1](#) [770-010Y208](#) [770-010Y308](#) [770-010Y705](#) [770-010Y706](#) [770-010Y707W1](#) [770-011T201](#) [770-011T203](#) [770-011T701W1](#) [770-011T702](#) [770-011T702W1](#) [770-011T703](#) [770-013210W1](#) [770-013311](#) [770-013312](#) [770-013709](#)