

SPECIFICATION MODEL: "SL19" SERIES

6A 120VAC, 3A 250VAC (UL)  
 6A 28VAC (UL)  
 INITIAL CONTACT RESISTANCE : 10mΩ (max)  
 INSULATION RESISTANCE: 500VDC 100MΩ (min)  
 DIELECTRIC STRENGTH: 1,000VAC FOR 1 MINUTE  
 LIFE CYCLE : 30,000 CYCLES  
 TEMPERATURE RANGE: -20°C TO 85°C  
 CASE: DIALYL PHTHALATE (DAP)  
 HOUSING: STAINLESS STEEL  
 SLIDE HANDLE: NYLON66  
 CONTACT: COIN SILVER, SILVER PLATED  
 CENTER CONTACT & TERMINALS : BRASS SILVER PLATED

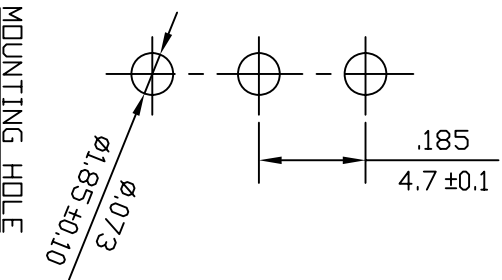
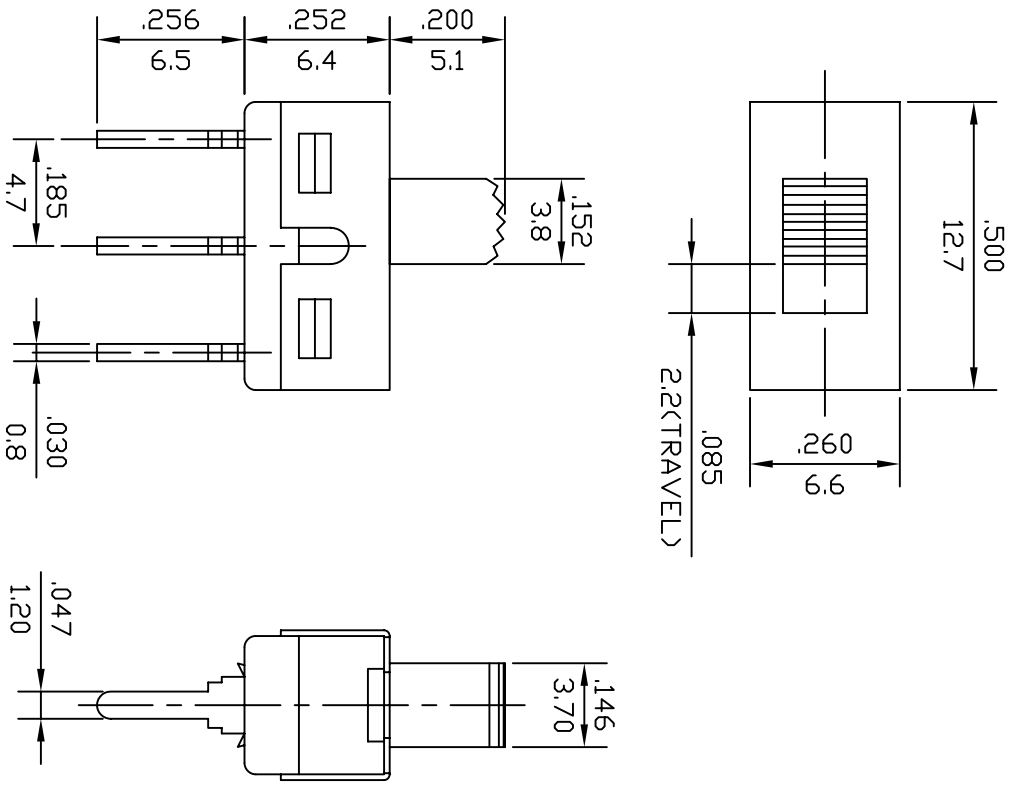

REVISION	DESCRIPTION	REVISED BY	TOLERANCES X±0.3	ANGLE $\frac{1}{2}^\circ$	UNIT mm	PART NAME	SL19 SPEC DRAWING	DWG NO
△			DRAWN BY 吳美玉	DESIGNED BY	3/1			WS0205A
△			CHECKED BY 吳美玉	APPROVED BY				
△	2005.12.14 換新圖框 重新出圖			DATE 2003.12.24		PART NO	SL19-121	

## X-ON Electronics

Largest Supplier of Electrical and Electronic Components

*Click to view similar products for [Slide Switches](#) category:*

*Click to view products by [Canal manufacturer](#):*

Other Similar products are found below :

[6-1437581-1](#) [M43R](#) [MHS123K15D](#) [MHSS1104A](#) [MMD](#) [GH49S010001](#) [GH49WW00001](#) [1437576-8](#) [EPS1PC1](#) [1825074-1](#) [1825160-3](#)  
[1825167-2](#) [25139NLDB](#) [25436NLDB](#) [25449NAH](#) [25536NA](#) [L101011ML04B](#) [SLB1240R45](#) [SLSA12004](#) [1825078-1](#) [1825080-4](#) [1825081-1](#)  
[1825269-1](#) [1825270-2](#) [STS141RA04](#) [T2215BEN506](#) [GF-124-0204](#) [GH46P000001](#) [GH46W000001](#) [GH49P010001](#) [25339NA](#) [25436NLDH](#)  
[CST91246FK](#) [TG36P000000](#) [TG36P000050](#) [47227LFE](#) [49331L](#) [MHSS1105A](#) [50208L](#) [HW4S-5LF22N3](#) [L202091MS02Q](#) [4-1437581-7](#)  
[X2225CR-437W](#) [48BFSP3M2QT](#) [49329L](#) [1101M1S3ZB8E2](#) [1-1437581-1](#) [EG1218REDACTUATOR](#) [TG39W000000](#) [1825075-1](#)