



inserts:		page
CDD	24 poles + ⊕	53
CQE	10 poles + ⊕	74
CN	6 poles + ⊕	80
CCE	6 poles + ⊕	86
CNE, CSE	6 poles + ⊕	87
CSS	6 poles + ⊕	98
CTE, CTSE	6 poles + ⊕	106
MIXO	2 modules	137÷151

insert centre distance:
44 x 27 mm

bulkhead mounting housings with single lever



bulkhead mounting housings with 2 pegs



description	part No.	part No.
with lever	CHI 06 L	
with lever and cover	CHI 06 LS	
with pegs ¹⁾		CHI 06 LC
with pegs and aluminium cover ¹⁾		CHI 06 LCS
with pegs and plastic cover ¹⁾		CHI 06 LCP

¹⁾ May be combined with hoods:
- CHO/CHV 06 LX
- MHO/MHV 06 LX

N.B.: the enclosures ensure IP66 protection (or IP65 cover versions) rating when mated and locked with the closing levers.
The cover (CS, CP) only ensures mechanical protection, but does not ensure IP65 protection rating.

panel cut-out for bulkhead mounting housings in mm

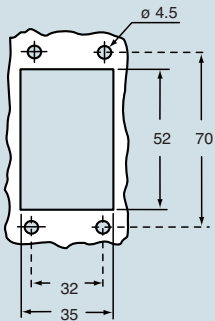

dimensions in mm

CHI L

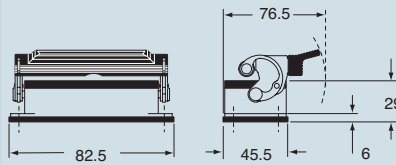

CHI LS

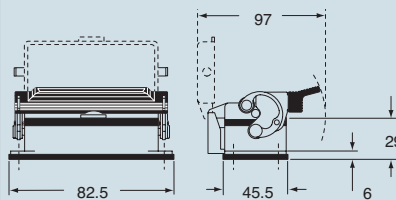

dimensions in mm

CHI LC

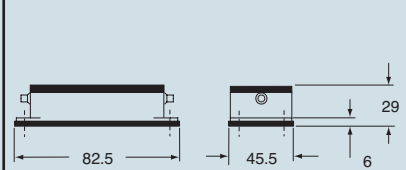

CHI LCS/LCP

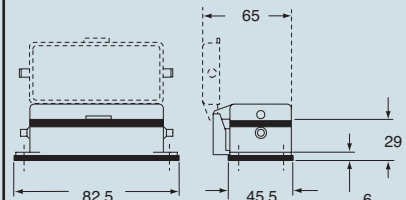

CRUS® Type 4/4X/12
(excluding enclosures with plastic cover)

dimensions indicated are not binding and may be changed without notice

size 44.27



inserts:		page
CDD	24 poles + ⊕	53
CQE	10 poles + ⊕	74
CN	6 poles + ⊕	80
CCE	6 poles + ⊕	86
CNE, CSE	6 poles + ⊕	87
CSS	6 poles + ⊕	98
MIXO	2 modules	137÷151

insert centre distance:
44 x 27 mm

surface mounting housings with single lever



description	part No.	entry Pg	part No.	entry M
	with lever	CHP 06 L	16	MHP 06 L20
with lever	CHP 06 L2	16 x 2	MHP 06 L220	20 x 2
with lever, high construction	CAP 06 L	21	MAP 06 L32	32
with lever, high construction	CAP 06 L2	21 x 2	MAP 06 L232	32 x 2
with lever, high construction	CAP 06 L29	29	MAP 06 L40	40
with lever, high construction	CAP 06 L229	29 x 2	MAP 06 L240	40 x 2
with lever and cover	CHP 06 LS	16	MHP 06 LS20	20
with lever and cover	CHP 06 LS2	16 x 2	MHP 06 LS220	20 x 2
with lever and cover, high construction	CAP 06 LS	21	MAP 06 LS32	32
with lever and cover, high construction	CAP 06 LS2	21 x 2	MAP 06 LS232	32 x 2
with lever and cover, high construction	CAP 06 LS29	29	MAP 06 LS40	40
with lever and cover, high construction	CAP 06 LS229	29 x 2	MAP 06 LS240	40 x 2

N.B.: the enclosures ensure IP66 protection (or IP65 cover versions) rating when mated and locked with the closing levers.
The cover (CS, CP) only ensures mechanical protection, but does not ensure IP65 protection rating.

dimensions in mm

CHP L - CAP L and MHP L - MAP L

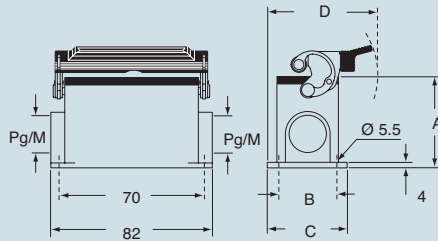

CHP LS - CAP LS and MHP LS - MAP LS

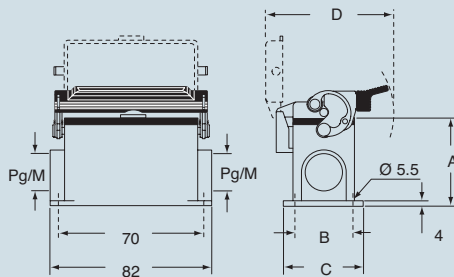

CAVUS® Type 4/4X/12

type	A	B	C	D
CHP L / MHP L	53	40	52	73.5
CAP L / MAP L	74	45	57	82
CHP LS / MHP LS	53	40	52	97
CAP LS / MAP LS	74	45	57	97

dimensions indicated are not binding and may be changed without notice



inserts:		page
CDD	24 poles + ⊕	53
CQE	10 poles + ⊕	74
CN	6 poles + ⊕	80
CCE	6 poles + ⊕	86
CNE, CSE	6 poles + ⊕	87
CSS	6 poles + ⊕	98
MIXO	2 modules	137÷151

insert centre distance:
44 x 27 mm

hoods with 2 pegs



hoods with single lever



description	part No.		part No.		part No.		part No.	
		entry Pg		entry M		entry Pg		entry M
with pegs, side entry	CHO 06 L13	13,5	MHO 06 L20	20				
with pegs, side entry	CHO 06 L16	16	MHO 06 L25	25				
with pegs, side entry, high construction	CAO 06 L21	21	MAO 06 L25	25				
with pegs, side entry, high construction	CAO 06 L29	29	MAO 06 L32	32				
with pegs, side entry, high construction, without adaptor *	CFO 06 L21	21	MFO 06 L25	25				
with pegs, side entry, high construction, without adaptor *	CFO 06 L29	29	MFO 06 L32	32				
with pegs, top entry	CHV 06 L13	13,5	MHV 06 L20	20				
with pegs, top entry	CHV 06 L16	16	MHV 06 L25	25				
with pegs, top entry, high construction	CAV 06 L21	21	MAV 06 L25	25				
with pegs, top entry, high construction	CAV 06 L29	29	MAV 06 L32	32				
with pegs, top entry, high construction, without adaptor *	CFV 06 L21	21	MFV 06 L25	25				
with pegs, top entry, high construction, without adaptor *	CFV 06 L29	29	MFV 06 L32	32				
with lever, top entry					CHV 06 LG	16	MHV 06 LG25	25
with lever, top entry, high construction					CAV 06 LG21	21	MAV 06 LG25	25
with lever, top entry, high construction					CAV 06 LG29	29	MAV 06 LG32	32
with lever, top entry, high constr., without adaptor *					CFV 06 LG21	21	MFV 06 LG25	25
with lever, top entry, high constr., without adaptor *					CFV 06 LG29	29	MFV 06 LG32	32

* enclosure without adaptor, threaded on the body, to be used only with a complete cable clamp.

dimensions in mm

CHO L (CAO L) and (CFO L)
MHO L (MAO L) and (MFO L)

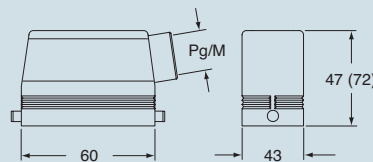

CHV L (CAV L) and [CFV L]
MHV L (MAV L) and [MFV L]

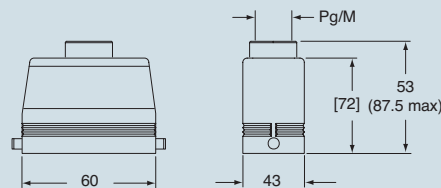

dimensions in mm

CHV LG (CAV LG) and [CFV LG]
MHV LG (MAV LG) and [MFV LG]

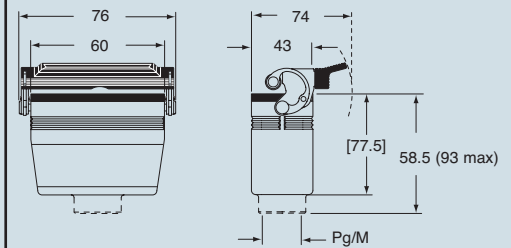

CALUS® Type 4/4X/12

dimensions indicated are not binding and may be changed without notice



inserts:		page
CDD	24 poles + ⊕	53
CQE	10 poles + ⊕	74
CN	6 poles + ⊕	80
CCE	6 poles + ⊕	86
CNE, CSE	6 poles + ⊕	87
CSS	6 poles + ⊕	98
CTE, CTSE	6 poles + ⊕	106
MIXO	2 modules	137÷151

insert centre distance:
44 x 27 mm

hoods with single lever



covers

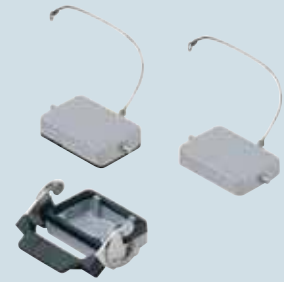

description	part No.		part No.		part No.
		entry Pg		entry M	
with lever, without gasket, side entry ¹⁾	CHO 06 LX16	16	MHO 06 LX20	20	
with lever, without gasket, side entry ¹⁾			MHO 06 LX25	25	
with lever, without gasket, top entry ¹⁾	CHV 06 LX16	16	MHV 06 LX20	20	
with lever, without gasket, top entry ¹⁾			MHV 06 LX25	25	
with lever (for hoods with pegs)					CHC 06 LG
with pegs (for housings with lever)					CHC 06 L
with pegs and gasket (for hoods with lever) ²⁾					CHC 06 LC

¹⁾ May be combined with housings: CHI 06 LCS/LCP/LC

²⁾ May be combined with housings:
- CHO/CHV 06 LX
- MHO/MHV 06 LX

dimensions in mm

CHO LX and MHO LX

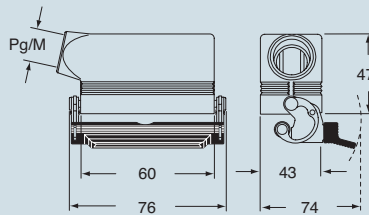

CHV LX and MHV LX

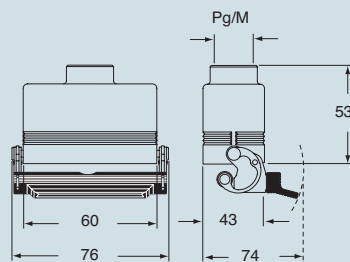

dimensions in mm

CHC LG

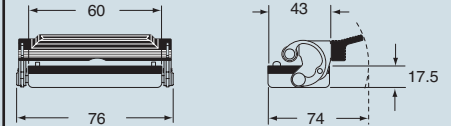

CHC L

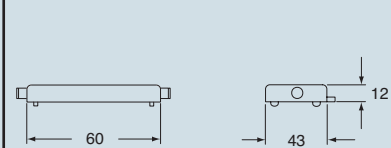

CHC LC

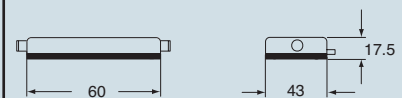

CALUS® Type 4/4X/12

dimensions indicated are not binding and may be changed without notice

size 44.27



inserts:	page
CN RY 6 poles + ⊕	80
CNE RY 6 poles + ⊕	87

insert centre distance:
44 x 27 mm

housings and cover

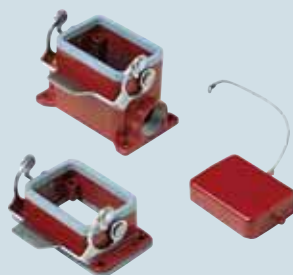

hoods and cover



description	part No.		part No.		part No.		part No.	
		entry Pg		entry M		entry Pg		entry M
bulkhead housing with lever	CZIR 06 L	---						
surface housing with lever	CZPR 06 L	16	MZPR 06 L20	20				
surface housing with lever, high construction	CZAPR 06 L	21	MZAPR 06 L32	32				
cover with pegs (for housings)	CHCR 06 L	---						
with pegs, side entry					CHOR 06 L13	13.5	MHOR 06 L20	20
with pegs, side entry, high construction					CAOR 06 L21	21	MAOR 06 L32	32
with pegs, top entry					CHVR 06 L13	13.5	MHVR 06 L20	20
with pegs, top entry, high construction					CAVR 06 L21	21	MAVR 06 L32	32
cover with lever (for hoods)					CZCR 06 LG	---		

panel cut-out for bulkhead mounting housings in mm

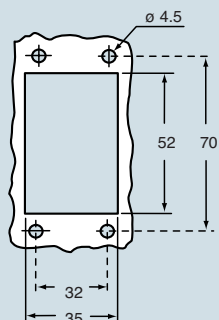

dimensions in mm

CZIR L

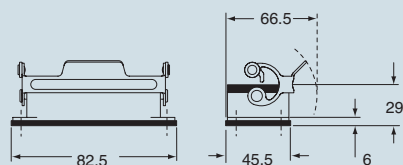

CZPR L - CZAPR L and MZPR L - MZAPR L

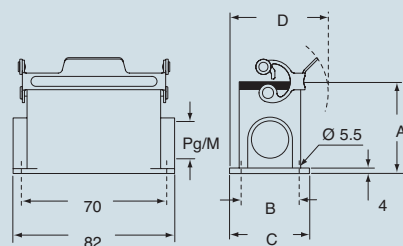

CHCR L

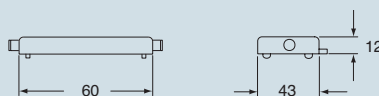

dimensions in mm

CHOR L (CAOR L) and MHOR L (MAOR L)

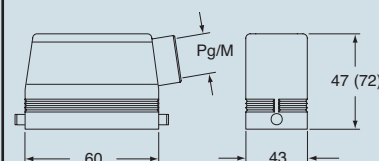

CHVR L (CAVR L) and MHVR L (MAVR L)

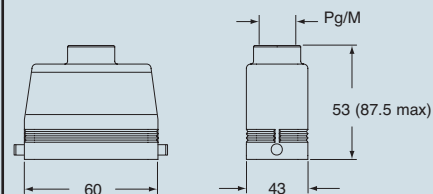

CZCR LG

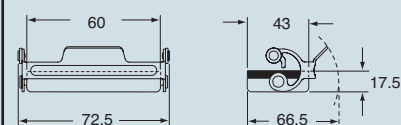

CALUS® Type 4/4X/12

type	A	B	C	D
CZPR L / MZPR L	53	40	52	69.5
CZAPR L / MZAPR L	74	45	57	72

dimensions indicated are not binding and may be changed without notice

size 44.27



inserts:		page
CDD	24 poles + ⊕	53
CQE	10 poles + ⊕	74
CN	6 poles + ⊕	80
CCE	6 poles + ⊕	86
CNE, CSE.....	6 poles + ⊕	87
CSS	6 poles + ⊕	98
CTE, CTSE *).....	6 poles + ⊕	106
MIXO	2 modules	137-151

insert centre distance:
44 x 27 mm

*) only for enclosure CHIW 06 L

housings and cover



hoods and cover



description	part No.		part No.		part No.		part No.	
		entry Pg		entry M		entry Pg		entry M
bulkhead housing with lever	CHIW 06 L	---						
surface housing with lever, high construction	CAPW 06 L	21	MAPW 06 L32	32				
cover with pegs (for enclosures with lever)	CHCW 06 L							
with pegs, side entry, high construction					CAOW 06 L21	21	MAOW 06 L32	32
with pegs, top entry, high construction					CAVW 06 L21	21	MAVW 06 L32	32
cover with lever (for enclosures with pegs)					CHCW 06 LG			
with lever and gasket, top entry, high construction					CAVW 06 LG	21	MAVW 06 LG32	32

panel cut-out for bulkhead mounting housings in mm

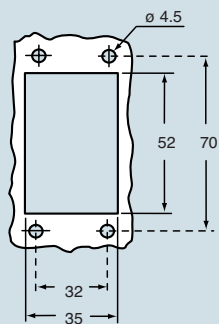

dimensions in mm

CHIW L

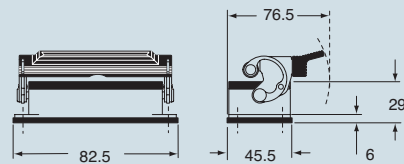

CAPW L and MAPW L

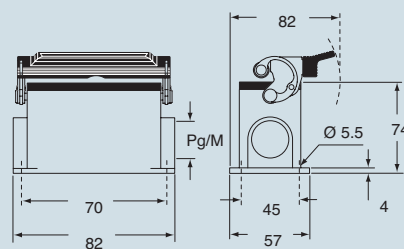

CHCW L



dimensions in mm

CAOW L and MAOW L

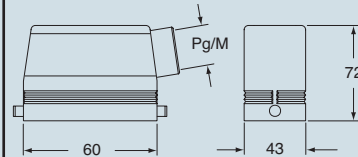

CAVW L and MAVW L

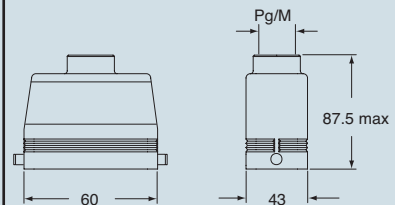

CHCW LG

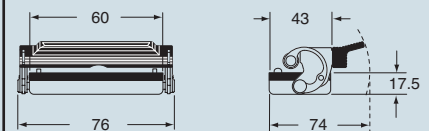

CAVW LG and MAVW LG

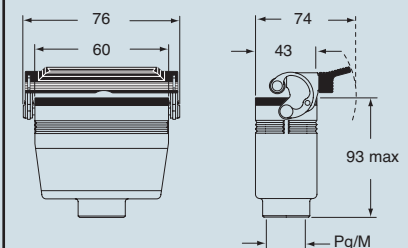

CAVUS® Type 4/4X/12

dimensions indicated are not binding and may be changed without notice

size 44.27



inserts:		page
CDD	24 poles + ⊕	53
CQE	10 poles + ⊕	74
CN	6 poles + ⊕	80
CCE	6 poles + ⊕	86
CNE, CSE	6 poles + ⊕	87
CSS	6 poles + ⊕	98
CTE, CTSE *)	6 poles + ⊕	106
MIXO	2 modules	137÷151

insert centre distance:
44 x 27 mm

*) only for enclosure CHIS 06 L

housings and cover for electromagnetic compatibility



hoods and cover for electromagnetic compatibility



description	part No.		part No.		part No.		part No.	
	entry Pg	entry M	entry Pg	entry M	entry Pg	entry M	entry Pg	entry M
bulkhead housing with lever	---	---	---	---	---	---	---	---
surface housing with lever, high construction	21	32	21	32	21	32	21	32
cover with pegs (for enclosures with lever)	---	---	---	---	---	---	---	---
with pegs, side entry, high construction	---	---	---	---	21	32	21	32
with pegs, top entry, high construction	---	---	---	---	21	32	21	32
cover with lever (for enclosures with pegs)	---	---	---	---	---	---	---	---

panel cut-out for bulkhead mounting housings in mm

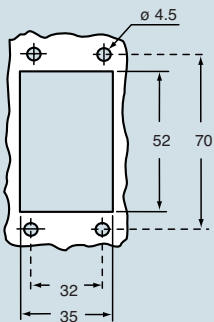

dimensions in mm

CHIS L

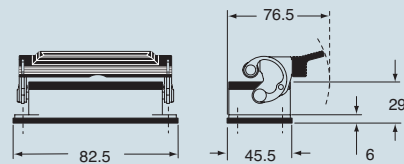

CAPS L and MAPS L

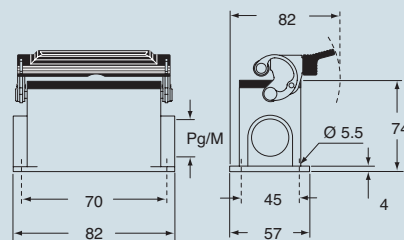

CHCS L



dimensions in mm

CAOS L and MAOS L

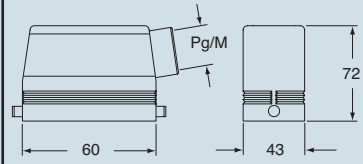

CAVS L and MAVS L

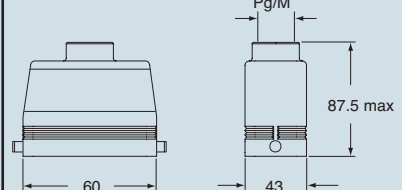

CHCS LG

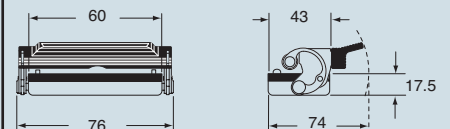

CAUS® Type 4/4X/12

dimensions indicated are not binding and may be changed without notice

X-ON Electronics

Largest Supplier of Electrical and Electronic Components

Click to view similar products for [Standard Circular Connector](#) category:

Click to view products by [ILME](#) manufacturer:

Other Similar products are found below :

[C015 10F006 001 1](#) [5M2530B10P](#) [600247N007](#) [600259N006](#) [600273N007](#) [600432N009](#) [6280-2PG-519](#) [6280-3PG-311](#) [6280-3SG-311](#)
[6280-7SG-3DC](#) [6280-7SG-522](#) [6282-5PG-311](#) [6282-6PG-519](#) [6282-8SG-311](#) [6283-11](#) [6283-15](#) [6290](#) [6293](#) [6382-2PG-311](#) [6382-2PG-3DC](#)
[6382-2SG-321](#) [6382-2SG-3DC](#) [6382-4SG-516](#) [67-03E20-37P](#) [681-PMG](#) [CXS3102A14S2P](#) [CXS3102A181S](#) [CXS3106A14S6S](#)
[D38999/20FC8SA L/C](#) [MB12P-1](#) [MB12R-6](#) [7251-2PG-300](#) [7251-2SG-300](#) [7251-4PG-300](#) [7251-4SG-300](#) [7251-5PG-300](#) [7251-5SG-300](#)
[7251-6SG-300](#) [7251-7PG-300](#) [7251-8PG-300](#) [7271-6SG-300](#) [7282-3PG-300-CH3](#) [73000005663](#) [75-190011-03P](#) [75-190216-08S](#) [75-190218-](#)
[10P](#) [75-214636-52P](#) [75-474118-10P](#) [75-474211-03P](#) [75-474218-19S](#)