

FRC6 RELAY



FEATURES

Small size & High Contact Rating 100A

High temperature design
Ideal for using in Automobile
Plug in terminal

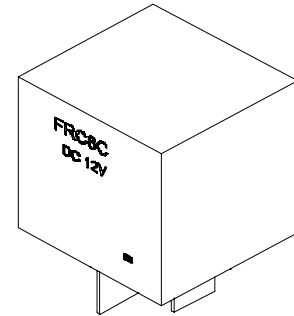

SPECIFICATIONS

COIL RATING

RATED VOLTAGE (V DC)	COIL RESISTANCE Ω +/- 10 %	RATED CURRENT (mA)	MUST OPERATE VOLTAGE	MUST DROPOUT VOLTAGE	MAXIMUM VOLTAGE	POWER CONSUMPTION
			% OF RATED VOLTAGE (At +20 °C)			
12	50	240	65 Max.	10 Min.	130 Max.	2.9W (Approx.)
24	195	123				

If with Resistor : 12VDC with 680Ω +/- 10%
24VDC with 2702Ω +/- 10%

CHARACTERISTICS

Contact Arrangement	SPST (1 FORM A) SPDT (1 FORM C)
Contact Material	Silver Alloy
Contact Resistance	30m Ω Max.
Contact Rating (Resistive Load)	FRC6 NO : 100A 12VDC, 50A 24VDC; NC : 80A 12VDC, 40A 24VDC FRC6B NO : 150A 12VDC, 70A 24VDC; NC : 100A 12VDC, 50A 24VDC
Switching Current	100A Max.
Switching Voltage	DC 75V (Max.)
Voltage Drop	•200mV (at Contact Rating)
Operate Time (Initial)	10ms Max. Typical
Release Time (Initial)	5ms Max. Typical
Insulation Resistance	100M Ω Min. (at 500V DC)
Dielectric Strength	500Vrms between coil and contact
Shock Resistance	147m/s ² 11ms
Vibration Resistance	1.5mm Double Amplitude; 10-40Hz
Ambient Temperature	-40°C to +85°C
Humidity	40 ~ 85% R.H.
Operation Life	Mechanical : 10 ⁷ Electrical : 10 ⁵ (At rated load)
Weight	35g Approx.

[Specifications are subject to change without notices.]

FORWARD INDUSTRIAL COMPANY. (O/B COMMERCIAL UNION LTD)

RM. 1405, Wu Sang House, 655 Nathan Road, Mongkok, Kowloon, Hong Kong.

TEL : (852) 27892365 FAX : (852) 27893102 E-MAIL : sales@ficrelay.com.hk

WEBSITE : <http://www.ficrelay.com.hk>

FRC6 RELAY



ORDERING INFORMATION

FRC6 B A - 1 N DC 12V

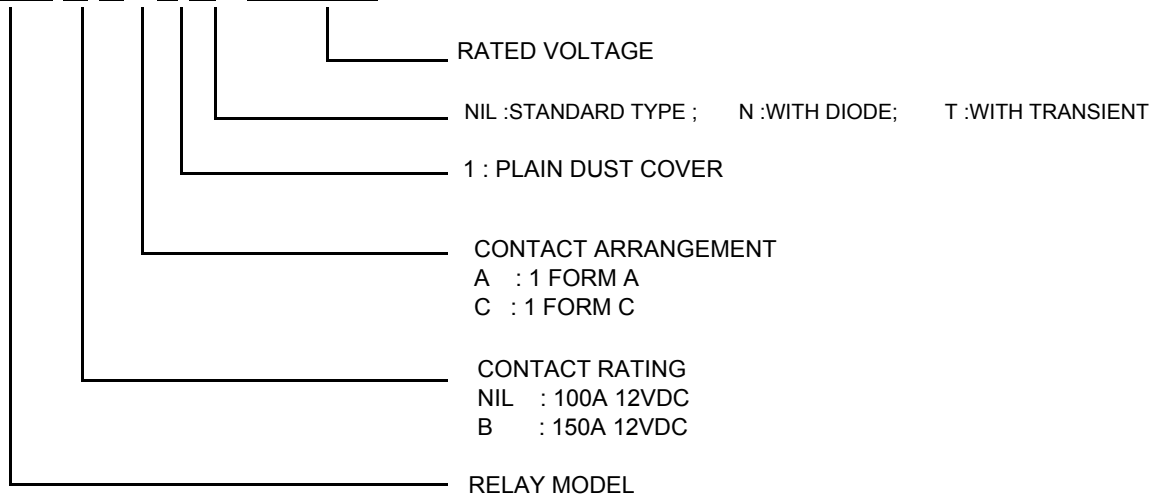

Note : Pb-Free and RoHS compliant relays are available.
 For ordering, please add suffix "Pb-Free" or "RoHS" to standard relay part numbers.

For example : FRC6A-1 DC 12V "Pb-Free" for Pb-Free Relay
 For example : FRC6A-1 DC 12V "RoHS" for RoHS Compliant Relay

DIMENSIONS (UNIT : mm)

50A / DC 24V

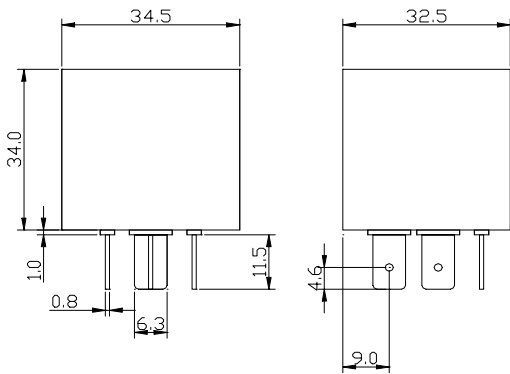

100A / DC 12V

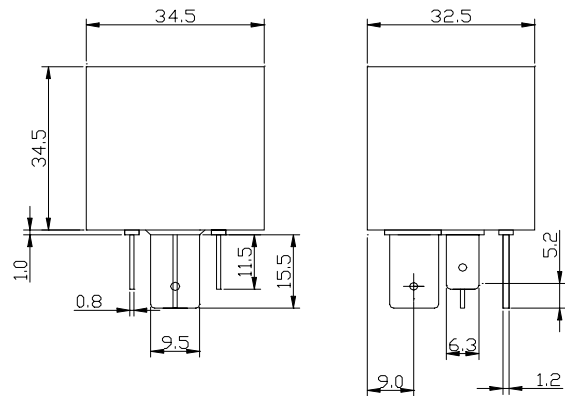

MOUNTING (BOTTOM VIEW)

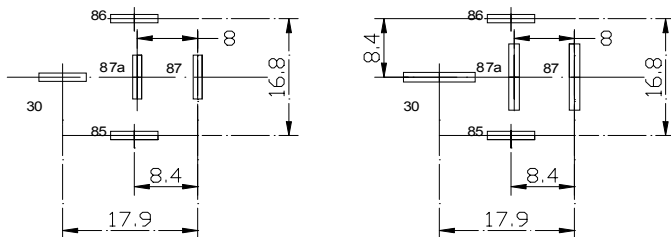

TERMINAL ARRANGEMENT (BOTTOM VIEW)

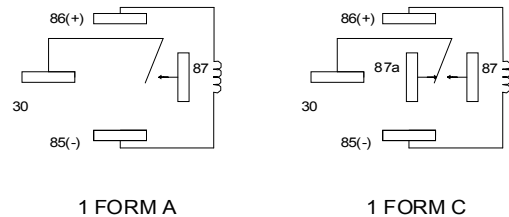

50A/ DC 24V

Terminal width
 Coil : 6.3mm
 Contact : 6.3mm

100A/ DC 12V

Terminal width
 Coil : 6.3mm
 Contact : 9.5mm

X-ON Electronics

Largest Supplier of Electrical and Electronic Components

Click to view similar products for [Automotive Relays](#) category:

Click to view products by [Forward](#) manufacturer:

Other Similar products are found below :

[896H-1AH-D1SW-001-24VDC](#) [896H-1AH-D1SW-R1-12VDC](#) [896H-1CH-C1-001-12VDC](#) [896H-1CH-S-24VDC](#) [896HP-1AH-C-12VDC](#)
[G5CE1ASIDC12](#) [AEV31024](#) [1393204-2](#) [1393302-3](#) [13Z99A115-0074](#) [1432872-1](#) [1617057-2](#) [2-1617057-2](#) [CB1F-M-12V-H15](#) [CB1-T-R-M-](#)
[12V](#) [896H-1CH-D1SF-R1-12VDC](#) [896H-1CH-D1SF-R1-T-12VDC](#) [898H-1AH-D-001-12VDC](#) [24198-1](#) [5-1616920-2](#) [5-1617052-9](#) [5407-](#)
[0011-HS](#) [CB1AF-M-12V-H59](#) [5-1617346-8](#) [103-1AH-C-12VDC](#) [CF2Q-12V](#) [V23134A1052X299](#) [CP112J](#) [896H-1AH-S1-001-12VDC](#)
[897H-1AH-D-R1-U01-12VDC](#) [896H-1CH-D-U39-24VDC](#) [896HP-1AH-C-U2120VDC](#) [896E-1CH-D1SW-U57-12VDC](#) [896H-1CH-D1SW-](#)
[R1-U30-12VDC](#) [896H-1AH-C1S-R1-24VDC](#) [102-1CH-C-12VDC](#) [V23076A3001D142T](#) [1-19042-6](#) [3-1393305-1](#) [J7TKNA9](#)
[V23234A1001X043-EV-144](#) [V23086-R1851-A502](#) [898H-1AH-D1SW-R1-12VDC](#) [RH4C1P2607](#) [RE031005](#) [V23134M0052G242](#) [1393204-1](#)
[G8N-1L-AS DC12](#) [V23076A3022D142](#) [V23074A2001A402](#)