

### TSM102A1

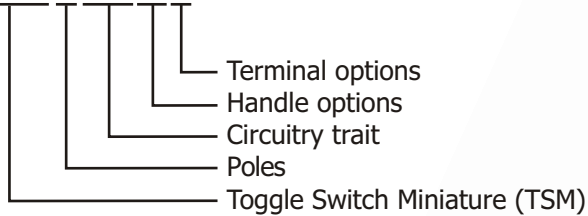

### Specification:

- 1) Rating: 6 A 125 VAC; 3 A 250 VAC
- 2) Contact Resistance: 20 mW max.
- 3) Insulation Resistance: 500 VDC 1000 MW min.
- 4) Dielectric strength: 1500 VAC, 1 minute
- 5) Operating Temperature: -25°C ~ +85°C
- 6) Electrical Life: 20000 cycles

### CIRCUITRY TRAIT

Model No				Terminals
101	ON	-	OFF	2P
102	ON	-	ON	3P
112	ON	-	(ON)	3P
103	ON	OFF	ON	3P
113	ON	OFF	(ON)	3P
123	(ON)	OFF	(ON)	3P
201	ON	-	OFF	4P
202	ON	-	ON	6P
212	ON	-	(ON)	6P
203	ON	OFF	ON	6P
213	ON	OFF	(ON)	6P
223	(ON)	OFF	(ON)	6P

### TOGGLE CAP (D)

omitted when without toggle cap

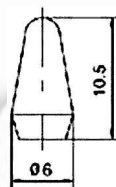

- BK black
- WH white
- RD red
- YL yellow
- GN green
- BL blue

### BASE COLOUR

- BK black
- RD red
- GN green
- omitted when standard colour (blue)

### PROTECTIV CAP

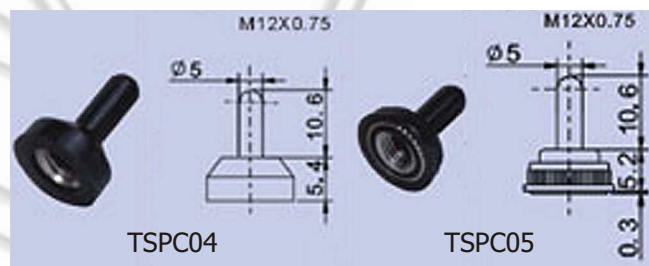

### HANDLE OPTIONS

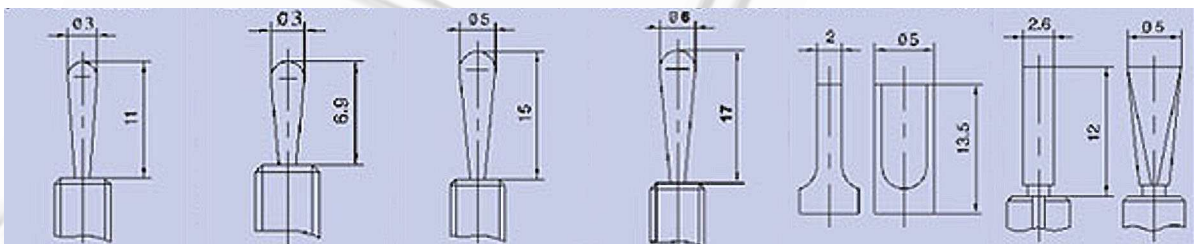

Standard (A)    Short (C)    Grand (G)    Large cap (L)    Plastic Flat (E)    Metal Flat (F)

### TERMINAL OPTIONS

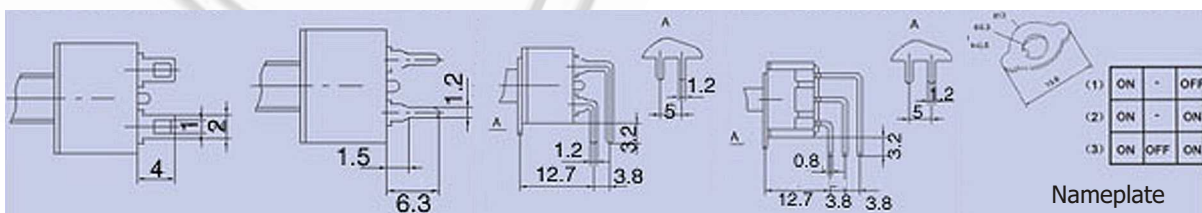

Solder terminal (1)    PC terminal (2)    PC-H terminal (3)    PC-V terminal (4)

# Ninigi



**TSM101** ON-OFF  
SPST 2P

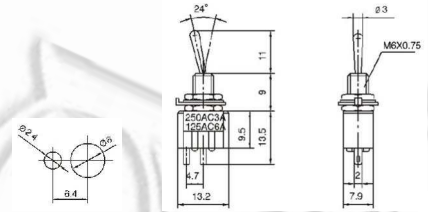

**TSM102** ON-ON  
**TSM112** ON-(ON)  
**TSM103** ON-OFF-ON  
**TSM113** ON-OFF-(ON)  
**TSM123** (ON)-OFF-(ON)  
**TSM1033** ON-ON-ON  
SPDT 3P

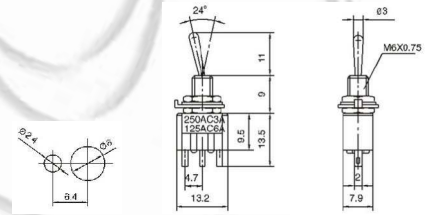

**TSM201** ON-OFF  
DPST 4P

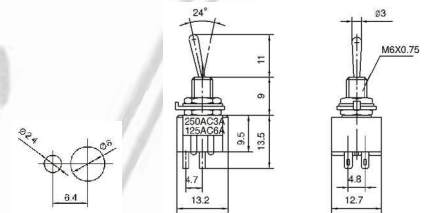

**TSM202** ON-ON  
**TSM212** ON-(ON)  
**TSM203** ON-OFF-ON  
**TSM213** ON-OFF-(ON)  
**TSM223** (ON)-OFF-(ON)  
**TSM2033** ON-ON-ON  
DPDT 6P

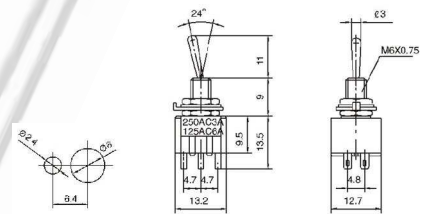

**TSM302** ON-ON  
**TSM303** ON-OFF-ON  
3PST 2P

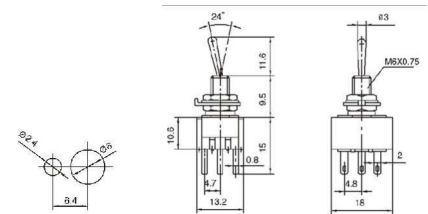

**TSM101A2** ON-OFF  
SPST 2P

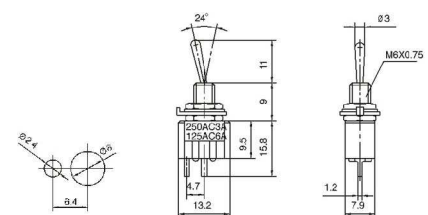

# Ninigi



**TSM102A2** ON-ON  
**TSM112A2** ON-(ON)  
**TSM103A2** ON-OFF-ON  
**TSM113A2** ON-OFF-(ON)  
**TSM123A2** (ON)-OFF-(ON)  
 SPDT 3P

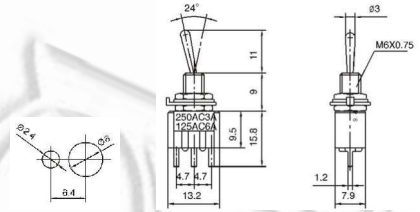

**TSM201A2** ON-OFF  
 DPST 4P

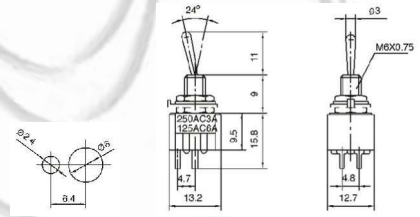

**TSM202A2** ON-ON  
**TSM212A2** ON-(ON)  
**TSM203A2** ON-OFF-ON  
**TSM213A2** ON-OFF-(ON)  
**TSM223A2** (ON)-OFF-(ON)  
 SPDT 3P

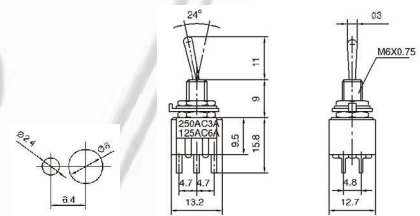

**TSM302A2** ON-ON  
**TSM303A2** ON-OFF-ON  
 3PST 9P

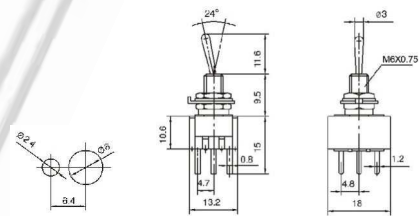

**TSM102A2T** ON-ON  
**TSM112A2T** ON-(ON)  
**TSM103A2T** ON-OFF-ON  
**TSM113A2T** ON-OFF-(ON)  
**TSM123A2T** (ON)-OFF-(ON)  
 SPDT 3P

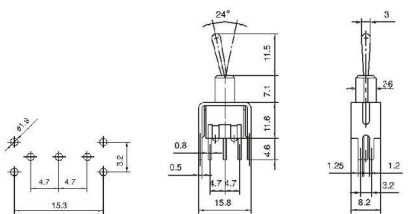

**TSM202A2T** ON-ON  
**TSM212A2T** ON-(ON)  
**TSM203A2T** ON-OFF-ON  
**TSM213A2T** ON-OFF-(ON)  
**TSM223A2T** (ON)-OFF-(ON)  
 DPDT 6P

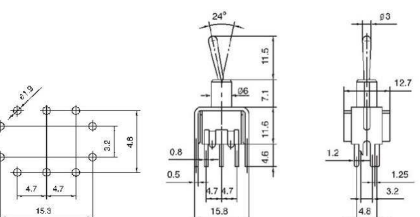

# Ninigi



**TSM102C3** ON-ON  
**TSM112C3** ON-(ON)  
**TSM103C3** ON-OFF-ON  
**TSM113C3** ON-OFF-(ON)  
**TSM123C3** (ON)-OFF-(ON)  
 SPDT 3P

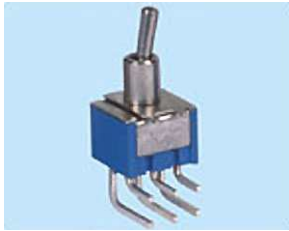
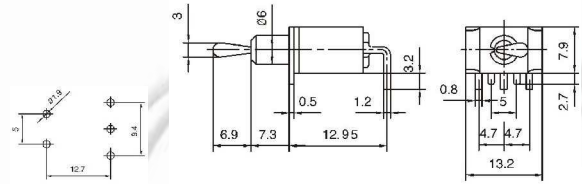

**TSM202C3** ON-ON  
**TSM212C3** ON-(ON)  
**TSM203C3** ON-OFF-ON  
**TSM213C3** ON-OFF-(ON)  
**TSM223C3** (ON)-OFF-(ON)  
 DPDT 3P

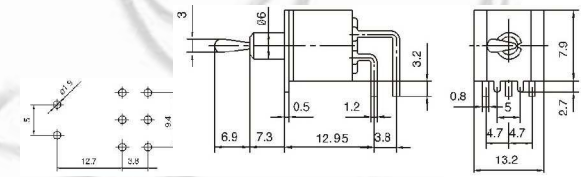

**TSM102C4** ON-ON  
**TSM112C4** ON-(ON)  
**TSM103C4** ON-OFF-ON  
**TSM113C4** ON-OFF-(ON)  
**TSM123C4** (ON)-OFF-(ON)  
 SPDT 3P

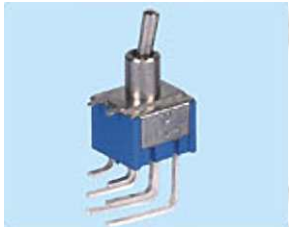
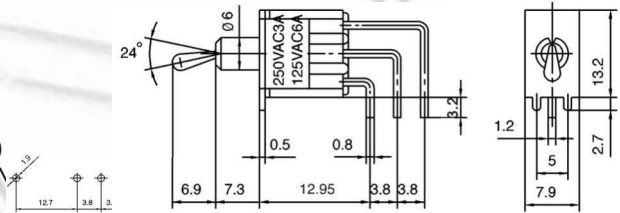

**TSM202C4** ON-ON  
**TSM212C4** ON-(ON)  
**TSM203C4** ON-OFF-ON  
**TSM213C4** ON-OFF-(ON)  
**TSM223C4** (ON)-OFF-(ON)  
 DPDT 6P

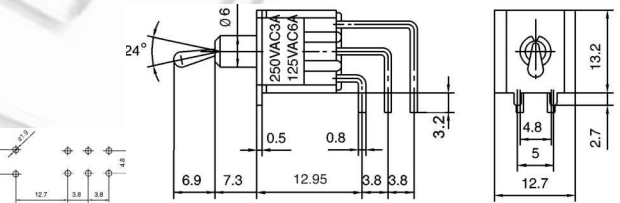

**TSM101E1** ON-OFF  
 SPST 2P  
 (PLASTIC FLAT LEVER)

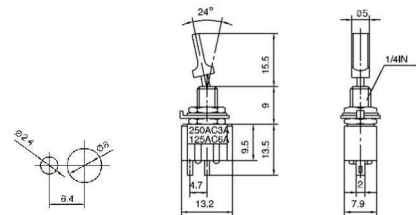

**TSM102E1** ON-ON  
**TSM112E1** ON-(ON)  
**TSM103E1** ON-OFF-ON  
**TSM113E1** ON-OFF-(ON)  
**TSM123E1** (ON)-OFF-(ON)  
 SPDT 3P  
 (PLASTIC FLAT LEVER)

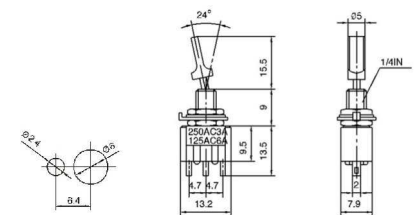

# Ninigi



**TSM202E1** ON-ON  
**TSM212E1** ON-(ON)  
**TSM203E1** ON-OFF-ON  
**TSM213E1** ON-OFF-(ON)  
**TSM223E1** (ON)-OFF-(ON)  
 DPDT 6P  
 (PLASTIC FLAT LEVER)

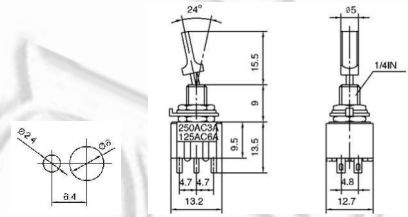

**TSM101F1** ON-OFF  
 SPST 2P  
 (METAL FLAT LEVER)

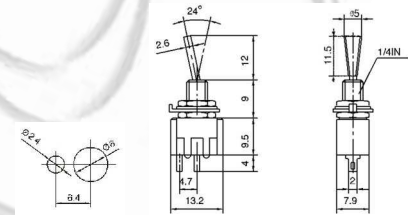

**TSM102F1** ON-ON  
**TSM112F1** ON-(ON)  
**TSM103F1** ON-OFF-ON  
**TSM113F1** ON-OFF-(ON)  
**TSM123F1** (ON)-OFF-(ON)  
 SPDT 3P  
 (METAL FLAT LEVER)

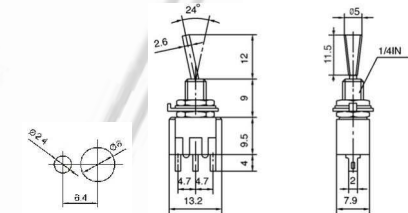

**TSM202F1** ON-ON  
**TSM212F1** ON-(ON)  
**TSM203F1** ON-OFF-ON  
**TSM213F1** ON-OFF-(ON)  
**TSM223F1** (ON)-OFF-(ON)  
 DPDT 6P  
 (METAL FLAT LEVER)

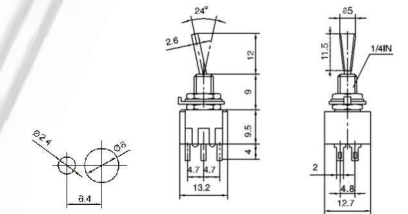

## X-ON Electronics

Largest Supplier of Electrical and Electronic Components

*Click to view similar products for [Toggle Switches](#) category:*

*Click to view products by [Ninigi](#) manufacturer:*

Other Similar products are found below :

[A19HV](#) [8A1-C-222](#) [60012L](#) [6006L](#) [6663](#) [7101MD9V30GE](#) [7101SPDV30BE](#) [7103SDV30BE](#) [7105D](#) [7108P3YAV2BE](#) [71YY50282](#)  
[7201MD9AVBE](#) [7301K38](#) [7306K36](#) [7310K36](#) [7314K36](#) [7506K4](#) [7592K6](#) [7691K14](#) [7700K1](#) [8396K108](#) [8824K14](#) [8828K13](#) [G3VX](#) [PS83-](#)  
[121G](#) [A101MD9AB04](#) [A101SD9AB04](#) [A101SDCQ04](#) [A103SD9AQ04](#) [A107TZB04](#) [A123P32YZQ](#) [A123S1YZG](#) [A127S1YCQ](#) [1-1825192-](#)  
[0](#) [A131S1YZQ](#) [A201SCWZB04](#) [A207SYCB04](#) [A208J61ZQ0004](#) [A221K12KAG](#) [A221S1YZQ](#) [A221T1TCQ](#) [A232K12KZQ](#) [A232M1YCQ](#)  
[A323S1CWZQ](#) [A423S1CWZG-M8](#) [A423S1YZQ](#) [12149A-3V](#) [12156AX408](#) [12147AGKX679](#) [12149AD2G0383VX408](#)