

REVISIONS			DOC. NO. SPC-F004 * Effective: 7/8/02 * DCP No: 1398						
DCP #	REV	DESCRIPTION	DRAWN	DATE	CHECKD	DATE	APPRVD	DATE	
1201	E	UPDATED PART LIST	HYO	9/25/01	JC	9/26/01	JC	9/26/01	
1914	F	Update To RoHS Compliant	EO	5/29/06	HO	5/30/06	HO	5/30/06	

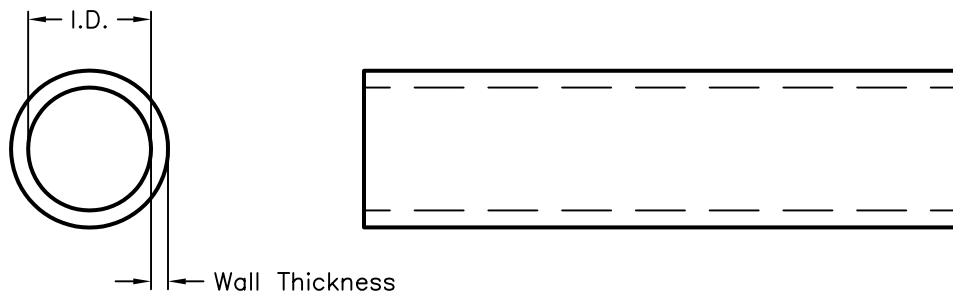

**SPECIFICATIONS:**

1. UL Subject 224 VW-1. CSA OFT, Size # 24 ~ Size # 1 rated for 300V, size 5/16 ~ 2" rated for 600V. ASTM D 922. AMS 3631. MIL-I-631D Grade C QPL Approved.
2. Operating Temperature Range: -20°C ~ 105°C.
3. UL File No. E52331



Property	Test Method	Typical Volume
Specific Gravity	ASTM D 792	1.32
Durometer Shore A	ASTM D 2240	91
Tensile Strength	ASTM D 876	2,800psi
Elongation	ASTM D 876	2.88
Brittleness Temperature	ASTM D 746	-20°C
Heat Aging 7 Days @ 136°C	UL Subject 224	81 %
Heat Aging 14 Days @ 131°C	CSA 22.2 No.198	Pass
Oil Aging 4 Hours @ 70°C SAE 20	CSA 22.2 No.198	85 %
Insulating Varnish Test 20 hours @ 150°C in Isonel 31	CSA 22.2 No.198	Pass
Flammability	UL Subject 224 VW-1	Pass
Deformation 1 hour @ 121°C	UL Subject 224	22 %
Volume Resistivity	ASTM D 257	5.4 x 10 <sup>12</sup>
Dielectric Constant @ 1 KHz	ASTM D 150	6.0
Dissipation Factor @ 1KHz	ASTM D 150	0.09
Dielectric Strength 0.021" Specimen	ASTM D 149	750vpm

SPC-F004.DWG

TOLERANCES: UNLESS OTHERWISE SPECIFIED, DIMENSIONS ARE FOR REFERENCE PURPOSES ONLY.	DRAWN BY:	DATE:	DRAWING TITLE:			
	J.A.P.	2/26/93	PVC INSULATING TUBING			
	CHECKED BY:	DATE:	SIZE	DWG. NO.	ELECTRONIC FILE	REV
	J.C.	3/12/93	A	TA-298	TA-298.DWG	F
	APPROVED BY:	DATE:	SCALE: NTS		U.O.M.: INCHES [mm]	SHEET: 1 OF 2
J.L.	3/17/93					

ALL RIGHTS RESERVED. NO PORTION OF THIS PUBLICATION, WHETHER IN WHOLE OR IN PART CAN BE REPRODUCED WITHOUT THE EXPRESS WRITTEN CONSENT OF SPC TECHNOLOGY. DISCLAIMER: ALL STATEMENTS AND TECHNICAL INFORMATION CONTAINED HEREIN ARE BASED UPON INFORMATION AND/OR TESTS WE BELIEVE TO BE ACCURATE AND RELIABLE. SINCE CONDITIONS OF USE ARE BEYOND OUR CONTROL, THE USER SHALL DETERMINE THE SUITABILITY OF THE PRODUCT FOR THE INTENDED USE AND ASSUME ALL RISK AND LIABILITY WHATSOEVER IN CONNECTION THEREWITH.

SPC Type No.		AWG Size	Nominal I.D		Nominal Wall Thickness		Spool Size (Feet)
Color Black	Color Clear		Inches	(mm)	Inches	(mm)	
PVI-S24-1100-BLK	PVI-S24-1100-CLR	24	0.022	0.56	0.012	0.30	100
PVI-S22-1100-BLK	PVI-S22-1100-CLR	22	0.027	0.69			
PVI-S20-1100-BLK	PVI-S20-1100-CLR	20	0.034	0.86	0.016	0.41	
PVI-S19-1100-BLK	N/A	19	0.038	0.97			
PVI-S18-1100-BLK	PVI-S18-1100-CLR	18	0.042	1.07			
PVI-S17-1100-BLK	PVI-S17-1100-CLR	17	0.047	1.19			
PVI-S16-1100-BLK	PVI-S16-1100-CLR	16	0.053	1.35			
PVI-S15-1100-BLK	PVI-S15-1100-CLR	15	0.059	1.50			
PVI-S14-1100-BLK	PVI-S14-1100-CLR	14	0.066	1.68			
PVI-S13-1100-BLK	PVI-S13-1100-CLR	13	0.076	1.93			
PVI-S12-1100-BLK	PVI-S12-1100-CLR	12	0.085	2.16			
PVI-S11-1100-BLK	PVI-S11-1100-CLR	11	0.095	2.41			
PVI-S10-1100-BLK	PVI-S10-1100-CLR	10	0.106	2.69	0.020	0.51	
PVI-S09-1100-BLK	PVI-S09-1100-CLR	9	0.118	3.00			
PVI-S08-1100-BLK	PVI-S08-1100-CLR	8	0.133	3.38			
PVI-S07-1100-BLK	PVI-S07-1100-CLR	7	0.148	3.76			
PVI-S06-1100-BLK	PVI-S06-1100-CLR	6	0.166	4.22			
PVI-S05-1100-BLK	PVI-S05-1100-CLR	5	0.186	4.72			
PVI-S04-1100-BLK	PVI-S04-1100-CLR	4	0.208	5.28			
PVI-S03-1100-BLK	PVI-S03-1100-CLR	3	0.234	5.94			
PVI-S02-1100-BLK	PVI-S02-1100-CLR	2	0.263	6.68	0.025	0.64	
PVI-S01-1100-BLK	N/A	1	0.294	7.47			
PVI-020-1100-BLK	PVI-020-1100-CLR	5/16"	0.313	7.95			
PVI-S00-1100-BLK	SPC10938	0	0.330	8.38			
PVI-024-1100-BLK	PVI-024-1100-CLR	3/8"	0.375	9.53			
PVI-028-1100-BLK	PVI-028-1100-CLR	7/16"	0.438	11.13			
PVI-032-1100-BLK	PVI-032-1100-CLR	1/2"	0.500	12.70			
PVI-040-1100-BLK	N/A	5/8"	0.625	15.88	0.030	0.76	50
PVI-048-1050-BLK	N/A	3/4"	0.750	19.05	0.035	0.89	
PVI-064-1050-BLK	PVI-064-1050-CLR	1"	1.000	25.40			
PVI-128-1050-BLK	PVI-128-1050-CLR	2"	2.000	50.80	0.06	1.52	

ALL RIGHTS RESERVED. NO PORTION OF THIS PUBLICATION, WHETHER IN WHOLE OR IN PART CAN BE REPRODUCED WITHOUT THE EXPRESS WRITTEN CONSENT OF SPC TECHNOLOGY.

SPC-F004.DWG

SIZE DWG. NO.

A

TA-298

ELECTRONIC FILE

TA-298.DWG

REV

F

DOC. NO. SPC-F004 \* Effective: 7/8/02 \* DCP No: 1398

SCALE: NTS

U.O.M.: INCHES [mm]

SHEET: 2 OF 2

## X-ON Electronics

Largest Supplier of Electrical and Electronic Components

*Click to view similar products for [Wire Identification](#) category:*

*Click to view products by [Pro Power](#) manufacturer:*

Other Similar products are found below :

[CU6337-000](#) [CU6342-000](#) [FCA-410-12](#) [11631010](#) [1-1768037-1](#) [1-1768037-2](#) [1-1768050-0](#) [PXLK-VI](#) [Q62184-1](#) [A64304-000](#) [QMT221](#)  
[HK032WE1NF038B](#) [1330-0519-10](#) [1395199-1](#) [1395200-1](#) [1395202-1](#) [DMVF050WE-300S6](#) [D-SCE-1K-2.4-50-4-CS7834](#) [1538738-1](#)  
[E90935-000](#) [EC1238-000](#) [EC1465-000](#) [EC1855-000](#) [EC1859-000](#) [EC1863-000](#) [EC5415-000](#) [EC7277-000](#) [EC7352-000](#) [EC7603-000](#)  
[EC7707-000](#) [EC7735-000](#) [EC7768-000](#) [EC7828-000](#) [EC7854-000](#) [EC7952-000](#) [EC8128-000](#) [1768037-8](#) [1768041-7](#) [NC-127191-10-9](#)  
[HS048WE2NF038B](#) [C03232-000](#) [HTCM-SCE-14-4H-9](#) [HTMS-3/16-9](#) [HT-SCE-1/4-2.0-4](#) [HT-SCE-3/16-2.0-4](#) [HTTMS-1/2-1.50-9](#) [HTTMS-](#)  
[CM-1/2-4H-9](#) [HX-SCE-19.0-50-9](#) [HX-SCE-6.4-50-4](#) [C25254-000](#)