

# PCB TERMINAL BLOCKS

## 5mm Pitch Pluggable Rising Clamp Terminal with Screw Flanges

PCB  
TERMINAL  
BLOCKS

INTER-  
CONNECTION

FUSES &  
FUSE-  
HOLDERS

LEDs &  
INDICATORS

MINIATURE  
SWITCHES

LIMIT &  
SAFETY  
SWITCHES

CONTROL  
PRODUCTS

INTERFACE  
MODULES &  
SUPPORTS

RELAY  
BASES

ENCLOSURES

BATTERIES

TRANS-  
FORMERS

- 2-22 pole solid block
- Pluggable male-female connectors
- Screw Flanges
- Horizontal female plug style
- Polarised mouldings
- Moulded in green UL94-V0 flame retardant PA66
- Professional rising clamp terminals
- 0.2 to 4mm<sup>2</sup> (24 to 12 AWG)
- Anti solder wicking
- Captive screws
- Guided pin alignment
- CE and approved

### SPECIFICATION

Rating	16A/320V UL=300V, VDE=380V
Dielectric strength	2kV
Insulation resistance	>2MΩ
Working temperature	-40°C to 105°C
Moulding	UL94-V0 flame retardant PA66
Pin/terminal	Tinned phosphor bronze
Rising clamp	Nickel copper flash brass
Screw/torque	M3 steel zinc plated, 0.5Nm
Recommended PCB hole size	ø1.5mm

### Female connector

TYPE NO.	POLES	LENGTH	TYPE NO.	POLES	LENGTH
CTB9200/2FL	2	20mm	CTB9200/14FL	14	80mm
CTB9200/3FL	3	25mm	CTB9200/15FL	15	85mm
CTB9200/4FL	4	30mm	CTB9200/16FL	16	90mm
CTB9200/5FL	5	35mm	CTB9200/17FL	17	95mm
CTB9200/6FL	6	40mm	CTB9200/18FL	18	100mm
CTB9200/7FL	7	45mm	CTB9200/19FL	19	105mm
CTB9200/8FL	8	50mm	CTB9200/20FL	20	110mm
CTB9200/9FL	9	55mm	CTB9200/21FL	21	115mm
CTB9200/10FL	10	60mm	CTB9200/22FL	22	120mm
CTB9200/11FL	11	65mm			
CTB9200/12FL	12	70mm			
CTB9200/13FL	13	75mm			

CTB9200/ FL

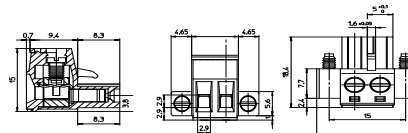

### PCB mounting male vertical

TYPE NO.	POLES	LENGTH	TYPE NO.	POLES	LENGTH
CTB9300/2FL	2	20mm	CTB9300/14FL	14	80mm
CTB9300/3FL	3	25mm	CTB9300/15FL	15	85mm
CTB9300/4FL	4	30mm	CTB9300/16FL	16	90mm
CTB9300/5FL	5	35mm	CTB9300/17FL	17	95mm
CTB9300/6FL	6	40mm	CTB9300/18FL	18	100mm
CTB9300/7FL	7	45mm	CTB9300/19FL	19	105mm
CTB9300/8FL	8	50mm	CTB9300/20FL	20	110mm
CTB9300/9FL	9	55mm	CTB9300/21FL	21	115mm
CTB9300/10FL	10	60mm	CTB9300/22FL	22	120mm
CTB9300/11FL	11	65mm			
CTB9300/12FL	12	70mm			
CTB9300/13FL	13	75mm			

CTB9300/ FL

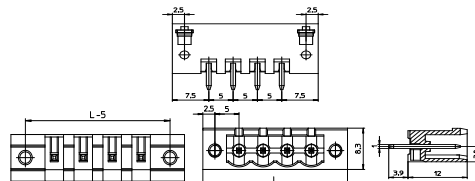
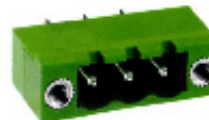

### PCB mounting male horizontal

TYPE NO.	POLES	LENGTH	TYPE NO.	POLES	LENGTH
CTB9350/2FL	2	20mm	CTB9350/14FL	14	80mm
CTB9350/3FL	3	25mm	CTB9350/15FL	15	85mm
CTB9350/4FL	4	30mm	CTB9350/16FL	16	90mm
CTB9350/5FL	5	35mm	CTB9350/17FL	17	95mm
CTB9350/6FL	6	40mm	CTB9350/18FL	18	100mm
CTB9350/7FL	7	45mm	CTB9350/19FL	19	105mm
CTB9350/8FL	8	50mm	CTB9350/20FL	20	110mm
CTB9350/9FL	9	55mm	CTB9350/21FL	21	115mm
CTB9350/10FL	10	60mm	CTB9350/22FL	22	120mm
CTB9350/11FL	11	65mm			
CTB9350/12FL	12	70mm			
CTB9350/13FL	13	75mm			

CTB9350/ FL

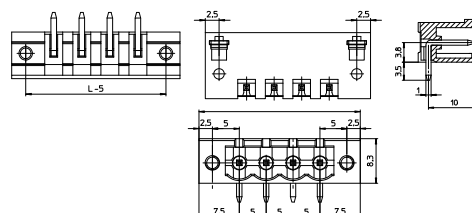
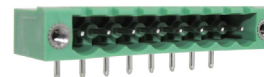

## X-ON Electronics

Largest Supplier of Electrical and Electronic Components

*Click to view similar products for [camden manufacturer](#):*

Other Similar products are found below :

[412689X](#) [CTBP92VE/12R](#) [CTBP9350/12](#) [IND515205-240-T/GRN](#) [IND515205-240-T/RD](#) [IND5032405-240-T/GRN](#) [CE10.00.EI](#)  
[C192SHAND](#) [CNMB/6ST/2](#) [CNMB/4ST/2](#) [CSACST004](#) [CTBP9200/9](#) [CIME/M/BE2250SS](#) [CHH64E1BL](#) [CIM/15W-DMFS](#) [CHHBAT2GY](#)  
[CFTBN/2](#) [CCB2S1/04](#) [CHDX6-221C](#) [CHDX8-224](#) [CHDASMP29](#) [CHDASMP34](#) [CHDX810DD](#) [CHDX811DD](#) [CCTTM40LR](#)  
[CTBP92VJ/5S](#) [CTBP92VJ/8R](#) [CTSN431/12/M](#) [CTSN433/12/M](#) [CUABOX006](#) [CE10.00.FM](#) [CBRPH-BLK](#) [BIM2003/13-WH/WH](#)  
[RX2008/S-5-WH](#) [CBARD-CAR](#) [CRDCG0007](#) [CNMB/4/KIT](#) [CTB5050/5](#) [CTBP92HE/11](#) [CTBP9358/10AO](#) [CHH66C2GY](#) [CHH456PBK](#)  
[CHH451ABK](#) [CIM/9W-DMFS](#) [CIM/25W-DMFS](#) [RTM5006/16-NC-BLK](#) [IND5032405-125-T/AMB](#) [CCB1S1/03](#) [CCD2S1/04](#) [CCE1S1/05](#)