

THIS DRAWING IS UNPUBLISHED. RELEASED FOR PUBLICATION
 © COPYRIGHT 2010 BY TYCO ELECTRONICS CORPORATION. ALL RIGHTS RESERVED.

LOC		DIST		REVISIONS					
DW				P	LTR	DESCRIPTION	DATE	DWN	APVD
					C2	REVISED (ECR-11-011338) UPDATED NOTE 3 & ADDED NOTE 5	31MAR'11	E.L.	W.K.

- NOTE:
- MATERIAL:
 HOUSING (SEE TABLE): PA46 OR PA9T, UL94 V-0, COLOR: BLACK.
 CONTACTS: PHOSPHOR BRONZE.
 BOARDLOCK: BRASS.
 - FINISH:
 2.1 CONTACTS: (SEE TABLE) GOLD PLATED ON CONTACT AREA,
 2.54um [100u"] MIN. MATTE-TIN ON SOLDER TAIL,
 WITH ENTIRE CONTACT UNDERPLATED 1.27um [50u"] MIN. NICKEL.
 2.2 BOARDLOCK: 2.54um [100u"] MATTE-TIN PLATING ALL OVER
 NICKEL 1.27um[50u"] MIN. UNDERPLATED OVERALL.
 - WAVE SOLDER CAPABLE TO 265°C MAX. PER TE SPEC. 109-202, CONDITION B.
 - WEIGHT:
 36 POS.: 2.55 GRAMS
 64 POS.: 3.90 GRAMS
 98 POS.: 5.50 GRAMS
 164 POS.: 8.80 GRAMS
 - REFLOW SOLDER CAPABLE TO 260°C PER TE SPEC. TEC-109-201, CONDITION B.

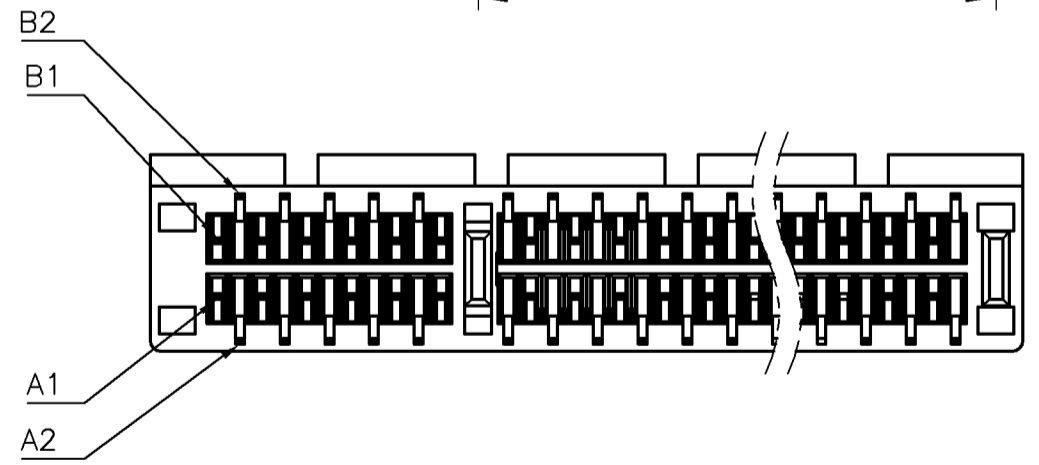
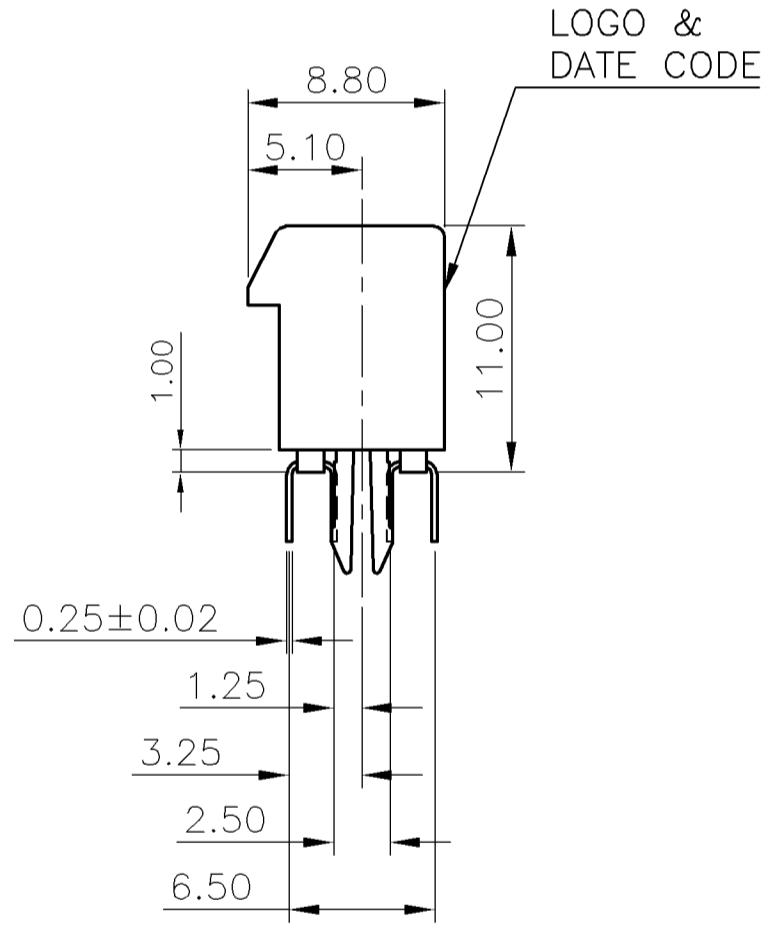
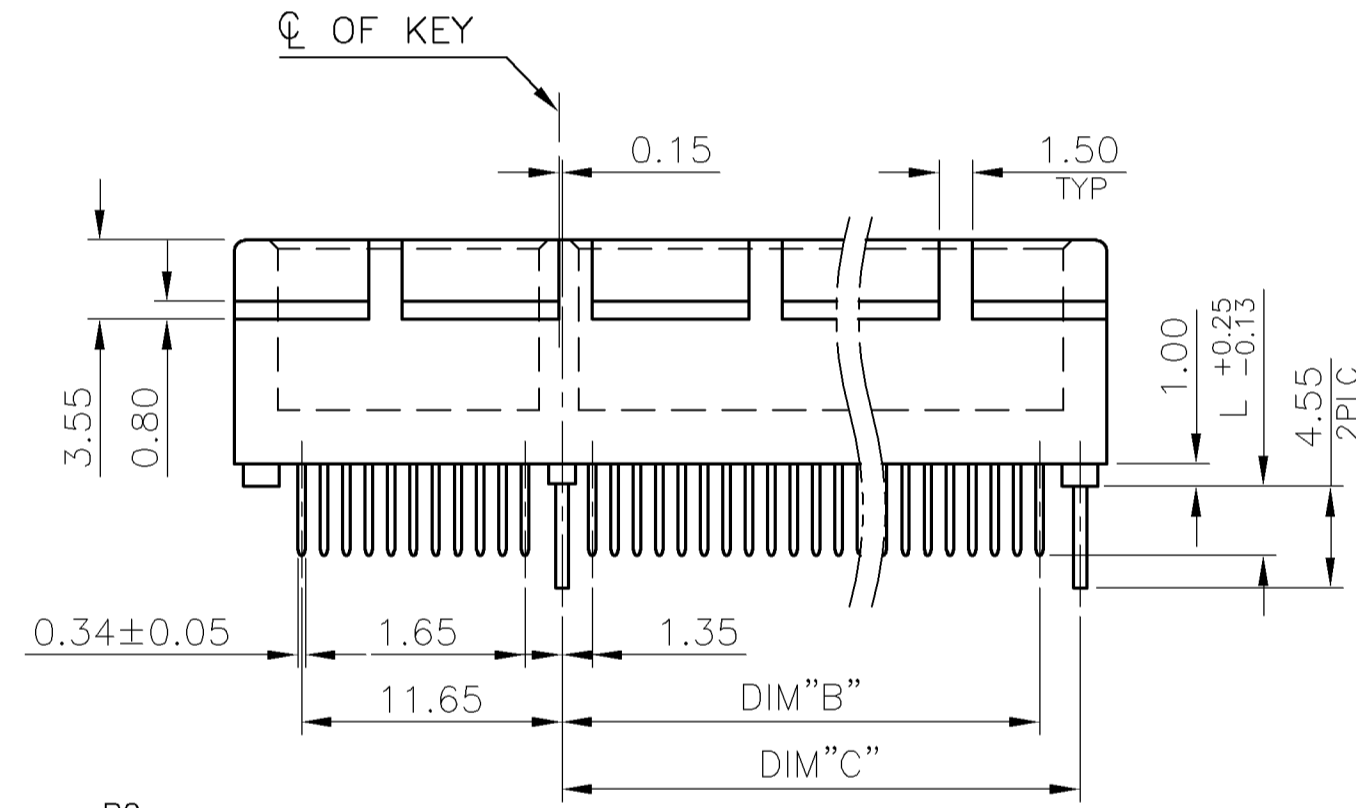
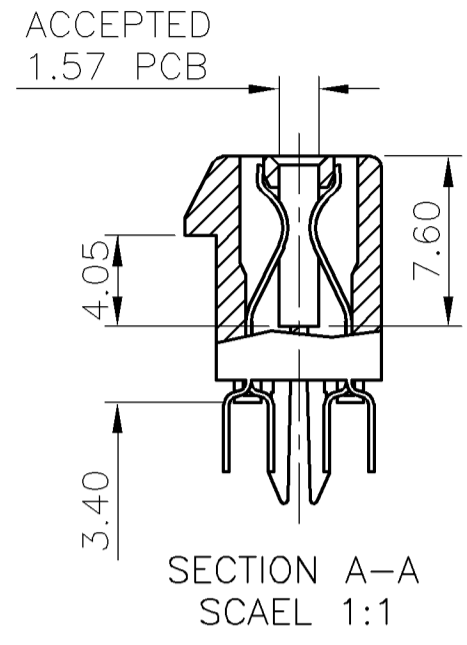
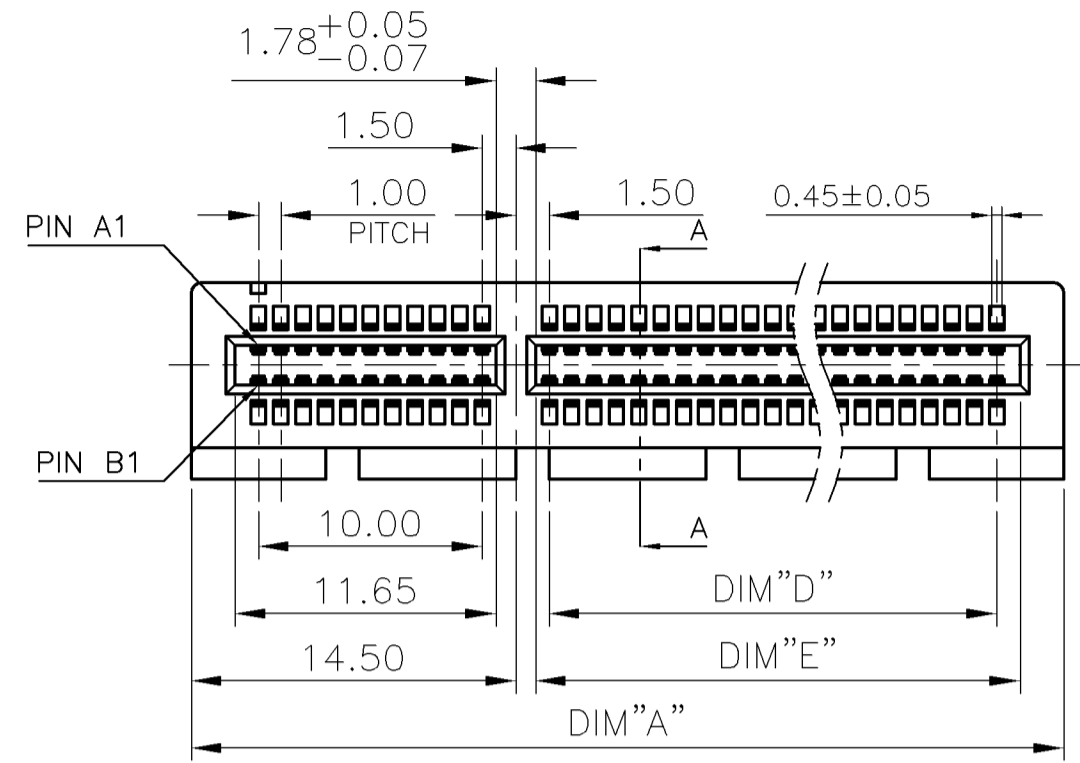

NOTE 3 & 5	PA9T	2.30	0.381µm[15µ"] MIN.	71.65	70.0	73.15	71.35	89.0	164	5-	-2
		3.10	0.762µm[30µ"] MIN. 0.381µm[15µ"] MIN. GOLD FLASH	71.65	70.0	73.15	71.35	89.0	164	4-	-6
		2.30	0.762µm[30µ"] MIN. 0.381µm[15µ"] MIN. GOLD FLASH	71.65	70.0	73.15	71.35	89.0	164	4-	-5
		3.10	0.762µm[30µ"] MIN. 0.381µm[15µ"] MIN. GOLD FLASH	71.65	70.0	73.15	71.35	89.0	164	4-	-4
		2.30	0.762µm[30µ"] MIN. 0.381µm[15µ"] MIN. GOLD FLASH	71.65	70.0	73.15	71.35	89.0	164	4-	-3
		3.10	0.762µm[30µ"] MIN. 0.381µm[15µ"] MIN. GOLD FLASH	71.65	70.0	73.15	71.35	89.0	164	4-	-2
		2.30	0.762µm[30µ"] MIN. 0.381µm[15µ"] MIN. GOLD FLASH	71.65	70.0	73.15	71.35	89.0	164	4-	-1
		3.10	0.762µm[30µ"] MIN. 0.381µm[15µ"] MIN. GOLD FLASH	38.65	37.0	40.15	38.35	56.0	98	3-	-6
		2.30	0.762µm[30µ"] MIN. 0.381µm[15µ"] MIN. GOLD FLASH	38.65	37.0	40.15	38.35	56.0	98	3-	-5
		3.10	0.762µm[30µ"] MIN. 0.381µm[15µ"] MIN. GOLD FLASH	38.65	37.0	40.15	38.35	56.0	98	3-	-4
		2.30	0.762µm[30µ"] MIN. 0.381µm[15µ"] MIN. GOLD FLASH	38.65	37.0	40.15	38.35	56.0	98	3-	-3
		3.10	0.762µm[30µ"] MIN. 0.381µm[15µ"] MIN. GOLD FLASH	38.65	37.0	40.15	38.35	56.0	98	3-	-2
		2.30	0.762µm[30µ"] MIN. 0.381µm[15µ"] MIN. GOLD FLASH	38.65	37.0	40.15	38.35	56.0	98	3-	-1
		3.10	0.762µm[30µ"] MIN. 0.381µm[15µ"] MIN. GOLD FLASH	21.65	20.0	23.15	21.35	39.0	64	2-	-6
		2.30	0.762µm[30µ"] MIN. 0.381µm[15µ"] MIN. GOLD FLASH	21.65	20.0	23.15	21.35	39.0	64	2-	-5
		3.10	0.762µm[30µ"] MIN. 0.381µm[15µ"] MIN. GOLD FLASH	21.65	20.0	23.15	21.35	39.0	64	2-	-4
		2.30	0.762µm[30µ"] MIN. 0.381µm[15µ"] MIN. GOLD FLASH	21.65	20.0	23.15	21.35	39.0	64	2-	-3
		3.10	0.762µm[30µ"] MIN. 0.381µm[15µ"] MIN. GOLD FLASH	21.65	20.0	23.15	21.35	39.0	64	2-	-2
		2.30	0.762µm[30µ"] MIN. 0.381µm[15µ"] MIN. GOLD FLASH	21.65	20.0	23.15	21.35	39.0	64	2-	-1
		3.10	0.762µm[30µ"] MIN. 0.381µm[15µ"] MIN. GOLD FLASH	7.65	6.0	9.15	7.35	25.0	36	1-	-6
		2.30	0.762µm[30µ"] MIN. 0.381µm[15µ"] MIN. GOLD FLASH	7.65	6.0	9.15	7.35	25.0	36	1-	-5
		3.10	0.762µm[30µ"] MIN. 0.381µm[15µ"] MIN. GOLD FLASH	7.65	6.0	9.15	7.35	25.0	36	1-	-4
		2.30	0.762µm[30µ"] MIN. 0.381µm[15µ"] MIN. GOLD FLASH	7.65	6.0	9.15	7.35	25.0	36	1-	-3
		3.10	0.762µm[30µ"] MIN. 0.381µm[15µ"] MIN. GOLD FLASH	7.65	6.0	9.15	7.35	25.0	36	1-	-2
		2.30	0.762µm[30µ"] MIN. 0.381µm[15µ"] MIN. GOLD FLASH	7.65	6.0	9.15	7.35	25.0	36	1-	-1
		3.10	0.762µm[30µ"] MIN. 0.381µm[15µ"] MIN. GOLD FLASH	7.65	6.0	9.15	7.35	25.0	36	1-	-1

THIS DRAWING IS A CONTROLLED DOCUMENT.

DIMENSIONS: mm	TOLERANCES UNLESS OTHERWISE SPECIFIED: 0 PLC ± - 1 PLC ± 0.3 2 PLC ± 0.2 3 PLC ± 0.15 4 PLC ± - ANGLES ± 3'	DWN B. HSING 21MAY2009 CHK S. CHIEN 21MAY2009 APVD W. KODAMA 21MAY2009 PRODUCT SPEC 108-57375 APPLICATION SPEC	TE Connectivity PCI EXPRESS CARD EDGE CONNECTOR VERTICAL, DIP TYPE (BOARD-LOCK FUNCTION)			
MATERIAL SEE NOTE	FINISH SEE NOTE	WEIGHT SEE NOTE	SIZE A3	CAGE CODE 00779	DRAWING NO C-1775801	RESTRICTED TO -
CUSTOMER DRAWING			SCALE -	SHEET 1 OF 3	REV C2	

THIS DRAWING IS UNPUBLISHED. RELEASED FOR PUBLICATION
 © COPYRIGHT 2010 BY TYCO ELECTRONICS CORPORATION. ALL RIGHTS RESERVED.

LOC DW	DIST /	REVISIONS		
P	LTR	DESCRIPTION	DATE	DWN APVD
		SEE SHEET 1.		

- NO TIE BAR PERMITTED FROM CARD EDGE TO LEADING EDGE OF PAD FOR PINS A1 AND "K"
- CHAMFER EDGE MUST BE FREE OF CUTTING BURRS

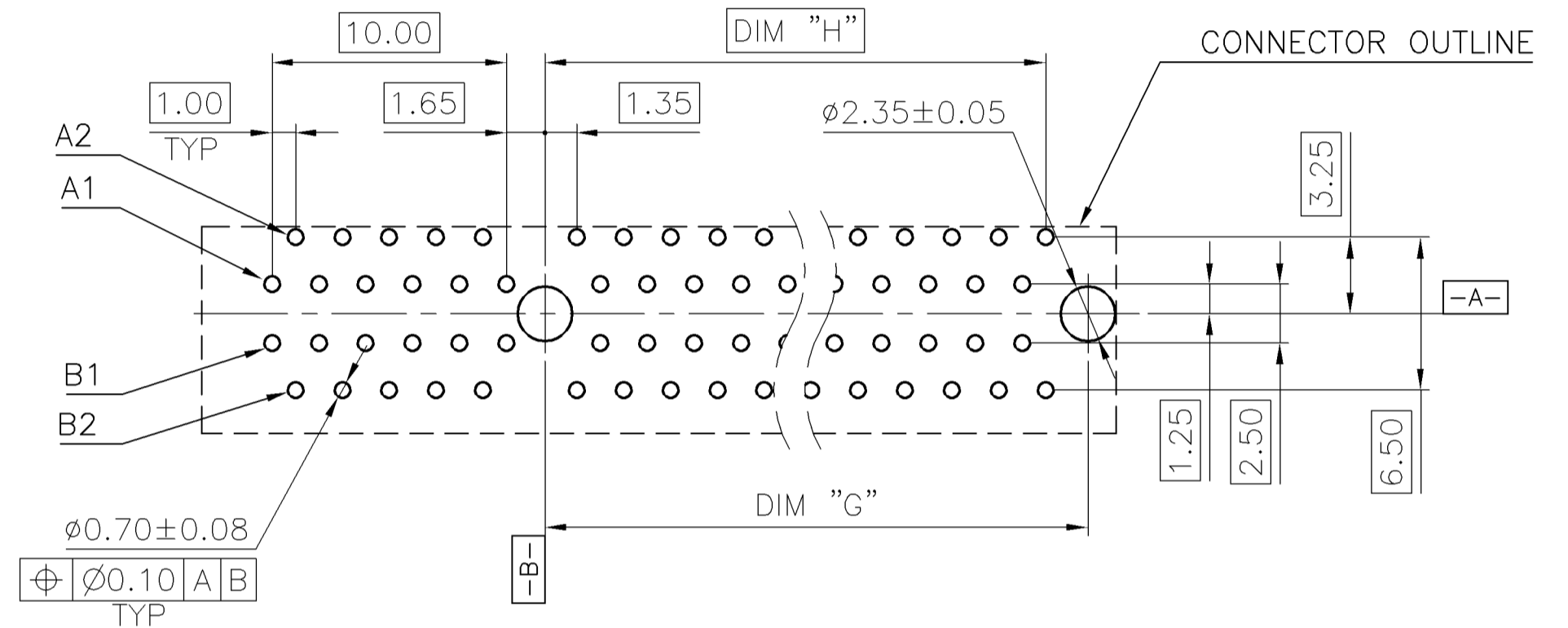
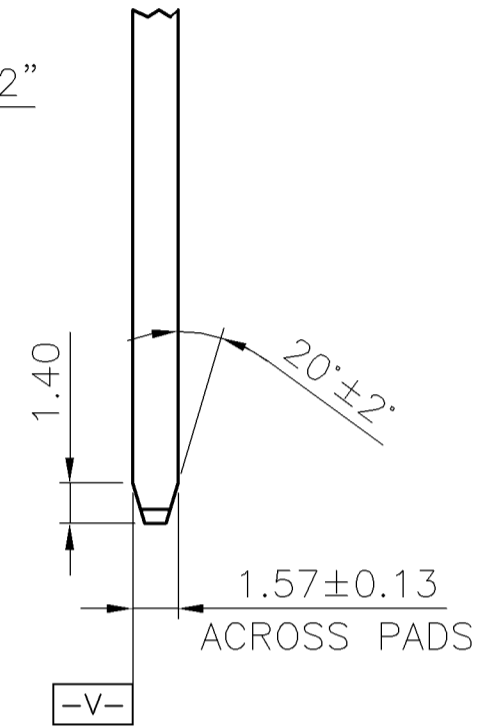
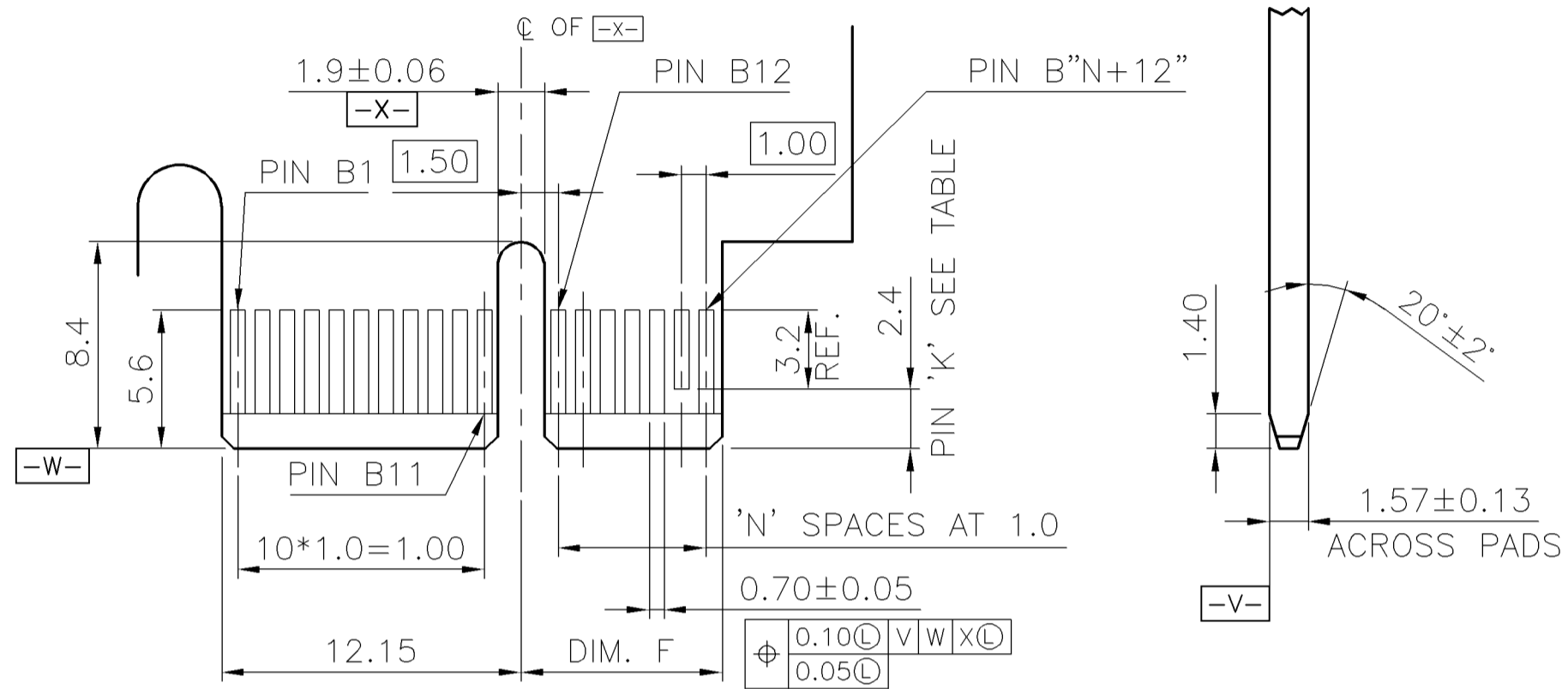

RECOMMENDED PCB LAYOUT

TOLERANCE: ±0.05
 DIM.L=3.1mm THICKNESS: 2.4mm
 DIM.L=2.3mm THICKNESS: 1.6mm

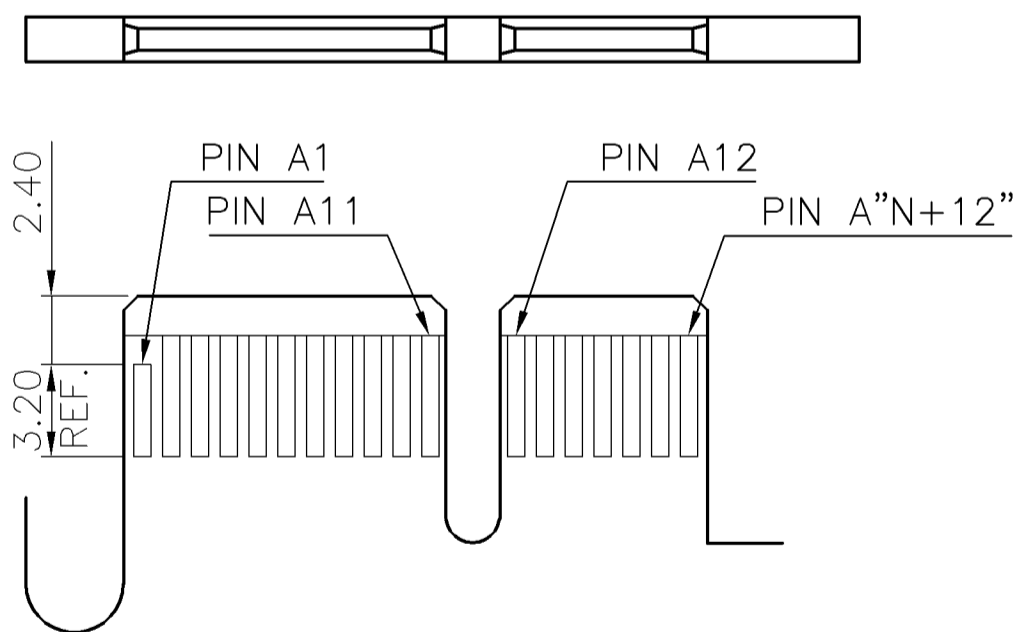

SECONDARY (SOLDER) SIDE

POS.	N	DIM. F	DIM. G	DIM. H	"K"
36	6	8.15	9.15	7.35	B17
64	20	22.15	23.15	21.35	B17,B31
98	37	39.15	40.15	38.35	B17,B31,B48
164	70	72.15	73.15	71.35	B17,B31,B48,B81

THIS DRAWING IS A CONTROLLED DOCUMENT.		DWN	TE Connectivity					
DIMENSIONS: mm		CHK				NAME PCI EXPRESS CARD EDGE CONNECTOR VERTICAL, DIP TYPE (BOARD-LOCK FUNCTION)		
TOLERANCES UNLESS OTHERWISE SPECIFIED:		APVD						
0 PLC ± - 1 PLC ± 0.3 2 PLC ± 0.2 3 PLC ± 0.15 4 PLC ± - ANGLES ± 3°		PRODUCT SPEC						
MATERIAL		FINISH	APPLICATION SPEC	SIZE	CAGE CODE			
			WEIGHT	A3 00779 C-1775801				
CUSTOMER DRAWING			SCALE	SHEET	2 OF 3		REV C2	

THIS DRAWING IS UNPUBLISHED. RELEASED FOR PUBLICATION
 © COPYRIGHT 2010 BY TYCO ELECTRONICS CORPORATION. ALL RIGHTS RESERVED.

LOC	DIST	REVISIONS			
P	LTR	DESCRIPTION	DATE	DWN	APVD
		SEE SHEET 1.			

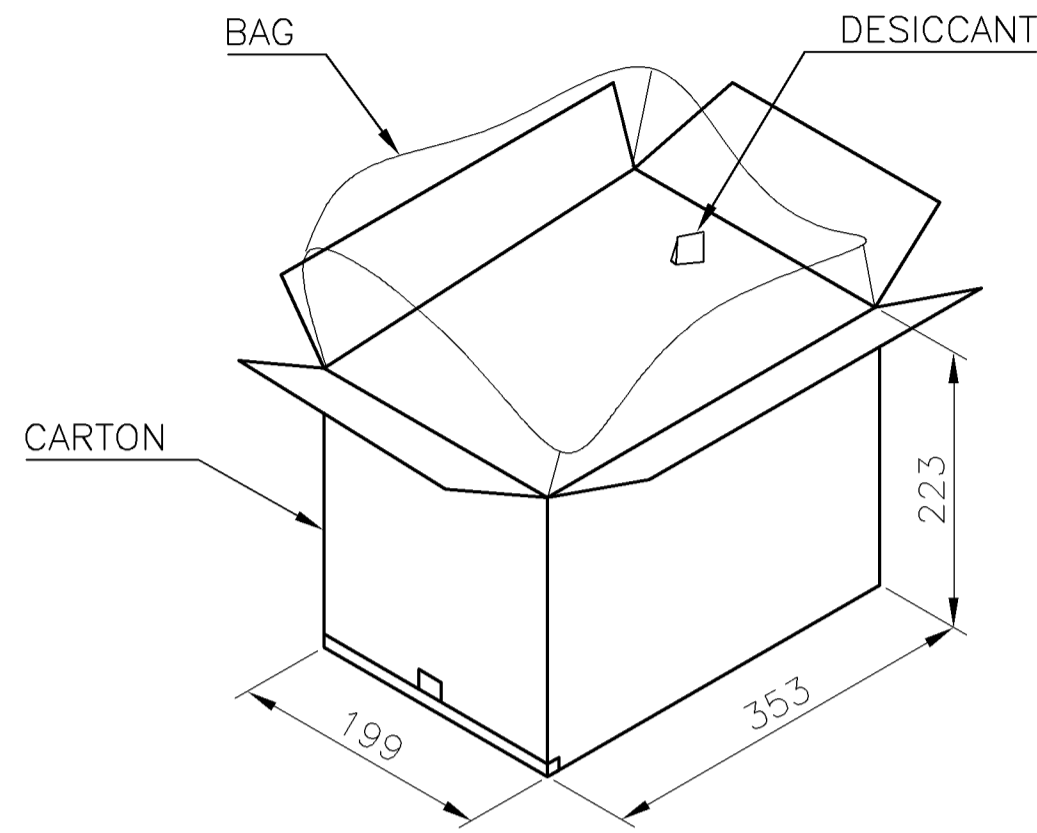
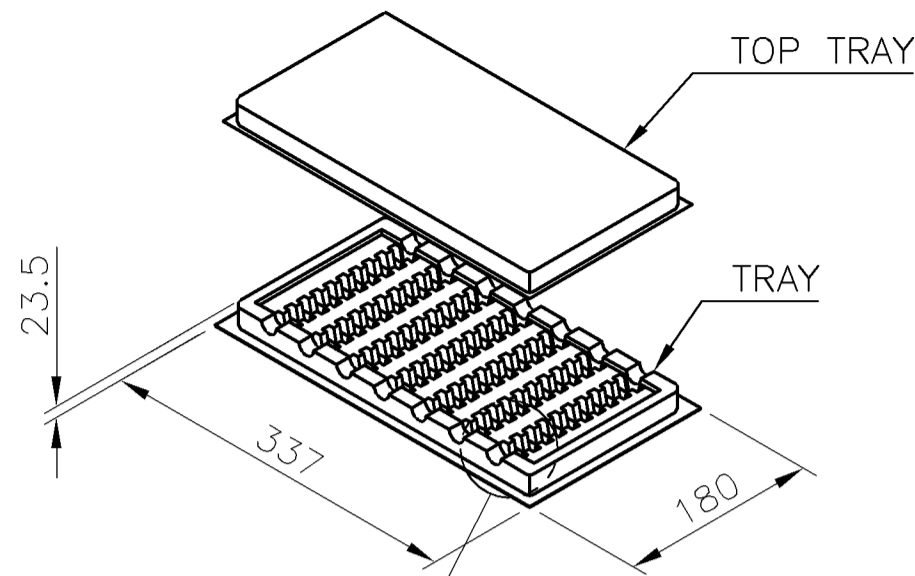

- NOTES :
- MATERIAL :
 TRAY : PVC, COLOR: TRANSPARENT.
 CARTON: CORRUGATED FIBER
 BOX: CORRUGATED FIBER
 - DIMENSION :
 TRAY: SEE DRAWING
 CARTON: SEE DRAWING
 BOX : SEE DRAWING
 - QUANTITY : SEE TABLE
 - WEIGHT : SEE TABLE

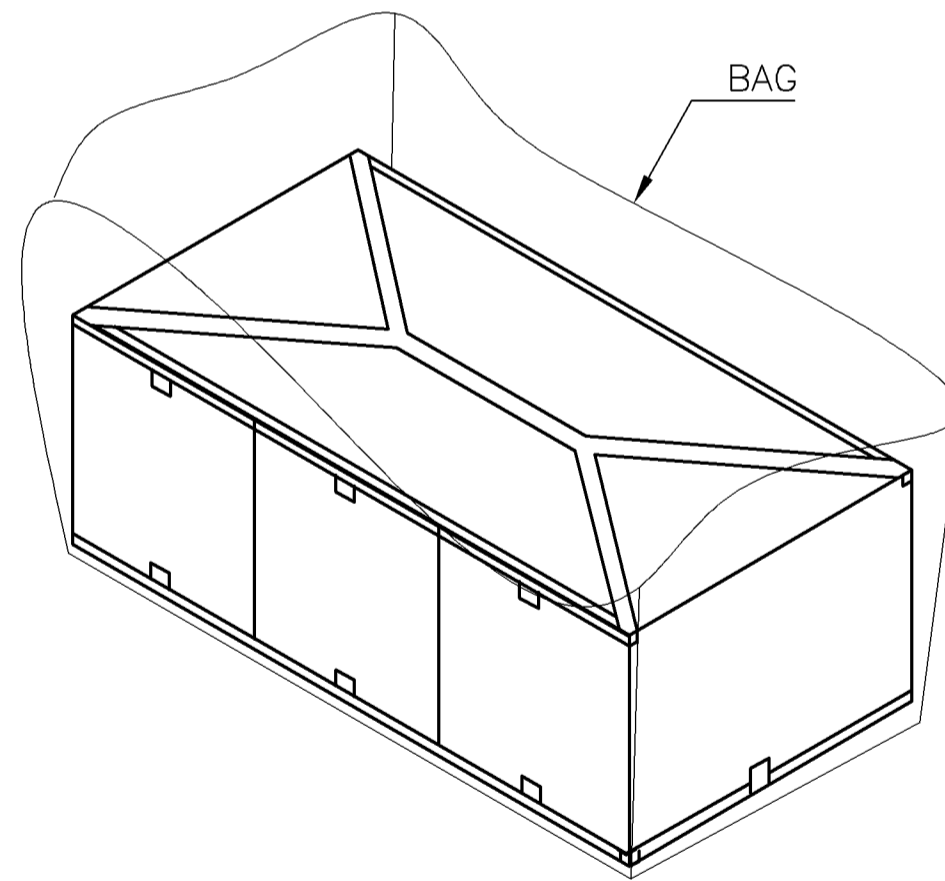
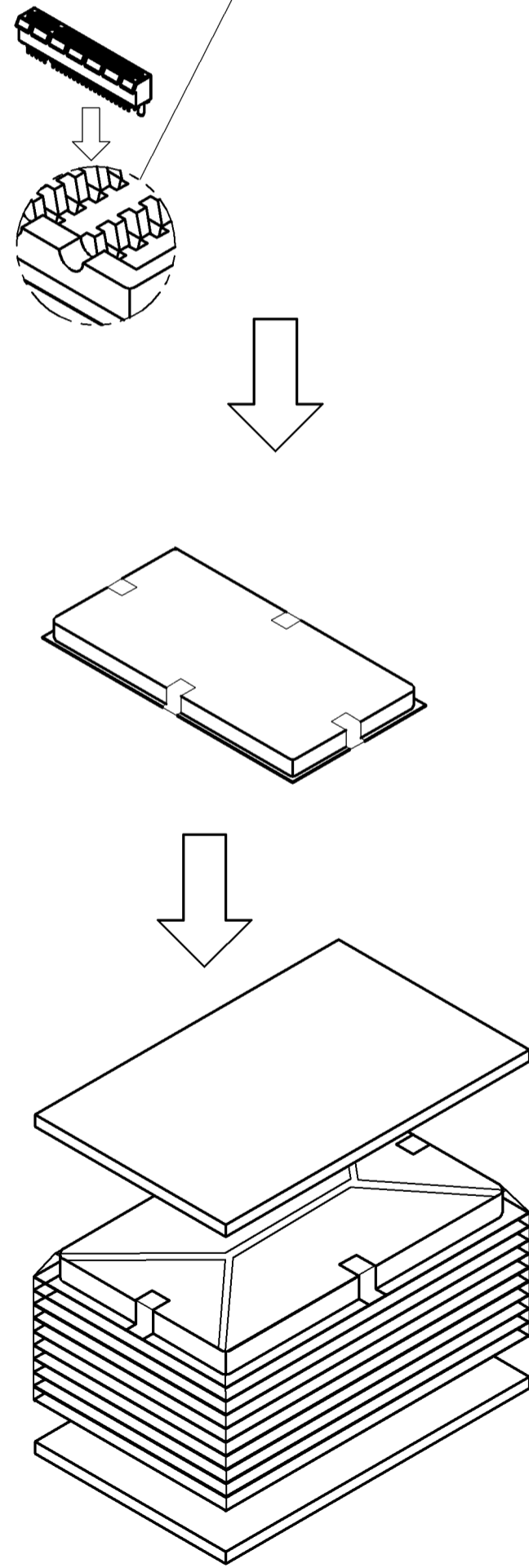

9.6 KG	7.6 KG	30	10	3	900	164
8.5 KG	6.5 KG	40	10	3	1200	98
9.1 KG	7.1 KG	60	10	3	1800	64
7.7 KG	5.7 KG	70	10	3	2100	36
GROSS WEIGHT	NET WEIGHT	PCS/ TRAY	TRAY/ CARTON	CARTON/ BOX	PCS/ BOX	POS

THIS DRAWING IS A CONTROLLED DOCUMENT.		DWN	TE Connectivity PCI EXPRESS CARD EDGE CONNECTOR VERTICAL, DIP TYPE (BOARD-LOCK FUNCTION)				
DIMENSIONS: mm		CHK					
		APVD					
TOLERANCES UNLESS OTHERWISE SPECIFIED: 0 PLC ± - 1 PLC ± 0.3 2 PLC ± 0.2 3 PLC ± 0.15 4 PLC ± - ANGLES ± 3°		PRODUCT SPEC					
MATERIAL		FINISH	APPLICATION SPEC	SIZE	CAGE CODE	DRAWING NO	RESTRICTED TO
CUSTOMER DRAWING			WEIGHT	A3	00779	C=1775801	-
			SCALE	SHEET 3 OF 3		REV C2	

X-ON Electronics

Largest Supplier of Electrical and Electronic Components

Click to view similar products for [PCI Express/PCI Connectors](#) category:

Click to view products by [TE Connectivity](#) manufacturer:

Other Similar products are found below :

[UEX220-6U](#) [0877159203](#) [10039755-10110TLF](#) [10039755-10211TLF](#) [10025026-10003PLF](#) [10125756-A41010LF](#) [10125756-980000LF](#) [1-1871239-2](#) [2170560-2](#) [10082378-11003TLF](#) [10125756-980000LF](#) [1775861-2](#) [10039755-10111TLF](#) [EB220-3U](#) [WD2M144WB2R300](#)
[10061913-120PLF](#) [10108777-10002WLF](#) [GPCP146400111HR](#) [10144667-112Y0LF](#) [10144667-113Y0LF](#) [205058-1001](#) [GPCP446200120HR](#)
[GPCP245400111HR](#) [10082378-10000TLF](#) [10082378-10001TLF](#) [87715-9256](#) [MDT580M03001](#) [0877159107](#) [205058-1003](#) [MDT580M01001](#)
[10018783-11000MLF](#) [10061913-103BLF](#) [10145445-10003MLF](#) [PSASF2130311TR](#) [10147430-113T0LF](#) [10146070-113Y0LF](#)
[MDT670M01005](#) [10108777-10200MLF](#) [MDT420M01002](#) [PSASF3130211TR](#) [PSASF4130051TR](#) [PSASM2130412TR](#) [PSASM2130391TR](#)
[10139595-111T0LF](#) [10139595-110T0LF](#) [PSASF3130131TR](#) [0745400501](#) [7-1734774-7](#) [10150900-052R2LF](#) [3-1761465-1](#)