



Eco Version

High Output Version

Audible Signals - Industrial ECO TLM AUDIBLE MODULES

Industrial LED-TLM Eco Tower Light > Audible Modules

Product overview

These audible modules have been designed for use in conjunction with the Moflash LED-TLM Eco Tower Light Module range. They are a simple fix addition that offers an audible warning signal in addition to the multiple visual ones that the tower offers.

The module can be pre-set with either a pulsed or continuous tone. The Eco buzzers have been designed for local indication only but a higher decibel output version (Ac only) is available.

This has two dB outputs selectable by a slide switch inside the enclosure.

Features

- Continuously rated
- Low current consumption
- Cost effective audible solution
- Quick & easy installation or upgrade

Material

Black ABS Plastic

ECO TLM-AUD-02 >

Code No:	LED-TLM-AUD-02
Voltage:	24v Dc ---
Operating Temperature:	-25 to +55 °C
Current:	55mA
Pulsed Tone Rate:	60/80 (time/min)
Output dB:	100
IP Protection:	IP65

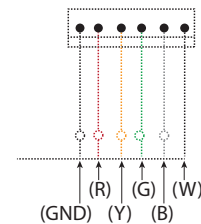
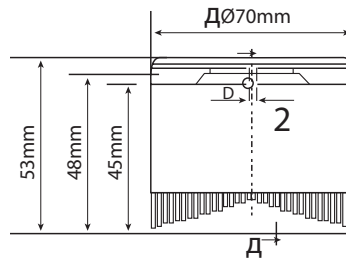

ECO TLM-AUD-04 >

Code No:	LED-TLM-AUD-04
Voltage:	85-275v Ac ~
Operating Temperature:	-25 to +55 °C
Current:	<55mA
Output dB:	80
IP Protection:	IP54

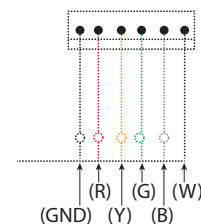
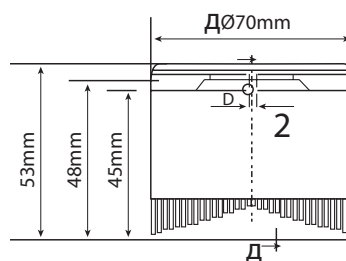

HIGH OUTPUT TLM-AUD120-04 >

Code No:	LED-TLM-AUD120-04
Voltage:	85-275v Ac ~
Operating Temperature:	-25 to +55 °C
Current:	<20
Output dB:	100-120 selectable
IP Protection:	IP65

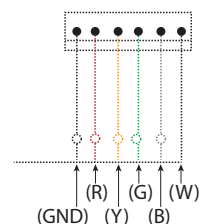
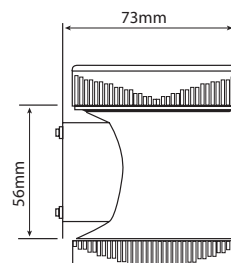
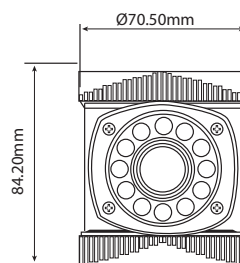

APPROVALS and
CONFORMITIES



X-ON Electronics

Largest Supplier of Electrical and Electronic Components

Click to view similar products for [moflash signalling manufacturer](#):

Other Similar products are found below :

[FF200-87](#) [AP360M](#) [LED100-01-01](#) [LED100-01-02](#) [LEDA100-01-04](#) [LEDD100-01-02](#) [LEDD100-01-04](#) [LEDD100-02-01](#) [LEDD100-02-02](#)
[LEDS100-02-04](#) [LEDS100-05-04](#) [FF400-87](#) [LED80-04-04](#) [LEDA100-02-04](#) [AE20M-115FA](#) [AE30M-FT-01](#) [A8BM-24DC](#) [LEDD100-02-04](#)
[LEDS100-02-02](#) [50067](#) [LED80-04-03](#) [LEDD100-05-04](#) [LEDS100-01-04](#) [X195-02WH-01](#) [LEDA100-03-01](#) [RA200-25](#) [AE36M-02](#)
[LED80-04-02](#) [LEDA100-02-01](#) [FF201-85](#) [X195-02WH-02](#) [A6BM-24DC](#) [LED100-02-04](#) [LED100-05-02](#) [LED100-05-04](#) [LEDA100-01-02](#)
[LEDD100-05-01](#) [LED80-02-04](#) [LEDD100-05-02](#) [X401-18](#) [LEDS100-02-01](#) [X80-04-01](#) [LED80-02-03](#) [50018](#) [LEDA100-05-02](#)
[LED100-02-01](#) [LED100-05-01](#) [LEDA100-02-02](#) [LEDS100-05-01](#) [50088FA](#)