

Features

Regulated Converters

- Reinforced Insulation for 250VAC Working Voltage
- Clearance and Creepage Distance: 8mm
- 5kVAC I/P to O/P 2MOPP Isolation
- 2µA Patient Leakage Current
- Industry Standard Pinout
- 2:1 and 4:1 Wide Input Range

Description

The REM6 series of medical grade regulated DC/DC converters features reinforced 5kVAC/1 minute isolation with low 2µA leakage and are 60601-1 3rd Ed. certified for 250VAC continuous working. The compact DIP24 package offers tightly regulated single and dual outputs, even under no-load conditions. The outputs are short circuit and overload protected. The converters are available in two different pinning options and optionally with an external control pin for standby consumption as low as 12.5mW. The converters are fully certified to CB, IEC/EN and ANSI/AAMI standards and carry the CE and UL marks.

Selection Guide

Part Number	Input Voltage Range (VDC)	Output Voltage (VDC)	Output Current (mA)	Efficiency typ. (%)	Max. Capacitive Load (µF)
REM6-xx3.3S/ (3,4)	4.5-9 / 9-18 / 18-36 / 36-75	3.3	1800	81.5 / 83.5 / 83 / 82.5	2100
REM6-xx05S/ (3,4)	4.5-9 / 9-18 / 18-36 / 36-75	5	1200	86 / 86 / 86 / 86.5	1500
REM6-xx12S/ (3,4)	4.5-9 / 9-18 / 18-36 / 36-75	12	500	86 / 89 / 89 / 88	260
REM6-xx15S/ (3,4)	4.5-9 / 9-18 / 18-36 / 36-75	15	400	87.5 / 88.5 / 88.5 / 88.5	210
REM6-xx24S/ (3,4)	4.5-9 / 9-18 / 18-36 / 36-75	24	250	87 / 88.5 / 88.5 / 88	75
REM6-xx05D/ (3,4)	4.5-9 / 9-18 / 18-36 / 36-75	±5	±600	84 / 85 / 85 / 85	±860
REM6-xx12D/ (3,4)	4.5-9 / 9-18 / 18-36 / 36-75	±12	±250	86.5 / 89 / 88.5 / 88	±150
REM6-xx15D/ (3,4)	4.5-9 / 9-18 / 18-36 / 36-75	±15	±200	87.5 / 88 / 88.5 / 87	±110
REM6-xx3.3SW/ (3,4)	9-36 / 18-75	3.3	1800	83 / 82.5	2100
REM6-xx05SW/ (3,4)	9-36 / 18-75	5	1200	86 / 86.5	1500
REM6-xx12SW/ (3,4)	9-36 / 18-75	12	500	89 / 88	260
REM6-xx15SW/ (3,4)	9-36 / 18-75	15	400	89 / 88.5	210
REM6-xx24SW/ (3,4)	9-36 / 18-75	24	250	88.5 / 88	75
REM6-xx05DW/ (3,4)	9-36 / 18-75	±5	±600	85 / 85	±860
REM6-xx12DW/ (3,4)	9-36 / 18-75	±12	±250	88.5 / 88	±150
REM6-xx15DW/ (3,4)	9-36 / 18-75	±15	±200	88.5 / 87	±110

Model Numbering

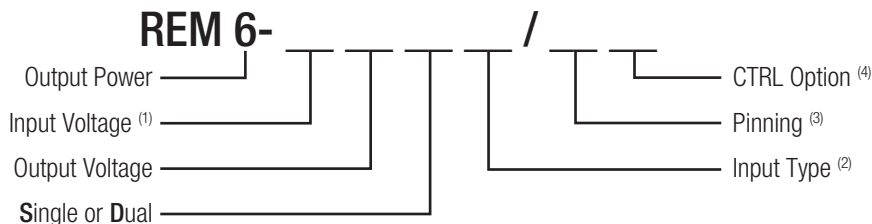

Notes:

Note1: for 4:1 Input Voltage Type add "W", see Note 2.

2:1		4:1 "W"	
xx= 4.5-9 Vin	= "05"	xx= 9-36Vin	= "24"
xx= 9-18Vin	= "12"	xx= 18-75Vin	= "48"
xx= 18-36Vin	= "24"		
xx= 36-75Vin	= "48"		

Note2: Blank for Standard 2:1 Input Voltage Range; „W" suffix for 4:1 Input Voltage Range

Note3: „A" suffix for A pinning; „C" suffix for C pinning, for more details refer to Package Style and Pinning

Note4: „CTRL" suffix for control pin option, for A pinning only, for C pinning not available

Examples:

REM6-0512D/A	=	2:1 Input, 4.5-9Vin, ±12Vout,	pinout „A",	without control pin
REM6-1215S/C	=	2:1 Input, 9-18Vin, 15Vout,	pinout „C",	without control pin
REM6-4815SW/A/CTRL	=	4:1 Input, 36-75Vin, 15Vout,	pinout „A"	with control pin
REM6-243.3SW/C	=	4:1 Input, 9-36Vin, 3.3Vout,	pinout „C",	without control pin

REM6

6 Watt

2:1 & 4:1

DIP24

Single and Dual Output



2MOPP 250VAC

IEC-60601-1 Certified
ES-60601-1 Certified
EN-55011 Certified
EN-55022 Certified

Specifications (measured at TA= 25°C, nominal input voltage, full load and after warm-up)

BASIC CHARACTERISTICS					
Parameter	Condition		Min.	Typ.	Max.
Absolute Maximum Input Voltage (3sec max.)	2:1	5Vin nom.			16VDC
		12Vin nom.			25VDC
	4:1	24Vin nom.			50VDC
		48Vin nom.			100VDC
Under Voltage Lockout	2:1	5Vin nom.	4VDC		4.5VDC
		12Vin nom.	8VDC		9VDC
	4:1	24Vin nom.	16VDC		18VDC
		48Vin nom.	33VDC		36VDC
	4:1	24Vin nom.	8VDC		9VDC
		48Vin nom.	16VDC		18VDC
Start-up Time	constant resistive load, Power up or Remote ON/OFF			30ms	
Remote ON/OFF (referenced to -Vin Pin)	DC-DC ON DC-DC OFF		Open or 0-1.2VDC 2.2-12VDC		
Current of CTRL Pin			-0.5mA		1mA
Remote OFF Input Current				2.5mA	
Operating Frequency Range			225kHz	250kHz	275kHz
Output Ripple and Noise (20MHz BW limited)	10µF/25V X7R MLCC for 3.3, 5Vout 10µF/25V X7R MLCC for 12, 15Vout 4.7µF/50V X7R MLCC for 24Vout			30mVp-p 40mVp-p 50mVp-p	

Efficiency

Table1 : Efficiency Crosstable

Graph1 : Efficiency Factor vs. Load

Efficiency Crosstable (%) @ full load							
		Input Voltage					
		5	12	24	48	24W	48W
Output Voltage	3.3S	81.5	83.5	83	82.5	83	82.5
	05S	86	86	86	86.5	86	86.5
	12S	86	89	89	88	89	88
	15S	87.5	88.5	89	88.5	89	88.5
	24S	87	88.5	88.5	88	88.5	88
	05D	84	85	85	85	85	85
	12D	86.5	89	88.5	88	88.5	88
	15D	87.5	88	88.5	87	88.5	87

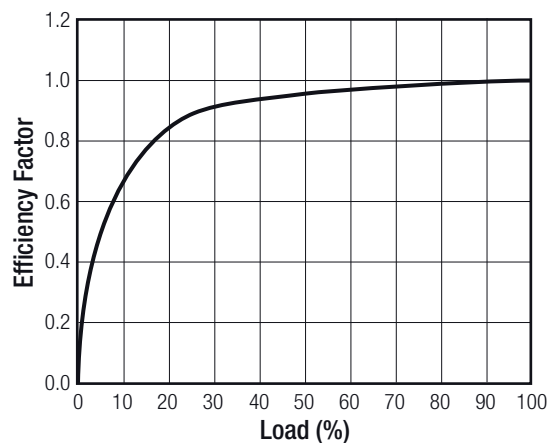

continued on next page

Specifications (measured at T_A= 25°C, nominal input voltage, full load and after warm-up)

Calculation Example:

choose your model:

REM6-1212D

- Efficiency from Table1 (= 89% @ max Load / nom Vin)
- Loading conditions in application (e.g. 50%)
- use Eff factor from Graph1 (= 0.96 @50%)

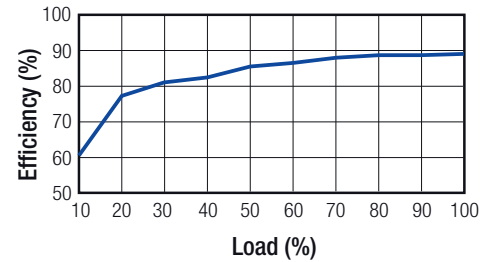

Calculation:

V_{in} = 12V
 I_{out} = 50%
 Eff_{100%} = 89%
 Eff_{factor50%} = 0.96
 R_{th} = 18°C/W
 T_{CASEmax} = 105°C

$$Eff_{50\%} = Eff_{100\%} * Eff_{factor50\%} = 89 * 0.96 = \underline{85.44\%}$$

$$P_{DIS50\%} = P_{in50\%} - P_{out50\%} = \frac{P_{out100\%} * 0.5}{Eff_{50\%}} - (P_{out100\%} * 0.5) = 3.51 - 3 = \underline{0.51W}$$

$$T_{OVER} = R_{th} * P_{DIS50\%} = 18 * 0.51 = \underline{9.2^\circ C}$$

$$T_{AMBmax} = T_{CASEmax} - T_{OVER} = 105 - 9.2 = \underline{95.8^\circ C}$$

REGULATIONS				
Parameter	Condition		Type	Value
Output Voltage Accuracy				±1%
Line Voltage Regulation	LL to HL	Single		±0.2%
	LL to HL	Dual		±0.5%
Load Voltage Regulation	no load to full load	Single		±0.2%
	no load to full load	Dual		±1%
Cross Regulation	asymmetrical load 25% / Full Load only Dual Output			±5%
Transient Response	25% load step change			250µs

PROTECTIONS				
Parameter	Condition		Type	Value
Short Circuit Protection (SCP)				continuous, auto-recovery
Over Load Protection (OLP)	% of I _{out} rated			Hiccup mode, 150% typ.
Output Over Voltage Protection (OVP)			Single	3.3V _{out} 3.7VDC min. / 5VDC max.
			5V _{out} 5.6VDC min. / 7VDC max.	
			12V _{out} 13.5VDC min. / 16VDC max.	
			15V _{out} 18.3VDC min. / 22VDC max.	
			24V _{out} 29.1VDC min. / 34.5VDC max.	
			Dual	5V _{out} 5.6VDC min. / 7VDC max.
12V _{out} 13.5VDC min. / 18.2VDC max.				
15V _{out} 17VDC min. / 22VDC max.				

continued on next page

Specifications (measured at T_A= 25°C, nominal input voltage, full load and after warm-up)

Isolation Voltage	I/P to O/P working voltage	5kVAC / 1 minute 250VAC / continuous
Means of Protection		2MOPP
Leakage Current	240VAC, 60Hz	2µA
Medical Device Classification		Type CF applied device (design to meet)
Internal Clearance	I/P to O/P	8mm
Creepage	I/P to O/P	8mm
External Clearance	I/P to O/P, Single Output	>19.72mm
	I/P to O/P, Dual Output	>14.64mm
Creepage	I/P to O/P, Single Output	>19.72mm
	I/P to O/P, Dual Output	>14.64mm
Isolation Capacitance		12pF typ. / 17pF max.
Insulation Grade		Reinforced Insulation

Notes:

Note5: This Power module is not internally fused. A input line fuse must be always used.

Recommended Fuse:	2:1 Input Voltage	Fuse (slow blow)	4:1 Input Voltage	Fuse (slow blow)
	5V	T2.5A	24V	T1.25A
	12V	T1.25A	48V	T0.63A
	24V	T0.63A		
	48V	T0.315A		

ENVIRONMENTAL

Parameter	Condition	Value
Relative Humidity		5% to 95% RH
Temperature Coefficient		±0.02% / °C
Thermal Impedance	natural convection (20LFM)	18°C / W
max. Case Temperature Range		-40°C to +105°C
max. Ambient Temperature Range		see calculation example
MTBF (+25°C)	according to MIL-HDBK-217F, full load	4718 x 10 ³ hours

SAFETY AND CERTIFICATIONS

Certificate Type (Safety)	Report / File Number	Standard
CB Medical Safety	E314885-A6 1409015	IEC-60601-1 Medical Report + ISO14971 Risk Assessment
ANSI/AAMI	E314885-A6	ES60601-1
CAN/CSA Medical	E314885-A6	C22.2 No. 60601-1:08

Certificate Type (Others)	Conditions	Standard / Criterion
EMI Standard ⁽⁷⁾	Conducted Radiated Conducted and Radiated	EN55011 (EN-55022), Class A, B EN55011 (EN-55022), Class A, B FCC18
ESD	Air ±8kV; Contact ±6kV	EN61000-4-2, Criteria A
Radiated Immunity	10V/m	EN61000-4-3, Criteria A
Fast Transient ⁽⁶⁾	±2kV	EN61000-4-4, Criteria A
Surge ⁽⁶⁾	±2kV	EN61000-4-5, Criteria A
Conducted Immunity	20Vr.m.s	EN61000-4-6, Criteria A

continued on next page

Specifications (measured at $T_A= 25^{\circ}\text{C}$, nominal input voltage, full load and after warm-up)

Power Frequency Magnetic Field	10A/m	EN61000-4-8, Criteria A
Thermal Shock		MIL-STD-810F
Vibration		MIL-STD-810F

Notes:

Note6: An external input filter capacitor is required if the model has to meet EN61000-4-4 or/and EN61000-4-5.

<u>Recommended components:</u>	5Vin	aluminium capacitor (Nippon Chemi-con KY series, 1000 $\mu\text{F}/25\text{V}$) and a reverse diode (Vishay V10P45) to connect in parallel
	12Vin, 24Vin	aluminium capacitor (Nippon Chemi-con KY series, 470 $\mu\text{F}/50\text{V}$)
	48Vin	aluminium capacitor (Nippon Chemi-con KY series, 330 $\mu\text{F}/100\text{V}$)

Note7: The whole REM6 series can meet EMI Class A with no external filter. And Class B only with external components.

EMC Filter Suggestion for Class B

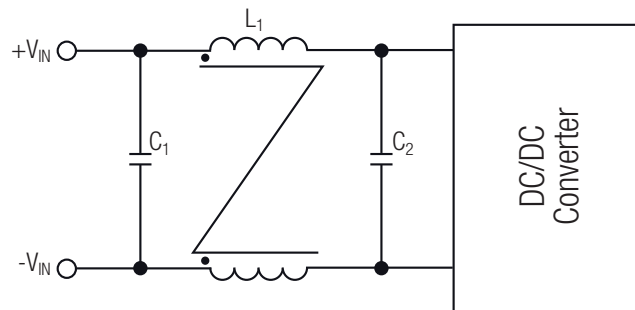

MODEL	C1 ⁽⁸⁾	C2 ⁽⁸⁾	L1 ⁽⁸⁾
REM6-05xxS_D	22 $\mu\text{F}/16\text{V}$ MLCC	22 $\mu\text{F}/16\text{V}$ MLCC	33mH WE 744825433
REM6-12xxS_D REM6-24xxS_D REM6-24xxS_D/W	4.7 $\mu\text{F}/50\text{V}$ MLCC	4.7 $\mu\text{F}/50\text{V}$ MLCC	500 μH WE 744223
REM6-48xxS_D REM6-48xxS_D/W	2.2 $\mu\text{F}/100\text{V}$ MLCC	1 $\mu\text{F}/100\text{V}$ MLCC	500 μH WE 744223

Notes:

Note8: The component values can be adapted according to customers' application.

DIMENSION and PHYSICAL CHARACTERISTICS		
Parameter	Type	Value
Case Material		non-conductive black plastic
Potting Material		silicone (UL94-V0)
Package Dimension (LxWxH)		31.80 x 20.30 x 10.40mm
Package Weight		14g

continued on next page

Specifications (measured at $T_A = 25^\circ\text{C}$, nominal input voltage, full load and after warm-up)

Dimension Drawing (mm)

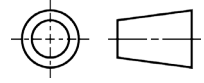

“C” Pinning

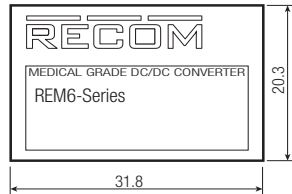

“A” Pinning (Standard)

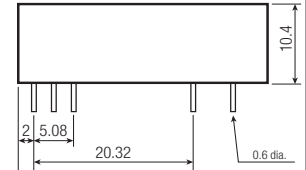
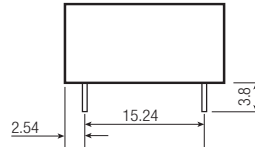
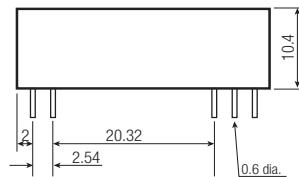
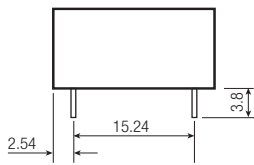
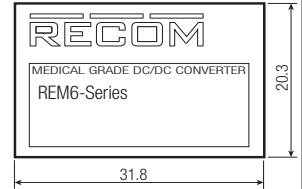

Pin Connections

Pin #	Single	Dual
1	+Vin	+Vin
11	No Pin	Com
12	-Vout	No Pin
13	+Vout	-Vout
15	No Pin	+Vout
23	-Vin	-Vin
24	-Vin	-Vin

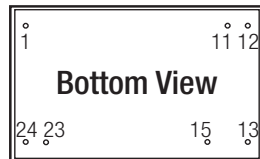

Pin Connections

Pin #	Single	Dual
1	CTRL*	CTRL*
2	-Vin	-Vin
11	NC	-Vout
14	+Vout	+Vout
16	-Vout	Com
22	+Vin	+Vin
23	+Vin	+Vin

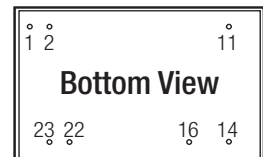

Tolerance: xx.x= ±0.5mm
xx.xx= ±0.25mm

* If don't choose CTRL option, there is no pin on the corresponding pin number

NC= not connected
Tolerance: xx.x= ±0.5mm
xx.xx= ±0.25mm

PACKAGING INFORMATION

Parameter	Type	Value
Packaging Dimension (LxWxH)	Tube	255 x 21.8 x 16.5mm
Packaging Quantity		7pcs
Storage Temperature Range		-55°C to +125°C

Tube Dimension Drawing (mm)

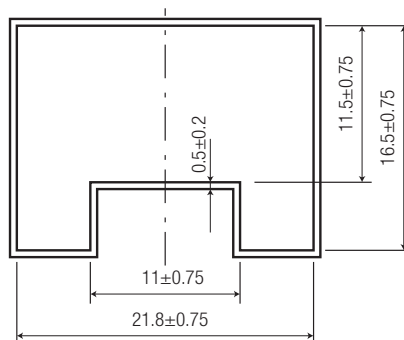

The product information and specifications are subject to change without prior notice. RECOM products are not authorized for use in safety-critical applications (such as life support) without RECOM's explicit written consent. A safety-critical application is defined as an application where a failure of a RECOM product may reasonably be expected to endanger or cause loss of life, inflict bodily harm or damage property. The buyer shall indemnify and hold harmless RECOM, its affiliated companies and its representatives against any damage claims in connection with the unauthorized use of RECOM products in such safety-critical applications.

X-ON Electronics

Largest Supplier of Electrical and Electronic Components

Click to view similar products for [Isolated DC/DC Converters](#) category:

Click to view products by [RECOM POWER](#) manufacturer:

Other Similar products are found below :

[ESM6D044440C05AAQ](#) [FMD15.24G](#) [PSL486-7LR](#) [PSR152.5-7IR](#) [Q48T30020-NBB0](#) [AVO240-48S12B-6L](#) [AVO250-48S28B-6L](#) [NAN-0505](#) [HW-L16D](#) [JAHW100Y1](#) [217-1617-001](#) [22827](#) [SPB05C-12](#) [SQ24S15033-PS0S](#) [18952](#) [19-130041](#) [CE-1003](#) [CE-1004](#) [GQ2541-7R](#) [PSE1000DCDC-12V](#) [RDS180245](#) [MAU228](#) [419-2065-201](#) [449-2075-101](#) [J80-0041NL](#) [V300C24C150BG](#) [419-2062-200](#) [419-2063-401](#) [419-2067-101](#) [419-2067-501](#) [419-2068-001](#) [DCG40-5G](#) [DFC15U48D15](#) [449-2067-000](#) [XGS-0512](#) [XGS-1205](#) [XGS-1212](#) [XGS-2412](#) [XGS-2415](#) [XKS-1215](#) [033456](#) [NCT1000N040R050B](#) [SPB05B-15](#) [SPB05C-15](#) [SSQE48T25025-NAA0G](#) [L-DA20](#) [HP3040-9RG](#) [HP1001-9RTG](#) [XKS-2415](#) [XKS-2412](#)