

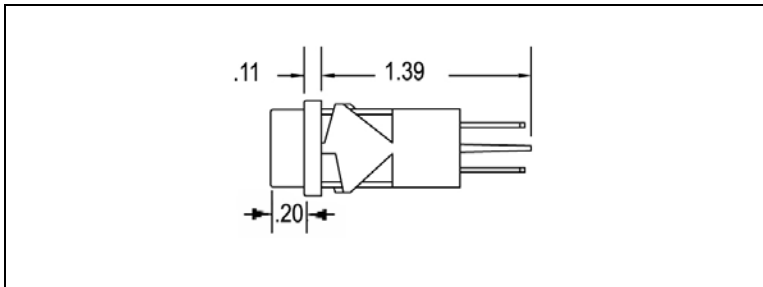

**Panel Mount Indicator, Non-Relampable
Neon Technology
Mounting Hole, Ø 0.500"**



All dimensions are in inches



Recommended panel thickness: 0.030" to 0.090"

.187 terminals are standard

Storage temperature T_{STG} : -25°C - +80°C
 Ambient temperature T_A : -20°C - +60°C
 Voltage tolerance V_{OP} : ±10%

| Part No. | Lens Color | Voltage | Current mA | Rated Life |
|---------------------------|------------|------------|------------|------------|
| Neon 115VAC Series | | | | |
| WL-1060QC1 | Red | 105-125VAC | 1.5mA | 25,000 Hrs |
| WL-1060QC3 | Amber | 105-125VAC | 1.5mA | 25,000 Hrs |
| WL-1060QC4 | White | 105-125VAC | 1.5mA | 25,000 Hrs |
| WL-1060QC5 | Green | 105-125VAC | 1.5mA | 25,000 Hrs |
| Neon 230VAC Series | | | | |
| WL-1061QC1 | Red | 208-250VAC | 1.5mA | 25,000 Hrs |
| WL-1061QC3 | Amber | 208-250VAC | 1.5mA | 25,000 Hrs |
| WL-1061QC4 | White | 208-250VAC | 1.5mA | 25,000 Hrs |
| WL-1061QC5 | Green | 208-250VAC | 1.5mA | 25,000 Hrs |
| Neon 480VAC Series | | | | |
| WL-1062QC1 | Red | 432-528VAC | 1.5mA | 25,000 Hrs |
| WL-1062QC3 | Amber | 432-528VAC | 1.5mA | 25,000 Hrs |
| WL-1062QC4 | White | 432-528VAC | 1.5mA | 25,000 Hrs |
| WL-1062QC5 | Green | 432-528VAC | 1.5mA | 25,000 Hrs |
| Neon 600VAC Series | | | | |
| WL-1063QC1 | Red | 540-660VAC | 1.5mA | 25,000 Hrs |
| WL-1063QC3 | Amber | 540-660VAC | 1.5mA | 25,000 Hrs |
| WL-1063QC4 | White | 540-660VAC | 1.5mA | 25,000 Hrs |
| WL-1063QC5 | Green | 540-660VAC | 1.5mA | 25,000 Hrs |

Body Material: Polycarbonate, white
 Lens Material: Polycarbonate
 Bezel Material: Stainless steel
 Note: .250 quick connects available upon request

Certifications: Most Wamco indicators carry Agency approvals. Please contact Wamco for the latest Agency information regarding the specific product series and voltage required.
 Options: Additional options and lens styles available. Please contact Wamco for more information.

| | | | | | |
|----------|----|----------|---|--|------------------|
| Drawn | SC | 03/01/10 | Panel Mount Indicators Neon and Incandescent | Datasheet: WL-106XQCX Series | Rev: 1 |
| Checked | EB | 03/01/10 | | | |
| Approved | EB | 03/02/10 | | | |

X-ON Electronics

Largest Supplier of Electrical and Electronic Components

Click to view similar products for [wamco manufacturer](#):

Other Similar products are found below :

[WL-2195A5-28V](#) [WL-19041351](#) [WL-B05I03L0300](#) [WL-1090D1-12V](#) [WL-1061QC1](#) [WL-192A1250](#) [WL-2153A5](#) [WL-19012353](#) [WL-19010351](#) [WL-19210250](#) [WL-19091352](#) [WL-19040352](#) [WL-19040252](#) [WL-1090QC4-28V](#) [WL-19050352](#) [WL-1090QC3-28V](#) [WL-B05G10F0900](#) [WL-6091QM5-24V](#) [WL-19040257](#) [WL-19210350](#) [WL-19080255](#) [WL-192A0351](#) [WL-1090A1-28V](#) [WL-192A1350](#) [WL-19210251](#) [WL-19040451](#) [WL-19040353](#) [WL-19011352](#) [WL-19081350](#) [WL-192A0350](#) [WL-19040357](#) [WL-19050257](#) [WL-1062C1](#) [WL-1090A5-12V](#) [WL-19090350](#) [WL-1860235W3D](#) [WL-1051QC1](#) [WL-1052QC5](#) [WL-6391Q2D5-24V](#) [WL-2151A1](#) [WL-19090252](#) [WL-1032D5](#) [WL-192A1251](#) [WL-2191U5-12V](#) [WL-2152A5](#) [WL-19090355](#) [WL-6391Q2M3-12V](#) [WL-1060QC5](#) [WL-2150A3](#) [WL-19210351](#)