

Number of contacts

3 + 



Identification	Part number		Drawing	Dimensions in mm
	Male insert (M)	Female insert (F)		

**Crimp terminal**  
Order crimp contacts separately

09 12 003 3051

09 12 003 3151

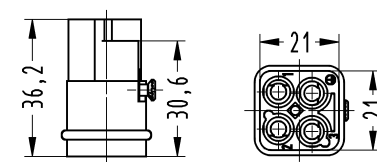

**Coding element**  
20 pieces per frame



09 12 000 9924

09 12 000 9924

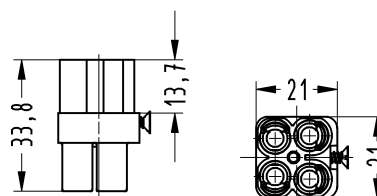

Contact arrangement view from termination side

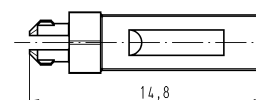

Identification	Wire gauge (mm²)	Part number		Drawing	Dimensions in mm
		Male contact	Female contact		

**Crimp contacts**

Power contacts

silver plated



1.5  
2.5  
4  
6  
10

09 32 000 6104  
09 32 000 6105  
09 32 000 6107  
09 32 000 6108  
09 32 000 6109

09 32 000 6204  
09 32 000 6205  
09 32 000 6207  
09 32 000 6208  
09 32 000 6209

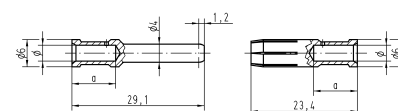

Wire gauge			Ø	Stripping length
1.5	mm²	AWG 16	1.75	9 mm
2.5	mm²	AWG 14	2.25	9 mm
4	mm²	AWG 12	2.85	9.6 mm
6	mm²	AWG 10	3.5	9.6 mm
10	mm²	AWG 8	4.3	12 mm

## Features

- High current inserts designed to fit all hoods/housings size Han® 3 A
- 4 coding options
- Use of standard Han® C crimp contacts
- Finger protected male and female contacts
- Pre-mating PE crimp contact

## Current Carrying Capacity

The current carrying capacity of the connectors is limited by the thermal load capability of the contact element material including the connections and the insulating parts. The derating curve is therefore valid for currents which flow constantly (non-intermittent) through each contact element of the connector evenly, without exceeding the allowed maximum temperature.

Measuring and testing techniques according to DIN EN 60 512-5

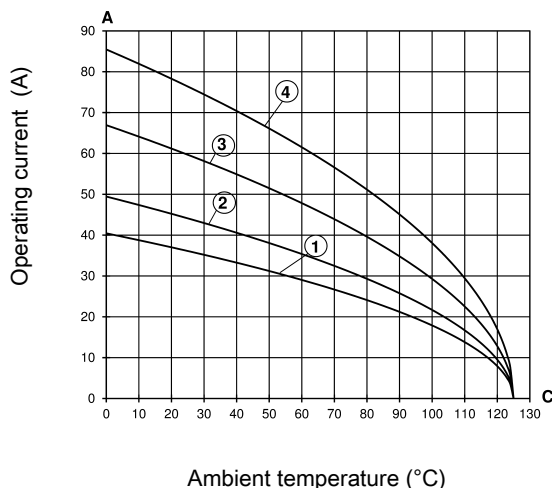

- ① wire gauge: 2.5 mm<sup>2</sup>
- ② wire gauge: 4 mm<sup>2</sup>
- ③ wire gauge: 6 mm<sup>2</sup>
- ④ wire gauge: 10 mm<sup>2</sup>

## Technical characteristics

### Inserts

Number of contacts	3 + PE
Electrical data	
acc. to EN 61 984	<b>40 A 400 V 6 kV 3</b>
Rated current	40 A
Rated voltage	400 V
Rated impulse voltage	6 kV
Pollution degree	3

Insulation resistance	≥ 10 <sup>10</sup> Ω
Material	polycarbonate
Limiting temperatures	-40 °C ... 125 °C
Flammability acc. to UL 94	V 0
Mechanical working life	
- mating cycles	≥ 500

### Contacts

Material	copper alloy
Surface	
- hard-silver plated	3 μm Ag
Contact resistance	≤ 1 mΩ
Crimp termination	
- mm <sup>2</sup>	1.5 ... 10 mm <sup>2</sup>
- AWG	16 ... 8

### Tools

see chapter 99  
in the main catalogue  
„Industrial Connectors Han®“

### Hoods/Housings

Detailed information and further hoods/housings types see catalogue „Industrial Connectors Han®“, chapter 31

#### Plastic hoods/housings

Material	polycarbonate
Flammability acc. to UL 94	V 0
Degree of protection acc. to DIN EN 60 529 for coupled connector	IP 67

#### Metal hoods/housings

Material	zinc die-cast
Degree of protection acc. to DIN EN 60 529 for coupled connector	IP 44
	IP 67 is achieved with seal screw 09 20 000 9918

## X-ON Electronics

Largest Supplier of Electrical and Electronic Components

*Click to view similar products for [Terminals](#) category:*

*Click to view products by [HARTING](#) manufacturer:*

Other Similar products are found below :

[HT-13-10](#) [71M-250-32-NB](#) [01-2065-1-0216](#) [00581P0075](#) [M10-10RX](#) [M10BCK](#) [60205-1](#) [604200-1](#) [60598-1-CUT-TAPE](#) [60617-1-C](#) [60873-1](#) [M14-516R/SK](#) [M14-6RSX](#) [M18-10FLX](#) [M18-8FBX](#) [M18-8R/LX](#) [M18BCK](#) [61314-6-C](#) [61-S](#) [61-SN-A](#) [62149-1](#) [62-NBM-A](#) [63-S](#) [640179-1](#) [640917-2-CUT-TAPE](#) [6501550002](#) [66107-2-C](#) [66107-4-C](#) [696683-1](#) [696834-1](#) [696861-1](#) [696931-1](#) [696999-1](#) [M8-516RK](#) [M86700006](#) [MA250DMFMX-A](#) [701-2007](#) [701-2307](#) [701-7761-03](#) [70F-110-32-PB](#) [718-N-A](#) [71M-187-20-NBL](#) [71M-250-32-NBL](#) [72F-187-20-NBL](#) [72M-250-32-NBL](#) [7310](#) [73F-250-32](#) [73F-250-32-NBL](#) [73F-250-32-NL](#) [F-1M](#)