

Connectors in 3.50 mm pitch Series BL/SL 3.50

BL 3.50/././180

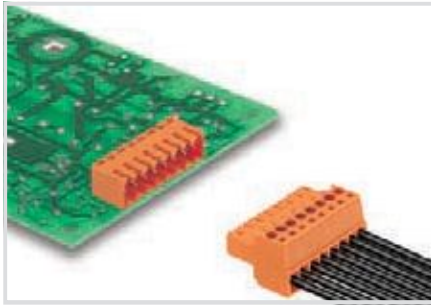

Female plug with clamping-yoke screw system for connecting wires with straight outlet direction in 3.5 mm pitch. Available with a screw flange (F), release lever (LH) or lock and release lever (LR). They include space for labelling and can be coded.

Product data

IEC: 320 V / 17 A / 0.2 - 1.5 mm²
UL: 300 V / 10 A / AWG 28 - 14

For additional articles and information, refer to catalog.weidmueller.com

Note:

- Additional colours on request
- Gold-plated contact surfaces on request
- Rated current related to rated cross-section and min. No. of poles.
- Max. O.D. of conductor: 2.9 mm
- Wire end ferrule without plastic collar to DIN 46228/1
- Wire end ferrule with plastic collar to DIN 46228/4
- P on drg. = pitch
- Rated data refer only to the component itself. Clearance and creepage distances to other components are to be designed in accordance with the relevant application standards.

BL 3.50/././180

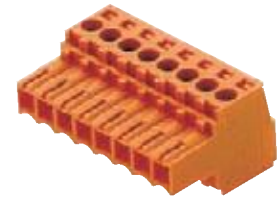

Dimensioned drawing

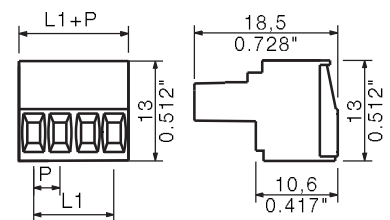

Technical data

In compliance with IEC 60664-1 / IEC 61984

Clamping range, max.	mm ²	0.08...1.5
Solid core H05(07) V-U	mm²	0.2...1.5
Stranded H07 V-R		
Flexible H05(07) V-K	mm ²	0.2...1.5
Flexible with ferrule	mm ²	0.2...1.5
Ferrule with plastic collar	mm ²	0.2...1.5
Stripping length	mm	6
Screwdriver blade	mm	0.4 x 2.5
According to norm		DIN 5264
Tightening torque range	Nm	0.2...0.25
Rated current, max.	A	17 14.5
At ambient temperature		20°C 40°C
For conductor cross-section	mm ²	1.5
Overvoltage category	III III II	
Pollution severity	3 2 2	
Rated voltage	V	160 160 320
Rated impulse voltage	kV	2.5 2.5 2.5
UL / CUL (Use Group)	B C D	D
Rated voltage	V	300 300
Rated current	A	10 10
AWG conductor	AWG	28-14
CSA (Use Group)	B C D	D
Rated voltage	V	300 300
Rated current	A	10 10
AWG conductor	AWG	28-14

General data

Type of insulation material	PBT
Flammability class UL 94	V-0
Contact base material	Copper alloy
Material of contact surface	tinned
Pin dimensions = d	mm
Solder eyelet Ø = D	mm
Solder eyelet Ø tolerance	mm

Accessories

Note: Refer to the Accessories chapter for additional accessories.

Coding	Order No.
BL SL 3.5 KO OR	1693430000
BL SL 3.5 KO SW	1610100000
Hood	
BL 3.5 AH 10 SW	1745650000
BL 3.5 AH 11 SW	1745660000
BL 3.5 AH 12 SW	1745670000
BL 3.5 AH 13 SW	1745680000
BL 3.5 AH 14 SW	1745690000
BL 3.5 AH 15 SW	1745700000
BL 3.5 AH 16 SW	1745710000
BL 3.5 AH 3 SW	1745580000
BL 3.5 AH 4 SW	1745590000
BL 3.5 AH 5 SW	1745600000
BL 3.5 AH 6 SW	1745610000
BL 3.5 AH 7 SW	1745620000
BL 3.5 AH 8 SW	1745630000
BL 3.5 AH 9 SW	1745640000
Strain relief	
BL 3.5 ZE 3 OR	1629680000
BL 3.5 ZE 3 SW	1627820000
BL 3.5 ZE 8 OR	1629690000
BL 3.5 ZE 8 SW	1627830000
Interlock	
BL/SL 3.5 VR OR	1669310000
BL/SL 3.5 VR SW	1669300000
Screwdriver	
SD 0,4x2,5x75	9009030000
SDI 0,4x2,5x75	9008370000

Ordering data

Solder pin length		Colour	
Colour	orange	black	
Pitch	3.50 mm		
Pol.	L1 (inch)	Qty.	Order No.
2	3.50 0.138	100	1597360000 1615670000
3	7.00 0.276	100	1597370000 1615680000
4	10.50 0.413	100	1597380000 1615690000
5	14.00 0.551	50	1597390000 1614090000
6	17.50 0.689	50	1597400000 1610180000
7	21.00 0.827	50	1597410000 1610190000
8	24.50 0.965	50	1597420000 1615700000
9	28.00 1.102	50	1597430000 1615710000
10	31.50 1.240	50	1597440000 1610200000
11	35.00 1.378	50	1597450000 1615720000
12	38.50 1.516	50	1597460000 1615730000
13	42.00 1.654	50	1597470000 1615740000
14	45.50 1.791	50	1597480000 1615750000
15	49.00 1.929	50	1597490000 1615760000
16	52.50 2.067	50	1597500000 1615770000
17	56.00 2.205	20	1620290000 1620370000
18	59.50 2.343	20	1620300000 1620380000
19	63.00 2.480	20	1620310000 1620390000
20	66.50 2.618	20	1620320000 1620400000
21	70.00 2.756	20	1620330000 1620410000
22	73.50 2.894	20	1620340000 1620420000
23	77.00 3.031	20	1620350000 1620430000
24	80.50 3.169	20	1620360000 1620440000

Representative derating curve

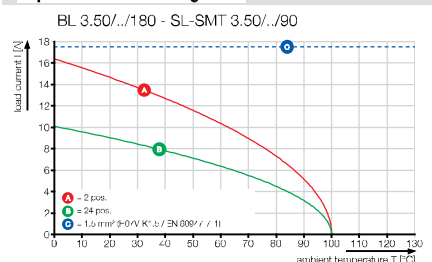

BL 3.50/./180F



Dimensioned drawing

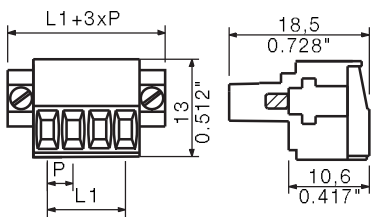

Ordering data

Solder pin length					
Colour		orange	black		
Pitch 3.50 mm					
Pol.	L1	(inch)	Qty.	Order No.	Order No.
2	3.50	0.138	100	1606640000	1615780000
3	7.00	0.276	100	1606650000	1615790000
4	10.50	0.413	100	1606660000	1615800000
5	14.00	0.551	50	1606670000	1615810000
6	17.50	0.689	50	1606680000	1615820000
7	21.00	0.827	50	1606690000	1615830000
8	24.50	0.965	50	1606700000	1615840000
9	28.00	1.102	50	1606710000	1615850000
10	31.50	1.240	50	1606720000	1615860000
11	35.00	1.378	50	1606730000	1615870000
12	38.50	1.516	50	1606740000	1615880000
13	42.00	1.654	50	1606750000	1615890000
14	45.50	1.791	50	1606760000	1615900000
15	49.00	1.929	50	1606770000	1615910000
16	52.50	2.067	50	1606780000	1615920000
17	56.00	2.205	20	1620760000	1620840000
18	59.50	2.343	20	1620770000	1620850000
19	63.00	2.480	20	1620780000	1620860000
20	66.50	2.618	20	1620790000	1620870000
21	70.00	2.756	20	1620800000	1620880000
22	73.50	2.894	20	1620810000	1620890000
23	77.00	3.031	20	1620820000	1620900000
24	80.50	3.169	20	1620830000	1620910000

BL 3.50/./180LH

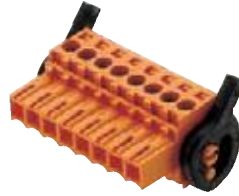

Dimensioned drawing

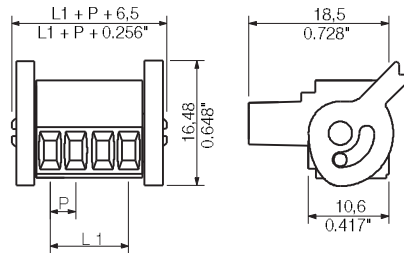

Ordering data

Solder pin length					
Colour		orange	black		
Pitch 3.50 mm					
Pol.	L1	(inch)	Qty.	Order No.	Order No.
2	3.50	0.138	100	1687650000	1687880000
3	7.00	0.276	100	1687660000	1687890000
4	10.50	0.413	100	1687670000	1687900000
5	14.00	0.551	50	1687680000	1687910000
6	17.50	0.689	50	1687690000	1687920000
7	21.00	0.827	50	1687700000	1687930000
8	24.50	0.965	50	1687710000	1687940000
9	28.00	1.102	50	1687720000	1687950000
10	31.50	1.240	50	1687730000	1687960000
11	35.00	1.378	50	1687740000	1687970000
12	38.50	1.516	50	1687750000	1687980000
13	42.00	1.654	50	1687760000	1687990000
14	45.50	1.791	50	1687770000	1688000000
15	49.00	1.929	50	1687780000	1688010000
16	52.50	2.067	50	1687790000	1688020000
17	56.00	2.205	20	1687800000	1688030000
18	59.50	2.343	20	1687810000	1688040000
19	63.00	2.480	20	1687820000	1688050000
20	66.50	2.618	20	1687830000	1688060000
21	70.00	2.756	20	1687840000	1688070000
22	73.50	2.894	20	1687850000	1688080000
23	77.00	3.031	20	1687860000	1688090000
24	80.50	3.169	20	1687870000	1688100000

BL 3.50/./180LR



Dimensioned drawing

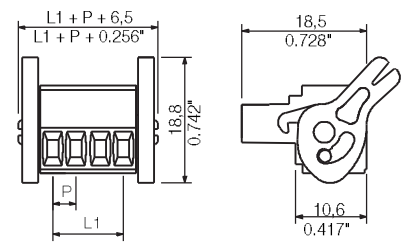

Ordering data

Solder pin length					
Colour		orange			
Pitch 3.50 mm					
Pol.	L1	(inch)	Qty.	Order No.	Order No.
3	7.00	0.276	100	1134310000	1134310000
4	10.50	0.413	100	1134320000	1134320000
5	14.00	0.551	50	1134330000	1134330000
6	17.50	0.689	50	1134340000	1134340000
7	21.00	0.827	50	1134350000	1134350000
8	24.50	0.965	50	1134360000	1134360000
9	28.00	1.102	50	1134370000	1134370000
10	31.50	1.240	50	1134380000	1134380000
11	35.00	1.378	50	1134390000	1134390000
12	38.50	1.516	50	1134400000	1134400000
13	42.00	1.654	50	1134410000	1134410000
14	45.50	1.791	50	1134420000	1134420000
15	49.00	1.929	50	1134430000	1134430000
16	52.50	2.067	50	1134440000	1134440000

Additional derating curves

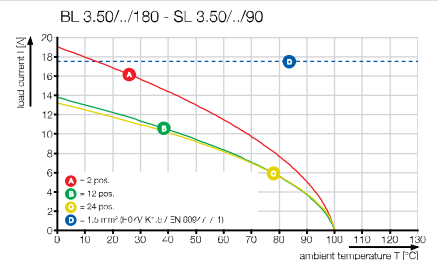
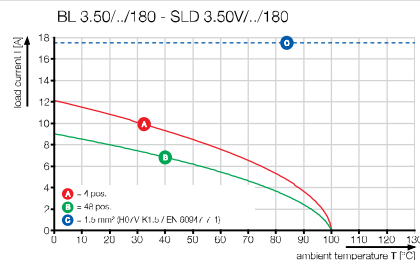
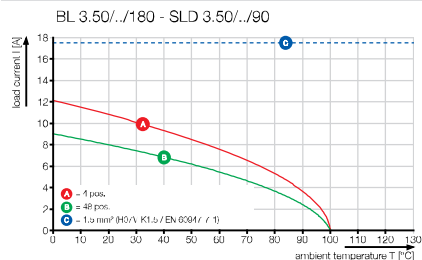

Connectors in 3.50 mm pitch Series BL/SL 3.50

BL 3.50/./90 & 270

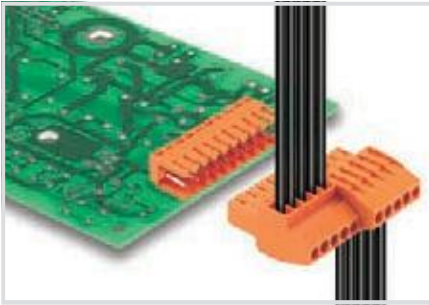

Female plug with clamping-yoke screw system for connecting wires with 90° and 270° angled orientation in 3.5 mm pitch. The female plugs are also available with a flange (F). They include space for labelling and can be coded.

Product data

IEC: 320 V / 12 A / 0.2 - 1.5 mm²
UL: 300 V / 8 A / AWG 28 - 14

For additional articles and information, refer to catalog.weidmueller.com

Note:

- Additional colours on request
- Gold-plated contact surfaces on request
- Rated current related to rated cross-section and min. No. of poles.
- Max. O.D. of conductor: 2.9 mm
- Wire end ferrule without plastic collar to DIN 46228/1
- Wire end ferrule with plastic collar to DIN 46228/4
- P on drg. = pitch
- Rated data refer only to the component itself. Clearance and creepage distances to other components are to be designed in accordance with the relevant application standards.

BL 3.50/./90



Dimensioned drawing

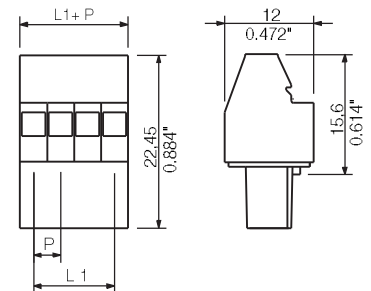





Technical data

In compliance with IEC 60664-1 / IEC 61984

Clamping range, max.	mm ²	0.08...1.5
Solid core H05(07) V-U	mm²	0.2...1.5
Stranded H07 V-R		
Flexible H05(07) V-K	mm ²	0.2...1.5
Flexible with ferrule	mm ²	0.2...1.5
Ferrule with plastic collar	mm ²	0.2...1.5
Stripping length	mm	6
Screwdriver blade	mm	0.4 x 2.5
According to norm		DIN 5264
Tightening torque range	Nm	0.2...0.25
Rated current, max.	A	12 10
At ambient temperature		20°C 40°C
For conductor cross-section	mm ²	1.5
Overvoltage category		III III II
Pollution severity		3 2 2
Rated voltage	V	160 160 320
Rated impulse voltage	kV	2.5 2.5 2.5
UL / CUL (Use Group)	B C D	B C D
Rated voltage	V	300 300
Rated current	A	8 8
AWG conductor	AWG	28-14
CSA (Use Group)	B C D	B C D
Rated voltage	V	300 300
Rated current	A	10 10
AWG conductor	AWG	28-14
General data		
Type of insulation material		PBT
Flammability class UL 94		V-0
Contact base material		Copper alloy
Material of contact surface		tinned
Pin dimensions = d	mm	
Solder eyelet Ø = D	mm	
Solder eyelet Ø tolerance	mm	

Accessories

Note: Refer to the Accessories chapter for additional accessories.

Coding	Order No.
 BL SL 3.5 KO OR	1693430000
 BL SL 3.5 KO SW	1610100000
Screwdriver	
 SD 0,4x2,5x75	9009030000
 SDI 0,4x2,5x75	9008370000

Ordering data

Solder pin length		orange		black	
Pitch	3.50 mm				
Pol.	L1 (inch)	Qty.	Order No.	Order No.	
2	3.50	0.138	100	1638550000	1638780000
3	7.00	0.276	100	1638560000	1638790000
4	10.50	0.413	100	1638570000	1638800000
5	14.00	0.551	50	1638580000	1638810000
6	17.50	0.689	50	1638590000	1638820000
7	21.00	0.827	50	1638600000	1638830000
8	24.50	0.965	50	1638610000	1638840000
9	28.00	1.102	50	1638620000	1638850000
10	31.50	1.240	50	1638630000	1638860000
11	35.00	1.378	50	1638640000	1638870000
12	38.50	1.516	50	1638650000	1638880000
13	42.00	1.654	50	1638660000	1638890000
14	45.50	1.791	50	1638670000	1638900000
15	49.00	1.929	50	1638680000	1638910000
16	52.50	2.067	50	1638690000	1638920000
17	56.00	2.205	20	1638700000	1638930000
18	59.50	2.343	20	1638710000	1638940000
19	63.00	2.480	20	1638720000	1638950000
20	66.50	2.618	20	1638730000	1638960000
21	70.00	2.756	20	1638740000	1638970000
22	73.50	2.894	20	1638750000	1638980000
23	77.00	3.031	20	1638760000	1638990000
24	80.50	3.169	20	1638770000	1639000000

Representative derating curve

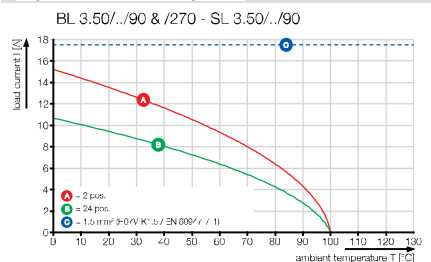

BL 3.50/././90F



Dimensioned drawing

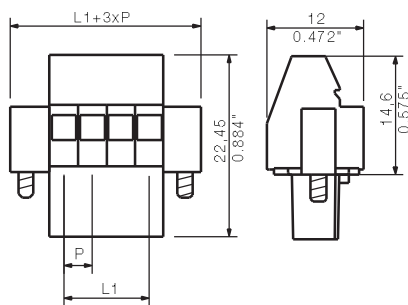

Ordering data

Solder pin length					
Colour		orange	black		
Pitch 3.50 mm					
Pol.	L1 (inch)	Qty.	Order No.	Order No.	
2	3.50	0.138	100	1639010000	1639240000
3	7.00	0.276	100	1639020000	1639250000
4	10.50	0.413	100	1639030000	1639260000
5	14.00	0.551	50	1639040000	1639270000
6	17.50	0.689	50	1639050000	1639280000
7	21.00	0.827	50	1639060000	1639290000
8	24.50	0.965	50	1639070000	1639300000
9	28.00	1.102	50	1639080000	1639310000
10	31.50	1.240	50	1639090000	1639320000
11	35.00	1.378	50	1639100000	1639330000
12	38.50	1.516	50	1639110000	1639340000
13	42.00	1.654	50	1639120000	1639350000
14	45.50	1.791	50	1639130000	1639360000
15	49.00	1.929	50	1639140000	1639370000
16	52.50	2.067	50	1639150000	1639380000
17	56.00	2.205	20	1639160000	1639390000
18	59.50	2.343	20	1639170000	1639400000
19	63.00	2.480	20	1639180000	1639410000
20	66.50	2.618	20	1639190000	1639420000
21	70.00	2.756	20	1639200000	1639430000
22	73.50	2.894	20	1639210000	1639440000
23	77.00	3.031	20	1639220000	1639450000
24	80.50	3.169	20	1639230000	1639460000

BL 3.50/././270



Dimensioned drawing

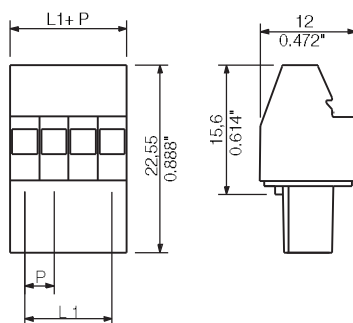

Ordering data

Solder pin length					
Colour		orange	black		
Pitch 3.50 mm					
Pol.	L1 (inch)	Qty.	Order No.	Order No.	
2	3.50	0.138	100	1639470000	1639700000
3	7.00	0.276	100	1639480000	1639710000
4	10.50	0.413	100	1639490000	1639720000
5	14.00	0.551	50	1639500000	1639730000
6	17.50	0.689	50	1639510000	1639740000
7	21.00	0.827	50	1639520000	1639750000
8	24.50	0.965	50	1639530000	1639760000
9	28.00	1.102	50	1639540000	1639770000
10	31.50	1.240	50	1639550000	1639780000
11	35.00	1.378	50	1639560000	1639790000
12	38.50	1.516	50	1639570000	1639800000
13	42.00	1.654	50	1639580000	1639810000
14	45.50	1.791	50	1639590000	1639820000
15	49.00	1.929	50	1639600000	1639830000
16	52.50	2.067	50	1639610000	1639840000
17	56.00	2.205	20	1639620000	1639850000
18	59.50	2.343	20	1639630000	1639860000
19	63.00	2.480	20	1639640000	1639870000
20	66.50	2.618	20	1639650000	1639880000
21	70.00	2.756	20	1639660000	1639890000
22	73.50	2.894	20	1639670000	1639900000
23	77.00	3.031	20	1639680000	1639910000
24	80.50	3.169	20	1639690000	1639920000

BL 3.50/././270F



Dimensioned drawing

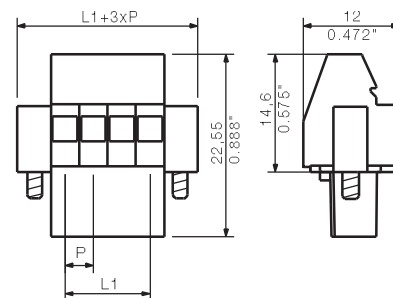

Ordering data

Solder pin length					
Colour		orange	black		
Pitch 3.50 mm					
Pol.	L1 (inch)	Qty.	Order No.	Order No.	
2	3.50	0.138	100	1639930000	1640160000
3	7.00	0.276	100	1639940000	1640170000
4	10.50	0.413	100	1639950000	1640180000
5	14.00	0.551	50	1639960000	1640190000
6	17.50	0.689	50	1639970000	1640200000
7	21.00	0.827	50	1639980000	1640210000
8	24.50	0.965	50	1639990000	1640220000
9	28.00	1.102	50	1640000000	1640230000
10	31.50	1.240	50	1640010000	1640240000
11	35.00	1.378	50	1640020000	1640250000
12	38.50	1.516	50	1640030000	1640260000
13	42.00	1.654	50	1640040000	1640270000
14	45.50	1.791	50	1640050000	1640280000
15	49.00	1.929	50	1640060000	1640290000
16	52.50	2.067	50	1640070000	1640300000
17	56.00	2.205	20	1640080000	1640310000
18	59.50	2.343	20	1640090000	1640320000
19	63.00	2.480	20	1640100000	1640330000
20	66.50	2.618	20	1640110000	1640340000
21	70.00	2.756	20	1640120000	1640350000
22	73.50	2.894	20	1640130000	1640360000
23	77.00	3.031	20	1640140000	1640370000
24	80.50	3.169	20	1640150000	1640380000

Connectors in 3.50 mm pitch Series BL/SL 3.50

BLZF 3.50/././180

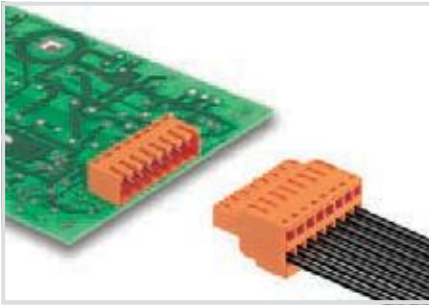

Female plug with tension-clamp wire connection in 3.5 mm pitch. Available with a screw flange (F), release lever (LH) or lock and release lever (LR). They include space for labelling and can be coded.

Product data

IEC: 320 V / 14.5 A / 0.2 - 1.5 mm²
UL: 300 V / 10 A / AWG 26 - 14

For additional articles and information, refer to catalog.weidmuller.com

Note:

- Additional colours on request
- Gold-plated contact surfaces on request
- Rated current related to rated cross-section and min. No. of poles.
- Max. O.D. of conductor: 2.9 mm
- Wire end ferrule without plastic collar to DIN 46228/1
- Wire end ferrule with plastic collar to DIN 46228/4
- We recommend crimp shape A for wire-end ferrules with crimping tools PZ 1.5 (order no. 9005990000) or PZ 6/5 (order no. 9011460000) for the larger wire cross-sections.
- P on drg. = pitch
- Rated data refer only to the component itself. Clearance and creepage distances to other components are to be designed in accordance with the relevant application standards.

BLZF 3.50/././180



Dimensioned drawing

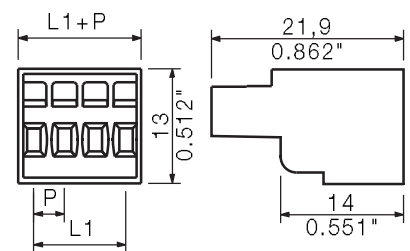

Technical data

In compliance with IEC 60664-1 / IEC 61984

Clamping range, max.	mm ²	0.13...1.5
Solid core H05(07) V-U	mm²	0.2...1.5
Stranded H07 V-R		
Flexible H05(07) V-K	mm ²	0.2...1.5
Flexible with ferrule	mm ²	0.2...1.5
Ferrule with plastic collar	mm ²	0.2...1
Stripping length	mm	10
Screwdriver blade	mm	0.4 x 2.5
According to norm		DIN 5264-A

Tightening torque range Nm

Rated current, max. A **14.5** — **12**

At ambient temperature 20°C — 40°C

For conductor cross-section mm² 1.5

Overvoltage category III III II

Pollution severity 3 2 2

Rated voltage V **160** **160** **320**

Rated impulse voltage kV 2.5 2.5 2.5

UL / CUL (Use Group) **B C D**

Rated voltage V **300** — **300**

Rated current A **10** — **10**

AWG conductor AWG **26-14**

CSA (Use Group) **B C D**

Rated voltage V 300 — 300

Rated current A 10 — 10

AWG conductor AWG 26-14

General data

Type of insulation material	PBT
Flammability class UL 94	V-0
Contact base material	Copper alloy
Material of contact surface	tinned
Pin dimensions = d	mm
Solder eyelet Ø = D	mm
Solder eyelet Ø tolerance	mm

Accessories

Note: Refer to the Accessories chapter for additional accessories.

Coding	Order No.
BL SL 3.5 KO OR	1693430000
BL SL 3.5 KO SW	1610100000
Strain relief	
BL 3.5 ZE 3 OR	1629680000
BL 3.5 ZE 3 SW	1627820000
BL 3.5 ZE 8 OR	1629690000
BL 3.5 ZE 8 SW	1627830000
Screwdriver	
SD 0,4x2,5x75	9009030000
Crimping tool	
PZ 1.5	9005990000
PZ 6/5	9011460000

Ordering data

Solder pin length		orange	black
Pitch	3.50 mm		
Pol.	L1 (inch)	Qty.	Order No. Order No.
2	3.50 0.138	100	1690190000 1690420000
3	7.00 0.276	100	1690200000 1690430000
4	10.50 0.413	100	1690210000 1690440000
5	14.00 0.551	50	1690220000 1690450000
6	17.50 0.689	50	1690230000 1690460000
7	21.00 0.827	50	1690240000 1690470000
8	24.50 0.965	50	1690250000 1690480000
9	28.00 1.102	50	1690260000 1690490000
10	31.50 1.240	50	1690270000 1690500000
11	35.00 1.378	50	1690280000 1690510000
12	38.50 1.516	50	1690290000 1690520000
13	42.00 1.654	50	1690300000 1690530000
14	45.50 1.791	50	1690310000 1690540000
15	49.00 1.929	50	1690320000 1690550000
16	52.50 2.067	50	1690330000 1690560000
17	56.00 2.205	20	1690340000 1690570000
18	59.50 2.343	20	1690350000 1690580000
19	63.00 2.480	20	1690360000 1690590000
20	66.50 2.618	20	1690370000 1690600000
21	70.00 2.756	20	1690380000 1690610000
22	73.50 2.894	20	1690390000 1690620000
23	77.00 3.031	20	1690400000 1690630000
24	80.50 3.169	20	1690410000 1690640000

Representative derating curve

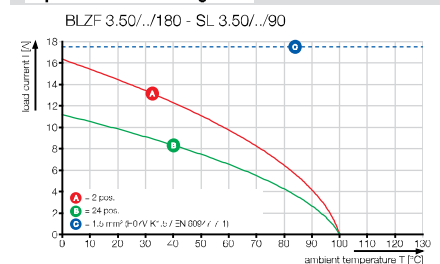

Connectors in 3.50 mm pitch Series BL/SL 3.50

SL-SMT 3.50/..90



High-temperature-resistant, angled, male header for all common soldering methods in 3.5 mm pitch.

- Optimised for SMT processing.
- 3.2 mm older pin suitable for reflow and wave soldering.
- The Male headers provide space for labelling and can be coded.
- Available in closed (G) version and with solder flange (LF).
- Packed either in box (BX) or on tape-on-reel (RL).

Product data

IEC: 320 V / 15 A
UL: 300 V / 10 A

For additional articles and information, refer to catalog.weidmuller.com

Note:

- Additional colours on request
- Gold-plated contact surfaces on request
- Rated current related to rated cross-section and min. No. of poles.
- Diameter of solder eyelet $D = 1.5 \pm 0.1$ mm from 9-pole
- P on drg. = pitch
- Rated data refer only to the component itself. Clearance and creepage distances to other components are to be designed in accordance with the relevant application standards.

SL-SMT 3.50/..90G Box



Dimensioned drawing

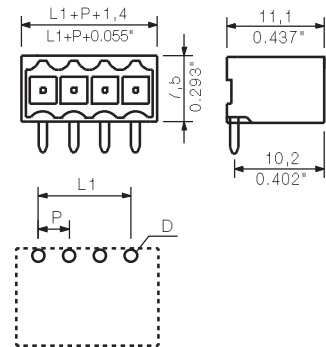

Technical data

In compliance with IEC 60664-1 / IEC 61984

Clamping range, max.	mm ²	
Solid core H05(07) V-U	mm²	
Stranded H07 V-R		
Flexible H05(07) V-K	mm ²	
Flexible with ferrule	mm ²	
Ferrule with plastic collar	mm ²	
Stripping length	mm	
Screwdriver blade	mm	
According to norm		
Tightening torque range	Nm	
Rated current, max.	A	15 13
At ambient temperature		20°C 40°C
For conductor cross-section	mm ²	
Overvoltage category		III III II
Pollution severity		3 2 2
Rated voltage	V	160 160 320
Rated impulse voltage	kV	2.5 2.5 2.5
UL / CUL (Use Group)		B C D
Rated voltage	V	300 300
Rated current	A	10 10
AWG conductor	AWG	-
CSA (Use Group)		B C D
Rated voltage	V	300 300
Rated current	A	10 10
AWG conductor	AWG	-
General data		
Type of insulation material		LCP,GF
Flammability class UL 94		V-0
Contact base material		CuSn
Material of contact surface		tinned
Pin dimensions = d	mm	1.2, Octagonal
Solder eyelet $\varnothing = D$	mm	1.4
Solder eyelet \varnothing tolerance	mm	+ 0,1

Accessories

Note: Refer to the Accessories chapter for additional accessories.

Coding		Order No.
	BL SL 3.5 KO OR	1693430000
	BL SL 3.5 KO SW	1610100000
Interlock		
	BL/SL 3.5 VR OR	1669310000
	BL/SL 3.5 VR SW	1669300000
LED light guide		
	SL 3.5 FLA 1.5/1.75/8	1597630000
	SL 3.5 FLA 1.5/8	1597510000
	SL 3.5 FLA 2.3/1.75/8	1597640000
	SL 3.5 FLA 2.3/8	1597520000
	SL 3.5 FLA 4.0/1.75/8	1597650000
SL 3.5 FLA 4.0/8	1597530000	
Mounting screw		
	PTSC KA 22X4.5	1610740000

Ordering data

Solder pin length	1.5 mm		3.2 mm	
	black		black	
Pitch	3.50 mm			
Pol.	L1 (inch)	Qty.	Order No.	Order No.
2	3.50	0.138	100	1761542001 1841630000
3	7.00	0.276	100	1761552001 1841640000
4	10.50	0.413	100	1761562001 1841650000
5	14.00	0.551	50	1761572001 1841660000
6	17.50	0.689	50	1761582001 1841670000
7	21.00	0.827	50	1761592001 1841680000
8	24.50	0.965	50	1761602001 1841690000
9	28.00	1.102	50	1761612001 1841700000
10	31.50	1.240	50	1761622001 1841710000
11	35.00	1.378	50	1761632001 1841720000
12	38.50	1.516	50	1761642001 1841730000
13	42.00	1.654	50	1761652001 1841740000
14	45.50	1.791	50	1761662001 1841750000
15	49.00	1.929	50	1761672001 1841760000
16	52.50	2.067	50	1761682001 1841770000
17	56.00	2.205	20	1761692001 1841780000
18	59.50	2.343	20	1761702001 1841790000
19	63.00	2.480	20	1761712001 1841800000
20	66.50	2.618	20	1761722001 1841810000
21	70.00	2.756	20	1761732001 1841820000
22	73.50	2.894	20	1761742001 1841830000
23	77.00	3.031	20	1761752001 1841840000
24	80.50	3.169	20	1761762001 1841850000

SL-SMT 3.50/./90G Tape



Dimensioned drawing

SL-SMT 3.50/./90LF Box



Dimensioned drawing

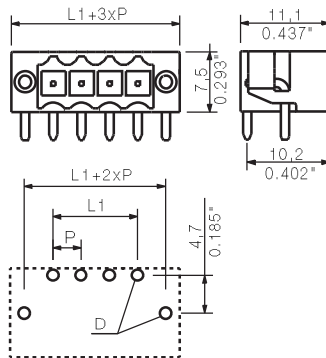

SL-SMT 3.50/./90LF Tape



Dimensioned drawing

Ordering data

Solder pin length		1.5 mm	
Colour		black	
Pitch 3.50 mm			
Pol.	L1	(inch)	Qty. Order No.
2	3.50	0.138	385 1761544002
3	7.00	0.276	385 1761554002
4	10.50	0.413	385 1761564002
5	14.00	0.551	385 1761574002
6	17.50	0.689	385 1761584001
7	21.00	0.827	385 1761594001
8	24.50	0.965	385 1761604001
9	28.00	1.102	385 1761614001
10	31.50	1.240	385 1761624001
11	35.00	1.378	385 1761634001

Ordering data

Solder pin length		1.5 mm		3.2 mm	
Colour		black		black	
Pitch 3.50 mm					
Pol.	L1	(inch)	Qty.	Order No.	Order No.
2	3.50	0.138	100	1804940000	1841860000
3	7.00	0.276	100	1804950000	1841870000
4	10.50	0.413	100	1804960000	1841880000
5	14.00	0.551	50	1804970000	1841890000
6	17.50	0.689	50	1804980000	1841900000
7	21.00	0.827	50	1804990000	1841910000
8	24.50	0.965	50	1805000000	1841920000
9	28.00	1.102	50	1805010000	1841930000
10	31.50	1.240	50	1805020000	1841940000
11	35.00	1.378	50	1805030000	1841950000
12	38.50	1.516	50	1805040000	1804340000
13	42.00	1.654	50	1805050000	1841960000
14	45.50	1.791	50	1805060000	1841970000
15	49.00	1.929	50	1805070000	1841980000
16	52.50	2.067	50	1805080000	1841990000
17	56.00	2.205	20	1805090000	1842000000
18	59.50	2.343	20	1805100000	1842010000
19	63.00	2.480	20	1805110000	1842020000
20	66.50	2.618	20	1805120000	1842030000
21	70.00	2.756	20	1805130000	1842040000
22	73.50	2.894	20	1805140000	1842050000
23	77.00	3.031	20	1805150000	1842060000
24	80.50	3.169	20	1805160000	1842070000

Ordering data

Solder pin length		1.5 mm	
Colour		black	
Pitch 3.50 mm			
Pol.	L1	(inch)	Qty. Order No.
2	3.50	0.138	385 1805310000
3	7.00	0.276	385 1805320000
4	10.50	0.413	385 1805330000
5	14.00	0.551	385 1805340000
6	17.50	0.689	385 1805350000
7	21.00	0.827	385 1805360000
8	24.50	0.965	385 1805370000
9	28.00	1.102	385 1805380000
10	31.50	1.240	385 1005180000

Tape widths: 32, 44, 56, 72, 88

Tape widths: 32, 44, 56, 72, 88

Connectors in 3.50 mm pitch Series BL/SL 3.50

SL-SMT 3.50/.. / F & RF



High-temperature-resistant, straight and angled, male header for all common soldering methods in 3.5 mm pitch.

- Optimised for the SMT processing.
- 3.2 mm solder pin suitable for reflow and wave soldering.
- Available in screw flange (F) and with solder flange for lock and release lever (RF).

Product data

IEC: 320 V / 15 A
UL: 300 V / 10 A

For additional articles and information, refer to catalog.weidmuller.com

Note:

- Additional colours on request
- Gold-plated contact surfaces on request
- Rated current related to rated cross-section and min. No. of poles.
- Diameter of solder eyelet $D = 1.5 \pm 0.1$ mm from 9-pole
- P on drg. = pitch
- Rated data refer only to the component itself. Clearance and creepage distances to other components are to be designed in accordance with the relevant application standards.

SL-SMT 3.50/.. /90F Box



Dimensioned drawing

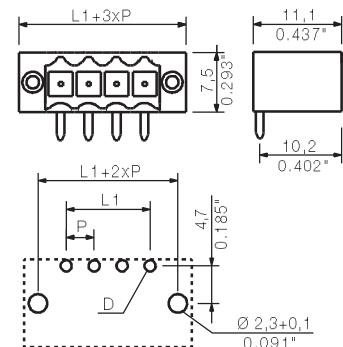

Technical data

In compliance with IEC 60664-1 / IEC 61984

Clamping range, max.	mm ²	
Solid core H05(07) V-U	mm²	
Stranded H07 V-R		
Flexible H05(07) V-K	mm ²	
Flexible with ferrule	mm ²	
Ferrule with plastic collar	mm ²	
Stripping length	mm	
Screwdriver blade	mm	
According to norm		
Tightening torque range	Nm	
Rated current, max.	A	15 — 13
At ambient temperature		20°C — 40°C
For conductor cross-section	mm ²	
Overvoltage category		III III II
Pollution severity		3 2 2
Rated voltage	V	160 160 320
Rated impulse voltage	kV	2.5 2.5 2.5
UL / CUL (Use Group)		B C D
Rated voltage	V	300 — 300
Rated current	A	10 — 10
AWG conductor	AWG	—
CSA (Use Group)		B C D
Rated voltage	V	300 — 300
Rated current	A	10 — 10
AWG conductor	AWG	—
General data		
Type of insulation material		LCP, GF
Flammability class UL 94		V-0
Contact base material		CuSn
Material of contact surface		tinned
Pin dimensions = d	mm	1.2, Octagonal
Solder eyelet $\varnothing = D$	mm	1.4
Solder eyelet \varnothing tolerance	mm	+0.1

Accessories

Note: Refer to the Accessories chapter for additional accessories.

Coding		Order No.
	BL SL 3.5 KO OR	1693430000
	BL SL 3.5 KO SW	1610100000
Interlock		
	BL/SL 3.5 VR OR	1669310000
	BL/SL 3.5 VR SW	1669300000
LED light guide		
	SL 3.5 FLA 1.5/1.75/8	1597630000
	SL 3.5 FLA 1.5/8	1597510000
	SL 3.5 FLA 2.3/1.75/8	1597640000
	SL 3.5 FLA 2.3/8	1597520000
	SL 3.5 FLA 4.0/1.75/8	1597650000
	SL 3.5 FLA 4.0/8	1597530000

Ordering data

Solder pin length		3.2 mm		
Colour		black		
Pitch	3.50 mm			
Pol.	L1	(inch)	Qty.	Order No.
2	3.50	0.138	100	1842080000
3	7.00	0.276	100	1842090000
4	10.50	0.413	100	1842100000
5	14.00	0.551	50	1842110000
6	17.50	0.689	50	1842120000
7	21.00	0.827	50	1842130000
8	24.50	0.965	50	1842140000
9	28.00	1.102	50	1842150000
10	31.50	1.240	50	1842160000
11	35.00	1.378	50	1842170000
12	38.50	1.516	50	1842180000
13	42.00	1.654	50	1842190000
14	45.50	1.791	50	1842200000
15	49.00	1.929	50	1842210000
16	52.50	2.067	50	1842220000
17	56.00	2.205	20	1842230000
18	59.50	2.343	20	1842240000
19	63.00	2.480	20	1842250000
20	66.50	2.618	20	1842260000
21	70.00	2.756	20	1842270000
22	73.50	2.894	20	1842280000
23	77.00	3.031	20	1842290000
24	80.50	3.169	20	1842300000

SL-SMT 3.50/./90RF Box



Dimensioned drawing

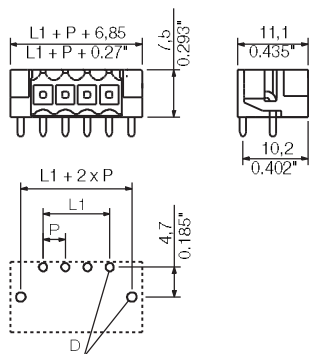

Ordering data

Solder pin length		1.5 mm	
Colour		black	
Pitch		3.50 mm	
Pol.	L1	(inch)	Qty. Order No.
3	7.00	0.276	100 1060810000
4	10.50	0.413	100 1000600000
5	14.00	0.551	50 1000610000
6	17.50	0.689	50 1000620000
7	21.00	0.827	50 1000630000
8	24.50	0.965	50 1000640000
9	28.00	1.102	50 1000650000
10	31.50	1.138	50 1060780000
11	35.00	1.378	50 1000660000
12	38.50	1.516	50 1000670000
13	42.00	1.654	50 1000680000
14	45.50	1.791	50 1000690000
15	49.00	1.929	50 1000700000
16	52.50	2.067	50 1060820000

SL-SMT 3.50/./180F Box



Dimensioned drawing

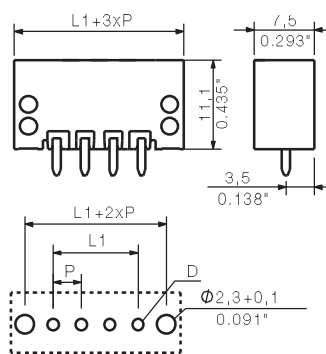

Ordering data

Solder pin length		3.2 mm	
Colour		black	
Pitch		3.50 mm	
Pol.	L1	(inch)	Qty. Order No.
2	3.50	0.138	100 1842770000
3	7.00	0.276	100 1842780000
4	10.50	0.413	100 1842790000
5	14.00	0.551	50 1842800000
6	17.50	0.689	50 1842810000
7	21.00	0.827	50 1842820000
8	24.50	0.965	50 1842830000
9	28.00	1.102	50 1842840000
10	31.50	1.240	50 1842850000
11	35.00	1.378	50 1842860000
12	38.50	1.516	50 1842870000
13	42.00	1.654	50 1842880000
14	45.50	1.791	50 1842890000
15	49.00	1.929	50 1842900000
16	52.50	2.067	50 1842910000
17	56.00	2.205	20 1842920000
18	59.50	2.343	20 1842930000
19	63.00	2.480	20 1842940000
20	66.50	2.618	20 1842950000
21	70.00	2.756	20 1842960000
22	73.50	2.894	20 1842970000
23	77.00	3.031	20 1842980000
24	80.50	3.169	20 1842990000

SL-SMT 3.50/./180F Tape



Dimensioned drawing

Ordering data

Solder pin length		1.5 mm	
Colour		black	
Pitch		3.50 mm	
Pol.	L1	(inch)	Qty. Order No.
2	3.50	0.138	100 1760962001
3	7.00	0.276	100 1760972001
4	10.50	0.413	100 1760982001
5	14.00	0.551	50 1760992001
6	17.50	0.689	50 1761002001
8	24.50	0.965	50 1761022001
10	31.50	1.240	50 1761042001
14	45.50	1.791	50 1761082001
18	59.50	2.343	20 1761122001
20	66.50	2.618	20 1761142001

Tape widths: 32, 44, 56, 72, 88

Connectors in 3.50 mm pitch

Series BL/SL 3.50

SL-SMT 3.50/././180

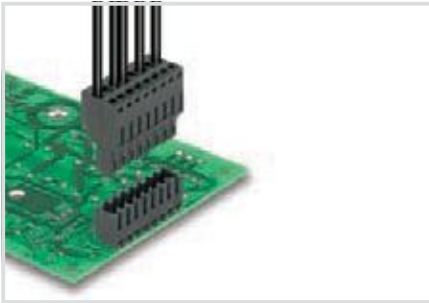

High-temperature-resistant, straight male header in 3.50 mm pitch for all conventional soldering methods.

- Optimised for the SMT processing.
- 3.2 mm solder pin suitable for reflow and wave soldering.
- Available in screw flange (F) and with solder flange (LF).
- Packed either in box (BX) or on tape-on-reel (RL).

Product data

IEC: 320 V / 15 A
UL: 300 V / 10 A

For additional articles and information, refer to catalog.weidmuller.com

Note:

- Additional colours on request
- Gold-plated contact surfaces on request
- Rated current related to rated cross-section and min. No. of poles.
- Diameter of solder eyelet $D = 1.5 \pm 0.1$ mm from 9-pole
- P on drg. = pitch
- Rated data refer only to the component itself. Clearance and creepage distances to other components are to be designed in accordance with the relevant application standards.

SL-SMT 3.50/././180G Box



Dimensioned drawing

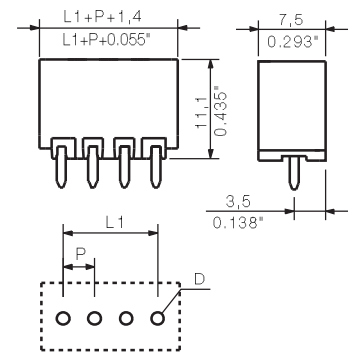

Technical data

In compliance with IEC 60664-1 / IEC 61984

Clamping range, max.	mm ²	
Solid core H05(07) V-U	mm²	
Stranded H07 V-R		
Flexible H05(07) V-K	mm ²	
Flexible with ferrule	mm ²	
Ferrule with plastic collar	mm ²	
Stripping length	mm	
Screwdriver blade	mm	

According to norm

Tightening torque range	Nm	
Rated current, max.	A	15 — 13

At ambient temperature 20°C — 40°C

For conductor cross-section	mm ²	
-----------------------------	-----------------	--

Overvoltage category	III	III	II
----------------------	-----	-----	----

Pollution severity	3	2	2
--------------------	---	---	---

Rated voltage	V	160	160	320
----------------------	----------	------------	------------	------------

Rated impulse voltage	kV	2.5	2.5	2.5
-----------------------	----	-----	-----	-----

UL / CUL (Use Group)	B	C	D
-----------------------------	----------	----------	----------

Rated voltage	V	300	300
----------------------	----------	------------	------------

Rated current	A	10	10
----------------------	----------	-----------	-----------

AWG conductor	AWG	-
----------------------	------------	---

CSA (Use Group)	B	C	D
------------------------	----------	----------	----------

Rated voltage	V	300	300
---------------	---	-----	-----

Rated current	A	10	10
---------------	---	----	----



AWG conductor	AWG	-
---------------	-----	---

General data

Type of insulation material	LCP,GF
Flammability class UL 94	V-0
Contact base material	CuSn
Material of contact surface	tinned
Pin dimensions = d	mm 1.2, Octagonal
Solder eyelet $\varnothing = D$	mm 1.4
Solder eyelet \varnothing tolerance	mm +0,1

Accessories

Note: Refer to the Accessories chapter for additional accessories.

Coding		Order No.
	BL SL 3.5 KO OR	1693430000
	BL SL 3.5 KO SW	1610100000
Interlock		
	BL/SL 3.5 VR OR	1669310000
	BL/SL 3.5 VR SW	1669300000

Ordering data

Solder pin length	1.5 mm	3.2 mm			
Colour	black	black			
Pitch	3.50 mm				
Pol.	L1 (inch)	Qty.	Order No.	Order No.	
2	3.50	0.138	100	1752982001	1842320000
3	7.00	0.276	100	1752992001	1842330000
4	10.50	0.413	100	1753002001	1842340000
5	14.00	0.551	50	1753012001	1842350000
6	17.50	0.689	50	1753022001	1842360000
7	21.00	0.827	50	1753032001	1842370000
8	24.50	0.965	50	1753042001	1842380000
9	28.00	1.102	50	1753052001	1842390000
10	31.50	1.240	50	1753062001	1836990000
11	35.00	1.378	50	1753072001	1842400000
12	38.50	1.516	50	1753082001	1842410000
13	42.00	1.654	50	1753092001	1842420000
14	45.50	1.791	50	1753102001	1842430000
15	49.00	1.929	50	1753112001	1842440000
16	52.50	2.067	50	1753122001	1842450000
17	56.00	2.205	20	1753132001	1842460000
18	59.50	2.343	20	1753142001	1842470000
19	63.00	2.480	20	1753152001	1842480000
20	66.50	2.618	20	1753162001	1842490000
21	70.00	2.756	20	1753172001	1842500000
22	73.50	2.894	20	1753182001	1842510000
23	77.00	3.031	20	1753192001	1842520000
24	80.50	3.169	20	1753202001	1842530000

SL-SMT 3.50/./180G Tape



Dimensioned drawing

SL-SMT 3.50/./180LF Box



Dimensioned drawing

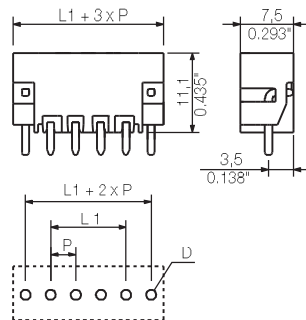

SL-SMT 3.50/./180LF Tape



Dimensioned drawing

Ordering data

Solder pin length		1.5 mm		
Colour		black		
Pitch 3.50 mm				
Pol.	L1	(inch)	Qty.	Order No.
2	3.50	0.138	265	1752984002
3	7.00	0.276	265	1752994002
4	10.50	0.413	265	1753004002
5	14.00	0.551	265	1753014002
6	17.50	0.689	265	1753024001
7	21.00	0.827	265	1753034001
8	24.50	0.965	265	1753044001
9	28.00	1.102	265	1753054001
10	31.50	1.240	265	1753064001
11	35.00	1.378	265	1753074001

Tape widths: 32, 44, 56, 72, 88

Ordering data

Solder pin length		1.5 mm		3.2 mm	
Colour		black		black	
Pitch 3.50 mm					
Pol.	L1	(inch)	Qty.	Order No.	Order No.
2	3.50	0.138	100	1804700000	1842540000
3	7.00	0.276	100	1804710000	1842550000
4	10.50	0.413	100	1804720000	1842560000
5	14.00	0.551	50	1804730000	1842570000
6	17.50	0.689	50	1804740000	1842580000
7	21.00	0.827	50	1804750000	1842590000
8	24.50	0.965	50	1804760000	1842600000
9	28.00	1.102	50	1804770000	1842610000
10	31.50	1.240	50	1804780000	1842620000
11	35.00	1.378	50	1804790000	1842630000
12	38.50	1.516	50	1804800000	1842640000
13	42.00	1.654	50	1804810000	1842650000
14	45.50	1.791	50	1804820000	1842660000
15	49.00	1.929	50	1804830000	1842670000
16	52.50	2.067	50	1804840000	1842680000
17	56.00	2.205	20	1804850000	1842690000
18	59.50	2.343	20	1804860000	1842700000
19	63.00	2.480	20	1804870000	1842710000
20	66.50	2.618	20	1804880000	1842720000
21	70.00	2.756	20	1804900000	1842730000
22	73.50	2.894	20	1804910000	1842740000
23	77.00	3.031	20	1804920000	1842750000
24	80.50	3.169	20	1804930000	1842760000

Ordering data

Solder pin length		1.5 mm		
Colour		black		
Pitch 3.50 mm				
Pol.	L1	(inch)	Qty.	Order No.
2	3.50	0.138	265	1805210000
3	7.00	0.276	265	1805230000
4	10.50	0.413	265	1805240000
5	14.00	0.551	265	1805250000
6	17.50	0.689	265	1805270000
7	21.00	0.827	265	1805280000
8	24.50	0.965	265	1805290000
9	28.00	1.102	265	1805300000

Tape widths: 32, 44, 56, 72, 88

Connectors in 3.50 mm pitch Series BL/SL 3.50

SL 3.50/.. /90

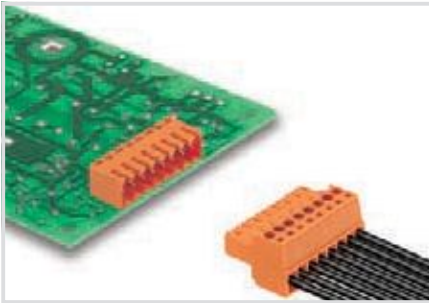

Angled male header (90° orientation) for wave soldering in 3.5 mm pitch. The male header is available in open, closed (G) and flange (F) versions. Packed in cardboard box.

Product data

IEC: 320 V / 17 A
UL: 300 V / 10 A

For additional articles and information, refer to catalog.weidmuller.com

Note:

- Additional colours on request
- Gold-plated contact surfaces on request
- Rated current related to rated cross-section and min. No. of poles.
- P on drg. = pitch
- Rated data refer only to the component itself. Clearance and creepage distances to other components are to be designed in accordance with the relevant application standards.

SL 3.50/.. /90

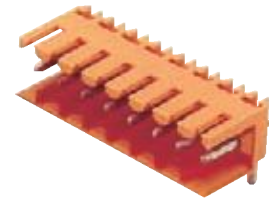

Dimensioned drawing

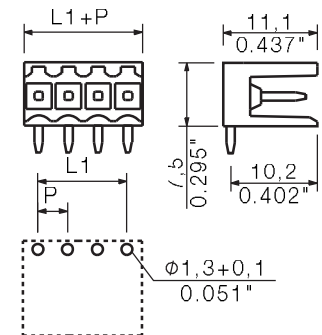

C

Technical data

In compliance with IEC 60664-1 / IEC 61984

Clamping range, max.	mm ²	
Solid core H05(07) V-U	mm²	
Stranded H07 V-R		
Flexible H05(07) V-K	mm ²	
Flexible with ferrule	mm ²	
Ferrule with plastic collar	mm ²	
Stripping length	mm	
Screwdriver blade	mm	
According to norm		
Tightening torque range	Nm	
Rated current, max.	A	17 14.5
At ambient temperature		20°C 40°C
For conductor cross-section	mm ²	
Overvoltage category		III III II
Pollution severity		3 2 2
Rated voltage	V	160 160 320
Rated impulse voltage	kV	2.5 2.5 2.5
UL / CUL (Use Group)		B C D
Rated voltage	V	300 300
Rated current	A	10 10
AWG conductor	AWG	-
CSA (Use Group)		B C D
Rated voltage	V	300 300
Rated current	A	10 10
AWG conductor	AWG	-
General data		
Type of insulation material		PBT
Flammability class UL 94		V-0
Contact base material		CuSn
Material of contact surface		tinned
Pin dimensions = d	mm	1.2, Octagonal
Solder eyelet Ø = D	mm	1.3
Solder eyelet Ø tolerance	mm	+0.1

Accessories

Note: Refer to the Accessories chapter for additional accessories.

Coding		Order No.
	BL SL 3.5 KO OR	1693430000
	BL SL 3.5 KO SW	1610100000
Interlock		
	BL/SL 3.5 VR OR	1669310000
	BL/SL 3.5 VR SW	1669300000
LED light guide		
	SL 3.5 FLA 1.5/1.75/8	1597630000
	SL 3.5 FLA 1.5/8	1597510000
	SL 3.5 FLA 2.3/1.75/8	1597640000
	SL 3.5 FLA 2.3/8	1597520000
	SL 3.5 FLA 4.0/1.75/8	1597650000
	SL 3.5 FLA 4.0/8	1597530000
Mounting screw		
	PTSC KA 22X4.5	1610740000

Ordering data

Solder pin length		3.2 mm		
Colour		orange		
Pitch	3.50 mm			
Pol.	L1	(inch)	Qty.	Order No.
2	3.50	0.138	100	1597210000
3	7.00	0.276	100	1597220000
4	10.50	0.413	100	1597230000
5	14.00	0.551	50	1597240000
6	17.50	0.689	50	1597250000
7	21.00	0.827	50	1597260000
8	24.50	0.965	50	1597270000
9	28.00	1.102	50	1597280000
10	31.50	1.240	50	1597290000
11	35.00	1.378	50	1597300000
12	38.50	1.516	50	1597310000
13	42.00	1.654	50	1597320000
14	45.50	1.791	50	1597330000
15	49.00	1.929	50	1597340000
16	52.50	2.067	50	1597350000
17	56.00	2.205	20	1618990000
18	59.50	2.343	20	1619000000
19	63.00	2.480	20	1619010000
20	66.50	2.618	20	1619020000
21	70.00	2.756	20	1619030000
22	73.50	2.894	20	1619040000
23	77.00	3.031	20	1619050000
24	80.50	3.169	20	1619060000

SL 3.50/./90G

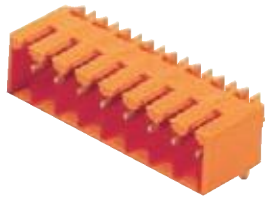

SL 3.50/./90F

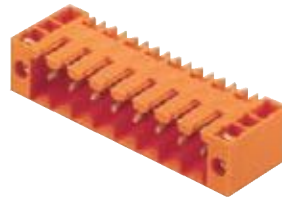

Dimensioned drawing

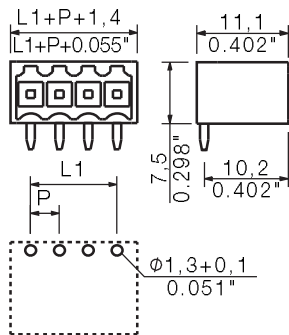

Dimensioned drawing

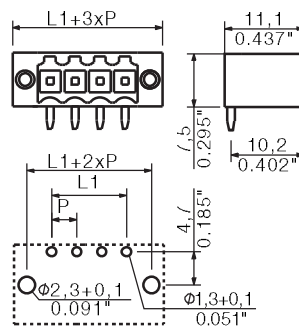

Ordering data

Solder pin length		3.2 mm	
Colour		orange	
Pitch 3.50 mm			
Pol.	L1	(inch)	Qty. Order No.
2	3.50	0.138	100 1605070000
3	7.00	0.276	100 1605080000
4	10.50	0.413	100 1605090000
5	14.00	0.551	50 1605100000
6	17.50	0.689	50 1605110000
7	21.00	0.827	50 1605120000
8	24.50	0.965	50 1605130000
9	28.00	1.102	50 1605140000
10	31.50	1.240	50 1605150000
11	35.00	1.378	50 1605160000
12	38.50	1.516	50 1605170000
13	42.00	1.654	50 1605180000
14	45.50	1.791	50 1605190000
15	49.00	1.929	50 1605200000
16	52.50	2.067	50 1605210000
17	56.00	2.205	20 1619380000
18	59.50	2.343	20 1619390000
19	63.00	2.480	20 1619400000
20	66.50	2.618	20 1619410000
21	70.00	2.756	20 1619420000
22	73.50	2.894	20 1619430000
23	77.00	3.031	20 1619440000
24	80.50	3.169	20 1619450000

Ordering data

Solder pin length		3.2 mm	
Colour		orange	
Pitch 3.50 mm			
Pol.	L1	(inch)	Qty. Order No.
2	3.50	0.138	100 1607040000
3	7.00	0.276	100 1607050000
4	10.50	0.413	100 1607060000
5	14.00	0.551	50 1607070000
6	17.50	0.689	50 1607080000
7	21.00	0.827	50 1607090000
8	24.50	0.965	50 1607100000
9	28.00	1.102	50 1607110000
10	31.50	1.240	50 1607120000
11	35.00	1.378	50 1607130000
12	38.50	1.516	50 1607140000
13	42.00	1.654	50 1607150000
14	45.50	1.791	50 1607160000
15	49.00	1.929	50 1607170000
16	52.50	2.067	50 1607180000
17	56.00	2.205	20 1619770000
18	59.50	2.343	20 1619780000
19	63.00	2.480	20 1619790000
20	66.50	2.618	20 1619800000
21	70.00	2.756	20 1619810000
22	73.50	2.894	20 1619820000
23	77.00	3.031	20 1619830000
24	80.50	3.169	20 1619840000

Connectors in 3.50 mm pitch

Series BL/SL 3.50

SL 3.50/././180

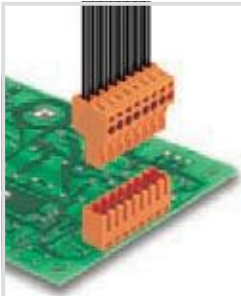

Straight male header (180° orientation) for wave soldering in 3.5 mm pitch. The male header is available in open, closed (G) and flange (F) versions. Packed in cardboard box.

Product data

IEC: 320 V / 17 A
UL: 300 V / 10 A

For additional articles and information, refer to catalog.weidmuller.com

Note:

- Additional colours on request
- Gold-plated contact surfaces on request
- Rated current related to rated cross-section and min. No. of poles.
- P on drg. = pitch
- Rated data refer only to the component itself. Clearance and creepage distances to other components are to be designed in accordance with the relevant application standards.

SL 3.50/././180

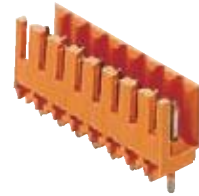

Dimensioned drawing

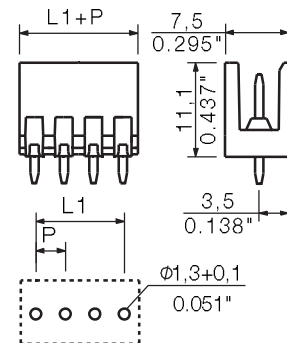





Technical data

In compliance with IEC 60664-1 / IEC 61984

Clamping range, max.	mm ²	
Solid core H05(07) V-U	mm²	
Stranded H07 V-R		
Flexible H05(07) V-K	mm ²	
Flexible with ferrule	mm ²	
Ferrule with plastic collar	mm ²	
Stripping length	mm	
Screwdriver blade	mm	
According to norm		
Tightening torque range	Nm	
Rated current, max.	A	17 14.5
At ambient temperature		20°C 40°C
For conductor cross-section	mm ²	
Overvoltage category		III III II
Pollution severity		3 2 2
Rated voltage	V	160 160 320
Rated impulse voltage	kV	2.5 2.5 2.5
UL / CUL (Use Group)	B C D	
Rated voltage	V	300 300
Rated current	A	10 10
AWG conductor	AWG	-
CSA (Use Group)	B C D	
Rated voltage	V	300 300
Rated current	A	10 10
AWG conductor	AWG	-
General data		
Type of insulation material		PBT
Flammability class UL 94		V-0
Contact base material		CuSn
Material of contact surface		tinned
Pin dimensions = d	mm	1.2, Octagonal
Solder eyelet $\phi = D$	mm	1.3
Solder eyelet ϕ tolerance	mm	+0.1

Accessories

Note: Refer to the Accessories chapter for additional accessories.

Coding	Order No.
 BL SL 3.5 KO OR	1693430000
 BL SL 3.5 KO SW	1610100000
Interlock	
 BL/SL 3.5 VR OR	1669310000
 BL/SL 3.5 VR SW	1669300000
Mounting screw	
 PTSC KA 22X4.5	1610740000

Ordering data

Solder pin length	3.2 mm			
Colour	orange			
Pitch	3.50 mm			
Pol.	L1	(inch)	Qty.	Order No.
2	3.50	0.138	100	1604770000
3	7.00	0.276	100	1604780000
4	10.50	0.413	100	1604790000
5	14.00	0.551	50	1604800000
6	17.50	0.689	50	1604810000
7	21.00	0.827	50	1604820000
8	24.50	0.965	50	1604830000
9	28.00	1.102	50	1604840000
10	31.50	1.240	50	1604850000
11	35.00	1.378	50	1604860000
12	38.50	1.516	50	1604870000
13	42.00	1.654	50	1604880000
14	45.50	1.791	50	1604890000
15	49.00	1.929	50	1604900000
16	52.50	2.067	50	1604910000
17	56.00	2.205	20	1621400000
18	59.50	2.343	20	1621410000
19	63.00	2.480	20	1621420000
20	66.50	2.618	20	1621430000
21	70.00	2.756	20	1621440000
22	73.50	2.894	20	1621450000
23	77.00	3.031	20	1621460000
24	80.50	3.169	20	1621470000

SL 3.50/././180G

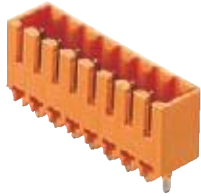

Dimensioned drawing

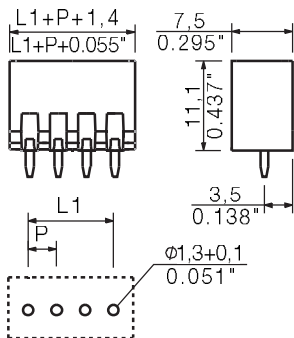

SL 3.50/././180F

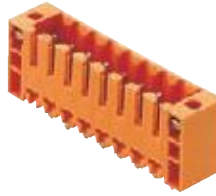

Dimensioned drawing

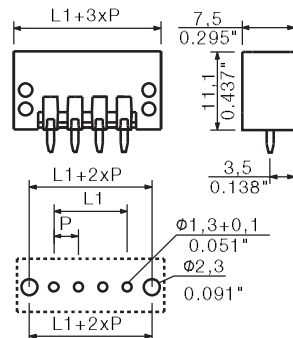

Ordering data

Solder pin length		3.2 mm	
Colour		orange	
Pitch 3.50 mm			
Pol.	L1	(inch)	Qty. Order No.
2	3.50	0.138	100 1604470000
3	7.00	0.276	100 1604480000
4	10.50	0.413	100 1604490000
5	14.00	0.551	50 1604500000
6	17.50	0.689	50 1604510000
7	21.00	0.827	50 1604520000
8	24.50	0.965	50 1604530000
9	28.00	1.102	50 1604540000
10	31.50	1.240	50 1604550000
11	35.00	1.378	50 1604560000
12	38.50	1.516	50 1604570000
13	42.00	1.654	50 1604580000
14	45.50	1.791	50 1604590000
15	49.00	1.929	50 1604600000
16	52.50	2.067	50 1604610000
17	56.00	2.205	20 1621790000
18	59.50	2.343	20 1621800000
19	63.00	2.480	20 1621810000
20	66.50	2.618	20 1621820000
21	70.00	2.756	20 1621830000
22	73.50	2.894	20 1621840000
23	77.00	3.031	20 1621850000
24	80.50	3.169	20 1621860000

Ordering data

Solder pin length		3.2 mm	
Colour		orange	
Pitch 3.50 mm			
Pol.	L1	(inch)	Qty. Order No.
2	3.50	0.138	100 1607500000
3	7.00	0.276	100 1607510000
4	10.50	0.413	100 1607520000
5	14.00	0.551	50 1607530000
6	17.50	0.689	50 1607540000
7	21.00	0.827	50 1607550000
8	24.50	0.965	50 1607560000
9	28.00	1.102	50 1607570000
10	31.50	1.240	50 1607580000
11	35.00	1.378	50 1607590000
12	38.50	1.516	50 1607600000
13	42.00	1.654	50 1607610000
14	45.50	1.791	50 1607620000
15	49.00	1.929	50 1607630000
16	52.50	2.067	50 1607640000
17	56.00	2.205	20 1622180000
18	59.50	2.343	20 1622190000
19	63.00	2.480	20 1622200000
20	66.50	2.618	20 1622210000
21	70.00	2.756	20 1622220000
22	73.50	2.894	20 1622230000
23	77.00	3.031	20 1622240000
24	80.50	3.169	20 1622250000



X-ON Electronics

Largest Supplier of Electrical and Electronic Components

Click to view similar products for [weidmuller](#) manufacturer:

Other Similar products are found below :

[56956](#) [0133660000](#) [68676](#) [69718](#) [EXO24CH](#) [7940000218](#) [8005181001](#) [8008180000](#) [8432240000](#) [8463580000](#) [8545830000](#) [8689870000](#)
[8705640000](#) [9001080000](#) [9003720000](#) [9004250000](#) [9004780000](#) [9013260000](#) [9014100000](#) [9019040000](#) [9026010000](#) [9028630000](#) [903708](#)
[9037350000](#) [9046290000](#) [9129643500](#) [913155](#) [919656](#) [919764](#) [9202230000](#) [9202850000](#) [9204260000](#) [9456750000](#) [9457913000](#) [980811](#)
[980826](#) [9912800003](#) [9916080000](#) [9916280012](#) [9918380000](#) [9919371224](#) [9925710000](#) [9926252005](#) [9927480024](#) [1166660000](#) [11751](#)
[1222550000](#) [ACT20X-2HDI-2SDO-RNC-S](#) [ACT20X-HUI-SAO-S](#) [ACT20X-SAI-HAO-S](#)