

### Front horizontal rail (A)

To accommodate guide rails and for the attachment of front panels.

- Front projection 2.5 mm in accordance with IEC 60 297-3.
- HP pitch patterns of holes for the precise installation of guide rails
- M4 thread on end face
- Straight-through core hole
- Horizontal rail 192 HP without machining on the end faces. Suitable for cutting to length

#### Material:

Extruded aluminium section

#### Surface finish:

Clear-chromated or anodised

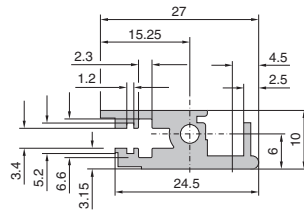

Usable width (HP)	Packs of	Model No. RP
4 (left)	1	3684.592
4 (right)	1	3684.955
8 (left)	1	3684.593
8 (right)	1	3684.956
12	1	3684.594
16	1	3684.595
20	1	3684.596
21	1	3685.985
40	1	3684.960
42	1	3684.560
63	1	3684.561
84	1	3684.562
84	2	3685.267 <sup>1)</sup>
192	1	3688.000 <sup>2)</sup>

<sup>1)</sup> Including 4 assembly screws

<sup>2)</sup> Anodised



#### Also required:

Assembly screws M4 x 12, packs of 100, Model No. RP 3654.300, see page 576.



#### Accessories:

Threaded inserts, see page 504.

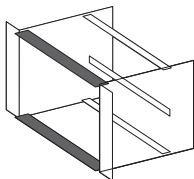

### Front horizontal rail, with 10 mm extension (B)

for type IV, IVs and VII injector/extractor handle  
To accommodate guide rails and for the attachment of front panels.

- Front projection and pitch pattern of holes based on IEEE 1101.10 and IEC 60 297-5-101, for use of type IV and VII injector/extractor handles
- HP pitch patterns of holes for the precise installation of guide rails
- M4 thread on end face
- Straight-through core hole
- Horizontal rail 192 HP without machining on the end faces. Suitable for cutting to length

#### Material:

Extruded aluminium section

#### Surface finish:

Clear-chromated or anodised

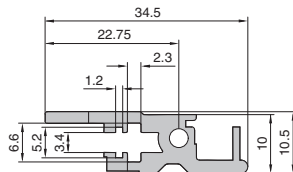

Usable width (HP)	Packs of	Model No. RP
40	1	3684.961
42	1	3684.565
63	1	3684.566
84	1	3684.567
84	2	3685.269 <sup>1)</sup>
192	1	3688.001 <sup>2)</sup>

<sup>1)</sup> Including 4 assembly screws

<sup>2)</sup> Anodised



#### Also required:

Assembly screws M4 x 12, packs of 100, Model No. RP 3654.300, see page 576.



#### Accessories:

Threaded inserts, see page 504.

## **X-ON Electronics**

Largest Supplier of Electrical and Electronic Components

*Click to view similar products for [rittal](#) manufacturer:*

Other Similar products are found below :

[3688117](#) [EB1554](#) [KS1434](#) [KS1483](#) [1002.600](#) [1004.600](#) [1037.500](#) [1077.500](#) [1302.600](#) [1578.450](#) [1578.530](#) [1579.450](#) [9516.000](#) [9521.050](#)  
[9522.000](#) [1522.010](#) [1523.010](#) [1524.010](#) [1525.010](#) [1526.010](#) [1527.010](#) [1529.010](#) [1530.010](#) [1530.510](#) [1536.510](#) [1538.510](#) [1541.510](#)  
[1542.510](#) [1547.500](#) [2383250](#) [2383300](#) [2383350](#) [2384010](#) [2384020](#) [9101.210](#) [9108.210](#) [9111.210](#) [9112.210](#) [9113.210](#) [9113700](#) [9114.210](#)  
[9116.210](#) [9117.210](#) [9118.210](#) [9119.210](#) [9516.100](#) [9518.000](#) [9519.000](#) [9519.100](#) [9520.100](#)