

Plug-in unit in kit form for CompacPCI and VME64x applications

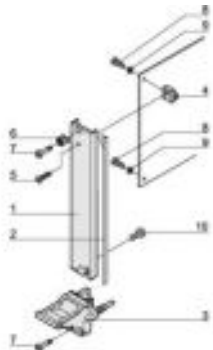

Dimension 3 / 6 U

Part no.: 20848-590

Features:

- Meets IEEE 1101.10 and IEC 60297-3-102 standards
- Codable to IEC 60297-3-103
- Front panel shielded, without offset
- Suitable for insertion and extraction forces up to 700 N (per pair)
- Designed for fitting of microswitches

Add to basket



Technical information:

Description	Height	Width
Front assembly	3 U	10 HP

Downloads:

- User manual, plug-in unit IEEE ([Log in](#) Required)
- User Manual ([Log in](#) Required)
- User manual, coding IEEE ([Log in](#) Required)

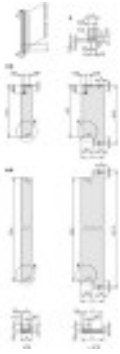

Product illustrations are exemplary illustrations and can deviate from supplied products.

To gain access to the additional information you must [Log in](#).
If you do not yet have a user name, you may [Register here](#).

Delivery comprises: kit

Item	Qty	Description
1	1	U front panel, Al, front anodised, rear conductive
2	1	EMC textile gasketing, core: foam, sleeve: textile cladding, CuNi coating
3	1	Handle with integrated alignment pin for perforated strip and guide rails, lever: plastic, PC, black, RAL 9005 key: plastic, PC, light grey, RAL 7035
4	1	Board support, die-cast zinc
5	1	Raised Pozidrive countersunk screw M2.5 × 8, St, nickel-plated
6	3	Sleeve, PA, grey
7	4	Pozidrive collar screw M2.5 × 12.3, St, nickel-plated
8	2	Panhead screw with Torx, M2.5 × 6, St, zinc-plated, self-locking
9	2	Washer A2.7, DIN 125, St, nickel-plated
10	1	Panhead screw with Torx, M2.5 × 6, St, nickel-plated

Accessories:

Part no.	Description	
20817-606	Microswitch for handles, CompactPCI/VME64x application Qty: 10 pieces	Add to basket

X-ON Electronics

Largest Supplier of Electrical and Electronic Components

Click to view similar products for [schroff](#) manufacturer:

Other Similar products are found below :

[24566-125](#) [14575271](#) [14576145](#) [14575265](#) [20117-156](#) [20817772](#) [20827088](#) [20846211](#) [20860229](#) [21100777](#) [23130082](#) [24571331](#) [24571586](#)
[24572066](#) [26230-374](#) [30825080](#) [20849021](#) [20860240](#) [23001021](#) [24560080](#) [24571303](#) [24572054](#) [24572056](#) [30219-113](#) [20848-410](#) [20838-125](#) [20860-605](#) [10225-602](#) [10225-623](#) [10828058](#) [13100103](#) [13100123](#) [28230-439-C](#) [24563-457](#) [24563-444](#) [20848-601](#) [21101-853](#) [24563-133](#) [24563-134](#) [24564-431](#) [24827-107](#) [24563-142](#) [24563-157](#) [24563-442](#) [A265HC-5.80EH](#) [24561-331](#) [10225640](#) [10225696](#) [16230005](#)
[16230007](#)