



Ripac box type plug-in units, type I

Technical specifications:

Installation depth: 160 and 220 mm
 Height: 3 U and 6 U
 to IEC 60 297-3,
 to accommodate:
 individual connectors

Material:

Front panel: 2.5 mm aluminium,
 natural anodised
 Rear panel: 2 mm aluminium, natural anodised
 Side panel sections: Extruded aluminium section,
 natural anodised
 Handle: Aluminium, natural anodised.
 PCB holder: Plastic

Available upon request:

- Box type plug-in units in special sizes or with printing
- EMC box type plug-in units with EMC front panels



Accessories:

Covers,
 see page 545.
 Guide rails,
 see page 512.
 Individual components,
 see page 542.

HP	a mm	B mm	b mm	c mm	C mm	d mm	e mm	f mm	Model No. RP		
									3 U	3 U	6 U
Board depth 160 mm											
6	32.2	-	20.3	27.5	-	171.5	122	167	3653.000	-	-
8	40.3	-	30.5	36.0	-	171.5	122	167	-	3653.010	-
10	50.5	35.6	40.6	46.2	-	171.5	122	167	-	3653.020	3653.100
12	60.6	45.7	50.8	56.4	-	171.5	122	167	-	3653.030	3653.110
14	70.8	55.9	60.9	66.5	-	171.5	122	167	-	3653.040	3653.120
21	106.3	91.4	96.4	102.0	86.3	171.5	122	167	-	3653.050	3653.130
28	141.9	127.0	132.0	137.6	121.8	171.5	122	167	-	3653.060	3653.140
42	213.1	198.1	203.2	208.8	193.0	171.5	122	167	-	3653.070	3653.150
Board depth 220 mm											
10	50.5	35.6	40.6	46.2	-	231.5	182	227	-	3653.200	3653.300
12	60.6	45.7	50.8	56.4	-	231.5	182	227	-	3653.210	3653.310
14	70.8	55.9	60.9	66.5	-	231.5	182	227	-	3653.220	3653.320
21	106.3	91.4	96.4	102.0	86.3	231.5	182	227	-	3653.230	3653.330
28	141.9	127.0	132.0	137.6	121.8	231.5	182	227	-	3653.240	3653.340
42	213.1	198.1	203.2	208.8	193.0	231.5	182	227	-	3653.250	3653.350
Supply includes											
Font panel									1	1	1
Handle									1	1	2
Side panels									1	2	2
Cover including rear panel									1	-	-
Rear panel									-	1	2
PCB holder									2	2	2
Assembly parts (set)									1	1	1

Section A – A
Board depth 160 mm

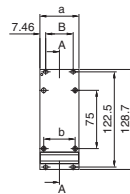

Section B – B
Type I, 3 U

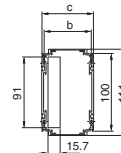
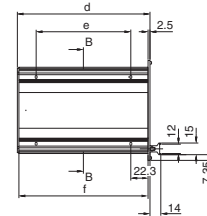

Section A – A
Board depth 160 mm

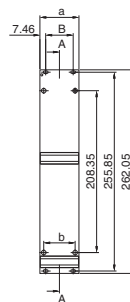

Section B – B
Type I, 6 U

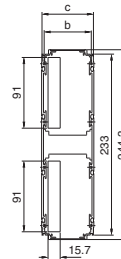
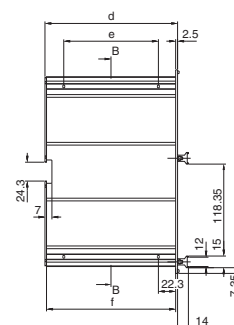

X-ON Electronics

Largest Supplier of Electrical and Electronic Components

Click to view similar products for [Rittal manufacturer](#):

Other Similar products are found below :

[EB1546](#) [KL1501](#) [KL1590](#) [3652070](#) [1002.600](#) [1004.600](#) [1033.500](#) [1036.500](#) [1037.500](#) [1076.500](#) [1077.500](#) [1302.600](#) [1338.500](#) [1380.500](#)
[1505.510](#) [1506.510](#) [1508.510](#) [1510.510](#) [1514.510](#) [1517.510](#) [1518.510](#) [1577.450](#) [1578.450](#) [1578.530](#) [1579.450](#) [9514.000](#) [9521.050](#)
[1434.500](#) [1444.500](#) [1446.500](#) [1519.510](#) [1522.010](#) [1523.010](#) [1524.010](#) [1525.010](#) [1526.010](#) [1527.010](#) [1527.510](#) [1529.010](#) [1530.010](#)
[1530.510](#) [1533.510](#) [1534.510](#) [1535.510](#) [1536.510](#) [1537.510](#) [1538.510](#) [1539.510](#) [1540.510](#) [1541.510](#)