

Part Number: CW1300 Series
Tilt Switch / Motion Sensor
Product Data Sheet

PICTURE

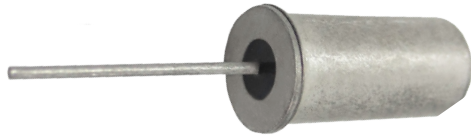

OPERATION

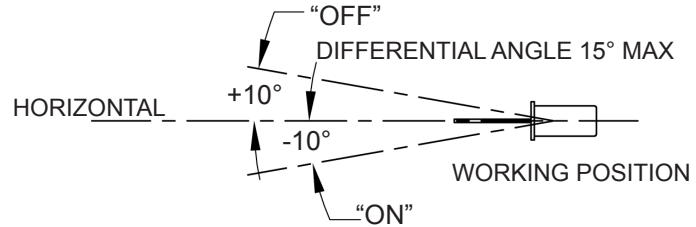

FEATURES

- Resistant to Ambient Environmental Conditions
- Case Material : Tin Plated
- Hermetically Sealed & Inert Gas Filled
- Customization Available

✓ **RoHS Compliant**

GENERAL SPECIFICATIONS

Contact Capacity	60 V MAX, 0.25 A MAX, 3 VA MAX
Contact Resistance	30 Ω MAX Measured 10° Below Horizontal at 5 VDC
Make Angle	10° MAX Below Horizontal
Break Angle	10° MAX Above Horizontal
Differential Angle	15° MAX
Operating Temperature	-37° to 100°C

DIMENSIONS

Click drawings for more information.

Part Number: CW1300-0

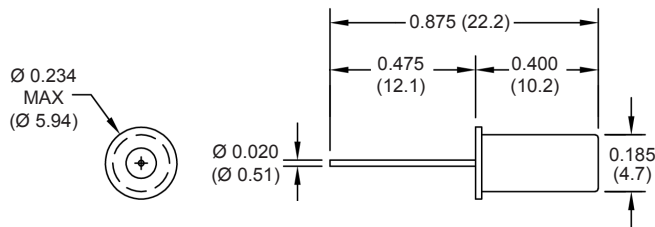

Part Number: CW1300-1

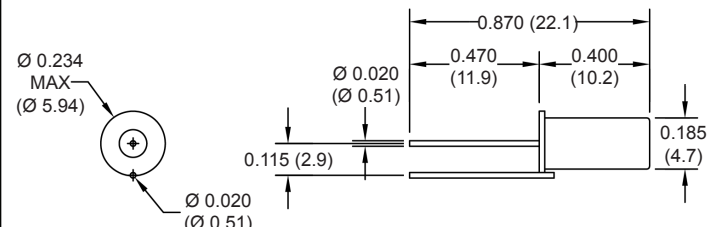

Part Number: CW1300-2

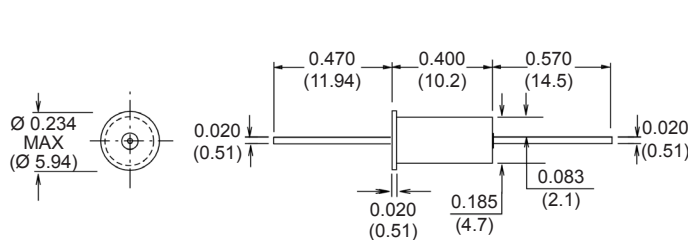

Part Number: CW1300-3

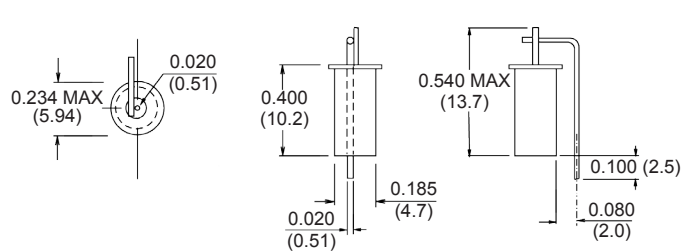

Drawings not to scale. All dimensions in inches (mm) nominal.

As part of the company policy of continued product improvement, specifications may change without notice. Our sales office will be pleased to help you with the latest information on this product range and the details of our full design and manufacturing service. All products are supplied to our standard conditions of sale unless otherwise agreed in writing.

Phone: (1) 973 777 6900

www.comus-intl.com

Fax: (1) 973 777 8405

Part Number: CW1300 Series Tilt Switch / Motion Sensor Product Data Sheet

DIMENSIONS

Click drawings for more information.

Part Number: CW1300-4

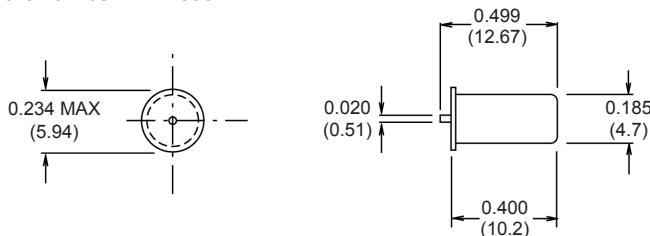

Part Number: CW1300-5

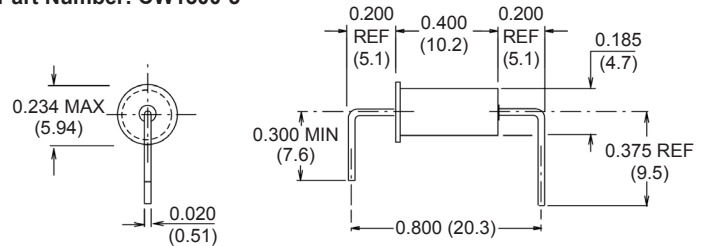

Part Number: CW1300-6

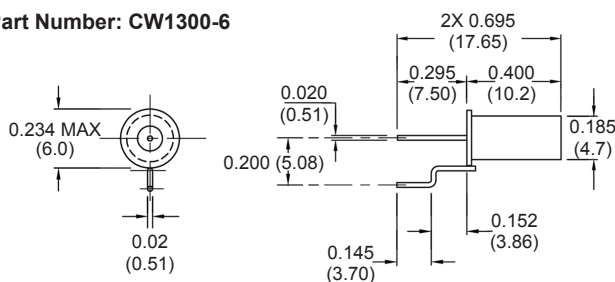

Part Number: CW1300-7

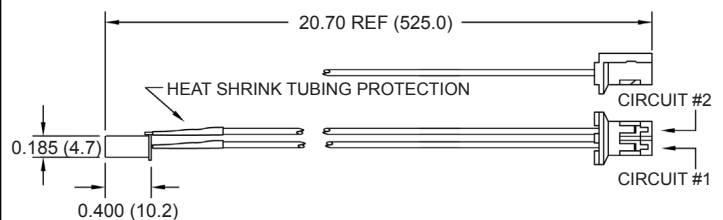

Part Number: CW1300-8

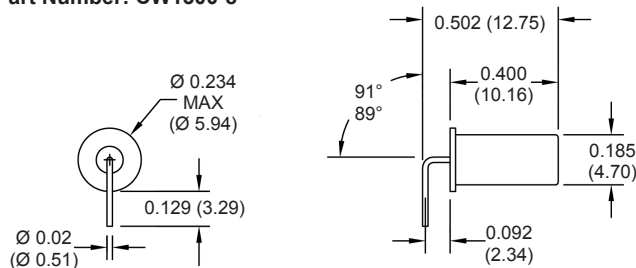

Part Number: CW1300-9

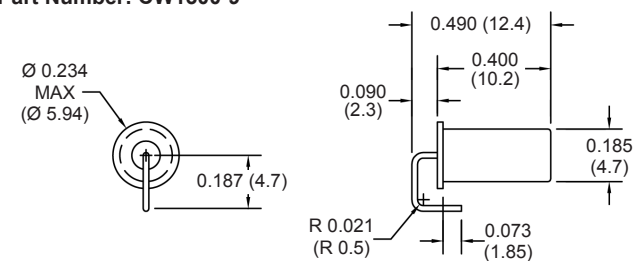

Part Number: CW1300-18

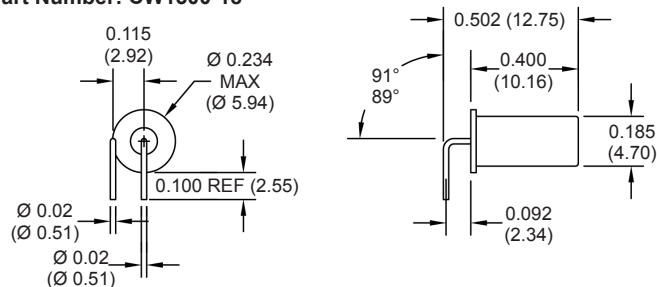

Part Number: CW1300-70

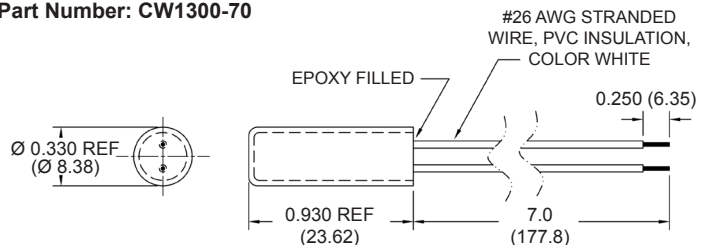

Drawings not to scale. All dimensions in inches (mm) nominal.

TAKE A LOOK AT OUR VARIETY OF PRODUCTS

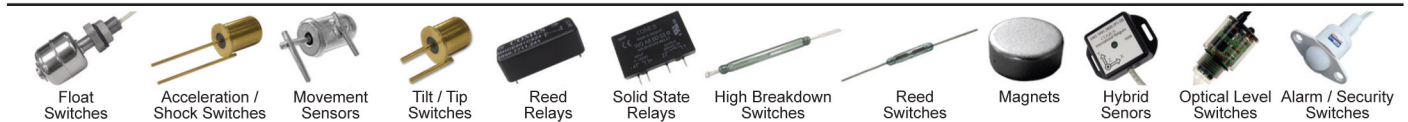

As part of the company policy of continued product improvement, specifications may change without notice. Our sales office will be pleased to help you with the latest information on this product range and the details of our full design and manufacturing service. All products are supplied to our standard conditions of sale unless otherwise agreed in writing.

Phone: (1) 973 777 6900

www.comus-intl.com

Fax: (1) 973 777 8405

Belgium: + 32 (0)12 390400 - Comus Europe Ltd (Assembletech) UK: +44 (0) 1255 862236 - Germany: +49 (0)911 923 15 943 - Netherlands: +31(0)45 54 39 345 - India: +(91) (44) 43219090
©2014 Copyright Comus International, 454 Allwood Road, Clifton NJ 07012, USA

An ISO 9001 Certified Company

Part Number: CW1300 Series Tilt Switch / Motion Sensor Product Data Sheet

DIMENSIONS

Click drawings for more information.

Part Number: CW1300-90

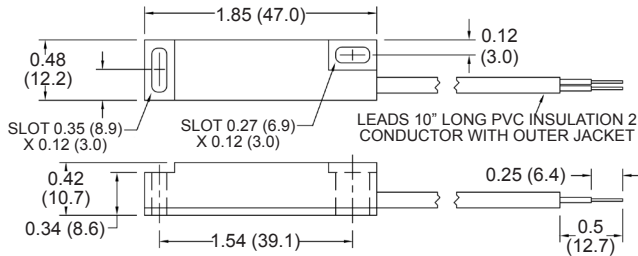

Part Number: CW1300-91

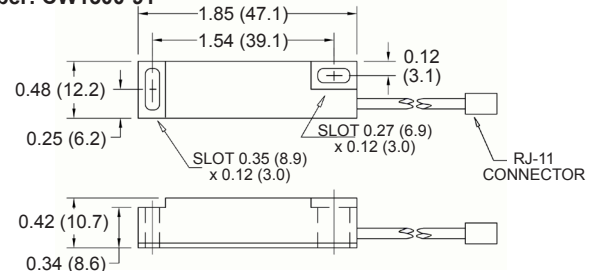

Part Number: CW1300-92

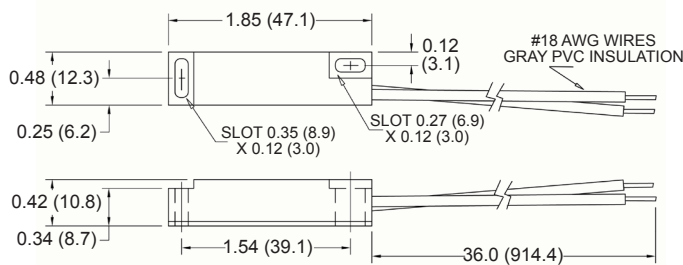

Part Number: CW1300-95

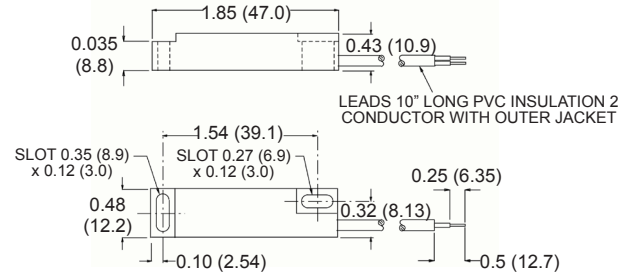

Part Number: CW1300-96

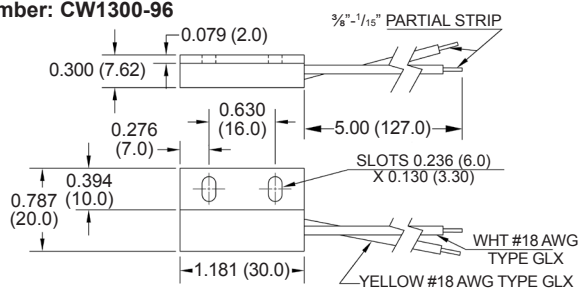

Part Number: CW1300-97

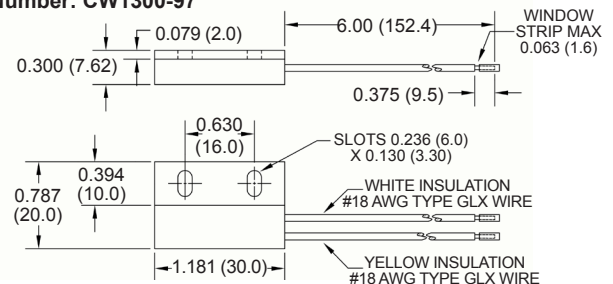

Part Number: CW1300-98

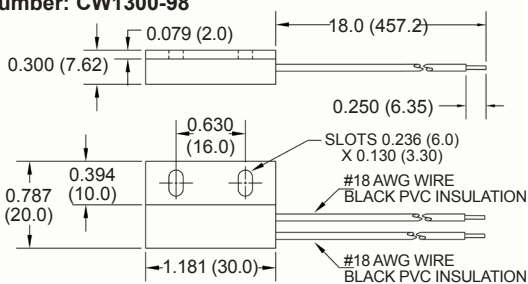

Part Number: CW1312-4

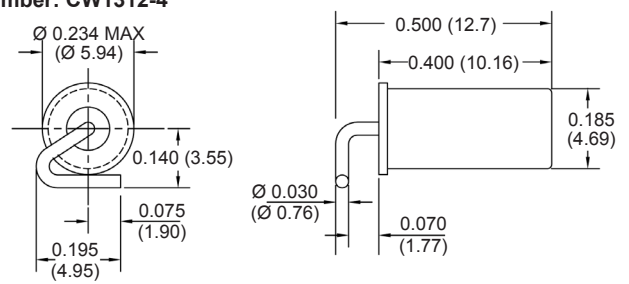

Drawings not to scale. All dimensions in inches (mm) nominal.

TAKE A LOOK AT OUR VARIETY OF PRODUCTS

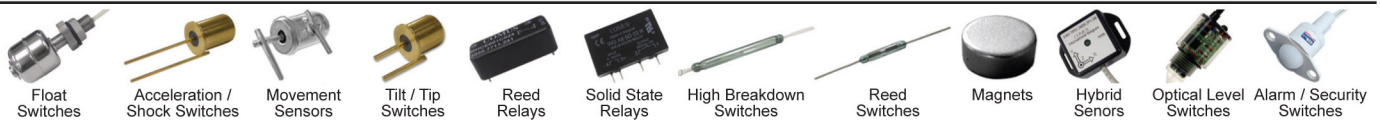

As part of the company policy of continued product improvement, specifications may change without notice. Our sales office will be pleased to help you with the latest information on this product range and the details of our full design and manufacturing service. All products are supplied to our standard conditions of sale unless otherwise agreed in writing.

Phone: (1) 973 777 6900

www.comus-intl.com

Fax: (1) 973 777 8405

Belgium: + 32 (0)12 390400 - Comus Europe Ltd (Assembletech) UK: +44 (0) 1255 862236 - Germany: +49 (0)911 923 15 943 - Netherlands: +31(0)45 54 39 345 - India: +(91) (44) 43219090
©2014 Copyright Comus International, 454 Allwood Road, Clifton NJ 07012, USA

An ISO 9001 Certified Company

X-ON Electronics

Largest Supplier of Electrical and Electronic Components

Click to view similar products for [comus](#) manufacturer:

Other Similar products are found below :

[WGA56D25Z](#) [WG660D110Z](#) [WG280A25Z](#) [PGN-SP-003](#) [WG660D10Z](#) [WGA316D25R](#) [WG660D90Z](#) [S1456](#) [S1366](#) [S1355](#) [WGA316D45R](#)
[3570.1331.121](#) [WG280D90Z](#) [WGA312D25Z](#) [WG280D10R](#) [3572.1220.051](#) [WG660D125Z](#) [WGA56A10Z](#) [CTC 012](#) [CTI 302](#)
[RF3002A/HFS30](#) [WG280D90R](#) [WG280A10Z](#) [WGA012D25](#) [WG660D25Z](#) [MS24](#) [PPS24](#) [3570.1411.053](#) [VFS30](#) [WG280D45R](#)
[WG480D75Z](#) [WG660D75Z](#) [WGA56D25R](#) [PGN-SP-002](#) [WGA56D40Z](#) [WG660D50Z](#) [WG280D50Z](#) [WGA56A25Z](#) [WG280D75Z](#) [PSM](#)
[S1747](#) [WG480D90Z](#) [WG480D40Z](#) [WG280A45Z](#) [MMPSA 240/30 LH](#) [PSSM](#) [MPSM](#) [3563.1231.053](#) [WGA56D10Z](#) [WG280D45Z](#)