



SMD Aluminum Electrolytic Capacitors

VSS

Features

- 4 ~ 6.3 ϕ , 85°C, 2,000 hours assured
- Vertical chip type miniaturized for 4.5mm height capacitor
- Designed for surface mounting on high density PC board
- RoHS Compliance



Marking color: Black

SPECIFICATIONS

Items	Performance																											
Category Temperature Range	-40°C ~ +85°C																											
Capacitance Tolerance	±20% (at 120Hz, 20°C)																											
Leakage Current (at 20°C)	I = 0.01CV or 3 (μ A) whichever is greater (after 2 minutes) Where, C = rated capacitance in μ F V = rated DC working voltage in V																											
Dissipation Factor (Tan δ at 120Hz, 20°C)	<table border="1"> <thead> <tr> <th>Rated Voltage</th> <th>4</th> <th>6.3</th> <th>10</th> <th>16</th> <th>25</th> <th>35</th> <th>50</th> </tr> </thead> <tbody> <tr> <td>Tan δ (max)</td> <td>0.50</td> <td>0.30</td> <td>0.24</td> <td>0.19</td> <td>0.16</td> <td>0.14</td> <td>0.14</td> </tr> </tbody> </table>	Rated Voltage	4	6.3	10	16	25	35	50	Tan δ (max)	0.50	0.30	0.24	0.19	0.16	0.14	0.14											
Rated Voltage	4	6.3	10	16	25	35	50																					
Tan δ (max)	0.50	0.30	0.24	0.19	0.16	0.14	0.14																					
Low Temperature Characteristics (at 120Hz)	<p>Impedance ratio shall not exceed the values given in the table below.</p> <table border="1"> <thead> <tr> <th colspan="2">Rated Voltage</th> <th>4</th> <th>6.3</th> <th>10</th> <th>16</th> <th>25</th> <th>35</th> <th>50</th> </tr> </thead> <tbody> <tr> <td>Impedance</td> <td>Z(-25°C)/Z(+20°C)</td> <td>7</td> <td>4</td> <td>3</td> <td>2</td> <td>2</td> <td>2</td> <td>2</td> </tr> <tr> <td>Ratio</td> <td>Z(-40°C)/Z(+20°C)</td> <td>15</td> <td>8</td> <td>5</td> <td>4</td> <td>3</td> <td>3</td> <td>3</td> </tr> </tbody> </table>	Rated Voltage		4	6.3	10	16	25	35	50	Impedance	Z(-25°C)/Z(+20°C)	7	4	3	2	2	2	2	Ratio	Z(-40°C)/Z(+20°C)	15	8	5	4	3	3	3
Rated Voltage		4	6.3	10	16	25	35	50																				
Impedance	Z(-25°C)/Z(+20°C)	7	4	3	2	2	2	2																				
Ratio	Z(-40°C)/Z(+20°C)	15	8	5	4	3	3	3																				
Endurance	<table border="1"> <thead> <tr> <th colspan="2">Test Time</th> <th colspan="2">2,000 Hrs</th> </tr> </thead> <tbody> <tr> <td rowspan="2">Capacitance Change</td> <td>4 ~ 6.3V</td> <td colspan="2">Within ±30% of initial value</td> </tr> <tr> <td>10 ~ 50V</td> <td colspan="2">Within ±25% of initial value</td> </tr> <tr> <td colspan="2">Dissipation Factor</td> <td colspan="2">Less than 300% of specified value</td> </tr> <tr> <td colspan="2">Leakage Current</td> <td colspan="2">Within specified value</td> </tr> </tbody> </table> <p>* The above specifications shall be satisfied when the capacitors are restored to 20°C after the rated voltage applied for 2,000 hours at 85°C.</p>	Test Time		2,000 Hrs		Capacitance Change	4 ~ 6.3V	Within ±30% of initial value		10 ~ 50V	Within ±25% of initial value		Dissipation Factor		Less than 300% of specified value		Leakage Current		Within specified value									
Test Time		2,000 Hrs																										
Capacitance Change	4 ~ 6.3V	Within ±30% of initial value																										
	10 ~ 50V	Within ±25% of initial value																										
Dissipation Factor		Less than 300% of specified value																										
Leakage Current		Within specified value																										
Shelf Life Test	Test time: 1,000 hours; other items are the same as those for the Endurance.																											
Ripple Current & Frequency Multipliers	<table border="1"> <thead> <tr> <th>Frequency(Hz)</th> <th>50</th> <th>120</th> <th>1k</th> <th>10k up</th> </tr> </thead> <tbody> <tr> <td>Multiplier</td> <td>0.7</td> <td>1.0</td> <td>1.3</td> <td>1.4</td> </tr> </tbody> </table>	Frequency(Hz)	50	120	1k	10k up	Multiplier	0.7	1.0	1.3	1.4																	
Frequency(Hz)	50	120	1k	10k up																								
Multiplier	0.7	1.0	1.3	1.4																								

DIAGRAM OF DIMENSIONS

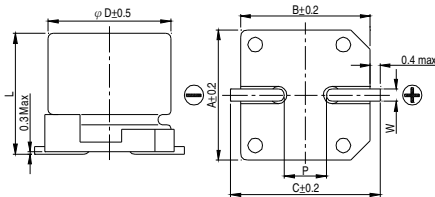

LEAD SPACING AND DIAMETER

Unit: mm

ϕ D	L	A	B	C	W	P ± 0.2
4	4.5 ± 0.2	4.3	4.3	5.1	0.5 ~ 0.8	1.0
5	4.5 ± 0.2	5.3	5.3	6.1	0.5 ~ 0.8	1.5
6.3	4.5 ± 0.2	6.6	6.6	7.4	0.5 ~ 0.8	2.0

MARKING

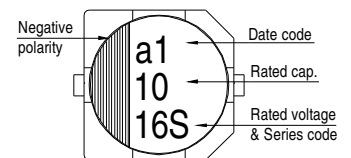

DIMENSION & PERMISSIBLE RIPPLE CURRENT

Dimension: ϕ D × L(mm)

Ripple Current: mA/rms at 120 Hz, 85°C

μ F	V. DC Contents	4V (0G)		6.3V (0J)		10V (1A)		16V (1C)		25V (1E)		35V (1V)		50V (1H)	
		ϕ D×L	mA	ϕ D×L	mA	ϕ D×L	mA	ϕ D×L	mA	ϕ D×L	mA	ϕ D×L	mA	ϕ D×L	mA
0.1	0R1													4×4.5	1.0
0.22	R22													4×4.5	2.0
0.33	R33													4×4.5	2.8
0.47	R47													4×4.5	4.0
1	010													4×4.5	8.4
2.2	2R2													4×4.5	13
3.3	3R3													4×4.5	17
4.7	4R7									4×4.5	16	4×4.5	18	5×4.5	20
10	100							4×4.5	23	5×4.5	27	5×4.5	29	6.3×4.5	33
22	220			4×4.5	23	5×4.5	33	5×4.5	37	6.3×4.5	42	6.3×4.5	46		
33	330	4×4.5	28	5×4.5	37	5×4.5	41	6.3×4.5	49	6.3×4.5	52				
47	470	4×4.5	33	5×4.5	45	6.3×4.5	70	6.3×4.5	58						
100	101	5×4.5	56	6.3×4.5	70										

X-ON Electronics

Largest Supplier of Electrical and Electronic Components

Click to view similar products for [Aluminium Electrolytic Capacitors - Radial Leaded](#) category:

Click to view products by [Lelon](#) manufacturer:

Other Similar products are found below :

[NRELS102M35V16X16C.140LLF](#) [ESRG160ETC100MD07D](#) [227RZS050M](#) [335CKR250M](#) [476CKH100MSA](#) [477CKR100M](#)
[107CKR010M](#) [107CKH063MSA](#) [RJH-25V222MI9#](#) [RJH-35V221MG5#](#) [B43827A1106M8](#) [RJH-50V221MH6#](#) [EKYA500ELL470MF11D](#)
[B41022A5686M6](#) [ESRG250ELL101MH09D](#) [EKMA160EC3101MF07D](#) [RJB-10V471MG3#](#) [ESMG160ETD221MF11D](#)
[EKZH160ETD152MJ20S](#) [RJH-35V122MJ6#](#) [EGXF630ELL621ML20S](#) [RBD-25V100KE3#N](#) [EKMA350ELL100ME07D](#)
[ESMG160ETD101ME11D](#) [ELXY100ETD102MJ20S](#) [EGXF500ELL561ML15S](#) [EKMG350ETD471MJ16S](#) [35YXA330MEFC10X12.5](#)
[RXW471M1ESA-0815](#) [ELXZ630ELL221MJ25S](#) [ERR1HM1R0D11OT](#) [LPE681M30060FVA](#) [LPL471M22030FVA](#) [HFE221M25030FVA](#)
[LKMD1401H221MF](#) [B41888G6108M000](#) [EKMA160ETD470MF07D](#) [UHW1J102MHD6](#) [EKMG500ETD221MJC5S](#) [LKMK2502W101MF](#)
[LKMD1401H181MF](#) [LKMI2502G820MF](#) [LKMJ2001J122MF](#) [LKML2501C472MF](#) [LKMJ4002C681MF](#) [450MXH330MEFCSN25X45](#)
[450MXK330MA2RFC22X50](#) [63ZLH560MEFCG412.5X30](#) [ELH2DM331O25KT](#) [ELH2DM471P30KT](#)