

# RASPBERRY PI STYLE ENCLOSURES

## Fitting of the PCB, Light Pipe and Pi-Face Digital Assembly

### Light Pipe Assembly

1. Place your Pi-Face Digital top and base onto a steady surface.
2. Peel off the protective film on the light pipes.
3. Apply two drops of glue onto the recess. (We recommend using Everbuild stick 2 All Purpose Superglue)
4. Ensuring that the light pipe is in the correct orientation as shown, place into the recess and hold for five seconds ensuring that the light pipes are perpendicular to the enclosure top.

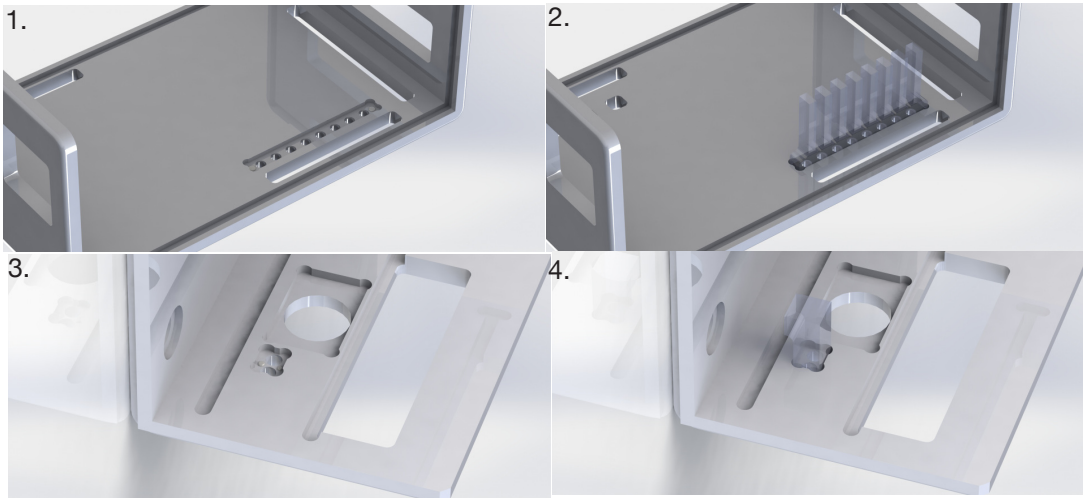

### PCB Assembly

5. Place your Pi-Face Digital enclosure base onto a steady surface.
6. Tilting your Pi-Face Digital at 45° angle align the audio and RCA video ports with the machined holes in the base and push until the PCB clips into the PCB groove.
7. Push the opposite side of the PCB down so that it clips into the second PCB groove in the base.

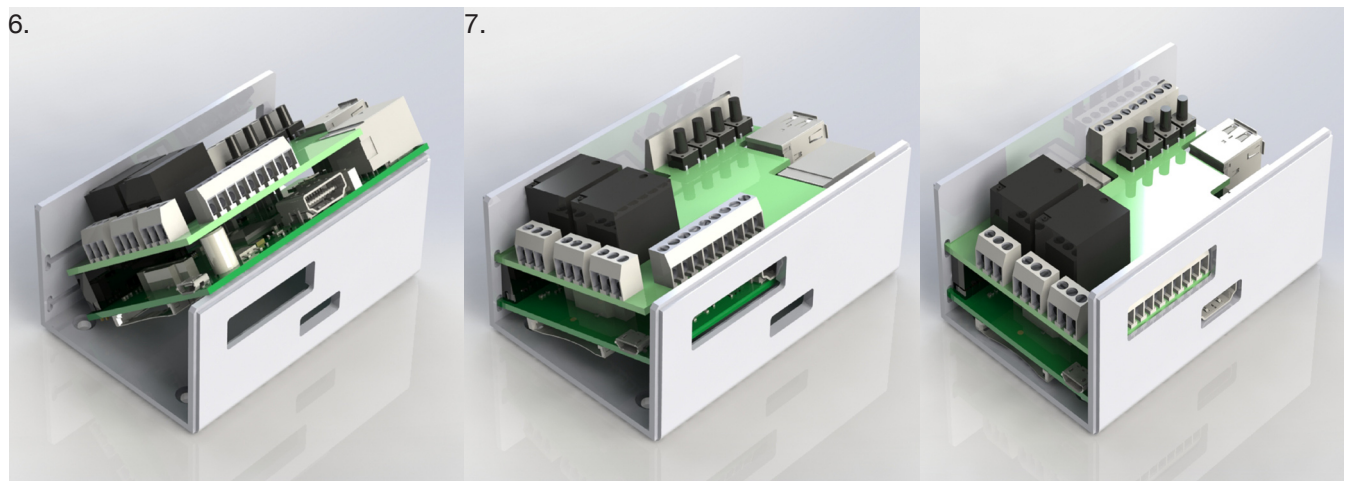

# RASPBERRY PI STYLE ENCLOSURES

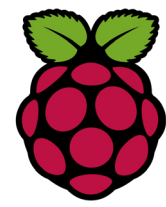

## Pi-Face Digital Enclosure Assembly

8. Place your Raspberry Pi-Face Digital Enclosure on a steady surface.

9. Place your four supplied actuators into the locations shown below. (Ensure correct orientation)

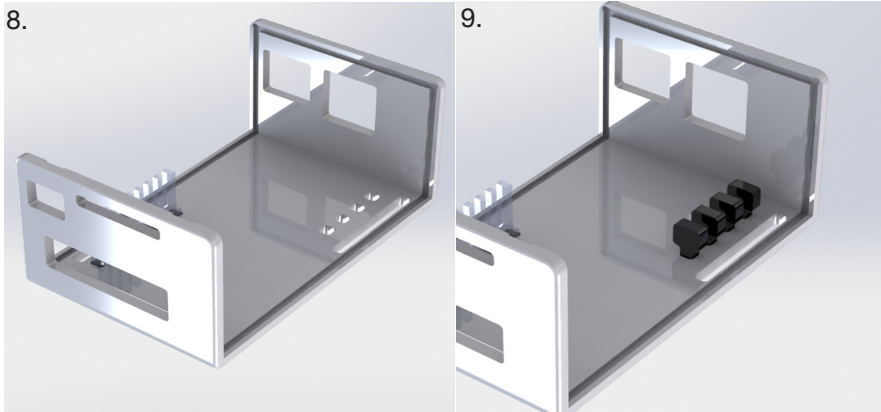

10. Hold the base upside down, in one hand (thumb on the audio connector, fingers over the HDMI connector) Align the USB connector with USB cut-out and clip over the USB and LAN connectors. Then clip the opposite end of the top onto the base.



11. Peel off the protective film on both the top and base of your enclosure. Push the supplied feet into place if required.



UNIVERSAL  
ENCLOSURES

HAND  
HELD  
CASES

HEAVY  
DUTY  
ENCLOSURES

DIN  
RAIL  
BOXES

INTERFACE  
SUPPORTS

CONTROL  
STATIONS

DIECAST  
& METAL  
BOXES

DESKTOP &  
INSTRUMENT  
CASES

POTTING  
BOXES

19"  
ENCLOSURES

19"  
SUBRACKS

CUSTOM  
SIZED  
ENCLOSURES

CUSTOM  
SERVICES



+44 (0)1638 716101  
info@camdenboss.com  
www.camdenboss.com

We operate a constant improvement policy,  
our products are subject to change without notice.

Ver 1.0 Iss 1

**CAMDENBOSS**  
ELECTRONICS & ENCLOSURES

## X-ON Electronics

Largest Supplier of Electrical and Electronic Components

*Click to view similar products for [camden manufacturer](#):*

Other Similar products are found below :

[412689X](#) [CTBP92HE/10](#) [CTBP92VE/12R](#) [CTBP9350/12](#) [IND515205-240-T/GRN](#) [IND515205-240-T/RD](#) [IND5032405-240-T/GRN](#)  
[CE10.00.EI](#) [C192SHAND](#) [RTM5006/16-PAT](#) [CNMB/6ST/2](#) [CNMB/4ST/2](#) [CSACST004](#) [CTBP9200/9](#) [CIME/M/BE2250SS](#) [CHH64E1BL](#)  
[CIM/15W-DMFS](#) [CHHBAT2GY](#) [CFTBN/2](#) [CCB2S1/04](#) [CHDX6-222C](#) [CHDX8-224](#) [CHDASMP29](#) [CHDASMP34](#) [CHDX810DD](#)  
[CHDX811DD](#) [CCTTM40LR](#) [CTBP92VJ/5S](#) [CTBP92VJ/8R](#) [CTSN431/12/M](#) [CTSN433/12/M](#) [CUABOX006](#) [IND513113-LED-RD](#)  
[CE10.00.FM](#) [CBRPH-BLK](#) [RX2008/S-5-WH](#) [CBARD-CAR](#) [CRDCG0007](#) [CNMB/4/KIT](#) [CTB5050/5](#) [CTBP92HE/11](#) [CTBP9358/10AO](#)  
[CHH66C2GY](#) [CHH456PBK](#) [CHH451ABK](#) [CIM/9W-DMFS](#) [CIM/25W-DMFS](#) [RTM5004/14-NC-BLK](#) [RTM5006/16-NC-BLK](#)  
[IND5032405-125-T/AMB](#)