

# Mini contactors

K 3-pole contactors for motor control, 6 and 9 A

Utilisation category AC-3

Control circuit : a.c.

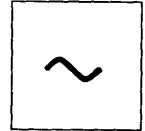

## References

### a.c. control contactors (1)

- Mounting on 35 mm rail or Ø 4 mm screw fixing.
- Screws in open "ready-to-tighten" position.

Standard power ratings of 3-phase motors 50/60 Hz in category AC-3		Rated operational voltage in AC-3 up to	Type of connection	Instantaneous auxiliary contacts	Basic reference. Complete with code indicating control circuit voltage (2)	Weight
220 V	380 V	440/500 V				
kW	kW	kW	A	N/O	N/C	kg
1.5	2.2	3	6	Screw clamp	1 -	<b>LC1-K0610ee</b> 0.180
					- 1	<b>LC1-K0601ee</b> 0.180
				Faston	1 -	<b>LC1-K06107ee</b> 0.180
				1 x 6.35	- 1	<b>LC1-K06017ee</b> 0.180
				or 2 x 2.8		
				Solder pins for printed circuit board	1 -	<b>LC1-K06105ee</b> 0.210
					- 1	<b>LC1-K06015ee</b> 0.210
2.2	4	4	9	Screw clamp	1 -	<b>LC1-K0910ee</b> 0.180
					- 1	<b>LC1-K0901ee</b> 0.180
				Faston	1 -	<b>LC1-K09107ee</b> 0.180
				1 x 6.35	- 1	<b>LC1-K09017ee</b> 0.180
				or 2 x 2.8		
				Solder pins for printed circuit board	1 -	<b>LC1-K09105ee</b> 0.210
					- 1	<b>LC1-K09015ee</b> 0.210

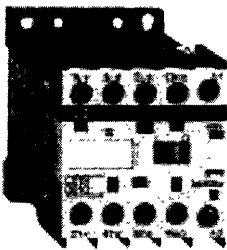

LC1-K0610ee

### a.c. control contactors for use in sensitive environments (1)

**Recommended for use in areas sensitive to noise, high interference mains supplies, etc.**

- Coil with rectifier incorporated, suppressor fitted as standard.
- Mounting on 35 mm rail or Ø 4 mm screw fixing.
- Screws in the open "ready-to-tighten" position.

1.5	2.2	3	6	Screw clamp	1 -	<b>LC7-K0610ee</b> 0.225
					- 1	<b>LC7-K0601ee</b> 0.225
				Faston	1 -	<b>LC7-K06107ee</b> 0.225
				1 x 6.35	- 1	<b>LC7-K06017ee</b> 0.225
				or 2 x 2.8		
				Solder pins for printed circuit board	1 -	<b>LC7-K06105ee</b> 0.255
					- 1	<b>LC7-K06015ee</b> 0.255
2.2	4	4	9	Screw clamp	1 -	<b>LC7-K0910ee</b> 0.225
					- 1	<b>LC7-K0901ee</b> 0.225
				Faston	1 -	<b>LC7-K09107ee</b> 0.225
				1 x 6.35	- 1	<b>LC7-K09017ee</b> 0.225
				or 2 x 2.8		
				Solder pins for printed circuit board	1 -	<b>LC7-K09105ee</b> 0.255
					- 1	<b>LC7-K09015ee</b> 0.255

(1) Add-on auxiliary contact blocks and accessories, see pages 1/8 to 1/11.

(2) Standard control circuit voltages, see page opposite.

Contactors  
LC1-K, LC7-K, LP1-K  
On panel

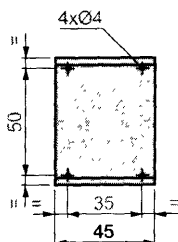
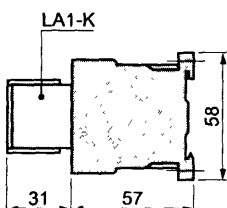

On mounting rail AM1-DP200 or AM1-DE200 (35 mm)

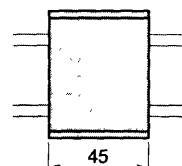
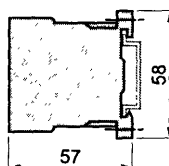

# Mini contactors

K 3-pole contactors for motor control, 6 and 9 A  
 Utilisation category AC-3  
 Control circuit : d.c.

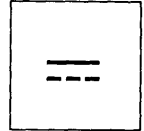

## References

### d.c. control contactors (1)

- Mounting on 35 mm rail or Ø 4 mm screw fixing.
- Screws in open "ready-to-tighten" position.

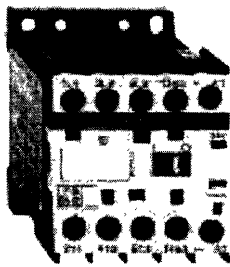

LP1-K0610

Standard power ratings of 3-phase motors 50/60 Hz in category AC-3	Rated operational voltage in AC-3 up to	Type of connection	Instantaneous auxiliary contacts	Basic reference. Complete with code indicating control circuit voltage (2)	Weight
220 V 380 V 440/500 V 230 V 415 V 660/690 V	400 V				
<b>kW</b> 1.5 2.2 3	<b>A</b> 6		N/O N/C		<b>kg</b>
		Screw clamp	1 -	<b>LP1-K0610</b>	0.225
			- 1	<b>LP1-K0601</b>	0.225
		Faston	1 -	<b>LP1-K0610</b>	0.225
		1 x 6.35	- 1	<b>LP1-K0601</b>	0.225
		or 2 x 2.8			
		Solder pins for printed circuit board	1 -	<b>LP1-K0610</b>	0.255
			- 1	<b>LP1-K0601</b>	0.255
2.2 4 4	9	Screw clamp	1 -	<b>LP1-K0910</b>	0.225
			- 1	<b>LP1-K0901</b>	0.225
		Faston	1 -	<b>LP1-K0910</b>	0.225
		1 x 6.35	- 1	<b>LP1-K0901</b>	0.225
		or 2 x 2.8			
		Solder pins for printed circuit board	1 -	<b>LP1-K0910</b>	0.255
			- 1	<b>LP1-K0901</b>	0.255

(1) Add-on auxiliary contact blocks and accessories, see pages 1/8 to 1/11.

(2) Standard control circuit voltages (for other voltages, please consult your Regional customer centre).

### Contactors LC1-K (0.8...1.15 Uc) (0.85...1.1 Uc)

Volts ~	12	20	24	36	42	48	110	120	127	200/220/230	230/256	277	380/400				
50/60 Hz										208 230	240		400				
Code	J7	Z7	B7	C7	D7	E7	F7	G7	FC7	L7	M7	P7	U7	W7	UE7	Q7	V7
Volts ~	400/440	500	575	600	660/690												
50/60 Hz	415				690												
Code	N7	R7	S7	SC7	X7	Y7											

Up to and including 240 V, coil with integral suppression device available : add 2 to the code required.  
 Example : J72

### Contactors LC7-K (0.85...1.1 Uc)

Volts ~	24	42	48	110	220	230/240
50/60 Hz						240
Code	B7	D7	E7	F7	M7	U7

### Contactors LP1-K (0.8...1.15 Uc)

Volts ~	12	20	24	36	48	60	72	100	110	125	155	174	200	220	230	240	250
Code	JD	ZD	BD	CD	ED	ND	SD	KD	FD	GD	PD	QD	LD	MD	MP	MUD	UD

Coil with integral suppression device available : add 3 to the code required. Example : JD3

## Contactors

### LC1-K, LC7-K, LP1-K

On one asymmetrical rail DZ5-MB with clip-on mounting plate LA9-D973

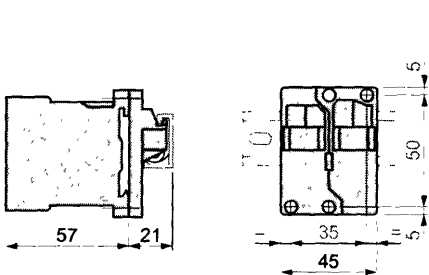

### DX1-AP25

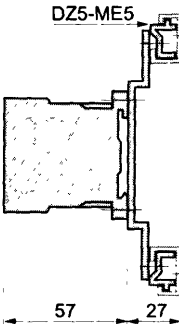

### On printed circuit board

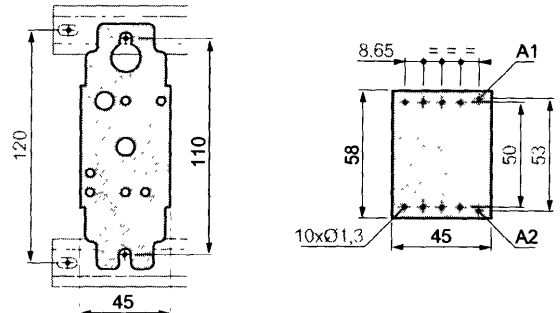

# Mini contactors

K 3 and 4-pole contactors for heating, lighting, etc., 20 A  
 Utilisation category AC-1  
 Control circuit : a.c. and d.c.

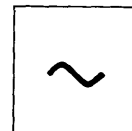

Dimensions  
 pages 1/2 and 1/3

## References

### a.c. control contactors (1)

- Mounting on 35 mm rail or Ø 4 mm screws.
- Screws in open "ready-to-tighten" position.

Non inductive loads Category AC-1 Maximum current at $\theta \leq 50^\circ\text{C}$ A	Type of connection	Number of poles 	Instantaneous auxiliary contacts 	Basic reference. Complete with code indicating control circuit voltage (2)	Weight kg
20	Screw clamp	3 -	1 -	<b>LC1-K0910ee</b>	0.225
		3 -	- 1	<b>LC1-K0901ee</b>	0.225
		4 -	- -	<b>LC1-K09004ee</b>	0.180
		2 2	- -	<b>LC1-K09008ee</b>	0.180
	Faston 1 x 6.35 or 2 x 2.8	3 -	1 -	<b>LC1-K09107ee</b>	0.225
		3 -	- 1	<b>LC1-K09017ee</b>	0.225
		4 -	- -	<b>LC1-K090047ee</b>	0.180
		2 2	- -	<b>LC1-K090087ee</b>	0.180
	Solder pins for printed circuit board	3 -	1 -	<b>LC1-K09105ee</b>	0.255
		3 -	- 1	<b>LC1-K09015ee</b>	0.255
		4 -	- -	<b>LC1-K090045ee</b>	0.210
		2 2	- -	<b>LC1-K090085ee</b>	0.212

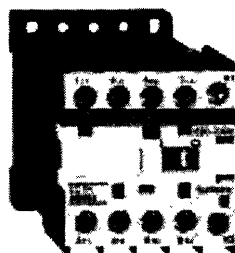

LC1-K09004ee

### a.c. control contactors for use in sensitive environments (1)

**Recommended for use in areas sensitive to noise, high interference mains supplies, etc.**

- Coil with rectifier incorporated, suppressor fitted as standard.
- Mounting on 35 mm rail or Ø 4 mm screw fixing.
- Screws in open "ready-to-tighten" position.

20	Screw clamp	3 -	1 -	<b>LC7-K0910ee</b>	0.225
		3 -	- 1	<b>LC7-K0901ee</b>	0.225
		4 -	- -	<b>LC7-K09004ee</b>	0.225
		2 2	- -	<b>LC7-K09008ee</b>	0.225
	Faston 1 x 6.35 or 2 x 2.8	3 -	1 -	<b>LC7-K09107ee</b>	0.225
		3 -	- 1	<b>LC7-K09017ee</b>	0.225
		4 -	- -	<b>LC7-K090047ee</b>	0.225
		2 2	- -	<b>LC7-K090087ee</b>	0.225
	Solder pins for printed circuit board	3 -	1 -	<b>LC7-K09105ee</b>	0.255
		3 -	- 1	<b>LC7-K09015ee</b>	0.255
		4 -	- -	<b>LC7-K090045ee</b>	0.255
		2 2	- -	<b>LC7-K090085ee</b>	0.255

### d.c. control contactors (1)

20	Screw clamp	3 -	1 -	<b>LP1-K0910ee</b>	0.225
		3 -	- 1	<b>LP1-K0901ee</b>	0.225
		4 -	- -	<b>LP1-K09004ee</b>	0.225
		2 2	- -	<b>LP1-K09008ee</b>	0.225
	Faston 1 x 6.35 or 2 x 2.8	3 -	1 -	<b>LP1-K09107ee</b>	0.225
		3 -	- 1	<b>LP1-K09017ee</b>	0.225
		4 -	- -	<b>LP1-K090047ee</b>	0.225
		2 2	- -	<b>LP1-K090087ee</b>	0.225
	Solder pins for printed circuit board	3 -	1 -	<b>LP1-K09105ee</b>	0.255
		3 -	- 1	<b>LP1-K09015ee</b>	0.255
		4 -	- -	<b>LP1-K090045ee</b>	0.255
		2 2	- -	<b>LP1-K090085ee</b>	0.255

(1) Add-on auxiliary contact blocks and accessories see pages 1/8 to 1/11.

(2) Standard control circuit voltages, see page 1/3.

# Mini contactors

K 3-pole reversing contactors for motor control, 6 and 9 A  
 Utilisation category AC-3  
 Control circuit : a.c. and d.c.

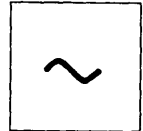

Dimensions  
 page 1/6

## References

### a.c. control reversing contactors (1)

- Integral mechanical interlock.
- Pre-wired power circuit connections as standard on screw clamp versions.
- Mounting on 35 mm rail or Ø 4 mm screw fixing.
- Screws in open "ready-to-tighten" position.

Standard power ratings of 3-phase motors 50/60 Hz in category AC-3	Rated operational current in AC-3 up to	Type of connection	Instantaneous auxiliary contacts	Basic reference. Complete with code indicating control circuit voltage (2)	Weight
220 V 380 V 440/500 V 230 V 415 V 660/690 V	400 V				
<b>kW</b>	<b>kW</b>	<b>A</b>	<b>N/O</b> <b>N/C</b>		<b>kg</b>
1.5	2.2	3	6	Screw clamp	1 - LC2-K0610ee 0.390
					- 1 LC2-K0601ee 0.390
				Faston	1 - LC2-K06107ee 0.370
				1 x 6.35	- 1 LC2-K06017ee 0.370
				or 2 x 2.8	
				Solder pins	1 - LC2-K06105ee 0.430
				for printed	- 1 LC2-K06015ee 0.430
				circuit board	
2.2	4	4	9	Screw clamp	1 - LC2-K0910ee 0.390
					- 1 LC2-K0901ee 0.390
				Faston	1 - LC2-K09107ee 0.370
				1 x 6.35	- 1 LC2-K09017ee 0.370
				or 2 x 2.8	
				Solder pins	1 - LC2-K09105ee 0.430
				for printed	- 1 LC2-K09015ee 0.430
				circuit board	

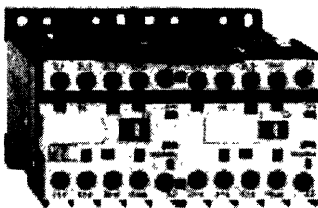

LC2-K0610ee

### a.c. control reversing contactors for use in sensitive environments (1)

**Recommended for use in areas sensitive to noise, high interference mains supplies, etc.**

- Coil with rectifier incorporated, suppressor fitted as standard.
- Integral mechanical interlock.
- Pre-wired power circuit connections as standard on screw clamp versions.
- Mounting on 35 mm rail or Ø 4 mm screw fixing.
- Screws in open "ready-to-tighten" position.

1.5	2.2	3	6	Screw clamp	1 - LC8-K0610ee 0.480
					- 1 LC8-K0601ee 0.480
				Faston	1 - LC8-K06107ee 0.460
				1 x 6.35	- 1 LC8-K06017ee 0.460
				or 2 x 2.8	
				Solder pins	1 - LC8-K06105ee 0.520
				for printed	- 1 LC8-K06015ee 0.520
				circuit board	
2.2	4	4	9	Screw clamp	1 - LC8-K0910ee 0.480
					- 1 LC8-K0901ee 0.480
				Faston	1 - LC8-K09107ee 0.460
				1 x 6.35	- 1 LC8-K09017ee 0.460
				or 2 x 2.8	
				Solder pins	1 - LC8-K09105ee 0.520
				for printed	- 1 LC8-K09015ee 0.520
				circuit board	

### d.c. control reversing contactors (1)

1.5	2.2	3	6	Screw clamp	1 - LP2-K0610ee 0.480
					- 1 LP2-K0601ee 0.480
				Faston	1 - LP2-K06107ee 0.460
				1 x 6.35	- 1 LP2-K06017ee 0.460
				or 2 x 2.8	
				Solder pins	1 - LP2-K06105ee 0.520
				for printed	- 1 LP2-K06015ee 0.520
				circuit board	
2.2	4	4	9	Screw clamp	1 - LP2-K0910ee 0.480
					- 1 LP2-K0901ee 0.480
				Faston	1 - LP2-K09107ee 0.460
				1 x 6.35	- 1 LP2-K09017ee 0.460
				or 2 x 2.8	
				Solder pins	1 - LP2-K09105ee 0.520
				for printed	- 1 LP2-K09015ee 0.520
				circuit board	

(1) Auxiliary contact blocks and accessories - see pages 1/8 to 1/11.

(2) Control circuit voltage codes, see page 1/7.

# Mini contactors

K 3 and 4-pole changeover contactors for heating, lighting, etc., 20 A  
Utilisation category AC-1  
Control circuit : a.c.

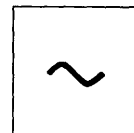

## References

### a.c. control reversing contactors (1)

- Integral mechanical interlock.
- Mounting on 35 mm rail or Ø 4 mm screw fixing.
- Screws in open "ready-to-tighten" position.

Non inductive loads Category AC-1 Maximum current at $\theta \leq 50^\circ\text{C}$	Type of connection	Number of poles 	Instantaneous auxiliary contacts 	Basic reference. Complete with code indicating control circuit voltage (2)	Weight
A			N/O N/C		kg
20	Screw clamp	3	1	LC2-K0910ee (3)	0.390
		3	1	LC2-K0901ee (3)	0.390
		4	-	LC2-K09004ee	0.380
	Faston 1 x 6.35 or 2 x 2.8	3	1	LC2-K09107ee	0.370
		3	1	LC2-K09017ee	0.370
		4	-	LC2-K090047ee	0.370
	Solder pins for printed circuit board	3	1	LC2-K09105ee	0.430
		3	1	LC2-K09015ee	0.430
		4	-	LC2-K090045ee	0.430

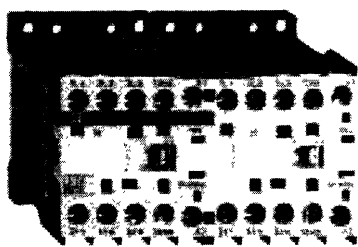

LC2-K0910ee

### a.c. control reversing contactors for use in sensitive environments (1)

**Recommended for use in areas sensitive to noise, high interference mains supplies, etc.**

- Coil with rectifier incorporated, suppressor fitted as standard.
- Integral mechanical interlock.
- Mounting on 35 mm rail or Ø 4 mm screw fixing.
- Screws in open "ready-to-tighten" position.

20	Screw clamp	3	1	LC8-K0910ee (3)	0.480
		3	1	LC8-K0901ee (3)	0.480
		4	-	LC8-K09004ee	0.470
	Faston 1 x 6.35 or 2 x 2.8	3	1	LC8-K09107ee	0.460
		3	1	LC8-K09017ee	0.460
		4	-	LC8-K090047ee	0.460
	Solder pins for printed circuit board	3	1	LC8-K09105ee	0.520
		3	1	LC8-K09015ee	0.520
		4	-	LC8-K090045ee	0.520

(1) Add-on auxiliary contact blocks and accessories: see pages 178 to 179.

(2) Control circuit voltage codes, see page opposite.

(3) **Warning: this reversing contactor is pre-wired for reverse motor operation as standard.**

## Reversing contactors LC2-K, LC8-K, LP2-K On panel

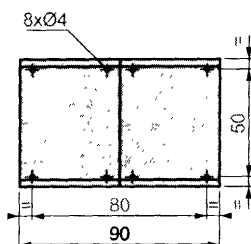
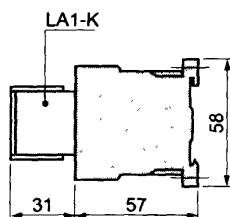

## On mounting rail AM1-DP200 or AM1-DE200 (35 mm)

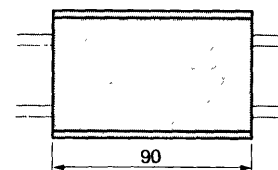
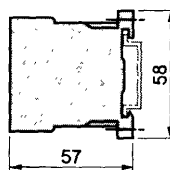

# Mini contactors

K 3 and 4-pole changeover contactors for heating, lighting, etc., 20 A  
 Utilisation category AC-1  
 Control circuit : d.c.

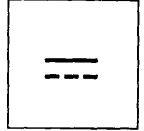

## References

### d.c. control reversing contactors (1)

- Integral mechanical interlock.
- Mounting on 35 mm rail or Ø 4 mm screw fixing.
- Screws in open "ready-to-tighten" position.

Non inductive loads Category AC-1 Maximum current at $\theta \leq 50^\circ\text{C}$	Type of connection	Number of poles 	Instantaneous auxiliary contacts 	Basic reference. Complete with code indicating control circuit voltage (2)	Weight	
<b>A</b>			N/O N/C		kg	
<b>20</b>	Screw clamp	3	1	<b>LP2-K0910ee (3)</b>	0.480	
		3	1	<b>LP2-K09001ee (3)</b>	0.480	
		4	-	<b>LP2-K09004ee</b>	0.480	
	Faston 1 x 6.35 or 2 x 2.8	3	1	<b>LP2-K09107ee</b>	0.460	
		3	1	<b>LP2-K09017ee</b>	0.460	
		4	-	<b>LP2-K090047ee</b>	0.460	
	Solder pins for printed circuit board	3	1	<b>LP2-K09105ee</b>	0.520	
		3	1	<b>LP2-K09015ee</b>	0.520	
			4	-	<b>LP2-K090045ee</b>	0.520

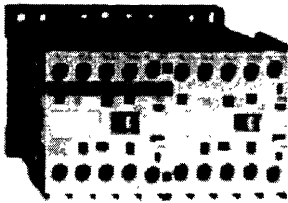

LP2-K0910ee

(1) Add-on auxiliary contact blocks and accessories see pages 1/8 to 1/11.

(2) Standard control circuit voltages (for other voltages, please consult your Regional customer centre).

### Reversing contactors LC2-K (0.85...1.15 Uc) (0.85...1.1 Uc)

Volts ~	12	20	24	36	42	48	110	120	127	200/220/230	230/256	277	380/400				
50/60 Hz										208	230	240	400				
Code	J7	Z7	B7	C7	D7	E7	F7	G7	FC7	L7	M7	P7	U7	W7	UE7	Q7	V7
Volts ~	400/440			500	575	600	660/										
50/60 Hz	415			690													
Code	N7		R7	S7	SC7	X7	Y7										

Up to and including 240 V, coil with integral suppression device available : add 2 to the code required.  
 Example : J72

### Reversing contactors LC8-K (0.85...1.1 Uc)

Volts ~	24	42	48	110	220	230/
50/60 Hz	240					
Code	B7	D7	E7	F7	M7	U7

### Reversing contactors LP2-K (0.8...1.15 Uc)

Volts ~	12	20	24	36	48	60	72	100	110	125	155	174	200	220	230	240	250
Code	JD	ZD	BD	CD	ED	ND	SD	KD	FD	GD	PD	QD	LD	MD	MPD	MUD	UD

Coil with integral suppression device available : add 3 to the code required. Example : JD3

(3) Warning: this reversing contactor is pre-wired for reverse motor operation as standard.

On one asymmetrical rail DZ5-MB with 2 clip-on mounting plates LA9-D973 or on 2 mounting plates DX1-AP25.  
 2 x LA9-D973

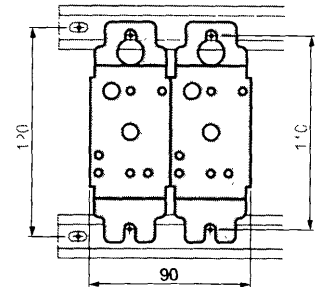
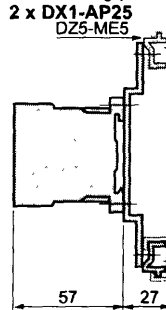
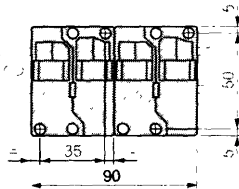
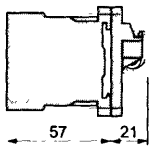

On printed circuit board for reversing contactors or 2 contactors mounted side by side

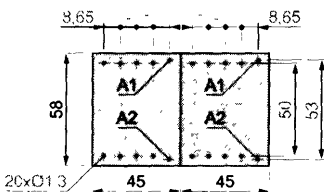

1

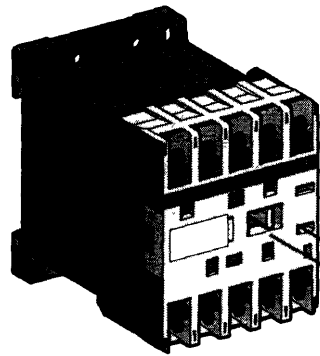

LC1,LC7,LP1-K06 ,K09

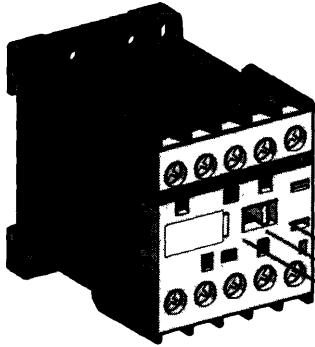
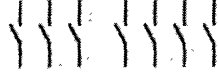

LC1,LC7,LP1-K06 ,K09

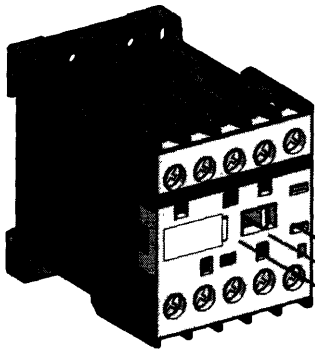

LC1,LC7,LP1-K09

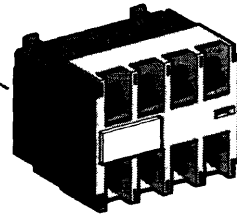

LA1-KN...

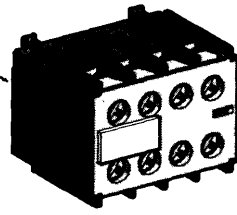

LA1-KN...M

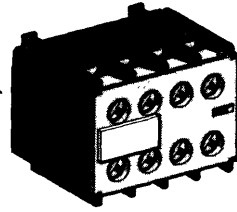

LA1-KN...

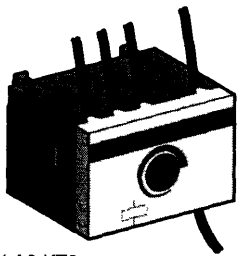

LA2-KT2...

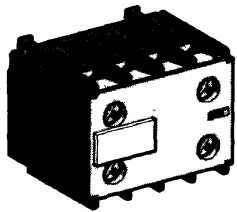

LA1-KN...P

# Mini contactors

K 3 and 4-pole contactors, reversing and changeover contactors  
Instantaneous and time delay auxiliary contacts

## References

Illustrations  
page 1/8

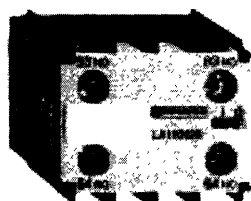

LA1-KN40●●

## Instantaneous auxiliary contact blocks

### Recommended for standard applications

#### Clip-on front mounting, 1 block per contactor

Type of connection	Type of contactor	Composition	Reference	Weight		
		N/O N/C		kg		
Screw clamp	LC1, LC7, LP1 3 or 4-pole	2 -	<b>LA1-KN20</b>	0.045		
		- 2	<b>LA1-KN02</b> (1)	0.045		
		1 1	<b>LA1-KN11</b> (2)	0.045		
		4 -	<b>LA1-KN40</b>	0.045		
		3 1	<b>LA1-KN31</b>	0.045		
		2 2	<b>LA1-KN22</b>	0.045		
		1 3	<b>LA1-KN13</b> (3)	0.045		
		- 4	<b>LA1-KN04</b> (4)	0.045		
		Faston 1 x 6.35 or 2 x 2.8	LC1, LC7, LP1 3 or 4-pole	2 -	<b>LA1-KN207</b>	0.045
				- 2	<b>LA1-KN027</b>	0.045
1 1	<b>LA1-KN117</b>			0.045		
4 -	<b>LA1-KN407</b>			0.045		
3 1	<b>LA1-KN317</b>			0.045		
2 2	<b>LA1-KN227</b>			0.045		
1 3	<b>LA1-KN137</b>			0.045		
- 4	<b>LA1-KN047</b>			0.045		

#### With terminal referencing conforming to standard EN 50012

#### Clip-on front mounting, 1 block per contactor

Screw clamp	LC1, LC7, LP1 3-pole 6 and 9 A	- 2	<b>LA1-KN02M</b>	0.045
		1 1	<b>LA1-KN11M</b>	0.045
		3 1	<b>LA1-KN31M</b>	0.045
		2 2	<b>LA1-KN22M</b>	0.045
		1 3	<b>LA1-KN13M</b>	0.045
LC1, LC7, LP1 4-pole 9 A		1 1	<b>LA1-KN11P</b>	0.045
		2 2	<b>LA1-KN22P</b>	0.045

(1) Cannot be used on contactors : LP4/LP5-K●●01, LP4/LP5-K09008.

(2) Cannot be used on contactors : LP4/LP5-K09008.

(3) Cannot be used on contactors : LC7/LC8/LP1/LP2-K09008.

(4) Cannot be used on contactors : LC7/LC8/LP1/LP2-K●●01, LC7/LC8/LP1/LP2-K09008.

## Electronic time delay auxiliary contact blocks

- Relay output, with common point changeover contact, 2 A maximum.
- Control voltage :  $\sim$  or  $\equiv$  24...48 V,  $\sim$  110...240 V, 0.85...1.1 Uc.
- Maximum switching capacity : 250 VA or 150 W.
- Operating temperature : -10...+60 °C.
- Reset time : 1.5 s during the time delay period, 0.5 s after the time delay period.

#### Clip-on front mounting, 1 block per contactor

Voltage	Type	Timing range	Composition	Reference	Weight
V		s	C/O		kg
$\sim$ or $\equiv$ 24...48	On-delay	1...30	1	<b>LA2-KT2E</b>	0.040
$\sim$ 110...240	On-delay	1...30	1	<b>LA2-KT2U</b>	0.040

### Electronic time delay contact blocks LA2-KT

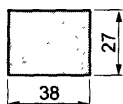
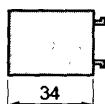

#### On contactors

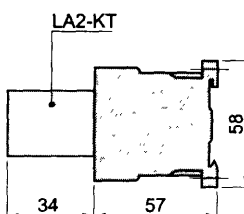

#### On reversing contactors

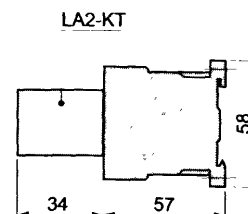



# Mini contactors

K 3 and 4-pole contactors, reversing and changeover contactors  
Suppressor modules incorporating LED indicator

## References

1

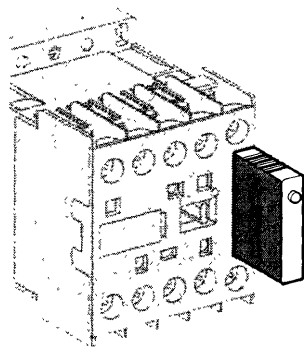

LA4-K\*\*\*

Mounting and connection	Type	For voltages:	Sold in lots of	Unit reference	Weight kg
Clip-on fixing on the front of contactors LC1, LC2, LP1 and LP2	Varistor (1)	~ and ≍ 12...24 V	5	<b>LA4-KE1B</b>	0.010
		~ and ≍ 32...48 V	5	<b>LA4-KE1E</b>	0.010
		~ and ≍ 50...129 V	5	<b>LA4-KE1FC</b>	0.010
		~ and ≍ 130...250 V	5	<b>LA4-KE1UG</b>	0.010
Diode + Zener diode (2)	≍	12...24 V	5	<b>LA4-KC1B</b>	0.010
		32...48 V	5	<b>LA4-KC1E</b>	0.010
RC (3)		~ 220 ..250 V	5	<b>LA4-KA1U</b>	0.010

(1) Protection by limitation of the transient voltage up to 2 Uc maximum.  
Maximum reduction of transient voltage peaks.  
Slight time delay on drop-out (1.1 to 1.5 times the normal time).  
(2) No overvoltage or oscillation frequency.  
Polarised component.  
Slight time delay on drop-out (1.1 to 1.5 times the normal time).  
(3) Protection by limitation of the transient voltage up to 3 Uc maximum and limitation of the oscillation frequency.  
Slight time delay on drop-out (1.2 to 2 times the normal time).

### Suppressor modules LA4-K\*

On contactors

On reversing contactors

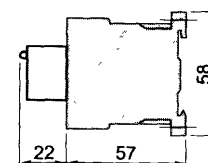
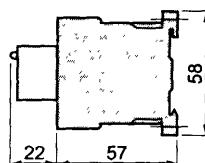
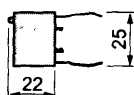

# Mini contactors

K 3 and 4-pole contactors, reversing and changeover contactors  
Accessories

## References

Dimensions  
pages 1/3 and 1/7

### Mounting and marking accessories

Description	Application		Sold in lots of	Unit reference	Weight kg
<b>Mounting plates (1)</b>	For fixing on 1 L rail	Clip-on	1	<b>LA9-D973</b>	0.025
	For fixing on 2 L rails	110/120 mm fixing centres	1	<b>DX1-AP25</b>	0.065
<b>Marker holder</b>	Clip-on	Onto front of contactor	100	<b>LA9-D90</b>	0.001
<b>Clip-in markers</b>	4 maximum per contactor	Strips of 10 identical numbers 0...9	25	<b>AB1-Ra (2)</b>	0.002
		Strips of 10 identical capital letters A...Z	25	<b>AB1-Ga (2)</b>	0.002

### Cabling accessories

Description	Application		Sold in lots of	Unit reference	Weight kg
<b>Paralleling links</b>	For 2 poles with screw clamp terminals		4	<b>LA9-E01</b>	0.010
	For 4 poles with screw clamp terminals		2	<b>LA9-E02</b>	0.015
<b>Set of 6 power connections</b>	For 3-pole reversing contactors for motor control	For contactors with screw clamp terminals	100	<b>LA9-K0969</b>	0.010
<b>Set of 4 power connections</b>	For 4-pole changeover contactor pairs	For contactors with screw clamp terminals	100	<b>LA9-K0970</b>	0.010

(1) Order 1 mounting plate for fixing a contactor and 2 mounting plates for fixing a reversing contactor.  
(2) Complete the reference by replacing the ● with the required character.

# Mini thermal overload relays

K thermal overload relays, adjustable from 0.11 to 11.5 A, for motor protection; compensated and phase failure sensitive, manual or automatic reset

## References

### 3-pole relays with screw clamp terminals

Direct mounting : under the contactor for versions with screw clamp terminals only; pre-wired terminals, see below.

Separate mounting : using terminal block LA7-K0064 (see below).

On the front of the overload relay :

- selection of reset mode : Manual (marked H) or Automatic (marked A),
- red pushbutton : Trip Test function,
- red pushbutton : Trip reset,
- blue pushbutton : Stop and manual Reset,
- yellow trip flag indicator : overload relay tripped.

Protection by fuses or by magnetic circuit-breaker type GV2-L, see page 1/92.

Relay setting range	Fuses to be used with selected relay		Reference	Weight kg
	Maximum rating			
	Type	Type		
A	aM	gG (BS88)		

**Class 10 A** (the standard specifies a tripping time of between 2 and 10 seconds at 7.2 In)

0.11...0.16	0.25	2	<b>LR2-K0301</b>	0.145
0.16...0.23	0.25	2	<b>LR2-K0302</b>	0.145
0.23...0.36	0.5	2	<b>LR2-K0303</b>	0.145
0.36...0.54	1	4	<b>LR2-K0304</b>	0.145
0.54...0.8	1	4	<b>LR2-K0305</b>	0.145
0.8...1.2	2	6	<b>LR2-K0306</b>	0.145
1.2...1.8	2	6	<b>LR2-K0307</b>	0.145
1.8...2.6	4	10	<b>LR2-K0308</b>	0.145
2.6...3.7	4	16	<b>LR2-K0310</b>	0.145
3.7...5.5	6	16	<b>LR2-K0312</b>	0.145
5.5...8	8	20	<b>LR2-K0314</b>	0.145
8...11.5	10	20	<b>LR2-K0316</b>	0.145

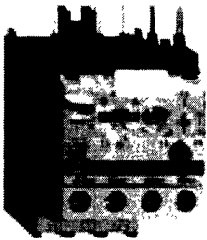

LR2-K030

## LR2-K

Direct mounting under the contactor

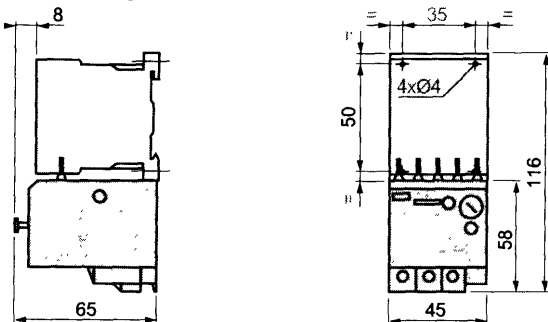

# Mini thermal overload relays

K thermal overload relays, adjustable from 0.11 to 11.5 A, for motor protection; compensated and phase failure sensitive, manual or automatic reset

## References

### Accessories for thermal overload relays

Description	Type of connection	Reference	Weight kg
Terminal block for separate clip-on mounting of the overload relay on 35 mm rail	Screw clamp	<b>LA7-K0064</b>	0 100

1

Separate mounting with terminal block **LA7-K0064**  
on 35 mm rail  
(AM1-DP200 or AM1-DE200)

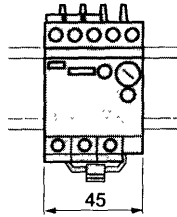
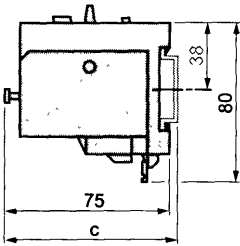

AM1-	C
DP200	78.5
DE200	86

# Mini contactors

K 3 and 4-pole low consumption contactors  
for motor control (AC-3) and heating and lighting, etc. (AC-1)  
Control circuit : d.c.



## References

### d.c. control contactors (1)

- Compatible with programmable controller outputs.
- LED indicator incorporated.
- Wide range coil (0.7...1.30 Uc), suppressor fitted as standard, consumption 1.5 W.
- Mounting on 35 mm rail or Ø 4 mm screw fixing.
- Screws in open "ready-to-tighten" position.

Motor control in category AC-3	Type of connection	Instantaneous auxiliary contacts	Basic reference. Complete with code indicating control circuit voltage (2)	Weight
Maximum operational current 440 V	Standard power ratings of 3-phase motors 220 V 380 V 440/500 V 230 V 415 V 660/690 V			
<b>A</b>	<b>KW</b> <b>KW</b> <b>KW</b>	<b>N/O</b> <b>N/C</b>		<b>kg</b>
<b>6</b>	1.5 2.2 3	Screw clamp	1 - <b>LP4-K0610eee</b>	0.235
			- 1 <b>LP4-K0611eee</b>	0.235
			1 - <b>LP4-K06107eee</b>	0.235
			- 1 <b>LP4-K0617eee</b>	0.235
<b>9</b>	2.2 4 4	Screw clamp	1 - <b>LP4-K0910eee</b>	0.235
			- 1 <b>LP4-K0901eee</b>	0.235
			1 - <b>LP4-K09107eee</b>	0.235
			- 1 <b>LP4-K0917eee</b>	0.235
<b>9</b>	2.2 4 4	Faston 1 x 6.35 or 2 x 2.8	1 - <b>LP4-K06105eee</b>	0.265
			- 1 <b>LP4-K0615eee</b>	0.265
			1 - <b>LP4-K09105eee</b>	0.265
			- 1 <b>LP4-K0915eee</b>	0.265

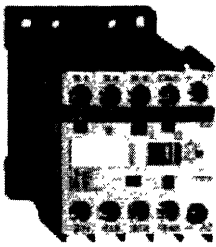

LP4-K0610

Non inductive loads Cat. AC-1 $\theta \leq 50^\circ\text{C}$ Maximum current	Type of connection	Number of poles	Instantaneous auxiliary contacts	Basic reference. Complete with code indicating control circuit voltage (2)	Weight
<b>A</b>			<b>N/O</b> <b>N/C</b>		<b>kg</b>
<b>20</b>	Screw clamp	3 -	1 -	<b>LP4-K0910eee</b>	0.235
		3 -	- 1	<b>LP4-K0901eee</b>	0.235
		4 -	-	<b>LP4-K09004eee</b>	0.235
		2 2 -	-	<b>LP4-K09008eee</b>	0.235
		3 -	1 -	<b>LP4-K09107eee</b>	0.235
		4 -	-	<b>LP4-K09047eee</b>	0.235
	Faston 1 x 6.35 or 2 x 2.8	3 -	-	<b>LP4-K090087eee</b>	0.235
		2 2 -	-	<b>LP4-K09105eee</b>	0.265
		3 -	-	<b>LP4-K0915eee</b>	0.265
		4 -	-	<b>LP4-K09045eee</b>	0.265
		2 2 -	-	<b>LP4-K09085eee</b>	0.265
		2 2 -	-	<b>LP4-K09085eee</b>	0.265

(1) Add-on auxiliary contact blocks and accessories see pages 1.16 and 1.17.

(2) Standard control circuit voltages (for other voltages, please consult your Regional customer centre).

Volts ---	12	24	48	72
Code	JW3	BW3	EW3	SW3

## Contactors

### LP4-K

On panel

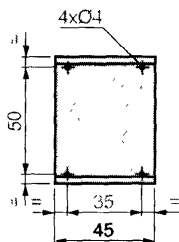
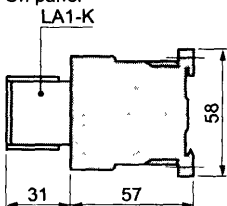

On mounting rail AM1-DP200 or AM1-DE200 (L= 35 mm)

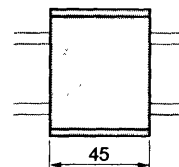
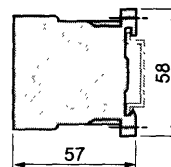

# Mini contactors

K 3 and 4-pole low consumption reversing and changeover contactors for motor control (AC-3) and heating, lighting etc., (AC-1)  
Control circuit : d.c.

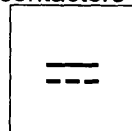

## References

### d.c. control reversing and changeover contactors (1)

- Compatible with programmable controller outputs.
- LED indicator incorporated.
- Wide range coil (0.7...1.30 Uc), suppressor fitted as standard, consumption 1.5 W.
- Mechanical interlock incorporated.
- Pre-wired power circuit connections as standard on screw clamp versions.
- Mounting on 35 mm rail or Ø 4 mm screw fixing.
- Screws in open "ready-to-tighten" position.

Motor control in category AC-3				Type of connection	Instantaneous auxiliary contacts	Basic reference. Complete with code indicating control circuit voltage (2)	Weight	
Maximum operational current	Standard power ratings of 3-phase motors							
440 V	220 V	380 V	440/500 V					
	230 V	415 V	660/690 V					
A	kW	kW	kW		N/O	N/C	kg	
6	1.5	2.2	3	Screw clamp	1	-	<b>LP5-K0610eee</b>	0.490
					-	1	<b>LP5-K0601eee</b>	0.490
				Faston 1 x 6.35 or 2 x 2.8	1	-	<b>LP5-K06107eee</b>	0.470
					-	1	<b>LP5-K06017eee</b>	0.470
				Solder pins for printed circuit board	1	-	<b>LP5-K06105eee</b>	0.530
				-	1	<b>LP5-K06015eee</b>	0.530	
9	2.2	4	4	Screw clamp	1	-	<b>LP5-K0910eee</b>	0.490
					-	1	<b>LP5-K0901eee</b>	0.490
				Faston 1 x 6.35 or 2 x 2.8	1	-	<b>LP5-K09107eee</b>	0.470
					-	1	<b>LP5-K09017eee</b>	0.470
				Solder pins for printed circuit board	1	-	<b>LP5-K09105eee</b>	0.530
				-	1	<b>LP5-K09015eee</b>	0.530	

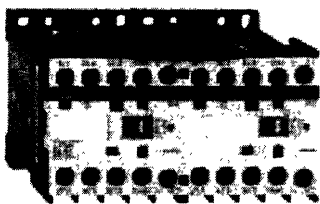

LP5-K0910eee

Non inductive loads	Type of connection	Number of poles	Instantaneous auxiliary contacts	Basic reference. Complete with code indicating control circuit voltage (2)	Weight		
Cat. AC-1 θ ≤ 50 °C Maximum current							
			N/O	N/C	kg		
20	Screw clamp	3	-	1	-	<b>LP5-K0910eee (3)</b>	0.490
		3	-	-	1	<b>LP5-K0901eee (3)</b>	0.490
	Faston 1 x 6.35 or 2 x 2.8	4	-	-	-	<b>LP5-K09004eee</b>	0.490
		3	-	1	-	<b>LP5-K09107eee</b>	0.470
		3	-	-	1	<b>LP5-K09017eee</b>	0.470
	Solder pins for printed circuit board	4	-	-	-	<b>LP5-K090047eee</b>	0.470
		3	-	1	-	<b>LP5-K09105eee</b>	0.530
		3	-	-	1	<b>LP5-K09015eee</b>	0.530
		4	-	-	-	<b>LP5-K090045eee</b>	0.530

(1) Add-on auxiliary contact blocks and accessories. see pages 1.16 and 1.17.

(2) Standard control circuit voltages (for other voltages, please consult your Regional customer centre).

Volts	12	24	48	72
Code	JW3	BW3	EW3	SW3

(3) Warning: this reversing contactor is pre-wired for reverse motor operation.

### Reversing contactors

LP5-K  
On panel  
LA1-K

On mounting rail AM1-DP200 or AM1-DE200 (35 mm)

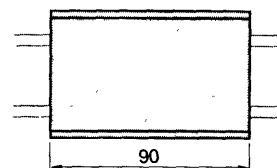
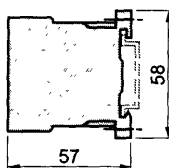
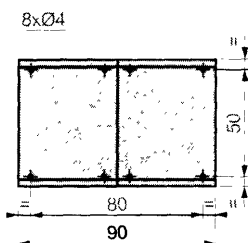
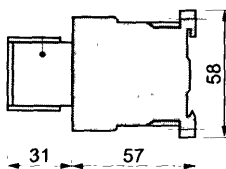

# Mini contactors

K 3 and 4-pole low consumption contactors,  
reversing and changeover contactors  
Instantaneous and time delay auxiliary contacts

## References

### Instantaneous auxiliary contact blocks

#### Clip-on front mounting, 1 block per contactor

Type of connection	Type of contactor	Composition		Reference	Weight
		N/O	N/C		
Screw clamp	3 or 4-pole	2	-	<b>LA1-KN20</b>	0.045
		-	2	<b>LA1-KN02</b>	0.045
		1	1	<b>LA1-KN11</b>	0.045
Faston 1 x 6.35 or 2 x 2.8	3 or 4-pole	2	-	<b>LA1-KN207</b>	0.045
		-	2	<b>LA1-KN027</b>	0.045
		1	1	<b>LA1-KN117</b>	0.045

### With terminal referencing conforming to standard EN 50012

#### Clip-on front mounting, 1 block per contactor

Screw clamp	3-pole, 6 and 9 A	Composition		Reference	Weight
		-	2		
		1	1	<b>LA1-KN02M</b>	0.045
				<b>LA1-KN11M</b>	0.045
	4-pole, 9 A	1	1	<b>LA1-KN11P</b>	0.045

### Electronic time delay auxiliary contact blocks

- Relay output, with common point changeover contact, 2 A maximum.
- Control voltage :  $\sim$  or  $\pm$  24...48 V,  $\sim$  110...240 V, 0.85 ..1.1 Uc.
- Maximum switching capacity : 250 VA or 150 W.
- Operating temperature : -10...+ 60 °C.
- Reset time : 1.5 s during the time delay period, 0.5 s after the time delay period.

#### Clip-on front mounting, 1 block per contactor

Voltage	Type	Timing range	Composition		Reference	Weight
			C/O			
$\sim$ or $\pm$ 24...48	On-delay	1...30	1		<b>LA2-KT2E</b>	0.040
$\sim$ 110...240	On-delay	1...30	1		<b>LA2-KT2U</b>	0.040

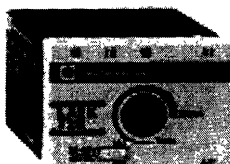

LA2-KT2●

### Electronic time delay contact blocks LA2-KT

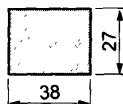
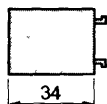

On contactor

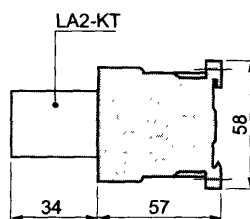

# Mini contactors

K 3 and 4-pole low consumption contactors,  
reversing and changeover contactors  
Mounting, marking and cabling accessories

## References

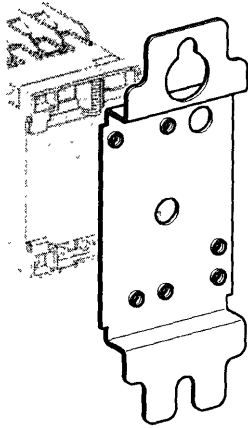

DX1-AP25

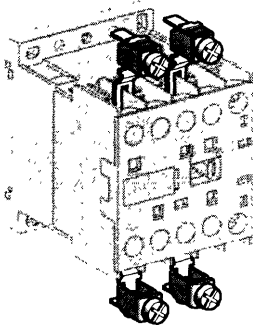

LA9-E01

## Mounting and marking accessories

Description	Application		Sold in lots of	Reference	Weight kg
<b>Mounting plates (1)</b>	For fixing on 1 rail	Clip-on	1	<b>LA9-D973</b>	0.025
	For fixing on 2 rails	110/120 mm fixing centres	1	<b>DX1-AP25</b>	0.065
<b>Marker holder</b>	Clip-on	Onto front of contactor	100	<b>LA9-D90</b>	0.001
<b>Clip-in markers</b>	4 maximum per contactor	Strips of 10 identical numbers 0...9	25	<b>AB1-Re (2)</b>	0.002
		Strips of 10 identical capital letters A...Z	25	<b>AB1-G• (2)</b>	0.002

## Cabling accessories

<b>Paralleling links</b>	For 2 poles with screw clamp terminals		4	<b>LA9-E01</b>	0.010
	For 4 poles with screw clamp terminals		2	<b>LA9-E02</b>	0.015
<b>Set of 6 power connections</b>	For 3-pole reversing contactors for motor control	For contactors with screw clamp terminals	100	<b>LA9-K0969</b>	0.010
<b>Set of 4 power connections</b>	For 4-pole changeover contactor pairs	For contactors with screw clamp terminals	100	<b>LA9-K0970</b>	0.010

(1) Order 1 mounting plate for fixing a contactor and 2 mounting plates for fixing a reversing contactor  
(2) Complete the reference by replacing the • with the required character.

On one asymmetrical rail DZ5-MB with 2 clip-on mounting plates LA9-D973 or two mounting plates DX1-AP25.  
2 x LA9-D973

2 x DX1-AP25

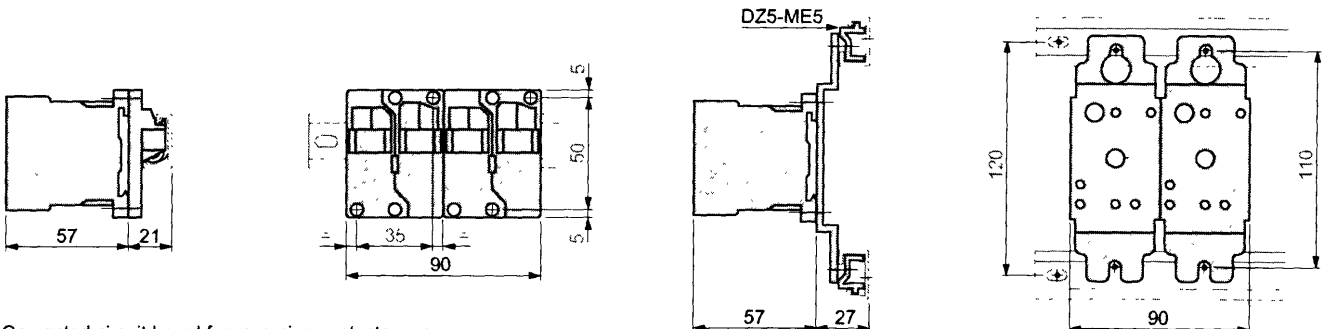

On printed circuit board for reversing contactors or 2 contactors mounted side by side

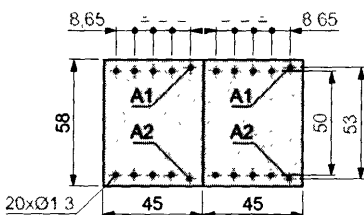



## X-ON Electronics

Largest Supplier of Electrical and Electronic Components

*Click to view similar products for [Solid State Relays - Industrial Mount](#) category:*

*Click to view products by [Schneider](#) manufacturer:*

Other Similar products are found below :

[6225XXASRS-DC3](#) [D2440-C](#) [H10CA4890](#) [D4875C](#) [D53TP50DH-10](#) [1395831-1](#) [1616010-6](#) [BR312BY](#) [A-1326](#) [AQY210SXE01](#)  
[AQY221N2SYD01](#) [AQY414SXE01](#) [26532764](#) [H10CA4850](#) [H12CA4890VL](#) [RA2410-D06](#) [D1202F](#) [D53TP50-10](#) [W230E-1-12](#) [W230T-3-](#)  
[12](#) [W6125ASX-1](#) [W6225DSX-2](#) [W6240DSX-4](#) [W6240DTX-2](#) [1-1617030-3](#) [1-1617033-9](#) [1-1617033-7](#) [MS2-D2420](#) [MS2-D2430](#) [A-1440](#)  
[4-1617080-0](#) [RJ1P60V50E](#) [RN1F48I50](#) [70.362.1028.0](#) [7-1393030-8](#) [Z5.509.0828.0](#) [W230E-2-5](#) [G3RV-SR700-D](#) [AC110](#) [G3RV-SR500-AL](#)  
[AC100](#) [G3RV-SR500-D](#) [ACDC24](#) [G3RV-SR500-AL](#) [ACDC24](#) [G3RV-SR700-D](#) [ACDC24](#) [G3RV-SR700-AL](#) [ACDC24](#) [G3RV-SR500-D](#)  
[DC12](#) [G3RV-SR700-A](#) [ACDC24](#) [G3RV-SR500-A](#) [ACDC24](#) [2912138](#) [2912141](#) [SSRDAC10](#) [1613353](#)