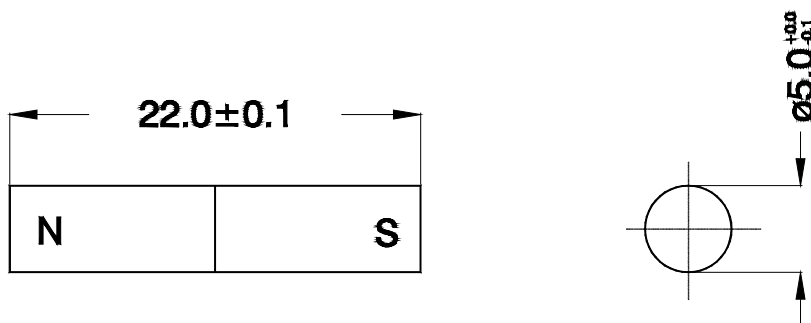

dimensions (tolerance $\pm 0,1\text{mm}$)

round bar magnet magnetization axial

AlNiCo 500 code acc. to DIN 17410 : 35 / 5

Magnetic values acc. to DIN 17410		Min.	Typ.	Max.	unit
Energy product	(B x H) max.	35	39,8	-	kJ/m^3
Remanence	B_r	1120	1240	-	mT
revers. temp. coeff. of B_r		-	-0,02%	-	%/K
Coercivity	H_{cB}	47,0	51,3	-	kA/m
Coercivity	H_{cJ}	48,0	51,7	-	kA/m
revers. temp. coeff. of H_{cJ}		-	-	-	%/K
Density		-	7,4	-	g/cm^3
max. working temperature		-	-	450	$^{\circ}\text{C}$

Remark : all details correspond to manufacturers information

X-ON Electronics

Largest Supplier of Electrical and Electronic Components

Click to view similar products for [standexmeder](#) manufacturer:

Other Similar products are found below :

[HE12-1A69-02](#) [MK18-B-500W](#) [DIP05-1A72-12L](#) [CRF05-1AS](#) [HE06-1B83-150](#) [HE24-1A83](#) [SHV12-1A85-78L3K](#) [SIL05-1A72-71QHR](#)
[NDFEB 8X15MM](#) [BE12-2A85-BV420](#) [KT12-1A-BV88589](#) [MK04-1A66B-500W](#) [DIP05-1A72-13L](#) [HM24-1A69-20-6](#) [HM12-1A83-06-UL](#)
[MS05-1A87-75DHR](#) [H12-1B83](#) [KT12-1A-40L-THT](#) [SIL05-1A31-71L](#) [LI05-1A85](#) [NDFEB 10X5X1.9MM](#) [LS01-1A66-PP-500W](#) [M11/M8](#)
[LS02-1A66-PP-500W](#) [NDFEB N35 4X2MM](#) [HM24-1A69-300](#) [LS02-1A66-PA-500W](#) [KT05-1A-40L-THT](#) [MK21M-1A66C-500W](#) [DIP24-](#)
[1C90-51D](#) [SIL24-1A75-71L](#) [DIP12-1A72-12L](#) [ORD211-1015](#) [DIP12-2A72-21L](#) [H24-1A83](#) [MK17-C-3](#) [SHV12-1A85-78L4K](#) [DIP05-1C90-](#)
[51D](#) [ALNICO500; 10X40MM](#) [HE24-1A83-02](#) [MK02/0-1A66-1000W](#) [DIL05-2C90-63L](#) [DIP24-1A72-12L](#) [HM24-1A69-06](#) [HE06-1A16](#)
[DIP24-1A31-16D](#) [MK03-1A66E-500W](#) [LS01-1A66-PA-500W](#) [ORD228VL-2030](#) [DIP05-1C90-51L](#)