

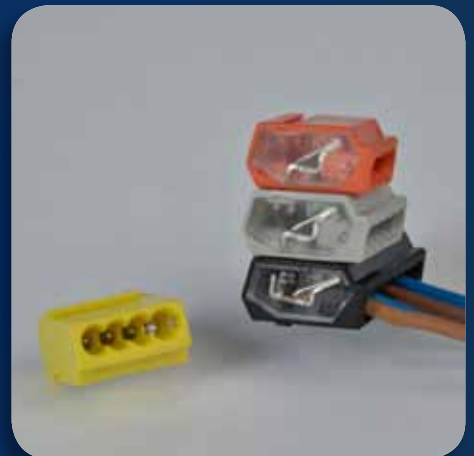

**MAKING THE RIGHT CONNECTIONS**



Product **Catalogue**



MAKING THE **RIGHT** CONNECTIONS

# Contents

## Control Stations & Enclosures



<b>Control Stations</b>	<b>P6-7</b>
Single Control Stations	P6
2 Switch Control Stations	P6-7
Accessories	P7



<b>22mm Switches &amp; Pilot Lamps</b>	<b>P8-9</b>
--	-------------



<b>DE Enclosures - Hole</b>	<b>P10-13</b>
Accessories	P12-13



<b>DE Enclosures - No Hole</b>	<b>P14-16</b>
Accessories	P16



<b>Door Enclosures</b>	<b>P17</b>
------------------------	------------

## Weatherproof



<b>IP68 TeeTube</b>	<b>P18-19</b>
---------------------	---------------

<b>TeePlugs</b>	<b>P20-23</b>
-----------------	---------------

<b>TeeBox</b>	<b>P24-27</b>
Power Distribution Unit	P26-27

<b>TeeBlock</b>	<b>P28-29</b>
-----------------	---------------

<b>TeeDrum</b>	<b>P30-31</b>
----------------	---------------

<b>Weatherproof Range Accessories</b>	<b>P32</b>
---------------------------------------	------------

<b>IP68 Gel Filled Containers</b>	<b>P33</b>
-----------------------------------	------------

# Control Stations



## Features:

- Insulation resistance - >100MΩ @ 500VDC
- Enclosures sealed upto IP66
- Unique snap on Din Rail and Flange brackets
- Dust & waterproof for short-term submersion
- 4 sizes available! Accepting 1-4 push button switches
- 2 contact blocks fitted as standard
- Different voltage ratings are available
- Contact material - Silver Bifurcated and serrated
- Operating Temperature -10 to +65degC
- Contact rating - AC12 Resistive / AC15 Electromagnetic - 240V (3A) / 415V (1.5A)
- Mechanical life - 1 million operations

## Single Control Stations

### Emergency Stop



Product Code	IP Rating	Colour (Cover / Base)	Material	H (mm)	W (mm)	D (mm)	Description
1DE.01.01AG	IP56	Yellow / Grey	ABS-UL94-HB	80	73	53*	Emergency Stop' EN418 fail safe, twist to release
1DE.01.01AB	IP56	Yellow / Black	ABS-UL94-HB	80	73	53*	Emergency Stop' EN418 fail safe, twist to release



### Emergency Stop Key

1DE.01.03AG	IP56	Yellow / Grey	ABS-UL94-HB	80	73	53*	Emergency Stop' EN418 fail safe, key release
1DE.01.03AB	IP56	Yellow / Black	ABS-UL94-HB	80	73	53*	Emergency Stop' EN418 fail safe, key release



### Push Button

75.024 mm	IP66	Grey / Black	ABS-UL94-HB	80	73	53*	Single 'Stop' push button, Red actuator
1DE.01.04AG	IP66	Grey / Grey	ABS-UL94-HB	80	73	53*	Single 'Stop' push button, Red actuator
1DE.01.06AB	IP66	Grey / Black	ABS-UL94-HB	80	73	53*	Single 'Start' push button, Green actuator
1DE.01.06AG	IP66	Grey / Grey	ABS-UL94-HB	80	73	53*	Single 'Start' push button, Green actuator



### Selector / Key Switch

1DE.01.08AB	IP56	Grey / Black	ABS-UL94-HB	80	73	53*	2-Position Selector Switch
1DE.01.08AG	IP56	Grey / Grey	ABS-UL94-HB	80	73	53*	2-Position Selector Switch
1DE.01.09AB	IP56	Grey / Black	ABS-UL94-HB	80	73	53*	2-Position Key Switch
1DE.01.09AG	IP56	Grey / Grey	ABS-UL94-HB	80	73	53*	2-Position Key Switch



### Double Push Button

1DE.01.10AB	IP56	Grey / Black	ABS-UL94-HB	80	73	53*	Double push button - Stop / Start (O/I)
1DE.01.10AG	IP56	Grey / Grey	ABS-UL94-HB	80	73	53*	Double push button - Stop / Start (O/I)



### Palm / Foot Switch

1DE.SP.21NR	IP66	Grey / Black	ABS-UL94-HB	85	85	102**	Palm / Foot push button Red button
1DE.SP.21NG	IP66	Grey / Black	ABS-UL94-HB	85	85	102**	Palm / Foot push button Green button
1DE.SP.21NB	IP66	Grey / Black	ABS-UL94-HB	85	85	102**	Palm / Foot push button Black button

## 2 Switch Control Stations

### Emergency Stop & 1 Push Button



1DE.02.01AG	IP56	Grey / Grey	ABS-UL94-HB	80	106	53	Emergency Stop' EN418 fail safe, twist to release. Single 'Start' push button, Green actuator.
1DE.02.01AB	IP56	Grey / Black	ABS-UL94-HB	80	106	53	Emergency Stop' EN418 fail safe, twist to release. Single 'Start' push button, Green actuator.

\*Enclosure dimensions \*\*Including Actuator

# 22mm Switches & Pilot Lamps



## 22mm LED Pilot Lamps



Product Code	Suffix x	Suffix y	IP Rating	Colour	Description
DLD22-xy	x = (R)ed (G)reen (Y)ellow (W)hite (S)Blue	y = Lamp Volt (A)AC/DC 24V (E)AC/DC 110V (I)AC/DC 240V	IP66	Red / Green / Yellow / White / Blue	Mono block, flush head
DPL22-xy			IP66	Red / Green / Yellow / White / Blue	Round head, complete with BA9 LED lamp

## 22mm Push Buttons - Non Illuminated



DPB22-D11x	x = (R)ed (G)reen (Y)ellow (B)lack (W)hite (S)Blue	N/A	IP56	Red / Green	Double, momentary action
DPB22-E11 x		N/A	IP66	Red / Green / Yellow / Black / White / Blue	Momentary, elevated head
DPB22-F11x		N/A	IP66	Red / Green / Yellow / Black / White / Blue	Momentary, flush head
DPB22-H11x		N/A	IP56	Red	'E-Stop' Push / Pull, twist to release, EN418 fail safe, 40mm mushroom head
DPB22-K11x		N/A	IP56	Red	'E-Stop', key to release, EN418 fail safe, 40mm mushroom head
DPB22-L11x		N/A	IP66	Red / Green / Yellow / Black / White / Blue	Latching, flush head
DPB22-M11x		N/A	IP56	Red / Green / Yellow	Momentary, 40mm mushroom head
DPB22-P11x		N/A	IP66	Red / Green / Yellow / White / Blue	Latching, elevated head
DPB22-R11x		N/A	IP56	Red	'E-Stop', twist to release, EN418 fail safe, 40mm mushroom head
DPB22-S11x		N/A	IP56	Red	'E-Stop' Push / Pull, twist to release, EN418 fail safe, 35mm mushroom head

## 22mm Push Buttons - LED Illuminated



DLB22-D11xy	x = (R)ed (G)reen (Y)ellow (W)hite	y = Lamp Volt (A)AC/DC 24V (E)AC/DC 110V (I)AC/DC 240V	IP56	Red / Green	Double, momentary action
DLB22-E11 xy			IP66	Red / Green / Yellow / White	Momentary, elevated head
DLB22-F11xy			IP66	Red / Green / Yellow / White	Momentary, flush head
DLB22-L11xy			IP66	Red / Green / Yellow / White	Latching, flush head
DLB22-M11xy			IP56	Red / Green / Yellow	Momentary, 40mm mushroom head
DLB22-P11xy			IP66	Red / Green / Yellow / White	Latching, elevated head
DLB22-R11xy			IP56	Red	'E-Stop', EN418 fail safe, 40mm mushroom head

## Other Switch Styles Available

### 22mm Selector / Key Switch - LED Illuminated



- IP56
- Selector switch
- Normal shaft size
- 2 & 3 position



- IP56
- Selector switch
- Long shaft size
- 2 positions



- IP56
- Selector switch
- Long shaft size
- 3 positions

# DE Enclosures - Hole

A range of enclosures supplied complete with 22mm holes for fitting of switches/indicators

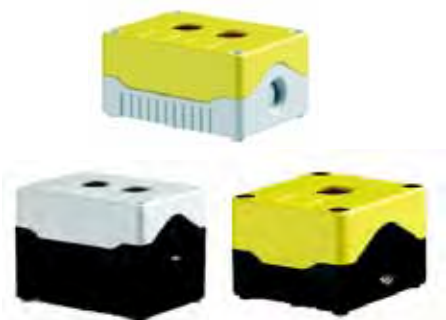

### Features of Range:

- Complete with M20 cable knockouts
- 4 sizes available in Standard and deep base
- Also available in ABS-UL94 and Polycarbonate
- Unique snap-on DIN rail and flange brackets available
- Sealed to IP67
- Suitable for mounting control switches or enclosing printed circuit boards
- Captive plastic screws in lid

### DE01 Enclosure With 1 x 22mm Hole



Product Code	IP rating	Colour (Cover / Base)	Material	Size	H (mm)	W (mm)	D (mm)	Temp Rating	Description
DE01S-A-BB-1	IP67	Black / Black	ABS-UL94-HB	DE01S	80	73	53	-10c to +65c	
DE01S-A-GG-1	IP67	Grey / Grey	ABS-UL94-HB	DE01S	80	73	53	-10c to +65c	
DE01S-A-BG-1	IP67	Black /Grey	ABS-UL94-HB	DE01S	80	73	53	-10c to +65c	
DE01S-A-GB-1	IP67	Grey/ Black	ABS-UL94-HB	DE01S	80	73	53	-10c to +65c	
DE01S-A-YB-1	IP67	Yellow/ Black	ABS-UL94-HB	DE01S	80	73	53	-10c to +65c	
DE01S-A-YG-1	IP67	Yellow/ Grey	ABS-UL94-HB	DE01S	80	73	53	-10c to +65c	
DE01S-P-BB-1	IP67	Black/ Black	Polycarbonate	DE01S	80	73	53	-10c to +65c	
DE01S-P-GG-1	IP67	Grey/ Grey	Polycarbonate	DE01S	80	73	53	-10c to +65c	
DE01S-A-BG-1	IP67	Black /Grey	Polycarbonate	DE01S	80	73	53	-10c to +65c	
DE01S-A-GB-1	IP67	Grey/ Black	Polycarbonate	DE01S	80	73	53	-10c to +65c	
DE01S-P-YB-1	IP67	Yellow/ Black	Polycarbonate	DE01S	80	73	53	-10c to +65c	
DE01S-P-YG-1	IP67	Yellow/ Grey	Polycarbonate	DE01S	80	73	53	-10c to +65c	

### DE01 Deep Base - 78mm



DE01D-A-BB-1	IP67	Black/ Black	ABS-UL94-HB	DE01D	80	73	78	-10c to +65c	
DE01D-A-GG-1	IP67	Grey/ Grey	ABS-UL94-HB	DE01D	80	73	78	-10c to +65c	
DE01D-A-BG-1	IP67	Black /Grey	ABS-UL94-HB	DE01D	80	73	78	-10c to +65c	
DE01D-A-GB-1	IP67	Grey/ Black	ABS-UL94-HB	DE01D	80	73	78	-10c to +65c	
DE01D-A-YB-1	IP67	Yellow/ Black	ABS-UL94-HB	DE01D	80	73	78	-10c to +65c	
DE01D-A-YG-1	IP67	Yellow/ Grey	ABS-UL94-HB	DE01D	80	73	78	-10c to +65c	
DE01D-P-BB-1	IP67	Black/ Black	Polycarbonate	DE01D	80	73	78	-10c to +65c	
DE01D-P-GG-1	IP67	Grey/ Grey	Polycarbonate	DE01D	80	73	78	-10c to +65c	
DE01D-A-BG-1	IP67	Black /Grey	Polycarbonate	DE01D	80	73	78	-10c to +65c	
DE01D-A-GB-1	IP67	Grey/ Black	Polycarbonate	DE01D	80	73	78	-10c to +65c	
DE01D-P-YB-1	IP67	Yellow/ Black	Polycarbonate	DE01D	80	73	78	-10c to +65c	
DE01D-P-YG-1	IP67	Yellow/ Grey	Polycarbonate	DE01D	80	73	78	-10c to +65c	

### DE02 Enclosure with 2x22mm Hole

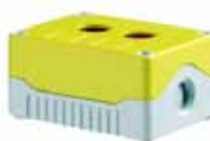

DE02S-A-BB-2	IP67	Black/ Black	ABS-UL94-HB	DE02S	80	106	53	-10c to +65c	
DE02S-A-GG-2	IP67	Grey/ Grey	ABS-UL94-HB	DE02S	80	106	53	-10c to +65c	
DE02S-A-BG-2	IP67	Black /Grey	ABS-UL94-HB	DE02S	80	106	53	-10c to +65c	
DE02S-A-GB-2	IP67	Grey/ Black	ABS-UL94-HB	DE02S	80	106	53	-10c to +65c	
DE02S-A-YB-2	IP67	Yellow/ Black	ABS-UL94-HB	DE02S	80	106	53	-10c to +65c	
DE02S-A-YG-2	IP67	Yellow/ Grey	ABS-UL94-HB	DE02S	80	106	53	-10c to +65c	
DE02S-P-BB-2	IP67	Black/ Black	Polycarbonate	DE02S	80	106	53	-10c to +65c	
DE02S-P-GG-2	IP67	Grey/ Grey	Polycarbonate	DE02S	80	106	53	-10c to +65c	
DE02S-A-BG-2	IP67	Black /Grey	Polycarbonate	DE02S	80	106	53	-10c to +65c	
DE02S-A-GB-2	IP67	Grey/ Black	Polycarbonate	DE02S	80	106	53	-10c to +65c	
DE02S-P-YB-2	IP67	Yellow/ Black	Polycarbonate	DE02S	80	106	53	-10c to +65c	
DE02S-P-YG-2	IP67	Yellow/ Grey	Polycarbonate	DE02S	80	106	53	-10c to +65c	

# DE Enclosures - Hole

## DE04 Enclosures with 4x22mm Hole



Product Code	IP rating	Colour (Cover / Base)	Material	Size	H (mm)	W (mm)	D (mm)	Temp Rating	Description
DE04S-A-BB-4	IP67	Black/ Black	ABS-UL94-HB	DE04S	80	172	53	-10c to +65c	
DE04S-A-GG-4	IP67	Grey/ Grey	ABS-UL94-HB	DE04S	80	172	53	-10c to +65c	
DE04S-A-BG-4	IP67	Black /Grey	ABS-UL94-HB	DE04S	80	172	53	-10c to +65c	
DE04S-A-GB-4	IP67	Grey/ Black	ABS-UL94-HB	DE04S	80	172	53	-10c to +65c	
DE04S-A-YB-4	IP67	Yellow/ Black	ABS-UL94-HB	DE04S	80	172	53	-10c to +65c	
DE04S-A-YG-4	IP67	Yellow/ Grey	ABS-UL94-HB	DE04S	80	172	53	-10c to +65c	
DE04S-P-BB-4	IP67	Black/ Black	Polycarbonate	DE04S	80	172	53	-10c to +65c	
DE04S-P-GG-4	IP67	Grey/ Grey	Polycarbonate	DE04S	80	172	53	-10c to +65c	
DE04S-A-BG-4	IP67	Black /Grey	Polycarbonate	DE04S	80	172	53	-10c to +65c	
DE04S-A-GB-4	IP67	Grey/ Black	Polycarbonate	DE04S	80	172	53	-10c to +65c	
DE04S-P-YB-4	IP67	Yellow/ Black	Polycarbonate	DE04S	80	172	53	-10c to +65c	
DE04S-P-YG-4	IP67	Yellow/ Grey	Polycarbonate	DE04S	80	172	53	-10c to +65c	

## DE04 Deep Base - 78mm



DE04D-A-BB-4	IP67	Black/ Black	ABS-UL94-HB	DE04D	80	172	78	-10c to +65c	
DE04D-A-GG-4	IP67	Grey/ Grey	ABS-UL94-HB	DE04D	80	172	78	-10c to +65c	
DE04D-A-BG-4	IP67	Black /Grey	ABS-UL94-HB	DE04D	80	172	78	-10c to +65c	
DE04D-A-GB-4	IP67	Grey/ Black	ABS-UL94-HB	DE04D	80	172	78	-10c to +65c	
DE04D-A-YB-4	IP67	Yellow/ Black	ABS-UL94-HB	DE04D	80	172	78	-10c to +65c	
DE04D-A-YG-4	IP67	Yellow/ Grey	ABS-UL94-HB	DE04D	80	172	78	-10c to +65c	
DE04D-P-BB-4	IP67	Black/ Black	Polycarbonate	DE04D	80	172	78	-10c to +65c	
DE04D-P-GG-4	IP67	Grey/ Grey	Polycarbonate	DE04D	80	172	78	-10c to +65c	
DE04D-A-BG-4	IP67	Black /Grey	Polycarbonate	DE04D	80	172	78	-10c to +65c	
DE04D-A-GB-4	IP67	Grey/ Black	Polycarbonate	DE04D	80	172	78	-10c to +65c	
DE04D-P-YB-4	IP67	Yellow/ Black	Polycarbonate	DE04D	80	172	78	-10c to +65c	
DE04D-P-YG-4	IP67	Yellow/ Grey	Polycarbonate	DE04D	80	172	78	-10c to +65c	

## Accessories

### Cable Glands - Grey



DECGG	IP68	RAL7035	Polyamide 6	M20	39.2	10	3.5 to 8	-40C TO + 100C	Fits all sizes of enclosures, m20 x 1.5Mm thread glands
-------	------	---------	-------------	-----	------	----	----------	----------------	---

### Cable Glands - Black

DECGB	IP68	RAL9005	Polyamide 6	M20	39.2	10	3.5 to 8	-40C TO + 100C	Fits all sizes of enclosures, m20 x 1.5Mm thread glands
-------	------	---------	-------------	-----	------	----	----------	----------------	---

### DIN Rail Clip



DEDDB	N/A	Black	PA66 UL94-V0 Flame Retardant	N/A	N/A	N/A	N/A	N/A	Snap-On combi foot din rail mounting bracket in black pa66 fits de01-de06
DEDG	N/A	Grey	PA66 UL94-V0 Flame Retardant	N/A	N/A	N/A	N/A	N/A	Snap-On combi foot din rail mounting bracket in grey pa66 fits de01-de06

### Flange Bracket



DEFB	N/A	Black	PA66 UL94-V0 Flame Retardant	N/A	N/A	N/A	N/A	N/A	Snap-On mounting bracket in black PA66 fits DE01-DE06 2x M3 fixing holes
DEFG	N/A	Grey	PA66 UL94-V0 Flame Retardant	N/A	N/A	N/A	N/A	N/A	Snap-On mounting bracket in grey PA66 fits DE01-DE06 2x M3 fixing holes

# DE Enclosures - No Hole



## DE Enclosure Features:

- 4 sizes available - standard & deep base
- Sealed to IP67
- Complete with M20 cable knockouts
- Captive plastic screws in lid
- Available in standard and deep base
- Suitable for enclosing printed circuit boards
- Unique snap-on DIN rail and flange brackets available
- Also available in ABS-UL94 and Polycarbonate
- Temperature rating of -10° to +65°

### DE01 Enclosure Standard Base - 53mm



Product Code	IP Rating	Colour	Material	Size	H (mm)	W (mm)	D (mm)	Temp Rating
DE01S-A-BB-0	IP67	Black / Black	ABS-UL94-HB	DE01S	80	73	53	-10c to +65c
DE01S-A-GG-0	IP67	Grey / Grey	ABS-UL94-HB	DE01S	80	73	53	-10c to +65c
DE01S-A-BG-0	IP67	Black /Grey	ABS-UL94-HB	DE01S	80	73	53	-10c to +65c
DE01S-A-GB-0	IP67	Grey/ Black	ABS-UL94-HB	DE01S	80	73	53	-10c to +65c
DE01S-A-TB-0	IP67	Transparent/ Black	ABS-UL94-HB	DE01S	80	73	53	-10c to +65c
DE01S-A-TG-0	IP67	Transparent/ Grey	ABS-UL94-HB	DE01S	80	73	53	-10c to +65c
DE01S-P-BB-0	IP67	Black/ Black	Polycarbonate	DE01S	80	73	53	-10c to +65c
DE01S-P-GG-0	IP67	Grey/ Grey	Polycarbonate	DE01S	80	73	53	-10c to +65c
DE01S-A-BG-0	IP67	Black /Grey	Polycarbonate	DE01S	80	73	53	-10c to +65c
DE01S-A-GB-0	IP67	Grey/ Black	Polycarbonate	DE01S	80	73	53	-10c to +65c
DE01S-P-TB-0	IP67	Transparent/ Black	Polycarbonate	DE01S	80	73	53	-10c to +65c
DE01S-P-TG-0	IP67	Transparent/ Grey	Polycarbonate	DE01S	80	73	53	-10c to +65c

### DE01 Deep Base - 78mm



DE01D-A-BB-0	IP67	Black/ Black	ABS-UL94-HB	DE01D	80	73	78	-10c to +65c
DE01D-A-GG-0	IP67	Grey/ Grey	ABS-UL94-HB	DE01D	80	73	78	-10c to +65c
DE01D-A-BG-0	IP67	Black /Grey	ABS-UL94-HB	DE01D	80	73	78	-10c to +65c
DE01D-A-GB-0	IP67	Grey/ Black	ABS-UL94-HB	DE01D	80	73	78	-10c to +65c
DE01D-A-TB-0	IP67	Transparent/ Black	ABS-UL94-HB	DE01D	80	73	78	-10c to +65c
DE01D-A-TG-0	IP67	Transparent/ Grey	ABS-UL94-HB	DE01D	80	73	78	-10c to +65c
DE01D-P-BB-0	IP67	Black/ Black	Polycarbonate	DE01D	80	73	78	-10c to +65c
DE01D-P-GG-0	IP67	Grey/ Grey	Polycarbonate	DE01D	80	73	78	-10c to +65c
DE01D-A-BG-0	IP67	Black /Grey	Polycarbonate	DE01D	80	73	78	-10c to +65c
DE01D-A-GB-0	IP67	Grey/ Black	Polycarbonate	DE01D	80	73	78	-10c to +65c
DE01D-P-TB-0	IP67	Transparent/ Black	Polycarbonate	DE01D	80	73	78	-10c to +65c
DE01D-P-TG-0	IP67	Transparent/ Grey	Polycarbonate	DE01D	80	73	78	-10c to +65c

### DE02 Enclosure Standard Base 53mm



DE02S-A-BB-0	IP67	Black/ Black	ABS-UL94-HB	DE02S	80	106	53	-10c to +65c
DE02S-A-GG-0	IP67	Grey/ Grey	ABS-UL94-HB	DE02S	80	106	53	-10c to +65c
DE02S-A-BG-0	IP67	Black /Grey	ABS-UL94-HB	DE02S	80	106	53	-10c to +65c
DE02S-A-GB-0	IP67	Grey/ Black	ABS-UL94-HB	DE02S	80	106	53	-10c to +65c
DE02S-A-TB-0	IP67	Transparent/ Black	ABS-UL94-HB	DE02S	80	106	53	-10c to +65c
DE02S-A-TG-0	IP67	Transparent/ Grey	ABS-UL94-HB	DE02S	80	106	53	-10c to +65c
DE02S-P-BB-0	IP67	Black/ Black	Polycarbonate	DE02S	80	106	53	-10c to +65c
DE02S-P-GG-0	IP67	Grey/ Grey	Polycarbonate	DE02S	80	106	53	-10c to +65c
DE02S-A-BG-0	IP67	Black /Grey	Polycarbonate	DE02S	80	106	53	-10c to +65c
DE02S-A-GB-0	IP67	Grey/ Black	Polycarbonate	DE02S	80	106	53	-10c to +65c
DE02S-P-TB-0	IP67	Transparent/ Black	Polycarbonate	DE02S	80	106	53	-10c to +65c
DE02S-P-TG-0	IP67	Transparent/ Grey	Polycarbonate	DE02S	80	106	53	-10c to +65c



# DE Enclosures - No Hole

## Deep Base - 78mm



Product Code	IP Rating	Colour	Material	Size	H (mm)	W (mm)	D (mm)	Temp Rating	Description
DE04D-A-BB-0	IP67	Black/ Black	ABS-UL94-HB	DE04D	80	172	78		
DE04D-A-GG-0	IP67	Grey/ Grey	ABS-UL94-HB	DE04D	80	172	78		
DE04D-A-BG-0	IP67	Black /Grey	ABS-UL94-HB	DE04D	80	172	78		
DE04D-A-GB-0	IP67	Grey/ Black	ABS-UL94-HB	DE04D	80	172	78		
DE04D-A-TB-0	IP67	Transparent/ Black	ABS-UL94-HB	DE04D	80	172	78		
DE04D-A-TG-0	IP67	Transparent/ Grey	ABS-UL94-HB	DE04D	80	172	78		
DE04D-P-BB-0	IP67	Black/ Black	Polycarbonate	DE04D	80	172	78		
DE04D-P-GG-0	IP67	Grey/ Grey	Polycarbonate	DE04D	80	172	78		
DE04D-A-BG-0	IP67	Black /Grey	Polycarbonate	DE04D	80	172	78		
DE04D-A-GB-0	IP67	Grey/ Black	Polycarbonate	DE04D	80	172	78		
DE04D-P-TB-0	IP67	Transparent/ Black	Polycarbonate	DE04D	80	172	78		
DE04D-P-TG-0	IP67	Transparent/ Grey	Polycarbonate	DE04D	80	172	78		



## Accessories

### Cable Glands - Grey

DECGG	IP68	RAL7035	Polyamide 6	M20	39.2	10	3.5 to 8	-40C TO + 100C	Fits all sizes of enclosures, m20 x 1.5mm thread glands
-------	------	---------	-------------	-----	------	----	----------	----------------	---

### Cable Glands - Black

DECEB	IP68	RAL9005	Polyamide 6	M20	39.2	10	3.5 to 8	-40C TO + 100C	Fits all sizes of enclosures, m20 x 1.5mm thread glands
-------	------	---------	-------------	-----	------	----	----------	----------------	---



### DIN Rail Clip

DEDB	N/A	Black	PA66 UL94-V0 Flame Retardant	N/A					Snap-On combi foot DIN rail mounting bracket in black PA66 fits DE01-DE06
DEEG	N/A	Grey	PA66 UL94-V0 Flame Retardant	N/A					Snap-On combi foot DIN rail mounting bracket in grey PA66 fits DE01-DE06



### Flange Bracket

DEFB	N/A	Black	PA66 UL94-V0 Flame Retardant	N/A					Snap-On mounting bracket in black PA66 fits DE01-DE06 2x M3 fixing holes
DEFG	N/A	Grey	PA66 UL94-V0 Flame Retardant	N/A					Snap-On mounting bracket in grey PA66 fits DE01-DE06 2x M3 fixing holes

# IP68 TeeTube



### Features:

- Tough, robust construction with large cable range acceptance
- Straight through, T splitter and Y splitter versions available
- Dual terminal versions available for easy fitting and looping of conductors (2+2 and 3+3 poles)
- Temperature rating of -20° to +125°

### Standard Series



Product Code	IP Rating	Poles	Colour	Material	Cable Entries	Insert Type	W (mm)	Dia (mm)	L (mm)
TTK20BK-SD	68 to 5Bar	3	Black	Nylon 66	2	Barrier	N/A	26.5	115
TTK20GY-SD	68 to 5Bar	3	Grey	Nylon 66	2	Barrier	N/A	26.5	115
TTK20CR-BK	68 to 5Bar	3	Clear	Polycarbonate	2	Barrier	N/A	26.5	115
TTK25BK-SD	68 to 5Bar	5	Black	Nylon 66	2	Barrier	N/A	32	130
TTK25GY-SD	68 to 5Bar	5	Grey	Nylon 66	2	Barrier	N/A	32	130

### TH390 Series



THB.390.A1B	68	2	Black	Nylon 66	2	Barrier	N/A	30	82
THB.390.A1A	68	3	Black	Nylon 66	2	Barrier	N/A	30	82
THB.390.C1B	68	2	Black	Nylon 66	3	Barrier	92	30	73
THB.390.C1A	68	3	Black	Nylon 66	3	Barrier	92	30	73

### THB.399 Long Series



THB.399.A3A	68	3	Black	Nylon 66	3	Barrier	63	33	180
THB.399.A5A	68	5	Black	Nylon 66	3	Barrier	63	33	180
THB.399.A6A	68	6	Black	Nylon 66	3	Barrier	63	33	180
THB.399.A9B	68	3 + 3	Black	Nylon 66	3	Through	63	33	180
THB.399.D3A	68	3	Black	Nylon 66	3	Barrier	63	33	180
THB.399.D5A	68	5	Black	Nylon 66	3	Barrier	63	33	180
THB.399.D6A	68	6	Black	Nylon 66	3	Barrier	63	33	180
THB.399.D9B	68	3 + 3	Black	Nylon 66	3	Through	63	33	180

### THB.399 Short Series



THB.399.E3A	68	3	Black	Nylon 66	3	Barrier	63	33	125
-------------	----	---	-------	----------	---	---------	----	----	-----

### THB.401 Series



THB.401.C1A	68	5	Black	Nylon 66	3	Barrier	92	30	121
THB.401.C1D	68	6	Black	Nylon 66	3	Barrier	92	30	121
THB.401.C2E	68	3+3	Black	Nylon 66	3	Through	92	30	121

### THB.402 Series



THB.402.C1B	68	5	Black	Nylon 66	3	Barrier	92	30	116
THB.402.C1A	68	6	Black	Nylon 66	3	Barrier	92	30	116
THB.402.C2E	68	3+3	Black	Nylon 66	3	Through	92	30	116

# Teeplugs



### Features:

- Up to IP68 versions available
- Various configurations available
- Components are keyway coded to ensure correct assembly
- All products are quick and simple to install
- Bulkhead/chassis mount options available (depending on product type)
- Temperature range of -20° to +125°
- Grey colour available on request

### TH380 Series



Product Code	Poles	IP Rating	Colour	Material	Ø (mm)	L (mm)	
THB.380.A2A	2	20	Black	Nylon 66	19	33	
THB.380.A1A	3	20	Black	Nylon 66	19	33	
THB.380.B2A	2	20	Black	Nylon 66	19	33	
THB.380.B1A	3	20	Black	Nylon 66	19	33	

### TH382 Series



THB.382.A2A	2	40	Black	Nylon 66	19	53	
THB.382.A1A	3	40	Black	Nylon 66	19	53	
THB.382.B2A	2	40	Black	Nylon 66	19	53	
THB.382.B1A	3	40	Black	Nylon 66	19	53	

### TH384 Series



THB.384.A2A	2	68	Black	Nylon 66	27	55	
THB.384.A1A	3	68	Black	Nylon 66	27	55	
THB.384.B2A	2	68	Black	Nylon 66	27	55	
THB.384.B1A	3	68	Black	Nylon 66	27	55	
THB.384.3KIT	3	68	Black	Nylon 66	27	55	



### TH385 Series - Panel Mount

THB.385.A2A	2	68	Black	Nylon 66	28	35	
THB.385.B2A	3	68	Black	Nylon 66	28	35	



### TH386 Series - Panel Mount

THB.386.A2A	2	67	Black	Nylon 66	30	35	
THB.386.B2A	3	67	Black	Nylon 66	30	35	
6DB00200C			Black	Nylon 66			
THB.386.A1A-KIT	3	67	Black	Nylon 66	30	78	

# Teeplugs



## TH405 Series

Product Code	Poles	IP Rating	Colour	Material	Ø (mm)	L (mm)	
THB.405.A2B	3	68	Black	Nylon 66	36.5	74	
THB.405.A2A	5	68	Black	Nylon 66	36.5	74	
THB.405.A2E	6	68	Black	Nylon 66	36.5	74	
THB.405.B2B	3	68	Black	Nylon 66	36.5	70	
THB.405.B2A	5	68	Black	Nylon 66	36.5	70	
THB.405.B2E	6	68	Black	Nylon 66	36.5	70	
THB.405.A2B-KIT	3	68	Black	Nylon 66	36.5	130	
THB.405.RPKIT	5	68	Black	Nylon 66	36.5	130	
600012200	3						
600009600	5						
6DB00750C	6		Black	Nylon 66			

## TH406 Series - Panel Mount

THB.406.A1B	3	68	Black	Nylon 66	39.5	40	
THB.406.A1A	5	68	Black	Nylon 66	39.5	40	
THB.406.A1E	6	68	Black	Nylon 66	39.5	40	



# TeeBox



### Features:

- Comprehensive range of connection options
- Protection rating up to IP68 depending on product
- Unique 3 pole T connector TH029 available for use in TH209 & TH211 range, no cable forming required
- TH211 available as full KIT version complete with TH029 fitted
- Power distribution products available in 3 port (TH630) and 4 port (TH62) versions
- Temperature range of  $-20^{\circ}$  to  $+125^{\circ}$

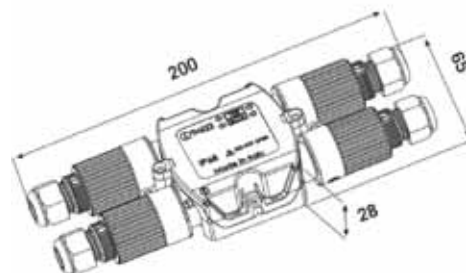

### TH110 Series



Product Code	IP Rating	Poles	Colour	Material	Cable Entries	Insert Type	H (mm)	W (mm)	L (mm)
THB.110.C3B	44	3	Natural	Nylon 66	2	Through	12.5	27	75
THB.110.C6B	44	3	Natural	Nylon 66	2	Wire Protected	11.5	27	75

### TH112 Series



THP.112.A3A	54	3	Black	Nylon 66	2	Insulation piercing screw and crimp	12.6	21.2	46.3
6000287CA			Natural	Nylon 66	2		17	36	75

### TH200 Series



THK.200.C2E	67	3	Black	Nylon 66	3	Barrier	20	41	82
-------------	----	---	-------	----------	---	---------	----	----	----

### TH209 Series

THA.209.A1B	54		Black	Nylon 66	4		28	65	108
THA.209.A1A	68		Black	Nylon 66	4		28	65	108
THA.209.A1A8PKIT	68	8	Black	Nylon 66	4	Barrier	28	65	108
THA.209.D1B	54		Black	Nylon 66	3		28	65	108
THA.209.D1A	68		Black	Nylon 66	3		28	65	108



# TeeBox



## TH211 Series

Product Code	IP Rating	Poles	Colour	Material	Cable Entries	Insert Type	H (mm)	W (mm)	L (mm)	
THA.211.A1B	54		Black	Nylon 66	3		36	118	137	
THA.211.A1A	65		Black	Nylon 66	3		36	118	137	
THA.211.A1A3PTK	68	3	Black	Nylon 66	3	Barrier	36	118	137	
THA.211.D1B	54		Black	Nylon 66	3		36	118	137	
THA.211.D1A	65		Black	Nylon 66	3		36	118	137	

## Power Distribution Units



## THH.622 Series

THH.622.L3A.AG	68	3	Black	Nylon 66	4		28	65	200	
THH.622.C3A.AG	54	3	Black	Nylon 66	4		28	65	200	



## THH.630 Series

THH.630.A3A.AG	54	3	Black	Nylon 66	3		43	99	118	
THH.630.A3A.AG	54	5	Black	Nylon 66	3		43	99	118	
THH.630.A3A.AG	54	6	Black	Nylon 66	3		43	99	118	
THH.630.A3A.AG	65	3	Black	Nylon 66	3		43	99	118	
THH.630.A3A.AG	65	5	Black	Nylon 66	3		43	99	118	
THH.630.A3A.AG	65	6	Black	Nylon 66	3		43	99	118	



# TeeBlock



### Features:

- Unique T style connector TH029 saves installation time and effort
- Range includes insulation piercing options
- Large conductor size capability with rising clamp fitting of TH027 enables easier installation
- The 3 and 5 pole options of TH026 gives flexibility of configuration when used with the Teebox
- TH032, 4+4 terminals colour for LED applications



TH026 Style PA66 FV V0 125°C

Product Code	Poles	Colour	Material	H (mm)	W (mm)	L (mm)	Insert Type
THB.026.A1A	5	Brown	Nylon 66	16.4	20.6	32	Through
THB.026.A2A	5	Brown	Nylon 66	16.4	20.6	32	Wire Protected
THB.026.B1A	3	Brown	Nylon 66	16.4	20.6	21	Through
THB.026.B2A	3	Brown	Nylon 66	16.4	20.6	21	Wire Protected



TH027 Style PA66GF V0 125°C

THB.027.A1A	3	Brown	Nylon 66GF	16	29	43.5	Rising Clamp
-------------	---	-------	------------	----	----	------	--------------



TH029 T Style PA66FV V0 125°C

THB.029.A1A	3	Brown	Nylon 66	15.8	20.6	38.5	Barrier
-------------	---	-------	----------	------	------	------	---------



TH032 Style PA66GF V0 125°C

THB.032.A4B	4+4	Brown	Nylon 66GF	21	20.8	50.7	Barrier
THP.032.A4B	4+4	Brown	Nylon 66GF	21	20.8	50.7	Insulation piercing screw & barrier



TH033 Style PA66GF V0 125°C

THB.033.A4A	4	Brown	Nylon 66GF	See Line Diagrams for details	Through	
THB.033.A4C	4	Brown	Nylon 66GF		Wire Protected	
THP.033.A4A	4	Brown	Nylon 66GF		Insulation piercing screw & barrier	

# TeeDrum



**Features:**

- The TeeDrum solution can be used as a stand alone connectors or installed in teetube
- TeeDrum solutions have been designed to guarantee safety and reliability of the connections
- The combination of the TeeDrum & teetube solution offers protection upto IP68
- TH021 is finger safe

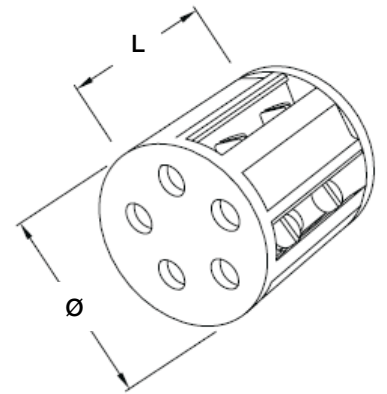

Finger Safe



**TeeDrum - Semi Housed**

Product Code	IP Rating	Poles	Colour	Material	Ø (mm)	L (mm)	Insert Type
THB.021.C1A	20	2	Black / Brown	Nylon 66	22	26	Barrier
THB.021.A1A	20	3	Black	Nylon 66	22	26	Barrier
THB.021.B1A	20	5	Black	Nylon 66	26	26	Barrier



**TeeDrum**

THB.020.A1A	00	3	Black	Nylon 66	18	26	Barrier
THB.020.B1A	00	5	Black	Nylon 66	22	26	Barrier
THD.020.D1A	00	6	Brown	Nylon 66	22	26	Barrier
THB.020.C2A	00	3+3	Brown	Nylon 66	22	26	Through

**TeeDrum - Semi Housed Mounting Rails**

6000048KC							
6000047KC							



# Weatherproof Range Accessories



## Weatherproof Range Accessories

Product Code	Suitable for product types	Poles	Description
600009600	TH405		5 pole assembly tool
600012200	TH405		3 pole assembly tool
6DB00200C	TH384, TH385, TH386*		Dust Cap c/w silicon strap. *Also acts as a locking tool for TH386, Black
6DB00750C	TH405		Combined 6 pole assy tool and cap
6000194CC	TH209 and TH211		Support plate for use with terminal blocks TH026 or TH027 when mounted in these junction boxes
6000183C	TH384, TH385, TH386		Dust cap only
6DB0900C	TH405, TH406		Dust cap complete with silicon belt
6000069CC	TH405, TH406		Dust cap only

## Alternative Inserts For Use With Tee Products

6DB000800			Double Yellow seal, cable range 5-13.5mm dia
64001800			Yellow seal, cable range 9-13.5mm dia
6000087LF	Not for use with TH110, TH112 TH200, TH382 TH384, TH385 TH386, TH388		Reducing insert cap, Hole dia 9mm
600012500			2 Hole Insert, 3.5mm dia
600012600			3 Hole Insert, 3.5mm dia
600018200			4 Hole Insert, 3.5mm dia
60013700			Blind insert
6000086MH		TH384, TH385, TH386	
6000085MM	TH384, TH385, TH386		Blue Seal single hole for cable dia 6-7.5mm
6000084MG	TH384, TH385, TH386		Yellow Seal single hole for cable dia 7.5-9.5mm
6000091MA	TH384, TH385, TH386		White Seal blanking plug
6000114MA	TH384, TH385, TH386		White Seal 2 hole dia 2mm
6000089MA	TH384, TH385, TH386		White Seal 2 hole dia 3.5mm
6000090MA	TH384, TH385, TH386		White Seal 1 hole dia 2mm
6000106MA	TH384, TH385, TH386		White Seal 3 hole dia 3.5mm
6000113MA	TH384, TH385, TH386		White Seal 4 hole dia 2mm
6000040LF	TH384, TH385, TH386		Green blanking cap
6000042LF	TH384, TH385, TH386		Green reducing adapter, 6mm Dia hole
6000041LF	TH384, TH385, TH386		Green reducing adapter, 7.5mm Dia hole

# IP67 Cable Grommets - Rapid Installation



## Klikseal - IP67 Cable Retention Grommet - Standard Panels



Product Code	Size	For Panel Thickness (mm)	Colour	Material
1475803	M20	2-5	RAL 7035 - Grey	TPE and Polyamide 66
1475804	M25	2-5	RAL 7035 - Grey	TPE and Polyamide 66
1475813	M20	2-5	RAL 9005 - Black	TPE and Polyamide 66
1475814	M25	2-5	RAL 9005 - Black	TPE and Polyamide 66
1475823	M20	2-5	RAL 9010 - White	TPE and Polyamide 66
1475824	M25	2-5	RAL 9010 - White	TPE and Polyamide 66

## Klikseal - IP67 Cable Retention Grommet - Thin Panels



1475807	M20	0,7 - 3	RAL 7035 - Grey	TPE and Polyamide 66
1475808	M25	0,7 - 3	RAL 7035 - Grey	TPE and Polyamide 66
1475817	M20	0,7 - 3	RAL 9005 - Black	TPE and Polyamide 66
1475818	M25	0,7 - 3	RAL 9005 - Black	TPE and Polyamide 66
1475827	M20	0,7 - 3	RAL 9010 - White	TPE and Polyamide 66
1475828	M25	0,7 - 3	RAL 9010 - White	TPE and Polyamide 66

## Kwikseal - IP67 Cable Retention Grommet



1475711	M16	0,5 - 3	RAL 7035 - Grey	TPE
1475712	M20	0,5 - 3	RAL 7035 - Grey	TPE
1475713	M25	0,5 - 3,5	RAL 7035 - Grey	TPE
1475714	M32	0,5 - 4,5	RAL 7035 - Grey	TPE
1475716	M16	0,5 - 3	RAL 9005 - Black	TPE
1475717	M20	0,5 - 3	RAL 9005 - Black	TPE
1475718	M25	0,5 - 3,5	RAL 9005 - Black	TPE
1475719	M32	0,5 - 4,5	RAL 9005 - Black	TPE
1475721	M16	0,5 - 3	RAL 9010 - White	TPE
1475722	M20	0,5 - 3	RAL 9010 - White	TPE
1475723	M25	0,5 - 3,5	RAL 9010 - White	TPE
1475724	M32	0,5 - 4,5	RAL 9010 - White	TPE

# IP67 Cable Grommets

## Rutaseal - IP67 Cable Retention Grommet



Product Code	Size	For Panel Thickness (mm)	Colour	Material
1458303	M12	0,5 - 2	RAL 7035 - Grey	EPDM
1458304	M16	1 - 4	RAL 7035 - Grey	EPDM
1458305	M20	1 - 4	RAL 7035 - Grey	EPDM
1458306	M25	1 - 4	RAL 7035 - Grey	EPDM
1458307	M32	1 - 4	RAL 7035 - Grey	EPDM
1458308	M40	1 - 4	RAL 7035 - Grey	EPDM
1458309	M50	1 - 4	RAL 7035 - Grey	EPDM
1458233	M12	0,5 - 2	RAL 7001 - Grey	EPDM
1458234	M16	1 - 4	RAL 7001 - Grey	EPDM
1458235	M20	1 - 4	RAL 7001 - Grey	EPDM
1458236	M25	1 - 4	RAL 7001 - Grey	EPDM
1458237	M32	1 - 4	RAL 7001 - Grey	EPDM
1458238	M40	1 - 4	RAL 7001 - Grey	EPDM
1458239	M50	1 - 4	RAL 7001 - Grey	EPDM

## Rutaseal - IP67 Cable Retention Grommet (Continued)

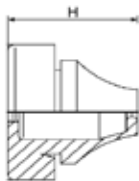

1458293	M12	0,5 - 2	RAL 9005 - Black	EPDM
1458294	M16	1 - 4	RAL 9005 - Black	EPDM
1458295	M20	1 - 4	RAL 9005 - Black	EPDM
1458296	M25	1 - 4	RAL 9005 - Black	EPDM
1458297	M32	1 - 4	RAL 9005 - Black	EPDM
1458298	M40	1 - 4	RAL 9005 - Black	EPDM
1458299	M50	1 - 4	RAL 9005 - Black	EPDM
1458253	M12	0,5 - 2	RAL 9005 - Black	Chloroprene
1458254	M16	1 - 4	RAL 9005 - Black	Chloroprene
1458255	M20	1 - 4	RAL 9005 - Black	Chloroprene
1458256	M25	1 - 4	RAL 9005 - Black	Chloroprene
1458257	M32	1 - 4	RAL 9005 - Black	Chloroprene
1458258	M40	1 - 4	RAL 9005 - Black	Chloroprene
1458259	M50	1 - 4	RAL 9005 - Black	Chloroprene

## Metric Rutaseal Light - IP67 Cable Retention Grommet

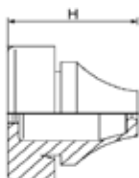

1458334	M16	1 - 4	RAL 7035 - Grey	EPDM
1458335	M20	1 - 4	RAL 7035 - Grey	EPDM
1458336	M25	1 - 4	RAL 7035 - Grey	EPDM
1458326	M16	1 - 4	RAL 7001 - Grey	EPDM
1458327	M20	1 - 4	RAL 7001 - Grey	EPDM
1458328	M25	1 - 4	RAL 7001 - Grey	EPDM
1458330	M16	1 - 4	RAL 9005 - Black	EPDM
1458331	M20	1 - 4	RAL 9005 - Black	EPDM
1458332	M25	1 - 4	RAL 9005 - Black	EPDM

# Metric Brass ATEX Explosion Proof

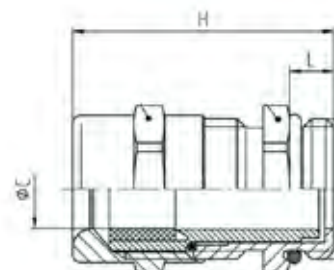

### Brass Explosion Proof Cable Glands:

- Brass CuZn39Pb3, nickel-plated
- IP68 to 5bar
- Temperature Rating of -20 to +80C
- Equipment group: II
- Category / Zone: 2G and 2D / 1, 2, 21, 22

### Vibration Damage Reducing:

- Brass CuZn39Pb3, nickel-plated
- IP68
- Temperature Rating of -20 to +80C
- EMC Versions Available

### Accessories Features:

- Brass CuZn39Pb3, nickel-plated
- IP68
- Temperature Rating of -20 to +80C

## IP68 Brass Explosion Proof Cable Glands

### IP68 Perfect Nickel Plated Brass Explosion Proof Cable Glands



Product Code	Size	H (mm)	L (mm)	ØC (mm)
50.612 M/L/EX	M12	30	10	3-6
50.616 M/L/EX	M16	34	10	5-9
50.620 M/L/EX	M20	37	10	9-13
50.625 M/L/EX	M25	40,5	11	11-16
50.632 M/L/EX	M32	43	13	14-21
50.640 M/L/EX	M40	46	13	19-27
50.650 M/L/EX	M50	52,5	14	24-35
50.663 M/L/EX	M63	58,5	14	32-42
50.663 M1/L/EX	M63	58,5	14	38-48

### IP68 Perfect Emc Nickel Plated Brass Explosion Proof Cable Glands

50.612 M/EMVLEX	M12	30	10	3-6
50.616 M/EMVLEX	M16	34	10	5-9
50.620 M/EMVLEX	M20	37	10	9-13
50.625 M/EMVLEX	M25	40,5	11	11-16
50.632 M/EMVLEX	M32	43	13	14-21
50.640 M/EMVLEX	M40	46	13	19-27
50.650 M/EMVLEX	M50	52,5	14	24-35
50.663 M/EMVLEX	M63	58,5	14	32-42
50.663 M1/EMVLEX	M63	58,5	14	38-48

## Accessories

### IP68 Nickel Plated Brass EX Screw Plug



Product Code	Size	H (mm)	L (mm)
10.1215 M/G/EX	M12	8	5
10.1615 M/G/EX	M16	9	6
10.2015 M/G/EX	M20	9,5	6,5
10.2515 M/G/EX	M25	11	7
10.3215 M/G/EX	M32	12	8
10.4015 M/G/EX	M40	12	8
10.5015 M/G/EX	M50	15	9
10.6315 M/G/EX	M63	16	10



# Perfect Metric Nickel Plated Brass



### Features:

- Easy to install
- Upto IP 68 protection
- Made From Nickel Plated Brass

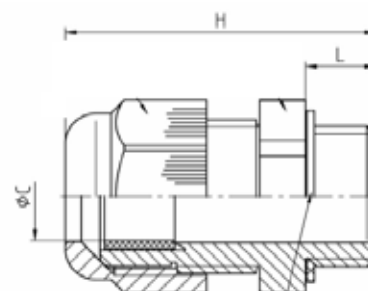

## IP68 Perfect Nickel Plated Brass Cable Gland Long Thread



Part Code	Size	H (mm)	L (mm)	ØC (mm)	Temp Rating
50.612M-L	M12	30	10	3-6	-20 to +100C
50.616M-L	M16	35	10	5-9	-20 to +100C
50.620M-L	M20	37,5	10	9-13	-20 to +100C
50.625M-L	M25	40,5	11	11-16	-20 to +100C
50.632M-L	M32	43	13	14-21	-20 to +100C
50.640M-L	M40	46	13	19-27	-20 to +100C
50.650M-L	M50	54,5	14	24-35	-20 to +100C
50.663M-L	M63	56,5	14	32-42	-20 to +100C
50.663 M1-L	M63	56,5	14	38-48	-20 to +100C

## IP68 Perfect Nickel Plated Brass with Reducing Insert



50.612 M/R	M12	25	5	2-5	-20 to +100C
50.616 M/R	M16	30	5	3-9	-20 to +100C
50.620 M/R	M20	33,5	6	5-13	-20 to +100C
50.625 M/R	M25	36,5	7	8-16	-20 to +100C
50.632 M/R	M32	38	8	12-21	-20 to +100C
50.640 M/R	M40	41	8	16-27	-20 to +100C
50.650 M/R	M50	49,5	9	21-35	-20 to +100C
50.663 M/R	M63	52,5	10	27-48	-20 to +100C

## IP66 Perfect Nickel Plated Brass Cable Gland for Flat Profile Cable



50.620 MFK1	M20	33,5	6	5x12max, 2x9min	-20 to +100C
50.625 MFK1	M25	36,5	7	6x16.3max, 2x11min	-20 to +100C
50.632 MFK1	M32	38	8	9x20max, 3x13min	-20 to +100C
50.640 MFK1	M40	41	8	10x27max, 3x17min	-20 to +100C
50.650 MFK1	M50	49,5	9	13x34max, 4x24min	-20 to +100C
50.663 MFK1	M63	52,5	10	15x45max, 5x33min	-20 to +100C

## IP65 Perfect Nickel Plated Brass Cable Gland For ASI Profile Cable



50.620 M/ASI/1	M20	33,5	6	1x ASI cable	-20 to +100C
50.625 M/ASI/1	M25	36,5	7	1x ASI cable	-20 to +100C
50.620 M/ASI/2	M20	33,5	6	2x ASI cable	-20 to +100C
50.625 M/ASI/2	M25	36,5	7	2x ASI cable	-20 to +100C

# Perfect Metric Nickel Plated Brass

## Other Styles Of Gland Are Available

### Kompakt Glands:



#### Features:

- IP55 rated
- Available in Standard or with rubber bushing inside
- Temperature rating of -30c to +100c
- Sizes From M12 - M63

### NPB Gland With Clamping Jaw:



#### Features:

- IP55 rated
- Temperature rating of -30c to +100c
- Sizes From M12 - M63

## Accessories

### Metric Locknuts



Part Code	IP Rating	Colour	Material	Size	H (mm)	L (mm)	ØC (mm)	Temp Rating
50.212 M	N/a	Silver	Metric Nickel Plated Brass	M12	2,8	N/a	N/a	-60 to +200C
50.216 M	N/a	Silver	Metric Nickel Plated Brass	M16	2,8	N/a	N/a	-60 to +200C
50.220 M	N/a	Silver	Metric Nickel Plated Brass	M20	3	N/a	N/a	-60 to +200C
50.225 M	N/a	Silver	Metric Nickel Plated Brass	M25	3,5	N/a	N/a	-60 to +200C
50.232 M	N/a	Silver	Metric Nickel Plated Brass	M32	4	N/a	N/a	-60 to +200C
50.240 M	N/a	Silver	Metric Nickel Plated Brass	M40	5	N/a	N/a	-60 to +200C
50.250 M	N/a	Silver	Metric Nickel Plated Brass	M50	5	N/a	N/a	-60 to +200C
50.263 M	N/a	Silver	Metric Nickel Plated Brass	M63	6	N/a	N/a	-60 to +200C

### IP68 Screw Plug With O Ring And Slot Top



10.1210 M/G	IP68	Silver	Metric Nickel Plated Brass	M12	7,5	4,5	16	-30 to +100C
10.1215 M/G	IP68	Silver	Metric Nickel Plated Brass	M12	8	5	16	-30 to +100C
10.1615 M/G	IP68	Silver	Metric Nickel Plated Brass	M16	9	6	20	-30 to +100C
10.2015 M/G	IP68	Silver	Metric Nickel Plated Brass	M20	9,5	6,5	24	-30 to +100C
10.2515 M/G	IP68	Silver	Metric Nickel Plated Brass	M25	11	7	28	-30 to +100C
10.3215 M/G	IP68	Silver	Metric Nickel Plated Brass	M32	12	8	35	-30 to +100C
10.4015 M/G	IP68	Silver	Metric Nickel Plated Brass	M40	12	8	45	-30 to +100C
10.5015 M/G	IP68	Silver	Metric Nickel Plated Brass	M50	15	9	55	-30 to +100C
10.6315 M/G	IP68	Silver	Metric Nickel Plated Brass	M63	16	10	68	-30 to +100C

### IP54 Screw Plug With Slot Top



10.1210	IP54	Silver	Metric Nickel Plated Brass	M12	7,5	4,5	16	-60 to +200C
10.1215	IP54	Silver	Metric Nickel Plated Brass	M12	8	5	16	-60 to +200C
10.1615	IP54	Silver	Metric Nickel Plated Brass	M16	9	6	20	-60 to +200C
10.2015	IP54	Silver	Metric Nickel Plated Brass	M20	9,5	6,5	24	-60 to +200C
10.2515	IP54	Silver	Metric Nickel Plated Brass	M25	11	7	28	-60 to +200C
10.3215	IP54	Silver	Metric Nickel Plated Brass	M32	12	8	35	-60 to +200C
10.4015	IP54	Silver	Metric Nickel Plated Brass	M40	12	8	45	-60 to +200C
10.5015	IP54	Silver	Metric Nickel Plated Brass	M50	15	9	55	-60 to +200C
10.6315	IP54	Silver	Metric Nickel Plated Brass	M63	16	10	68	-60 to +200C

# IP68 Nylon Metric Perfect



### Features:

- Upto IP68 at 5Bar
- Includes PG/ Metric Perfect Range where Sealing range and dome nut dimensions are identical to pg - series
- Reducing cable range versions included
- PA6 V0 Options Available
- Temp Rating of -20C to +100C

## Kwik Fix IP68 Metric Cable Glands

### Features:

- IP68
- Temp range -20C to +100C
- Quick and easy installation without special tools
- Assemble from one side only - no separate lock nut, saves time so saves money.
- Wall thickness 1-4mm

### IP68 Metric Perfect Nylon Cable Gland



Part Code	Colour	Material	Size	H (mm)	ØC (mm)
K341-1016-00	Grey RAL7035	Polyamide PA6 V2	M16	38.5	5-10
K341-1020-00	Grey RAL7035	Polyamide PA6 V2	M20	42.5	8-13
K341-1025-00	Grey RAL7035	Polyamide PA6 V2	M25	48	11-17
K341-1016-01	Grey RAL7001	Polyamide PA6 V2	M16	38.5	5-10
K341-1020-01	Grey RAL7001	Polyamide PA6 V2	M20	42.5	8-13
K341-1025-01	Grey RAL7001	Polyamide PA6 V2	M25	48	11-17
K341-1016-02	Black RAL9005	Polyamide PA6 V2	M16	38.5	5-10
K341-1020-02	Black RAL9005	Polyamide PA6 V2	M20	42.5	8-13
K341-1025-02	Black RAL9005	Polyamide PA6 V2	M25	48	11-17

## Other Styles Of Gland Are Available

### Krallen Cable Gland:



### Features:

- IP65 rated
- Polyamide PA6 GF30
- Sizes M12-M40
- Temp Rating of -30C to +100C
- Cable Range 4-6mm to 18-24mm

### Favorit Nylon Cable Glands:



### Features:

- IP55 rated
- Polyamide PA6 GF30
- Sizes M12-M40
- Temp Rating of -30C to +80C
- Cable Range 5,5-7,5mm to 18-25mm

# IP68 Nylon Metric Perfect



## IP68 Perfect Nylon Cable Gland With Reducing Insert

Part Code	Colour	Material	Size	H (mm)	L (mm)	ØC (mm)
50.612 PA/R	RAL7001 - Silver Grey	Nylon PA6	M12	31	8	2-5
50.616 PA/R	RAL7001 - Silver Grey	Nylon PA6	M16	35,5	8	3-10
50.620 PA/R	RAL7001 - Silver Grey	Nylon PA6	M20	36	8	5-13
50.625 PA/R	RAL7001 - Silver Grey	Nylon PA6	M25	43	8	8-17
50.632 PA/R	RAL7001 - Silver Grey	Nylon PA6	M32	50	10	12-21
50.640 PA/R	RAL7001 - Silver Grey	Nylon PA6	M40	51	10	16-28
50.650 PA/R	RAL7001 - Silver Grey	Nylon PA6	M50	61,5	12	21-35
50.663 PA/R	RAL7001 - Silver Grey	Nylon PA6	M63	65,5	12	27-48
50.612 PA/R7035	RAL7035 - Light Grey	Nylon PA6	M12	31	8	2-5
50.616 PA/R7035	RAL7035 - Light Grey	Nylon PA6	M16	35,5	8	3-10
50.620 PA/R7035	RAL7035 - Light Grey	Nylon PA6	M20	36	8	5-13
50.625 PA/R7035	RAL7035 - Light Grey	Nylon PA6	M25	43	8	8-17
50.632 PA/R7035	RAL7035 - Light Grey	Nylon PA6	M32	50	10	12-21
50.640 PA/R7035	RAL7035 - Light Grey	Nylon PA6	M40	51	10	16-28
50.650 PA/R7035	RAL7035 - Light Grey	Nylon PA6	M50	61,5	12	21-35
50.663 PA/R7035	RAL7035 - Light Grey	Nylon PA6	M63	65,5	12	27-48
50.612 PA/RSW	RAL9005 - Black	Nylon PA6	M12	31	8	2-5
50.616 PA/RSW	RAL9005 - Black	Nylon PA6	M16	35,5	8	3-10
50.620 PA/RSW	RAL9005 - Black	Nylon PA6	M20	36	8	5-13
50.625 PA/RSW	RAL9005 - Black	Nylon PA6	M25	43	8	8-17
50.632 PA/RSW	RAL9005 - Black	Nylon PA6	M32	50	10	12-21
50.640 PA/RSW	RAL9005 - Black	Nylon PA6	M40	51	10	16-28
50.650 PA/RSW	RAL9005 - Black	Nylon PA6	M50	61,5	12	21-35
50.663 PA/RSW	RAL9005 - Black	Nylon PA6	M63	65,5	12	27-48

## IP66 Perfect Nylon Cable Gland For Flat Profile Cable



50.620 PA7035FK1	RAL7035 - Light Grey	Nylon PA6	M20	36	8	5x12max, 2x8min
50.625 PA7035FK1	RAL7035 - Light Grey	Nylon PA6	M25	43	8	6x16.3max, 2x10min
50.632 PA7035FK1	RAL7035 - Light Grey	Nylon PA6	M32	50	10	9x20max, 3x12min
50.640 PA7035FK1	RAL7035 - Light Grey	Nylon PA6	M40	51	10	10x27max, 3x19min
50.650 PA7035FK1	RAL7035 - Light Grey	Nylon PA6	M50	61,6	12	13x34max, 4x23min
50.663 PA7035FK1	RAL7035 - Light Grey	Nylon PA6	M63	65,5	12	15x46max, 6x32min
50.620 PASWFK1	RAL9005 - Black	Nylon PA6	M20	36	8	5x12max, 2x8min
50.625 PASWFK1	RAL9005 - Black	Nylon PA6	M25	43	8	6x16.3max, 2x10min
50.632 PASWFK1	RAL9005 - Black	Nylon PA6	M32	50	10	9x20max, 3x12min
50.640 PASWFK1	RAL9005 - Black	Nylon PA6	M40	51	10	10x27max, 3x19min
50.650 PASWFK1	RAL9005 - Black	Nylon PA6	M50	61,6	12	13x34max, 4x23min
50.663 PASWFK1	RAL9005 - Black	Nylon PA6	M63	65,5	12	15x46max, 6x32min



# IP68 Nylon Metric Perfect

## Metric Nylon Accessories



### Features:

- Locknut available in V0 material
- Thread adaptors have a Temperature Range of -30c to +100C
- Flange Locknuts available

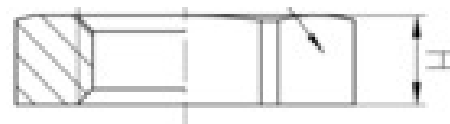

### Locknuts



Part Code	Colour	Size	H (mm)	L (mm)	ØC (mm)	IP Rating	Material	Temperature Rating
50.212 PA7001	Ral7001 - Grey	M12	5	N/a	N/a	N/a	PA6 GF30	-20 to +100C
50.216 PA7001	Ral7001 - Grey	M16	5	N/a	N/a	N/a	PA6 GF30	-20 to +100C
50.220 PA7001	Ral7001 - Grey	M20	6	N/a	N/a	N/a	PA6 GF30	-20 to +100C
50.225 PA7001	Ral7001 - Grey	M25	6	N/a	N/a	N/a	PA6 GF30	-20 to +100C
50.232 PA7001	Ral7001 - Grey	M32	7	N/a	N/a	N/a	PA6 GF30	-20 to +100C
50.240 PA7001	Ral7001 - Grey	M40	7	N/a	N/a	N/a	PA6 GF30	-20 to +100C
50.250 PA7001	Ral7001 - Grey	M50	8	N/a	N/a	N/a	PA6 GF30	-20 to +100C
50.263 PA7001	Ral7001 - Grey	M63	8	N/a	N/a	N/a	PA6 GF30	-20 to +100C
50.212 PA7035	Ral7035 - Light Grey	M12	5	N/a	N/a	N/a	PA6 GF30	-20 to +100C
50.216 PA7035	Ral7035 - Light Grey	M16	5	N/a	N/a	N/a	PA6 GF30	-20 to +100C
50.220 PA7035	Ral7035 - Light Grey	M20	6	N/a	N/a	N/a	PA6 GF30	-20 to +100C
50.225 PA7035	Ral7035 - Light Grey	M25	6	N/a	N/a	N/a	PA6 GF30	-20 to +100C
50.232 PA7035	Ral7035 - Light Grey	M32	7	N/a	N/a	N/a	PA6 GF30	-20 to +100C
50.240 PA7035	Ral7035 - Light Grey	M40	7	N/a	N/a	N/a	PA6 GF30	-20 to +100C
50.250 PA7035	Ral7035 - Light Grey	M50	8	N/a	N/a	N/a	PA6 GF30	-20 to +100C
50.263 PA7035	Ral7035 - Light Grey	M63	8	N/a	N/a	N/a	PA6 GF30	-20 to +100C
50.212 PA/SW	Ral9005 - Black	M12	5	N/a	N/a	N/a	PA6 GF30	-20 to +100C
50.216 PA/SW	Ral9005 - Black	M16	5	N/a	N/a	N/a	PA6 GF30	-20 to +100C
50.220 PA/SW	Ral9005 - Black	M20	6	N/a	N/a	N/a	PA6 GF30	-20 to +100C
50.225 PA/SW	Ral9005 - Black	M25	6	N/a	N/a	N/a	PA6 GF30	-20 to +100C
50.232 PA/SW	Ral9005 - Black	M32	7	N/a	N/a	N/a	PA6 GF30	-20 to +100C
50.240 PA/SW	Ral9005 - Black	M40	7	N/a	N/a	N/a	PA6 GF30	-20 to +100C
50.250 PA/SW	Ral9005 - Black	M50	8	N/a	N/a	N/a	PA6 GF30	-20 to +100C
50.263 PA/SW	Ral9005 - Black	M63	8	N/a	N/a	N/a	PA6 GF30	-20 to +100C

# IP68 Nylon Metric Perfect

## IP65 Metric Nylon Blanking Plug With Simple Sealing Ring



Part Code	Colour	Size	H (mm)	L (mm)	Da (mm)	IP Rating	Material	Temperature Rating
10.1215 PAV	Ral7001 - Grey	M12	10	6	15	IP65	PA6	-30 to +100C
10.1615 PAV	Ral7001 - Grey	M16	10,5	6	20	IP65	PA6	-30 to +100C
10.2015 PAV	Ral7001 - Grey	M20	10,5	6	24	IP65	PA6	-30 to +100C
10.2515 PAV	Ral7001 - Grey	M25	13	8	30	IP65	PA6	-30 to +100C
10.3125 PAV	Ral7001 - Grey	M32	13,5	8	37	IP65	PA6	-30 to +100C
10.4015 PAV	Ral7001 - Grey	M40	14	8	46	IP65	PA6	-30 to +100C
10.5015 PAV	Ral7001 - Grey	M50	16,5	10	56	IP65	PA6	-30 to +100C
10.6315 PAV	Ral7001 - Grey	M63	17	12	70	IP65	PA6	-30 to +100C
10.1215 PAV7035	Ral7035 - Light Grey	M12	10	6	15	IP65	PA6	-30 to +100C
10.1615 PAV7035	Ral7035 - Light Grey	M16	10,5	6	20	IP65	PA6	-30 to +100C
10.2015 PAV7035	Ral7035 - Light Grey	M20	10,5	6	24	IP65	PA6	-30 to +100C
10.2515 PAV7035	Ral7035 - Light Grey	M25	13	8	30	IP65	PA6	-30 to +100C
10.3125 PAV7035	Ral7035 - Light Grey	M32	13,5	8	37	IP65	PA6	-30 to +100C
10.4015 PAV7035	Ral7035 - Light Grey	M40	14	8	46	IP65	PA6	-30 to +100C
10.5015 PAV7035	Ral7035 - Light Grey	M50	16,5	10	56	IP65	PA6	-30 to +100C
10.6315 PAV7035	Ral7035 - Light Grey	M63	17	12	70	IP65	PA6	-30 to +100C
10.1215 PAVSW	Ral9005 - Black	M12	10	6	15	IP65	PA6	-30 to +100C
10.1615 PAVSW	Ral9005 - Black	M16	10,5	6	20	IP65	PA6	-30 to +100C
10.2015 PAVSW	Ral9005 - Black	M20	10,5	6	24	IP65	PA6	-30 to +100C
10.2515 PAVSW	Ral9005 - Black	M25	13	8	30	IP65	PA6	-30 to +100C
10.3125 PAVSW	Ral9005 - Black	M32	13,5	8	37	IP65	PA6	-30 to +100C
10.4015 PAVSW	Ral9005 - Black	M40	14	8	46	IP65	PA6	-30 to +100C
10.5015 PAVSW	Ral9005 - Black	M50	16,5	10	56	IP65	PA6	-30 to +100C
10.6315 PAVSW	Ral9005 - Black	M63	17	12	70	IP65	PA6	-30 to +100C

# Perfect Metric Stainless Steel Cable Glands



### Features:

- Stainless Steel
- Integrated anchorage
- Protection against twisting
- Wide sealing & clamping ranges
- Easy to install

### IP68 Perfect Stainless Steel Cable Gland



Part Code	Size	H (mm)	L (mm)	ØC (mm)	Temp Rating
50.612 ES	M12	25	5	3-6	-20 to +100C
50.616 ES	M16	30	5	5-9	-20 to +100C
50.620 ES	M20	33,5	6	9-13	-20 to +100C
50.625 ES	M25	36,5	7	11-16	-20 to +100C
50.632 ES	M32	38	8	14-21	-20 to +100C
50.640 ES	M40	41	8	19-27	-20 to +100C
50.650 ES	M50	49,5	9	24-35	-20 to +100C
50.663 ES	M63	52,5	10	32-42	-20 to +100C

### IP68 Perfect EMC Gland Stainless Steel



50.616 ES/EMV	M16	30	5	5-9	-20 to +100C
50.620 ES/EMV	M20	33,5	6	9-13	-20 to +100C
50.625 ES/EMV	M25	36,5	7	11-16	-20 to +100C
50.632 ES/EMV	M32	38	8	14-21	-20 to +100C

### IP65 WADI EMC Cable Gland NBR Sealing Insert



101011M16ES	M16	25	6	7-11,5	-30 to +100C
101016M20ES	M20	26	6	8-15	-30 to +100C
101021M25ES	M25	31	7,5	13-20	-30 to +100C
101029M32ES	M32	32	8	18-25,5	-30 to +100C

### IP65 WADI EMC High Temp Cable Gland Viton Sealing Insert



101011M16ES	M16	25	6	7-11,5	-18 to +200C
101016M20ES	M20	26	6	8-15	-18 to +200C
101021M25ES	M25	31	7,5	13-20	-18 to +200C
101029M32ES	M32	32	8	18-25,5	-18 to +200C

### Stainless Steel Locknut



Part Code	Size	H (mm)	SW1 (mm)	A (mm)	Temp Rating
50.212 ES	M12	2,8	14	M12x1,5	Upto +200C
50.216ES	M16	2,8	19	M16x1,5	Upto +200C
50.220ES	M20	3	24	M20x1,5	Upto +200C
50.225ES	M25	3,5	30	M25x1,5	Upto +200C
50.232ES	M32	4	36	M32x1,5	Upto +200C
50.240ES	M40	5	46	M40x1,5	Upto +200C
50.250ES	M50	5	60	M50x1,5	Upto +200C
50.263ES	M63	6	70	M63x1,5	Upto +200C

# Perfect PG Nickel Plated Brass Cable Glands



### Features:

- PG Nickel Plated Brass
- Easy to install
- 50.0xx range offers protection against twisting and also offers integrated anchorage
- EMC Versions available

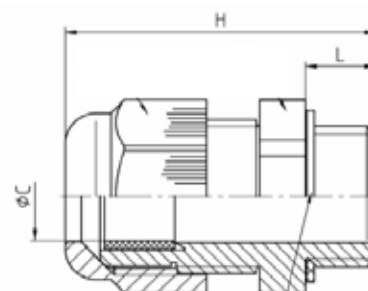

## IP68 Perfect Nickel Plated Brass Cable Gland



Part Code	IP Rating	Size	H (mm)	L (mm)	ØC (mm)	Temp Rating
50.007	IP68	Pg 7	24	5	3 -6,5	-20 to +100C
50.009	IP68	Pg 9	29	6	4-8	-20 to +100C
50.011	IP68	Pg 11	29,5	6	5-10	-20 to +100C
50.013	IP68	Pg 13,5	31,5	6,5	6-12	-20 to +100C
50.016	IP68	Pg 16	31,5	6,5	10-14	-20 to +100C
50.021	IP68	Pg 21	34	7	13-18	-20 to +100C
50.029	IP68	Pg 29	39	8	18-25	-20 to +100C
50.036	IP68	Pg 36	45	9	24-32	-20 to +100C
50.042	IP68	Pg 42	49	10	30-38	-20 to +100C
50.048	IP68	Pg 48	52	10	34-44	-20 to +100C

## IP68 Perfect Nickel Plated Reducing Brass Cable Gland



50.007 R	IP68	Pg 7	24	5	2 -5	-20 to +100C
50.009 R	IP68	Pg 9	29	6	2 -6	-20 to +100C
50.011 R	IP68	Pg 11	29,5	6	3 -7	-20 to +100C
50.013 R	IP68	Pg 13,5	31,5	6,5	5 -9	-20 to +100C
50.016 R	IP68	Pg 16	31,5	6,5	7 -12	-20 to +100C
50.021 R	IP68	Pg 21	34	7	9 -16	-20 to +100C
50.029 R	IP68	Pg 29	39	8	12 -20	-20 to +100C
50.036 R	IP68	Pg 36	45	9	20 -26	-20 to +100C

## IP68 Perfect Nickel Plated Brass Emv Cable Gland



50.007/EMV	IP68	Pg 7	24	5	3 -6,5	-20 to +100C
50.009/EMV	IP68	Pg 9	29	6	4-8	-20 to +100C
50.011/EMV	IP68	Pg 11	29,5	6	5-10	-20 to +100C
50.013/EMV	IP68	Pg 13,5	31,5	6,5	6-12	-20 to +100C
50.016/EMV	IP68	Pg 16	31,5	6,5	10-14	-20 to +100C
50.021/EMV	IP68	Pg 21	34	7	13-18	-20 to +100C
50.029/EMV	IP68	Pg 29	39	8	18-25	-20 to +100C
50.036/EMV	IP68	Pg 36	45	9	24-32	-20 to +100C
50.042/EMV	IP68	Pg 42	49	10	30-38	-20 to +100C
50.048/EMV	IP68	Pg 48	52	10	34-44	-20 to +100C

# Perfect PG Nickel Plated Brass Cable Glands

## IP68 Reducing Adaptor With O Ring Seal And Hex Collar

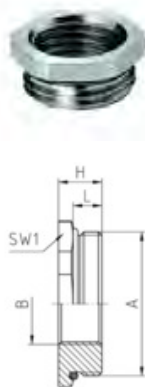

Part Code	IP Rating	Size	H (mm)	L (mm)	ØC (mm)	Temp Rating
60907/OM	IP68	PG9PG7	8,5	6	N/a	-30 to +100C
61107/OM	IP68	PG11PG7	8,5	6	N/a	-30 to +100C
61109/OM	IP68	PG11PG9	8,5	6	N/a	-30 to +100C
61307/OM	IP68	PG13PG7	9,5	6,5	N/a	-30 to +100C
61309/OM	IP68	PG13PG9	9,5	6,5	N/a	-30 to +100C
61311/OM	IP68	PG13PG11	9,5	6,5	N/a	-30 to +100C
61607/OM	IP68	PG16PG7	9,5	6,5	N/a	-30 to +100C
61609/OM	IP68	PG16PG9	9,5	6,5	N/a	-30 to +100C
61611/OM	IP68	PG16PG11	9,5	6,5	N/a	-30 to +100C
61613/OM	IP68	PG16PG13	9,5	6,5	N/a	-30 to +100C
62111/OM	IP68	PG21PG11	10	7	N/a	-30 to +100C
62113/OM	IP68	PG21PG13	10	7	N/a	-30 to +100C
62116/OM	IP68	PG21PG16	10	7	N/a	-30 to +100C
62916/OM	IP68	PG29PG16	11,5	8	N/a	-30 to +100C
62921/OM	IP68	PG29PG21	11,5	8	N/a	-30 to +100C
63621/OM	IP68	PG36PG21	12,5	9	N/a	-30 to +100C
63629/OM	IP68	PG36PG29	12,5	9	N/a	-30 to +100C
64236/OM	IP68	PG42PG36	14	10	N/a	-30 to +100C

## Other Styles Of Gland Are Available

### Gland With Clamping Jaw



#### Features:

- IP55
- Material PG Nickel Plated Brass
- Temp Rating Of -30°C to 100°C
- Sizes Ranges PG7 to PG48

### Favorit Cable Glands:



#### Features:

- IP55
- PG Nickel Plated Brass
- Temp Rating of -30°C to +100°C
- Sizes Range PG9 To PG29
- Also Available With Rubber Bushing

### Kompakt Pressure Screw



#### Features:

- PG Nickel plated Brass
- Temp Rating Of -60°C to +200°C
- Sizes Range PG9 to PG29

### Kompakt Cable Glands



#### Features:

- IP55
- PG Nickel Plated Brass
- Temp Rating Of -30°C To +100°C
- Sizes Range PG9 to PG48
- Also Available With Rubber Bushing

# Perfect PG Nylon Cable Glands



## Features:

- PG Nylon
- Easy to install
- 50.0xx range offers protection against twisting and also offers integrated anchorage
- Temperature rating -20c to + 100c

## IP68 Pg Perfect Nylon Cable Gland

Part Code	Colour	Size	H (mm)	L (mm)	ØC (mm)	Material
50.007 PA	RAL7001 - Silver Grey	Pg 7	30,5	8	3-6,5	Polyamide PA6 V-2
50.009 PA	RAL7001 - Silver Grey	Pg 9	34	8	4-8	Polyamide PA6 V-2
50.011 PA	RAL7001 - Silver Grey	Pg 11	37	8	5-10	Polyamide PA6 V-2
50.013 PA	RAL7001 - Silver Grey	Pg 13,5	39	9	6-12	Polyamide PA6 V-2
50.016 PA	RAL7001 - Silver Grey	Pg 16	42,5	10	10-14	Polyamide PA6 V-2
50.021 PA	RAL7001 - Silver Grey	Pg 21	47,5	11	13-18	Polyamide PA6 V-2
50.029 PA	RAL7001 - Silver Grey	Pg 29	53	11	18-25	Polyamide PA6 V-2
50.036 PA	RAL7001 - Silver Grey	Pg 36	61	13	22-32	Polyamide PA6 V-2
50.042 PA	RAL7001 - Silver Grey	Pg 42	65	13	30-38	Polyamide PA6 V-2
50.048 PA	RAL7001 - Silver Grey	Pg 48	67	14	34-44	Polyamide PA6 V-2
50.007 PA7035	RAL7035 - Light Grey	Pg 7	30,5	8	3-6,5	Polyamide PA6 V-2
50.009 PA7035	RAL7035 - Light Grey	Pg 9	34	8	4-8	Polyamide PA6 V-2
50.011 PA7035	RAL7035 - Light Grey	Pg 11	37	8	5-10	Polyamide PA6 V-2
50.013 PA7035	RAL7035 - Light Grey	Pg 13,5	39	9	6-12	Polyamide PA6 V-2
50.016 PA7035	RAL7035 - Light Grey	Pg 16	42,5	10	10-14	Polyamide PA6 V-2
50.021 PA7035	RAL7035 - Light Grey	Pg 21	47,5	11	13-18	Polyamide PA6 V-2
50.029 PA7035	RAL7035 - Light Grey	Pg 29	53	11	18-25	Polyamide PA6 V-2
50.036 PA7035	RAL7035 - Light Grey	Pg 36	61	13	22-32	Polyamide PA6 V-2
50.042 PA7035	RAL7035 - Light Grey	Pg 42	65	13	30-38	Polyamide PA6 V-2
50.048 PA7035	RAL7035 - Light Grey	Pg 48	67	14	34-44	Polyamide PA6 V-2
50.007 PA/SW	RAL9005 - Black	Pg 7	30,5	8	3-6,5	Polyamide PA6 V-2
50.009 PA/SW	RAL9005 - Black	Pg 9	34	8	4-8	Polyamide PA6 V-2
50.011 PA/SW	RAL9005 - Black	Pg 11	37	8	5-10	Polyamide PA6 V-2
50.013 PA/SW	RAL9005 - Black	Pg 13,5	39	9	6-12	Polyamide PA6 V-2
50.016 PA/SW	RAL9005 - Black	Pg 16	42,5	10	10-14	Polyamide PA6 V-2
50.021 PA/SW	RAL9005 - Black	Pg 21	47,5	11	13-18	Polyamide PA6 V-2
50.029 PA/SW	RAL9005 - Black	Pg 29	53	11	18-25	Polyamide PA6 V-2
50.036 PA/SW	RAL9005 - Black	Pg 36	61	13	22-32	Polyamide PA6 V-2
50.042 PA/SW	RAL9005 - Black	Pg 42	65	13	30-38	Polyamide PA6 V-2
50.048 PA/SW	RAL9005 - Black	Pg 48	67	14	34-44	Polyamide PA6 V-2



# Perfect PG Nylon Cable Glands

## Accessories

### LockNuts

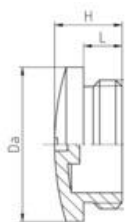
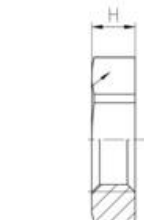

Part Code	Colour	Size	IP Rating	H (mm)	L (mm)	ØC (mm)	Temp Rating	Material
207 PA	RAL7001 - Silver Grey	Pg7	N/a	5	N/a	N/a	-20 to +100C	PA6 GF30
209 PA	RAL7001 - Silver Grey	PG9	N/a	5	N/a	N/a	-20 to +100C	PA6 GF30
211 PA	RAL7001 - Silver Grey	PG11	N/a	5	N/a	N/a	-20 to +100C	PA6 GF30
213 PA	RAL7001 - Silver Grey	PG13	N/a	6	N/a	N/a	-20 to +100C	PA6 GF30
216 PA	RAL7001 - Silver Grey	PG16	N/a	6	N/a	N/a	-20 to +100C	PA6 GF30
221 PA	RAL7001 - Silver Grey	PG21	N/a	7	N/a	N/a	-20 to +100C	PA6 GF30
229 PA	RAL7001 - Silver Grey	PG29	N/a	7	N/a	N/a	-20 to +100C	PA6 GF30
236 PA	RAL7001 - Silver Grey	PG36	N/a	8	N/a	N/a	-20 to +100C	PA6 GF30
242 PA	RAL7001 - Silver Grey	PG42	N/a	8	N/a	N/a	-20 to +100C	PA6 GF30
248 PA	RAL7001 - Silver Grey	PG48	N/a	8	N/a	N/a	-20 to +100C	PA6 GF30
207 PG	RAL7035 - Light Grey	Pg7	N/a	5	N/a	N/a	-20 to +100C	PA6 GF30
209 PG	RAL7035 - Light Grey	PG9	N/a	5	N/a	N/a	-20 to +100C	PA6 GF30
211 PG	RAL7035 - Light Grey	PG11	N/a	5	N/a	N/a	-20 to +100C	PA6 GF30
213 PG	RAL7035 - Light Grey	PG13	N/a	6	N/a	N/a	-20 to +100C	PA6 GF30
216 PG	RAL7035 - Light Grey	PG16	N/a	6	N/a	N/a	-20 to +100C	PA6 GF30
221 PG	RAL7035 - Light Grey	PG21	N/a	7	N/a	N/a	-20 to +100C	PA6 GF30
229 PG	RAL7035 - Light Grey	PG29	N/a	7	N/a	N/a	-20 to +100C	PA6 GF30
236 PG	RAL7035 - Light Grey	PG36	N/a	8	N/a	N/a	-20 to +100C	PA6 GF30
242 PG	RAL7035 - Light Grey	PG42	N/a	8	N/a	N/a	-20 to +100C	PA6 GF30
248 PG	RAL7035 - Light Grey	PG48	N/a	8	N/a	N/a	-20 to +100C	PA6 GF30
207 PA/SW	RAL9005 - Black	Pg7	N/a	5	N/a	N/a	-20 to +100C	PA6 GF30
209 PA/SW	RAL9005 - Black	PG9	N/a	5	N/a	N/a	-20 to +100C	PA6 GF30
211 PA/SW	RAL9005 - Black	PG11	N/a	5	N/a	N/a	-20 to +100C	PA6 GF30
213 PA/SW	RAL9005 - Black	PG13	N/a	6	N/a	N/a	-20 to +100C	PA6 GF30
216 PA/SW	RAL9005 - Black	PG16	N/a	6	N/a	N/a	-20 to +100C	PA6 GF30
221 PA/SW	RAL9005 - Black	PG21	N/a	7	N/a	N/a	-20 to +100C	PA6 GF30
229 PA/SW	RAL9005 - Black	PG29	N/a	7	N/a	N/a	-20 to +100C	PA6 GF30
236 PA/SW	RAL9005 - Black	PG36	N/a	8	N/a	N/a	-20 to +100C	PA6 GF30
242 PA/SW	RAL9005 - Black	PG42	N/a	8	N/a	N/a	-20 to +100C	PA6 GF30
248 PA/SW	RAL9005 - Black	PG48	N/a	8	N/a	N/a	-20 to +100C	PA6 GF30

### IP54 Screw Plug



Part Code	Colour	Size	IP Rating	H (mm)	L (mm)	Da (mm)	Temp Rating	Material
1007 PA	RAL7035 - Light Grey	PG7	IP54	10	6	15	-30C to +90C	PA6
1009 PA	RAL7035 - Light Grey	PG9	IP54	10	6	19	-30C to +90C	PA6
1011 PA	RAL7035 - Light Grey	PG11	IP54	10	6	22	-30C to +90C	PA6
1013 PA	RAL7035 - Light Grey	PG13	IP54	10	6	25	-30C to +90C	PA6
1016 PA	RAL7035 - Light Grey	PG16	IP54	10	6	27	-30C to +90C	PA6
1021 PA	RAL7035 - Light Grey	PG21	IP54	12,5	8	33	-30C to +90C	PA6
1029 PA	RAL7035 - Light Grey	PG29	IP54	13	8	44,5	-30C to +90C	PA6
1036 PA	RAL7035 - Light Grey	PG36	IP54	15	10	55,5	-30C to +90C	PA6
1042 PA	RAL7035 - Light Grey	PG42	IP54	15,5	10	62,5	-30C to +90C	PA6
1048 PA	RAL7035 - Light Grey	PG48	IP54	17	12	69,5	-30C to +90C	PA6

## PG Stainless Steel Cable Glands



**Features:**

- Stainless Steel
- Suitable For high temperature applications
- Easy to install with a wide sealing range

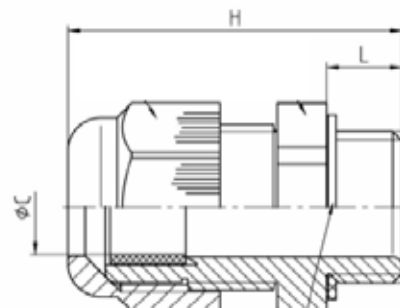

IP65 WADI EMC With Viton Sealing Insert



Part Code	Size	H(mm)	L (mm)	ØC (mm)	Temp Rating
129007	Pg 7	22	6	4-7	-18 to +200C
129009	Pg 9	23,5	6,5	5-10	-18 to +200C
129011	Pg 11	24	6	7-12	-18 to +200C
129013	Pg 13,5	27	6	7-15	-18 to +200C
129016	Pg 16	27	6	7-15	-18 to +200C
129021	Pg 21	30,5	7,5	9-20	-18 to +200C

PG Stainless Steel Locknuts

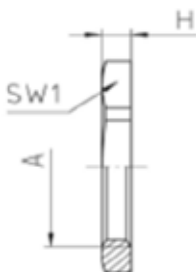

Part Code	Size	H(mm)	SW1 (mm)	ØC (mm)	Temp Rating
129207	Pg 7	3	14	N/a	-60c / +200c
129209	Pg 9	3	19	N/a	-60c / +200c
129211	Pg 11	3	22	N/a	-60c / +200c
129213	Pg 13,5	3	24	N/a	-60c / +200c
129216	Pg 16	3	27	N/a	-60c / +200c
129221	Pg 21	3,5	32	N/a	-60c / +200c
129229	Pg 29	4	41	N/a	-60c / +200c
129236	Pg 36	5	50	N/a	-60c / +200c



# Nylon Pillar Terminal Blocks

Kwik Snap is a new range of Polypropylene terminal blocks that can be 'snapped' into useable pole sizes without tools but with the pole dividers still being capable of supporting fixing screws. Supplied in 24-72 Amp options, these products offer a superior quality with a rapid installation.



## Features:

- New Kwik Snap range saves time, saves money
- Large diverse range of pillar style terminal blocks available
- Product available in nylon pa66 and no flame, depending on item
- Steel insert products available
- Raised base is standard across range



## VDE Approved Kwik Snap Terminal Blocks In Polypropylene

Product Code	Colour	Material	H (mm)	W (mm)	L (mm)
HYKS-02412PP	White	Polypropylene	12.2	17.8	93.5
HYKS-03212PP	White	Polypropylene	14	20	116.5
HYKS-05712PP	White	Polypropylene	16.3	23.4	139.3
HYKS-07612PP	White	Polypropylene	20.9	27.7	169.5

## 12 Pole Nylon Pillar Terminal Block



PA35	Natural	Nylon PA6.6	15.2	15	93.5
PA27XA1F01-12	Natural	Nylon PA6.6	17.8	20	117
PA44	Natural	Nylon PA6.6	20	23	139.3
PA76	Natural	Nylon PA6.6	25.5	25	174.5
PA220	Natural	Nylon PA6.6	32	30	175.2

## 12 Pole Nylon Pillar Terminal Block, Wire Protection



PA35WP	Natural	Nylon PA6.6	15.2	15	93.5
PA27XA1F01-12P	Natural	Nylon PA6.6	17.8	20	117
PA44WP	Natural	Nylon PA6.6	20	23	139.3
PA76WP	Natural	Nylon PA6.6	25.5	25	174.5

## 12 Pole Pillar Terminal Block, High Temp. Glass Filled Nylon



PA35FV	Red/Brown	Polyamide Glass Fibre reinforced	15.2	15	93.5
FV27XA1F01-12	Red/Brown	Polyamide Glass Fibre reinforced	17.8	20	117
PA44FV	Red/Brown	Polyamide glass fibre reinforced	20	23	139.3
PA76FV	Red/Brown	Polyamide Glass Fibre reinforced	25.5	25	174.5
PA220FV	Red/Brown	Polyamide Glass Fibre reinforced	32	30	175.2

## 12 Pole Pillar Terminal Block, High Temp. Glass Filled Nylon With Wire Protection



PA35FVWP	Red/Brown	Polyamide Glass Fibre reinforced	15.2	15	93.5
FV27XA1F01-12P	Red/Brown	Polyamide Glass Fibre reinforced	17.8	20	117
PA44FVWP	Red/Brown	Polyamide Glass Fibre reinforced	20	23	139.3
PA76FVWP	Red/Brown	Polyamide Glass Fibre reinforced	25.5	25	174.5

# Nylon Pillar Terminal Blocks

## Features:

- 12 way plug and socket terminal strip can be cut to pole lengths required
- IP 30 plug/socket connectors in 3,4 & 5 pole with latch options for lighting applications
- Modular assembly allows rapid disconnection/reconnection for testing and/or replacement units
- GST Style connectors VDE Approved to mate with Wieland and Adels equivalents



### 12 way plug & Skt connector strip

Product Code	Colour	Poles	Material	H (mm)	W (mm)	L (mm)
HYPS-01712	Natural	12	Polyamide	14	23	115



### IP30 Plug & Socket Lighting Connectors

HYGST-30PSK	Black	3	Polyamide			
HYGST-3LPSK	Black	3	Polyamide			
HYGST-4LPSK	Black	4	Polyamide			
HYGST-5LPSK	Black	5	Polyamide			



## Kwik Wire Connector

### Features:

- Temp range :-20 to 100°C
- Colour coded Thermoplastic 94-V2
- 2-8 way commoning blocks - Pushwire
- Moulded Dovetail for stacking.
- Push insertion and twist release and with test slot



Product Code	Colour	Poles	H (mm)	W (mm)	L (mm)
HYKW-02	Red	2	10	18	10
HYKW-03	Orange	3	10	18	12
HYKW-04	Yellow	4	10	18	17
HYKW-05	Grey	5	10	18	20
HYKW-08	Black	8	10	18	30



T: +44 (0)1933 234400 ■ E: [sales@hylec-apl.com](mailto:sales@hylec-apl.com)  
F: +44 (0)1933 234411 ■ W: [www.hylec-apl.com](http://www.hylec-apl.com)  
6 Stanton Close, Finedon Road Industrial Estate, Wellingborough, Northants, NN8 4HN

## X-ON Electronics

Largest Supplier of Electrical and Electronic Components

*Click to view similar products for [hylec manufacturer](#):*

Other Similar products are found below :

[LN167001](#) [50.625 PA/3X7](#) [50.620 PA/R](#) [DESTB-1003](#) [THB.406.A1G](#) [THB.387.A4A.R](#) [K150-1032-00](#) [GHG9601955R0004](#) [K151-1032-00](#)  
[HYKS-07612PP](#) [THB.382.A1A-KIT](#) [THB.390.A1AKIT](#) [THK.404.X2A00-F](#) [50.216 ES](#) [50.616M/EMVDL-F](#) [50.625 ES](#) [THB.405.A2A](#)  
[PA244SKIT](#) [50.220 M-F](#) [HY435/12 FV](#) [THB110A6B-F](#) [50.216 M-F](#) [5625////1121](#) [THB.380.3ASSY](#) [THB.405.A2G](#) [THA.209.A1A](#)  
[THB.387.B5A](#) [DESTB-1002](#) [THB.384.A1A](#) [K257-1012-00](#) [6000302CC](#) [TTK25BK-SD-F](#) [TTK20GY-SD-F](#) [DESTB-0403](#) [THB.384.B1A](#)  
[50.625 PA/RSW](#) [HY508/3 V/3F](#) [5665/221](#) [THB.387.A3A](#) [THB.387.D4A](#) [THB.387.B4A](#) [THR.405.S5A](#) [THB.381.M2A](#) [THB.387.A5A](#)  
[THB.387.C5A](#) [THB.387.D3A](#) [50.625 M/EMVDL-F](#) [THK.200.3T](#) [THB.381.A2A](#) [K160-1040-00](#)