

# AIMCO

**FASTENER TOOLS**

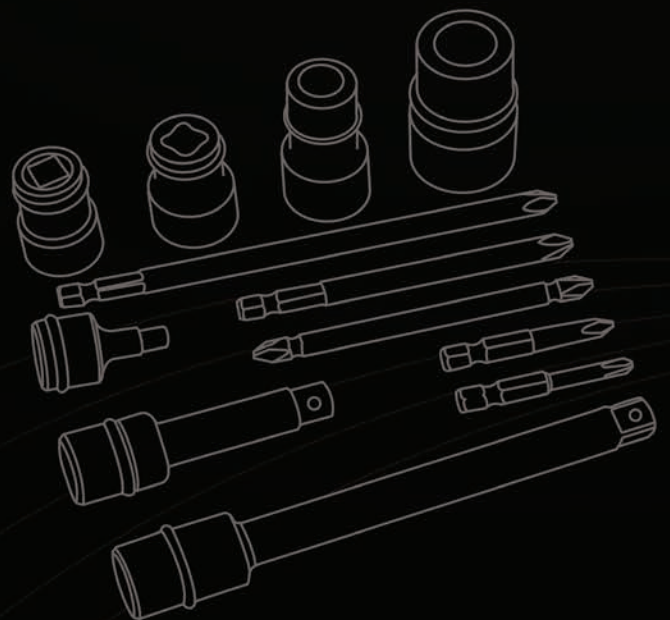



For over 40 years AIMCO has been working with manufacturers around the world, we are the complete global source for all assembly, fastening, and critical bolting needs. AIMCO can effectively and swiftly meet your needs whether you're in Thailand fastening a 3 mm nut at 3 Nm, or in Tennessee, USA torquing the last lug nut. AIMCO provides the tools and solutions, on a global scale, that guarantee the success of your project. It is with great pride that AIMCO can say the products that we manufacture are **MADE IN THE USA.**

# TABLE OF CONTENTS

## FASTENER TOOLS

|   |      |
|---|------|
| STANDARD FASTENER TOOLS . . . . .       | 4-5  |
| ERGO-DRIVE® SERIES <b>E</b> * . . . . . | 6-7  |
| CUSTOM / SPECIAL PARTS . . . . .        | 8-11 |
| CONVERSION CHARTS . . . . .             | 12   |



\* **E** logo indicates where ERGO-DRIVE sockets/extensions benefit tool operation.

ERGO-DRIVE sockets are uniquely designed to seat deeper on the tool anvil while an O-ring inside the socket fits tight onto the anvil to reduce vibration. By reducing run-out and vibration, ERGO-DRIVE sockets allow the most repeatable, accurate rundowns, ensuring excellent product quality, longer tool life, and better ergonomics for the tool user.

Look for the ERGO-DRIVE **E** logo in this catalog to see where ERGO-DRIVE sockets/extensions benefit tool operation, operator, and rundown. See page 6 for ERGO-DRIVE details.

# STANDARD FASTENER TOOLS

## EXTENSIONS

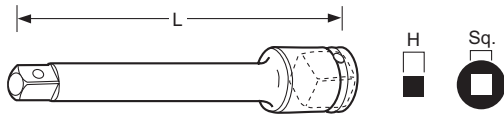

| PART NO | SQ DRIVE | HEX    | L MM | L IN  | D MM | D IN |
|---------|----------|--------|------|-------|------|------|
| A375E   | 3/8"     | 3/8"   | 75   | 2.95  | 20   | 0.79 |
| A405E   | 1/2"     | 1/2"   | 51   | 2.01  | 30   | 1.18 |
| A610E   | 3/4"     | 3/4"   | 100  | 3.94  | 44   | 1.73 |
| A810E   | 1"       | 1"     | 102  | 4.02  | 54   | 2.13 |
| A1220E  | 1-1/4"   | 1-1/4" | 200  | 7.87  | 60   | 2.36 |
| A1418E  | 1-1/2"   | 1-1/2" | 178  | 7.01  | 84   | 3.31 |
| A2426E  | 2-1/2"   | 2-1/2" | 264  | 10.39 | 137  | 5.39 |

## BIT HOLDERS



| PART NO                   | L MM | L IN |
|---------------------------|------|------|
| <b>1/4" Hex, Magnetic</b> |      |      |
| A3BHM-3                   | 75   | 2.94 |
| A3BHM-4                   | 100  | 3.94 |
| A3BHM-6                   | 150  | 5.91 |
| A3BHM-8                   | 200  | 7.87 |
| A3BHM-10                  | 250  | 9.84 |

## SOCKET ADAPTERS



| PART NO | FEMALE SQ. DRIVE | MALE SQ. DRIVE | D MM | D IN | L MM | L IN |
|---------|------------------|----------------|------|------|------|------|
| A302A   | 3/8"             | 1/4"           | 22   | 0.87 | 35   | 1.38 |
| A403A   | 1/2"             | 3/8"           | 25   | 0.98 | 37   | 1.46 |
| A504A   | 5/8"             | 1/2"           | 35   | 1.38 | 47   | 1.46 |
| A604A   | 3/4"             | 1/2"           | 38   | 1.50 | 53   | 2.09 |
| A806A   | 1"               | 3/4"           | 50   | 1.97 | 70   | 2.76 |
| A128A   | 1-1/4"           | 1"             | 60   | 2.36 | 76   | 2.99 |
| A#508A  | Spline #5        | 1"             | 60   | 2.36 | 90   | 3.54 |

## UNIVERSAL SOCKETS



| PART NO                  | HEX   | D1 MM | D1 IN | D2 MM | D2 IN | L MM | L IN |
|--------------------------|-------|-------|-------|-------|-------|------|------|
| <b>3/8" Square Drive</b> |       |       |       |       |       |      |      |
| A310U                    | 10 mm | 16    | 0.63  | 20    | 0.79  | 55   | 2.17 |
| A311U                    | 11 mm | 16    | 0.63  | 20    | 0.79  | 60   | 2.36 |
| <b>1/2" Square Drive</b> |       |       |       |       |       |      |      |
| A412U                    | 12 mm | 20.5  | 0.81  | 25    | 0.98  | 70   | 2.76 |
| A413U                    | 13 mm | 19    | 0.75  | 24    | 0.95  | 70   | 2.76 |

## Description of Bits and Nutsetters Part Number Nomenclature

### Precedes Part Number

#### BITS

|       |                                     |
|-------|-------------------------------------|
| A3S   | = Phillips® Power Drive             |
| A3W   | = Double Ended Phillips®            |
| A38S  | = Phillips® Insert                  |
| A39S  | = Phillips® Insert Reduced Nose     |
| A3M   | = Slotted Power Drive               |
| A38M  | = Slotted Insert                    |
| A3MT  | = Slotted Power Drive Reduced Nose  |
| A3C   | = Allen Socket Head Power Drive     |
| A38C  | = Allen Socket Head Insert          |
| A3R   | = Square Recess Power Drive         |
| A3RT  | = Square Recess Turned Down (Power) |
| A38R  | = Square Recess Insert              |
| A3T   | = Torx® Power Drive                 |
| A38T  | = Torx® Insert                      |
| A3TS  | = Torq-Set® Power Drive             |
| A38TS | = Torq-Set® Insert                  |
| A3TA  | = Triangle Power Drive              |
| A3TW  | = Tri-Wing® Power Drive             |
| A38TW | = Tri-Wing® Insert                  |
| A7    | = 7/16 Power Drive                  |
| AS    | = Electric Type Phillips®           |

#### BITS (Cont.)

|       |                                     |
|-------|-------------------------------------|
| AM    | = Electric Type Slotted             |
| ATW   | = Electric Type Tri-Wing®           |
| AT    | = Electric Hios Type Torx®          |
| A26S  | = Electric Driver Phillips®         |
| A26M  | = Electric Driver Slotted           |
| A26C  | = Electric Driver Allen Socket Head |
| A3BHM | = Insert Bit Holder (Magnetic Type) |
| A3BHD | = Insert Bit Holder (Non Magnetic)  |

#### NUTSETTERS

|       |                               |
|-------|-------------------------------|
| A3B   | = Nutsetter                   |
| A3BMP | = Magnetic (MP) Pressed Type  |
| A3BMS | = Magnetic (MS) Spring Loaded |
| A3BMT | = Magnetic (MT) Tube Type     |
| A3BU  | = Universal Nutsetter         |

#### MAG-O-NETS

|    |                    |
|----|--------------------|
| AM | = AIMCO Mag-O-Net® |
|----|--------------------|

### Contained Within Part Number

#### BITS

|       |                                    |
|-------|------------------------------------|
| PZ    | = Pozidriv®                        |
| PZACR | = Pozidriv® ACR®                   |
| SDV   | = Supadriv®                        |
| TR    | = Torx® Tamper Resistant           |
| ACRI  | = ACR® Installation                |
| ACR   | = ACR® Remove                      |
| ACRB  | = ACR® 4x4 Both Install and Remove |
| E4    | = Electric 4mm diameter            |
| E5    | = Electric 5mm diameter            |
| RS    | = Reduced Shank                    |

Additional types and sizes of fastener tools are available upon request. Contact AIMCO at 1-800-852-1368.

# STANDARD FASTENER TOOLS

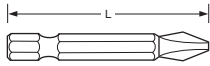

| PART NO   | POINT SIZE | L MM | L IN |
|-----------|------------|------|------|
| A3S0-2    | 0          | 50   | 1.97 |
| A3S1-2    | 1          | 50   | 1.97 |
| A3S1-2.75 | 1          | 70   | 2.76 |
| A3S1-3    | 1          | 75   | 2.95 |
| A3S1-3.5  | 1          | 90   | 3.54 |
| A3S1-4    | 1          | 100  | 3.94 |
| A3S1-6    | 1          | 150  | 5.91 |
| A3S2-1.2  | 2          | 30   | 1.18 |
| A3S2-1.6  | 2          | 40   | 1.57 |
| A3S3-2    | 3          | 50   | 1.97 |
| A3S3-2.75 | 3          | 70   | 2.76 |

## Double-Ended

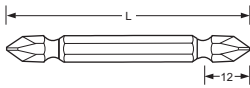

|         |   |     |       |
|---------|---|-----|-------|
| A3W1-3  | 1 | 75  | 2.94  |
| A3W1-4  | 1 | 100 | 3.94  |
| A3W2-2  | 2 | 50  | 1.97  |
| A3W2-3  | 2 | 75  | 2.94  |
| A3W2-4  | 2 | 100 | 3.94  |
| A3W2-6  | 2 | 150 | 5.91  |
| A3W2-8  | 2 | 200 | 7.87  |
| A3W2-10 | 2 | 250 | 9.84  |
| A3W2-12 | 2 | 300 | 11.81 |
| A3W3-2  | 3 | 50  | 1.97  |
| A3W3-3  | 3 | 75  | 2.94  |
| A3W3-4  | 3 | 100 | 3.94  |
| A3W3-6  | 3 | 150 | 5.91  |
| A3W3-8  | 3 | 200 | 7.87  |

## TORX POWER BITS



| PART NO   | TORX SIZE | L MM | L IN |
|-----------|-----------|------|------|
| A3T6-2    | T6        | 50   | 1.97 |
| A3T7-2    | T7        | 50   | 1.97 |
| A3T7-2.75 | T7        | 70   | 2.76 |
| A3T7-3.5  | T7        | 90   | 3.54 |
| A3T7-6    | T7        | 150  | 5.91 |
| A3T8-2    | T8        | 50   | 1.97 |
| A3T9-2.75 | T9        | 70   | 2.76 |

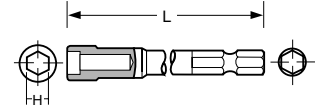

| PART NO     | HEX    | L MM | L IN |
|-------------|--------|------|------|
| A3B1/4-2    | 1/4"   | 50   | 1.97 |
| A3B1/4-2.5  | 1/4"   | 63   | 2.50 |
| A3B5/16-2   | 5/16"  | 50   | 1.97 |
| A3B5/16-2.5 | 5/16"  | 63   | 2.50 |
| A3B3/8-2    | 3/8"   | 50   | 1.97 |
| A3B3/8-2.5  | 3/8"   | 63   | 2.50 |
| A3B05-2.75  | 5 mm   | 70   | 2.76 |
| A3B55-1.2   | 5.5 mm | 30   | 1.18 |
| A3B55-2.75  | 5.5 mm | 70   | 2.76 |
| A3B55-4     | 5.5 mm | 100  | 3.94 |
| A3B06-2.75  | 6 mm   | 70   | 2.76 |
| A3B07-1.2   | 7 mm   | 30   | 1.18 |
| A3B07-2     | 7 mm   | 50   | 1.97 |
| A3B07-2.75  | 7 mm   | 70   | 2.76 |
| A3B07-4     | 7 mm   | 100  | 3.94 |
| A3B08-1.2   | 8 mm   | 30   | 1.18 |
| A3B08-2     | 8 mm   | 50   | 1.97 |
| A3B08-2.75  | 8 mm   | 70   | 2.76 |
| A3B08-4     | 8 mm   | 100  | 3.94 |
| A3B08-6     | 8 mm   | 150  | 5.91 |
| A3B08-8     | 8 mm   | 200  | 7.87 |
| A3B09-2.75  | 9 mm   | 70   | 2.76 |
| A3B09-4     | 9 mm   | 100  | 3.94 |
| A3B10-1.2   | 10 mm  | 30   | 1.18 |
| A3B10-2     | 10 mm  | 50   | 1.97 |
| A3B10-2.75  | 10 mm  | 70   | 2.76 |
| A3B11-2.75  | 11 mm  | 70   | 2.76 |
| A3B12-1.2   | 12 mm  | 30   | 1.18 |
| A3B13-2.75  | 13 mm  | 70   | 2.76 |
| A3B14-2.75  | 14 mm  | 70   | 2.76 |
| A3B16-2.75  | 16 mm  | 70   | 2.76 |
| A3B17-2.75  | 17 mm  | 70   | 2.76 |

## MAG-O-NETS®\*

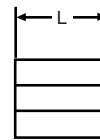
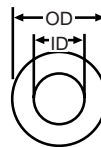

\*U.S. Patent 5861789

| PART NO | TORX SIZE | L MM    | L IN  |
|---------|-----------|---------|-------|
| AM1/4Z  | 7 mm      | 19 mm   | 10 mm |
| AM5Z    | 6 mm      | 17.5 mm | 10 mm |
| AM3/16Z | 3/16      | 17.5 mm | 10 mm |

**For custom parts, please contact us for more information, 1-800-852-1368.**

Additional types and sizes of fastener tools are available upon request. Contact AIMCO at 1-800-852-1368.

# ERGO-DRIVE® SERIES

## ERGO-DRIVE® SOCKETS PROTECT...

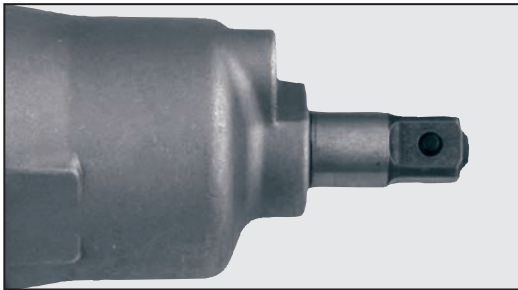

### ...YOUR INVESTMENT!

Pulse tools are an investment and the anvil is the most expensive single part of any pulse tool. ERGO-DRIVE® sockets decrease vibration and wear on this critical component.

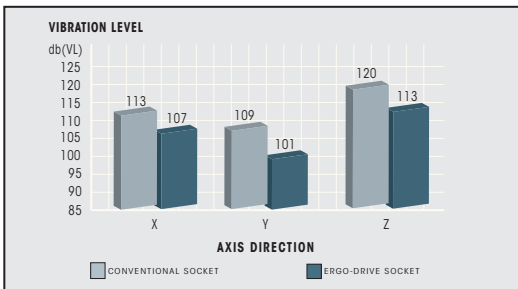
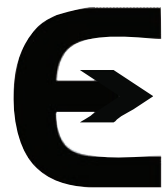

### ...YOUR ASSEMBLERS!

ERGO-DRIVE® sockets cause significantly less vibration during fastening than conventional sockets. This allows your assemblers to do their jobs without the worry of vibration related injuries.

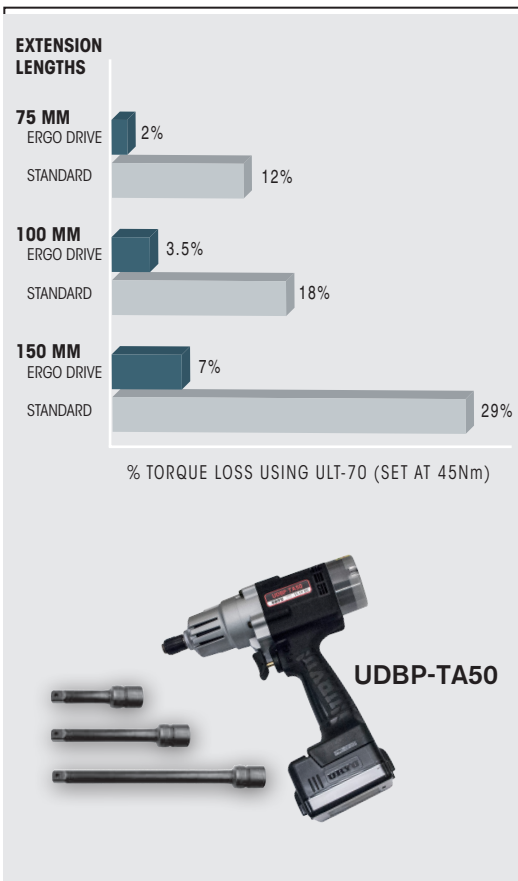

### ...YOUR PRODUCTS!

By reducing run-out and vibration, ERGO-DRIVE® sockets allow the most repeatable, accurate rundowns to take place, ensuring excellent product quality.

## ERGO-DRIVE® VS. STANDARD

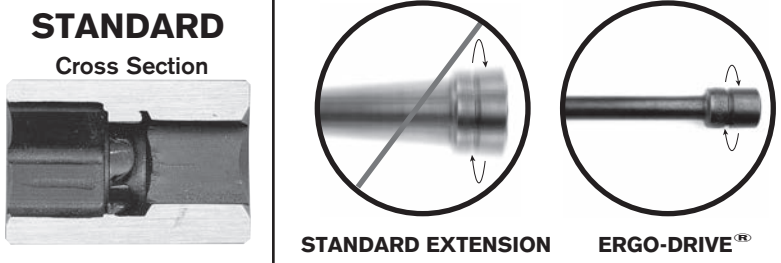

# ERGO-DRIVE® FASTENER TOOLS

## ERGO-DRIVE® SOCKETS

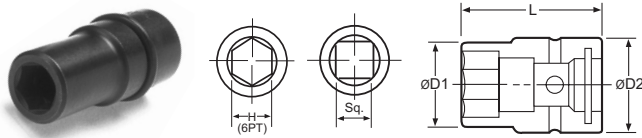

| PART NO | HEX | D1<br>MM | D1<br>IN | D2<br>MM | D2<br>IN | L<br>MM | L<br>IN |
|---------|-----|----------|----------|----------|----------|---------|---------|
|---------|-----|----------|----------|----------|----------|---------|---------|

| 3/8" Square Drive |       |    |      |    |      |    |      |
|-------------------|-------|----|------|----|------|----|------|
| A314EDS           | 1/4"  | 10 | 0.39 | 19 | 0.75 | 44 | 1.73 |
| A312EDS           | 1/2"  | 20 | 0.77 | 22 | 0.87 | 44 | 1.73 |
| A306EDS           | 6 mm  | 10 | 0.39 | 19 | 0.75 | 44 | 1.73 |
| A308EDS           | 8 mm  | 14 | 0.55 | 20 | 0.79 | 42 | 1.65 |
| A310EDS           | 10 mm | 17 | 0.65 | 20 | 0.79 | 42 | 1.65 |
| A312EDS           | 12 mm | 20 | 0.79 | 20 | 0.79 | 42 | 1.65 |
| A314EDS           | 14 mm | 22 | 0.87 | 20 | 0.79 | 42 | 1.65 |
| A316EDS           | 16 mm | 25 | 0.98 | 20 | 0.79 | 45 | 1.77 |
| A318EDS           | 18 mm | 27 | 1.06 | 20 | 0.79 | 45 | 1.77 |

| 1/2" Square Drive |       |    |      |    |      |    |      |
|-------------------|-------|----|------|----|------|----|------|
| A412EDS           | 1/2"  | 19 | 0.75 | 25 | 0.98 | 50 | 1.97 |
| A413EDS           | 13 mm | 22 | 0.85 | 25 | 0.98 | 52 | 2.05 |
| A414EDS           | 14 mm | 23 | 0.89 | 25 | 0.98 | 52 | 2.05 |
| A415EDS           | 15 mm | 24 | 0.93 | 25 | 0.98 | 52 | 2.05 |
| A416EDS           | 16 mm | 25 | 0.98 | 25 | 0.98 | 52 | 2.05 |
| A417EDS           | 17 mm | 28 | 1.10 | 28 | 1.10 | 54 | 2.13 |
| A418EDS           | 18 mm | 29 | 1.14 | 28 | 1.10 | 54 | 2.13 |
| A419EDS           | 19 mm | 30 | 1.18 | 28 | 1.10 | 54 | 2.13 |

| 3/4" Square Drive |        |    |      |    |      |    |      |
|-------------------|--------|----|------|----|------|----|------|
| A61-1/8EDS        | 1-1/8" | 44 | 1.73 | 44 | 1.73 | 64 | 2.52 |
| A61-1/4EDS        | 1-1/4" | 49 | 1.91 | 44 | 1.73 | 66 | 2.60 |
| A61-1/2EDS        | 1-1/2" | 57 | 2.24 | 44 | 1.73 | 68 | 2.68 |
| A618EDS           | 18 mm  | 31 | 1.22 | 44 | 1.73 | 60 | 2.36 |
| A624EDS           | 24 mm  | 40 | 1.52 | 40 | 1.73 | 65 | 2.36 |

| 1" Square Drive |        |     |      |    |      |     |      |
|-----------------|--------|-----|------|----|------|-----|------|
| A815/16EDS      | 15/16" | 38  | 1.50 | 54 | 2.13 | 69  | 2.72 |
| A8100EDS        | 100 mm | 136 | 5.35 | 76 | 2.99 | 120 | 4.72 |

## SEE ALSO: STUD BOLT SOCKETS

| PART NO  | THREAD<br>SIZE | LENGTH<br>MM | LENGTH<br>IN | DRIVE<br>IN |
|----------|----------------|--------------|--------------|-------------|
| A314P20  | 1/4-20"        | 55           | 2.17         | 3/8         |
| A305P0.8 | M5             | 42           | 1.65         | 3/8         |
| A414P20  | 1/4-20"        | 65           | 2.59         | 1/2         |
| A408P1.0 | M6             | 50           | 1.97         | 1/2         |

## ERGO-DRIVE® EXTENSIONS

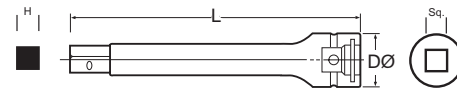

| PART NO | SQ<br>DRIVE | H | L<br>MM | L<br>IN | D<br>MM | D<br>IN |
|---------|-------------|---|---------|---------|---------|---------|
|---------|-------------|---|---------|---------|---------|---------|

| 3/8" Square Drive |      |      |     |       |    |      |
|-------------------|------|------|-----|-------|----|------|
| A352EDE           | 3/8" | 3/8" | 52  | 2.05  | 20 | 0.79 |
| A3100EDE          | 3/8" | 3/8" | 100 | 3.94  | 20 | 0.79 |
| A375EDE           | 3/8" | 3/8" | 75  | 2.95  | 20 | 0.79 |
| A3150EDE          | 3/8" | 3/8" | 150 | 5.91  | 20 | 0.79 |
| A3190EDE          | 3/8" | 3/8" | 190 | 7.48  | 20 | 0.79 |
| A3254EDE          | 3/8" | 3/8" | 254 | 10.00 | 20 | 0.79 |
| A3300EDE          | 3/8" | 3/8" | 300 | 11.81 | 20 | 0.79 |
| A3320EDE          | 3/8" | 3/8" | 320 | 12.60 | 20 | 0.79 |

| 1/2" Square Drive |      |      |     |       |    |      |
|-------------------|------|------|-----|-------|----|------|
| A464EDE           | 1/2" | 1/2" | 64  | 2.52  | 28 | 1.10 |
| A476EDE           | 1/2" | 1/2" | 76  | 2.99  | 28 | 1.10 |
| A4125EDE          | 1/2" | 1/2" | 125 | 4.92  | 28 | 1.10 |
| A4204EDE          | 1/2" | 1/2" | 204 | 8.03  | 28 | 1.10 |
| A4254EDE          | 1/2" | 1/2" | 254 | 10.00 | 28 | 1.10 |
| A4355EDE          | 1/2" | 1/2" | 355 | 13.98 | 28 | 1.10 |

| 3/4" Square Drive |      |      |     |      |    |      |
|-------------------|------|------|-----|------|----|------|
| A676EDE           | 3/4" | 3/4" | 76  | 2.99 | 40 | 1.58 |
| A6100EDE          | 3/4" | 3/4" | 100 | 3.94 | 40 | 1.58 |
| A6150EDE          | 3/4" | 3/4" | 150 | 5.91 | 40 | 1.58 |
| A6200EDE          | 3/4" | 3/4" | 200 | 7.87 | 40 | 1.58 |

| 1" Square Drive |    |    |     |      |    |      |
|-----------------|----|----|-----|------|----|------|
| A8150EDE        | 1" | 1" | 150 | 5.91 | 54 | 2.13 |
| A8200EDE        | 1" | 1" | 200 | 7.87 | 54 | 2.13 |

## QUICK CHANGE CHUCKS



| PART NO | SQUARE DRIVE | HEX |
|---------|--------------|-----|
|---------|--------------|-----|

| 3/8" Square Drive |      |       |
|-------------------|------|-------|
| ADC-3SEDSQ        | 3/8" | 1/4"  |
| ADC-3SEDSQH7/16   | 3/8" | 7/16" |

| 1/2" Square Drive |      |       |
|-------------------|------|-------|
| ADC-4SEDSQ        | 1/2" | 1/4"  |
| ADC-4SEDSQH7/16   | 1/2" | 7/16" |

Additional types and sizes of fastener tools are available upon request. Contact AIMCO at 1-800-852-1368.

# CUSTOM BITS, SOCKETS, AND EXTENSIONS

## CUSTOM BITS, SOCKETS, AND EXTENSIONS FOR THE POWER TOOL USER

AIMCO can provide specials for virtually any application. From design to delivery, AIMCO's quick response ensures high quality, tight tolerance specials.

### Specials are available in every style including:

- Deep Socket
- Extended Socket
- Universal
- Allen Head
- Torx Head
- Socket Adapter
- Nut Runner Socket
- Nut Runner Joint
- Nutsetter
- Magnetic Nutsetter
- Universal Nutsetter
- Screwdriver Bits



Sample request forms are shown. Your detailed requirements will allow AIMCO to quickly respond with custom solutions for your fastening requirements.

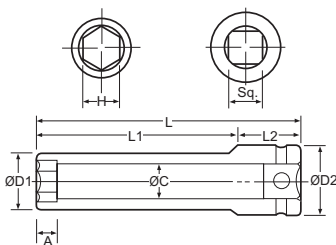

### SOCKET

| Magnet<br>MP / MT / MS | H | L | L <sub>1</sub> | L <sub>2</sub> | A | ØC | ØD <sub>1</sub> | ØD <sub>2</sub> | Sq. |
|------------------------|---|---|----------------|----------------|---|----|-----------------|-----------------|-----|
| SIZE                   |   |   |                |                |   |    |                 |                 |     |
| TYPE                   |   |   |                |                |   |    |                 |                 |     |



# SPECIAL PARTS

## SOCKET TYPES:

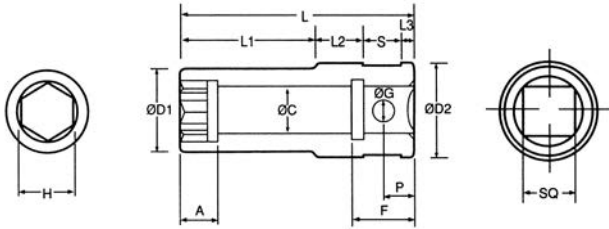

DOUBLE HEX D (12 PT) (DH)



SURFACE DRIVE (SF)



DOUBLE SQUARE (DSQ)



FLANK DRIVE (FD)



SINGLE HEX H (6 PT) (SH)



FAST LEAD (FL)



SINGLE SQUARE (SQ)



HEX LOBULE (TORX)

### NUTRUNNER SOCKET TYPE A

Min. Qty. 10

| Magnet<br>MP MT MS | H | L | L <sub>1</sub> | L <sub>2</sub> | L <sub>3</sub> | S | ØD <sub>1</sub> | A | ØC | ØG | P | F | ØD <sub>2</sub> | Sq. | Qty. |
|--------------------|---|---|----------------|----------------|----------------|---|-----------------|---|----|----|---|---|-----------------|-----|------|
| SIZE               |   |   |                |                |                |   |                 |   |    |    |   |   |                 |     |      |
| TYPE               |   |   |                |                |                |   |                 |   |    |    |   |   |                 |     |      |

√ Box for Ergo-Drive

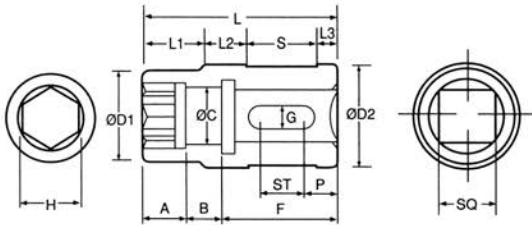

### NUTRUNNER SOCKET TYPE B

Min. Qty. 10

| H    | L | L <sub>1</sub> | L <sub>2</sub> | L <sub>3</sub> | S | ØD <sub>1</sub> | A | B | ØC | G | P | F | ST | ØD <sub>2</sub> | Sq. | Qty. |
|------|---|----------------|----------------|----------------|---|-----------------|---|---|----|---|---|---|----|-----------------|-----|------|
| SIZE |   |                |                |                |   |                 |   |   |    |   |   |   |    |                 |     |      |
| TYPE |   |                |                |                |   |                 |   |   |    |   |   |   |    |                 |     |      |

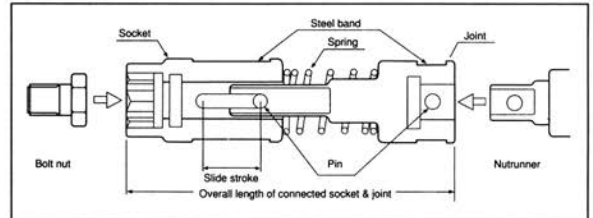
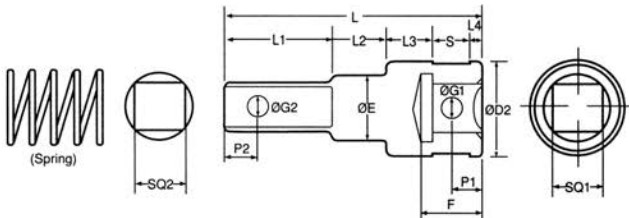

### NUTRUNNER JOINT TYPE B

Min. Qty. 10

| SQ <sub>2</sub> | L | L <sub>1</sub> | L <sub>2</sub> | L <sub>3</sub> | L <sub>4</sub> | S | P <sub>1</sub> | ØG <sub>2</sub> | ØE | F | ØG <sub>1</sub> | P <sub>2</sub> | ØD <sub>2</sub> | SQ <sub>1</sub> | Qty. |
|-----------------|---|----------------|----------------|----------------|----------------|---|----------------|-----------------|----|---|-----------------|----------------|-----------------|-----------------|------|
|                 |   |                |                |                |                |   |                |                 |    |   |                 |                |                 |                 |      |
|                 |   |                |                |                |                |   |                |                 |    |   |                 |                |                 |                 |      |

√ Box for Ergo-Drive

### NUT SETTER

Min. Qty. 10

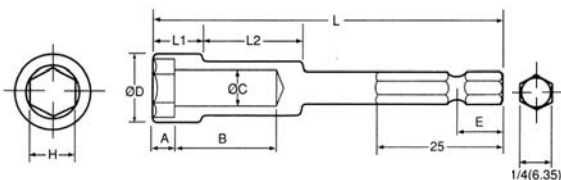

| H    | ØD | L | E | L <sub>1</sub> | L <sub>2</sub> | A | B | ØC | Qty. |
|------|----|---|---|----------------|----------------|---|---|----|------|
| SIZE |    |   |   |                |                |   |   |    |      |
| TYPE |    |   |   |                |                |   |   |    |      |

# SPECIAL PARTS

## MAGNETIC STYLES:

MP (Press-inserted) Type

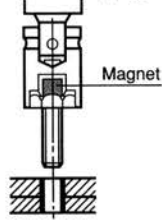

MS (Sliding) Type

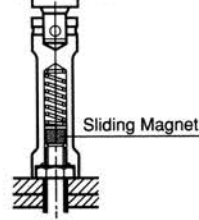

MT (Tube) Type

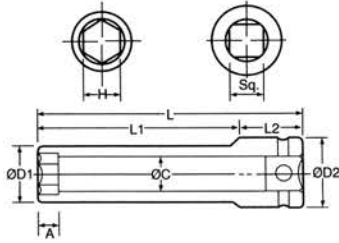
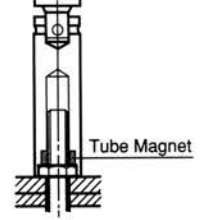

## SOCKET

Min. Qty. 10

| Magnet |    |    | H    | L | L <sub>1</sub> | L <sub>2</sub> | A | ØC | ØD <sub>1</sub> | ØD <sub>2</sub> | Sq. | Qty. |
|--------|----|----|------|---|----------------|----------------|---|----|-----------------|-----------------|-----|------|
| MP     | MT | MS | SIZE |   |                |                |   |    |                 |                 |     |      |
|        |    |    | TYPE |   |                |                |   |    |                 |                 |     |      |

√ Box for Ergo-Drive

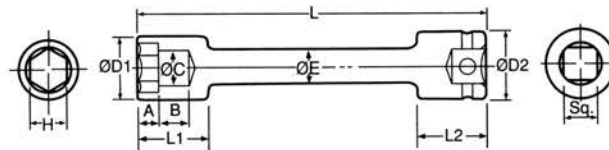

## EXTENSION SOCKET

Min. Qty. 10

| Magnet |    |    | H    | L | L <sub>1</sub> | L <sub>2</sub> | A | B | ØC | ØD <sub>1</sub> | ØD <sub>2</sub> | ØE | Sq. | Qty. |
|--------|----|----|------|---|----------------|----------------|---|---|----|-----------------|-----------------|----|-----|------|
| MP     | MT | MS | SIZE |   |                |                |   |   |    |                 |                 |    |     |      |
|        |    |    | TYPE |   |                |                |   |   |    |                 |                 |    |     |      |

√ Box for Ergo-Drive

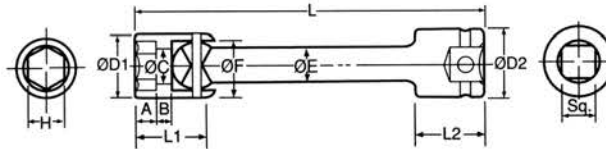

## UNIVERSAL SOCKET

Min. Qty. 10

| Magnet |    |    | H    | L | L <sub>1</sub> | L <sub>2</sub> | A | B | ØC | ØD <sub>1</sub> | ØD <sub>2</sub> | ØE | ØF | Sq. | Qty. |
|--------|----|----|------|---|----------------|----------------|---|---|----|-----------------|-----------------|----|----|-----|------|
| MP     | MT | MS | SIZE |   |                |                |   |   |    |                 |                 |    |    |     |      |
|        |    |    | TYPE |   |                |                |   |   |    |                 |                 |    |    |     |      |

√ Box for Ergo-Drive

## ALLEN HEAD/TORX HEAD

Min. Qty. 10

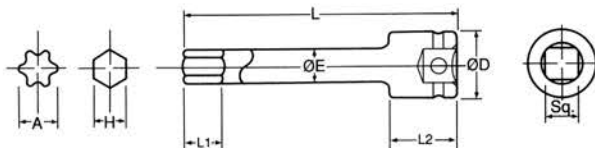

| Torx | H | L | L <sub>1</sub> | L <sub>2</sub> | ØD | ØE | Sq. | Qty. |
|------|---|---|----------------|----------------|----|----|-----|------|
|      |   |   |                |                |    |    |     |      |

√ Box for Ergo-Drive

## SOCKET ADAPTER

Min. Qty. 10

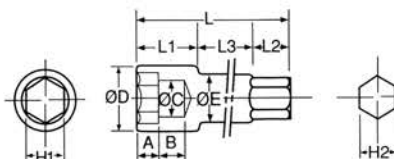

| H <sub>1</sub> | L | L <sub>1</sub> | L <sub>2</sub> | L <sub>3</sub> | ØD | A | B | ØC | ØE | H <sub>2</sub> | Qty. |
|----------------|---|----------------|----------------|----------------|----|---|---|----|----|----------------|------|
| SIZE           |   |                |                |                |    |   |   |    |    |                |      |
| TYPE           |   |                |                |                |    |   |   |    |    |                |      |

# SPECIAL PARTS

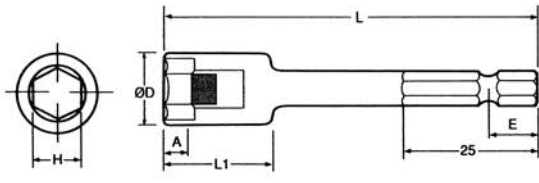

**(MP) MAGNETIC NUT SETTER**

Min. Qty. 10

|      | H | L | E | L <sub>1</sub> | ØD | A | Qty. |
|------|---|---|---|----------------|----|---|------|
| SIZE |   |   |   |                |    |   |      |
| TYPE |   |   |   |                |    |   |      |

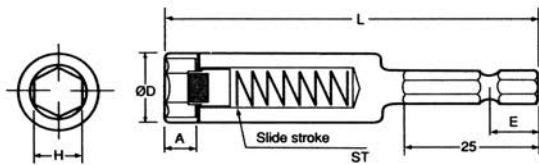

**(MS) MAGNETIC NUT SETTER**

Min. Qty. 10

|      | H | L | E | ØD | A | ST | Qty. |
|------|---|---|---|----|---|----|------|
| SIZE |   |   |   |    |   |    |      |
| TYPE |   |   |   |    |   |    |      |

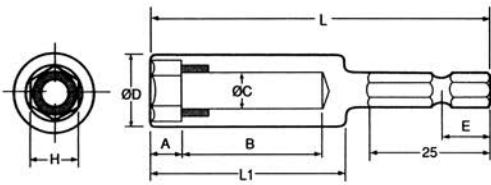

**(MT) MAGNETIC NUT SETTER**

Min. Qty. 10

|      | H | L | E | L <sub>1</sub> | ØD | A | B | ØC | Qty. |
|------|---|---|---|----------------|----|---|---|----|------|
| SIZE |   |   |   |                |    |   |   |    |      |
| TYPE |   |   |   |                |    |   |   |    |      |

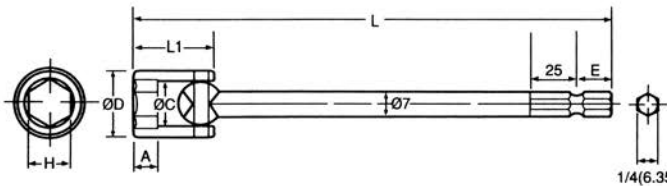

**UNIVERSAL NUT SETTER**

Min. Qty. 10

|  | H | L | E | L <sub>1</sub> | A | ØC | ØD | Qty. |
|--|---|---|---|----------------|---|----|----|------|
|  |   |   |   |                |   |    |    |      |

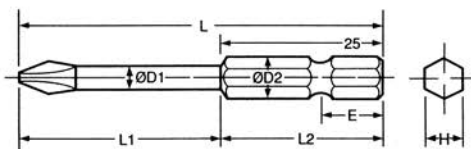

**CIRCLE ONE:**

**SCREWDRIVER BIT**

Min. Qty. 500

|  | Point Size | L | L <sub>1</sub> | L <sub>2</sub> | ØD <sub>1</sub> | ØD <sub>2</sub> | E | H | Qty. |
|--|------------|---|----------------|----------------|-----------------|-----------------|---|---|------|
|  |            |   |                |                |                 |                 |   |   |      |



Phillips®



Slotted



Torx®



Torx®  
Tamper Resistant



Pozidriv®



Supadriv®



Square Recess



Allen Head



Torq-Set®



Tri-Wing®

# CONVERSION CHARTS

## Fraction ■ Decimal ■ Metric Conversions (to .32)

|      | Decimal | mm     |       | Decimal | mm      |       | Decimal | mm      |       | Decimal | mm      |
|------|---------|--------|-------|---------|---------|-------|---------|---------|-------|---------|---------|
| 1/32 | .03125  | .7938  | 9/32  | .28125  | 7.1438  | 17/32 | .53125  | 13.4938 | 25/32 | .78125  | 19.8438 |
| 1/16 | .0625   | 1.5875 | 5/16  | .3125   | 7.9375  | 9/16  | .5625   | 14.2875 | 13/16 | .8125   | 20.6375 |
| 3/32 | .09375  | 2.3812 | 11/32 | .34375  | 8.7312  | 19/32 | .59375  | 15.0812 | 27/32 | .84375  | 21.4312 |
| 1/8  | .125    | 3.175  | 3/8   | .375    | 9.525   | 5/8   | .625    | 15.875  | 7/8   | .875    | 22.225  |
| 5/32 | .15625  | 3.9688 | 13/32 | .40625  | 10.3188 | 21/32 | .65625  | 16.6688 | 29/32 | .90625  | 23.0188 |
| 3/16 | .1875   | 4.7625 | 7/16  | .4375   | 11.1125 | 11/16 | .6875   | 17.4625 | 15/16 | .9375   | 23.8125 |
| 7/32 | .21875  | 5.5562 | 15/32 | .46875  | 11.9062 | 23/32 | .71875  | 18.2562 | 31/32 | .96875  | 24.6062 |
| 1/4  | .25     | 6.35   | 1/2   | .5      | 12.7    | 3/4   | .75     | 19.05   | 1     | 1.0     | 25.4    |

## Thread Size to Hex Size



|         | MM  |       | MM  | UNC   | INCHES  | SAE   | INCHES  |
|---------|-----|-------|-----|-------|---------|-------|---------|
| M 2     | 4   | M 27  | 41  | 1/4   | 7/16    | 1/4   | 7/16    |
| M 2.3   | 4.5 | M 30  | 46  | 5/16  | 1/2     | 5/16  | 1/2     |
| M 2.6   | 5   | M 33  | 50  | 3/8   | 9/16    | 3/8   | 9/16    |
| M 3     | 5.5 | M 36  | 55  | 7/16  | 11/16   | 7/16  | 5/8     |
| M 3.5   | 6   | M 39  | 60  | 1/2   | 3/4     | 1/2   | 3/4     |
| M 4     | 7   | M 42  | 65  | 9/16  | 7/8     | 9/16  | 7/8     |
| M 5     | 8   | M 45  | 70  | 5/8   | 15/16   | 5/8   | 15/16   |
| (M 5-6) | 9   | M 48  | 75  | 3/4   | 1-1/8   | 3/4   | 1-1/16  |
| M 6     | 10  | M 52  | 80  | 7/8   | 1-5/16  | 7/8   | 1-1/4   |
| M 7     | 11  | M 56  | 85  | 1     | 1-1/2   | 1-1/8 | 1-7/16  |
| M 8     | 13  | M 60  | 90  | 1-1/8 | 1-11/16 | 1-1/4 | 1-13/16 |
| (M 8)   | 14  | M 64  | 95  | 1-1/4 | 1-7/8   | 1-3/8 | 2       |
| M 10    | 16  | M 68  | 100 | 1-3/8 | 2-1/16  | 1-1/2 | 2-3/16  |
| (M 10)  | 17  | M 72  | 105 | 1-1/2 | 2-1/4   |       |         |
| M 12    | 18  | M 76  | 110 | 1-3/4 | 2-5/8   |       |         |
| (M 12)  | 19  | M 80  | 115 | 2     | 3       |       |         |
| M 14    | 21  | M 85  | 120 | 2-1/4 | 3-3/8   |       |         |
| (M 14)  | 22  | M 90  | 130 | 2-1/2 | 3-3/4   |       |         |
| M 16    | 24  | M 95  | 135 |       |         |       |         |
| M 18    | 27  | M 100 | 145 |       |         |       |         |
| M 20    | 30  | M 105 | 150 |       |         |       |         |
| (M 22)  | 32  | M 110 | 155 |       |         |       |         |
| M 22    | 34  | M 115 | 165 |       |         |       |         |
| M 24    | 36  | M 120 | 170 |       |         |       |         |

## Torque Conversion Factors

| Units to be | SAE     |        |         | METRIC |        |         | INTERNATIONAL SYSTEM - S.I. |       |        |
|-------------|---------|--------|---------|--------|--------|---------|-----------------------------|-------|--------|
| Converted   | ozf-in  | lbf-in | lbf-ft  | gf-cm  | kgf-cm | kgf-m   | mNm                         | cNm   | Nm     |
| 1 ozf-in    | = 1     | 0.0625 | 0.005   | 72     | 0.072  | 0.0007  | 7.062                       | 0.706 | 0.007  |
| 1 lbf-in    | = 16    | 1      | 0.083   | 1152.1 | 1.152  | 0.0115  | 113                         | 11.3  | 0.113  |
| 1 lbf-ft    | = 192   | 12     | 1       | 13826  | 13.83  | 0.138   | 1356                        | 135.6 | 1.356  |
| 1 gf-cm     | = 0.014 | 0.0009 | 0.00007 | 1      | 0.001  | 0.00001 | 0.098                       | 0.01  | 0.0001 |
| 1 kgf-cm    | = 13.89 | 0.868  | 0.072   | 1000   | 1      | 0.01    | 98.07                       | 9.807 | 0.098  |
| 1 kgf-m     | = 1389  | 86.8   | 7.233   | 100000 | 100    | 1       | 9807                        | 980.7 | 9.807  |
| 1 mN-m      | = 0.142 | 0.009  | 0.0007  | 10.2   | 0.01   | 0.0001  | 1                           | 0.1   | 0.001  |
| 1 cN-m      | = 1.42  | 0.088  | 0.007   | 102    | 0.102  | 0.001   | 10                          | 1     | 0.01   |
| 1 N-m       | = 141.6 | 8.851  | 0.738   | 10197  | 10.20  | 0.102   | 1000                        | 100   | 1      |









#### **AIMCO CORPORATE HEADQUARTERS**

10000 SE PINE STREET  
PORTLAND, OREGON 97216

PHONE: (503) 254-6600  
TOLL FREE: 1-800-852-1368

#### **AIMCO CORPORATION DE MEXICO SA DE CV**

AVE. CRISTOBAL COLON 14529  
CHIHUAHUA, CHIHUAHUA. 31125  
MEXICO

PHONE : (01-614) 380-1010  
FAX : (01-614) 380-1019

#### **AIMCO CHINA**

ROOM 607, NO.3998 HONGXIN RD,  
DIBAO PLAZA, MINHANG DISTRICT,  
SHANGHAI, 201103  
CHINA

PHONE: 0086-21-34319246  
FAX: 0086-21-34319245

#### **AIMCO EUROPE**

AVENIDA RÍO GALLO, 431  
19174 GALÁPAGOS - GUADALAJARA  
SPAIN

PHONE: +34 673 34 99 25

[WWW.AIMCO-GLOBAL.COM](http://WWW.AIMCO-GLOBAL.COM)

**FASTENER**



## **X-ON Electronics**

Largest Supplier of Electrical and Electronic Components

*Click to view similar products for [aimco](#) manufacturer:*

Other Similar products are found below :

[AM3/16](#)