

**ZONEX™ NON-METALLIC TERMINAL ENCLOSURE**

**INDUSTRY STANDARDS**
**ATEX Directive 94/9/EC**
**ATEX**

TUV 13 ATEX120808U

Ex e IIC Gb

Ex ta IIIC Da IP66

EN60079-0

EN60079-7

EN60079-31

Service temperature -50C to +100C

**IECEX**

IECEX TUV 13.0001U

Ex e IIC Gb

Ex ta IIIC Da IP66

IEC 60079-0

IEC 60079-7

IEC 60079-31

Service temperature -50C to +100C

Type 4, 4X, 12; File No. E61997

UL508A Listed

cUL Listed per CSA C22.2 No. 94; Type 4, 4X, 12; File No. E61997

NEMA / EEMAC Type 4, 4X, 12

IEC 60529, IP66

**APPLICATION**

ZONEX Non-Metallic Terminal Enclosure is ideal for field terminations in hazardous locations. The enclosure meets national and international standards and certifications. It can be used to protect equipment and terminations from corrosive contaminants while meeting rigorous demands. The cabinet is ideal for either panel- or din-mounted components. The enclosure meets ATEX Directives 94/9/EC and IECEX standards for increased safety in housing electrical components in Zone 1 and Zone 2 applications.

**FEATURES**

- Compression-molded, high-impact strength, fiberglass body and cover
- Cover includes recessed, retained, combination head (Straight blade, Phillips and Torx drive) M4 or M6 stainless steel Type 316 screws
- Retained, continuous, high-temperature silicon gasket within a labyrinth seal between cover and body
- Durable and reusable, internal M4 or M6 stainless steel inserts for DIN- and Panel-mounting
- Covered mounting screw provisions outside of gasketed area, sized M4 (#8) or M6 (1/4-in.)
- Mounting location dimensions are molded into the back side of the enclosure
- Panel mounting screws included, M4 or M6

**SPECIFICATIONS**

- Compression-molded fiberglass with added agents to address static charge build-up
- High-impact strength as well as high temperature-rated
- Increased Safety: Ex e applications
- Optional panels are pre-plated steel, 1.5mm (16 ga.) thick; or 2mm composite

**FINISH**

- Molded material has a smooth, low-gloss, black finish
- Cover screws are matte stainless steel finish

**ACCESSORIES**

Panels

Din Rail

Terminals

**NOTES**

Intrinsically safe terminal blocks can be installed through modification program to provide a populated enclosure. IECEX populated enclosures require IECEX certified components specifically listed in the approving Certification [see IECEX SIR 09.0100 for more detail].

**MODIFICATION AND CUSTOMIZATION**

Hoffman excels at modifying and customizing products to your specifications. Hoffman offers a ZONEX-specific modification program. Contact your local Hoffman Representative or Distributor for more information.

**BULLETIN: HL3**

Standard Product

Catalog Number	AxBxC mm/in.	F in./mm	G in./mm	H in./mm	I in./mm	J in./mm	Mounting Screw Size mm/in.	Panel	Panel Material	Panel Size mm/in.
EXE807555	80 x 75 x 55 3.15 x 2.95 x 2.17	.17 4	.57 15	.59 15	1.65 42	.23 6	4 #8	A8075P	Composite	69 x 64 x 2 2.72 x 2.52 x .08
EXE1107555	110 x 75 x 55 4.33 x 2.95 x 2.17	.17 4	.57 15	.59 15	1.65 42	.24 6	4 #8	A11075P	Composite	99 x 64 x 2 3.90 x 2.52 x .08
EXE1607555	160 x 75 x 55 6.30 x 2.95 x 2.17	.17 4	.57 15	.59 15	1.65 42	.24 6	4 #8	A16075P	Composite	149 x 64 x 2 5.87 x 2.52 x .08
EXE1907555	190 x 75 x 55 7.48 x 2.95 x 2.17	.17 4	.57 15	.59 15	1.65 42	.23 6	4 #8	A19075P	Composite	179 x 64 x 2 7.05 x 2.52 x .08
EXE807575	80 x 75 x 75 3.15 x 2.95 x 2.95	.16 4	.56 14	.59 15	2.44 62	.23 6	4 #8	A8075P	Composite	69 x 64 x 2 2.72 x 2.52 x .08
EXE1107575	110 x 75 x 75 4.33 x 2.95 x 2.95	.16 4	.56 14	.59 15	2.44 62	.24 6	4 #8	A11075P	Composite	99 x 64 x 2 3.90 x 2.52 x .08
EXE1607575	160 x 75 x 75 6.30 x 2.95 x 2.95	.16 4	.56 14	.59 15	2.44 62	.24 6	4 #8	A16075P	Composite	149 x 64 x 2 5.87 x 2.52 x .08
EXE1907575	190 x 75 x 75 7.48 x 2.95 x 2.95	.16 4	.56 14	.59 15	2.44 62	.24 6	4 #8	A19075P	Composite	179 x 64 x 2 7.05 x 2.52 x .08
EXE12212090	122 x 120 x 90 4.80 x 4.72 x 3.54	.17 4	.75 19	.98 25	2.91 74	.32 8	6 1/4	A122120P	Plated Steel	108 x 107 x 1.5 4.25 x 4.21 x .06
EXE22012090	220 x 120 x 90 8.66 x 4.72 x 3.54	.17 4	.75 19	.98 25	2.95 75	.32 8	6 1/4	A220120P	Plated Steel	206 x 107 x 1.5 8.11 x 4.21 x .06
EXE16016090	160 x 160 x 90 6.30 x 6.30 x 3.54	.23 5.9	.79 20	.83 21	2.95 75	.39 10	6 1/4	A160160P	Plated Steel	143 x 144 x 1.5 5.63 x 5.70 x .06
EXE26016090	260 x 160 x 90 10.24 x 6.30 x 3.54	.23 5.9	.79 20	.83 21	2.95 75	.39 10	6 1/4	A260160P	Plated Steel	244 x 144 x 1.5 9.61 x 5.70 x .06
EXE36016090	360 x 160 x 90 14.17 x 6.30 x 3.54	.23 5.9	.79 20	.83 21	2.95 75	.39 10	6 1/4	A360160P	Plated Steel	344 x 144 x 1.5 13.54 x 5.70 x .06
EXE56016090	560 x 160 x 90 22.05 x 6.30 x 3.54	.21 5	.77 20	.83 21	2.95 75	.39 10	6 1/4	A560160P	Plated Steel	543 x 144 x 2.5 21.38 x 5.70 x .06
EXE255250120	255 x 250 x 120 10.04 x 9.84 x 4.72	.22 6	.79 20	.98 25	4.09 104	.39 10	6 1/4	A255250P	Plated Steel	240 x 233 x 1.5 9.45 x 9.17 x .06
EXE400250120	400 x 250 x 120 15.75 x 9.84 x 4.72	.22 6	.79 20	.98 25	4.09 104	.39 10	6 1/4	A400250P	Plated Steel	384 x 233 x 1.5 15.12 x 9.17 x .06
EXE400405120	400 x 405 x 120 15.75 x 15.94 x 4.72	.23 6	.79 20	.98 25	4.09 104	.39 10	6 1/4	A400405P	Plated Steel	385 x 390 x 1.5 15.16 x 15.35 x .06
EXE400405165	400 x 405 x 165 15.75 x 15.94 x 6.50	.20 5	.76 19	.98 25	5.87 149	.39 10	6 1/4	A400405P	Plated Steel	385 x 390 x 1.5 15.16 x 15.35 x .06

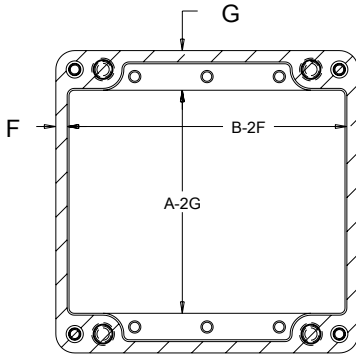

Z-Z

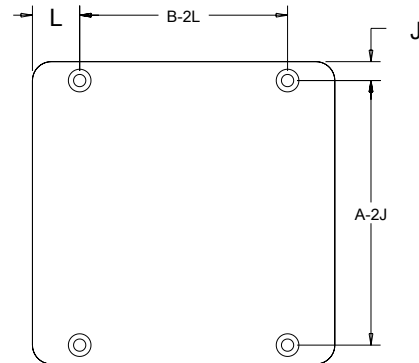
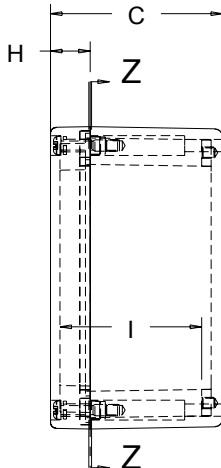
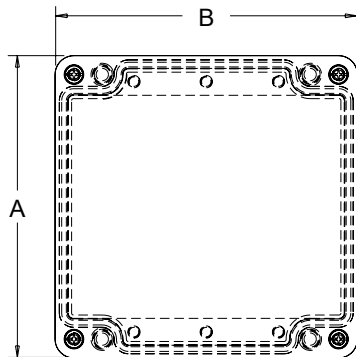

89103188

## X-ON Electronics

Largest Supplier of Electrical and Electronic Components

*Click to view similar products for [hoffman manufacturer](#):*

Other Similar products are found below :

[A-1412CHQR](#) [CSD201610](#) [CSD20168SS](#) [CSD20206](#) [CSD20208SS](#) [CSD24168](#) [CSD36248](#) [CSD36308](#) [PCU7](#) [PT126](#) [A1008CHNFSS](#)  
[A10106CH](#) [A10106CHFL](#) [A10106PHCW](#) [A1066JFGQRR](#) [A1210CHNF](#) [A1212SC](#) [A1412CHNFSS](#) [A161208LP](#) [A161410CH](#) [A16H12ALP](#)  
[A16P14](#) [A16P16G](#) [A18P16AL](#) [A20H16BLP](#) [A20P16](#) [A24H2408SSLP](#) [Q13138PCE](#) [A404CH](#) [A606CHNF](#) [A606NF](#) [A806SC](#) [A845JFGR](#)  
[A864CHQRFGW](#) [A90P36F1](#) [HJ1412HWPL2LG](#) [HJ1816HWPL2LG](#) [RHJ1210HWPL2LG](#) [AS125SS](#) [ASE10X10X4](#) [ASE12X12X4](#) [E1PBG](#)  
[E2PBG](#) [E3PB](#) [LED24V15](#) [LF230VD](#) [A10106PHC](#) [A10P8SS](#) [A1210CHEMC](#) [A1210CHFL](#)