

# EAO – Your Expert Partner for Human Machine Interfaces

## 82-6161.1000 - Pushbutton 22 mm stainless-steel

### 82-6161.1000 - Pushbutton 22 mm stainless-steel



Configuration number : 82-10-000241

#### Mounting

Mounting cut-out Ø 22 mm  
Design flush

#### Front

Front dimension Ø 25 mm  
Front shape round  
Front ring shape flush

#### Other Attributes

Weight 0.018 kg

#### Operating-/Indication part

Lens optics opaque  
Lens material Stainless steel  
Lens colour Stainless steel  
Lens profile raised, flat lens  
Lens illumination non-illuminative

#### IP-Rating

Front protection IP65, IP67, IK10

#### Connection Method

Terminal Solder/ plug-in 2.8 x 0.5 mm

#### Actuator

Switching action Momentary

#### Switching element

Switching current 5 A  
Contact material Silver  
Contacts 1 C  
Switching system Snap-action switching element  
Switching voltage 250 V AC  
Typical switch ratings 0.7A@24VDC, 0.5A@220VAC

#### Function

Pushbutton

# EAO – Your Expert Partner for Human Machine Interfaces

82-6161.1000 - Pushbutton 22 mm stainless-steel

## Dimensions

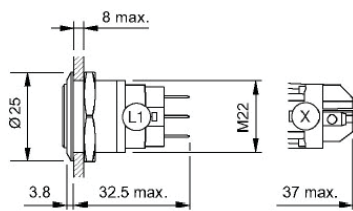

## Mounting cut-outs

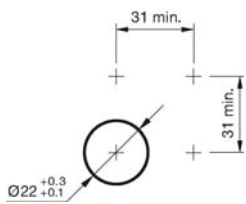

## Wiring diagram

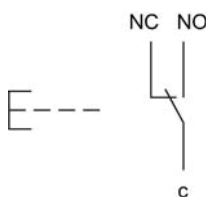

## Component layout

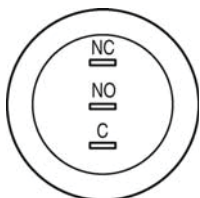

## Legend

Switching action: B = Momentary  
Contacts: C = Changeover

**Pushbutton**
**Switching system**

Snap-action changeover contact normally closed / normally open.  
Switching function momentary or maintain.

**Material**
**Housing**

Stainless-steel polished or brushed  
Brass nickel-plated or galvanically gold-plated

**Terminal housing**

Polyamide 66 (PA66)

**Contact material**

Silver alloy

**Mechanical characteristics**
**Mounting cut-out**

Ø19 mm +0.3/+0.1 mm

**Terminals**

Soldering terminals 2.8 x 0.5 mm

**Tightening torque**

5 Nm min. – 12 Nm max. for fixing nut

**Actuating force**

3 ... 6 N

**Actuating travel**

Pushbutton momentary 2.5 mm  
Pushbutton maintain 3 mm

**Mechanical lifetime**

Pushbutton momentary 1 Mio. cycles of operation  
Pushbutton maintain 500 000 cycles of operation

**Resistance to heat of soldering**

Hand-soldering 260 °C, 3 sek.

**Electrical characteristics**
**Rated Operational Voltage  $U_o$** 

250 VAC

**Rated Insulation Voltage  $U_i$** 

250 V

**Illumination**

LED red, green, blue, yellow, orange and white  
LED and series resistor with polarity protection are built in.

Voltage	Current
3.5 VDC	15 mA
6 VAC/DC	15 mA
12 VAC/DC	14 mA
24 VAC/DC	10 mA
110 VAC	2 mA
230 VAC	1.3 mA

**Contact resistance**

<50 mΩ

**Electrical life**

100 000 cycles of operation

**Switch rating IEC 60947-5-1**

Switch rating AC cosφ 0.3 service categorie AC-15

Voltage	Current
24 VAC	1 A
110 VAC	1 A
220 VAC	0.5 A

Switch rating DC service categorie DC-13

Voltage	Current
24 VDC	0.7 A
110 VDC	0.2 A
220 VDC	0.1 A

**Switch rating UL 508**

Switch rating AC cosφ 0.75 ... 0.8)

Voltage	Current
120 VAC	5 A
240 VAC	3 A

Switch rating DC

Voltage	Current
24 VDC	1 A

**Conventional free air thermal current  $I_{th}$** 

5 A

The maximum current in continuous operation and at ambient temperature must not exceed the quoted maximum values.

**Electrical strength**

2500 VAC, 50 Hz 1 min. between life terminals and ground  
1000 VAC, 50 Hz 1 min. between life terminals

**Isolation resistance**

500 VDC at min. 10 MΩ according to IEC 60512-2

**Environmental conditions**
**Storage temperature**

-40 °C ... +80 °C

**Operating temperature**

-30 °C ... +70 °C

**Front protection**

IP 65 and IP 67, as per IEC 60529

**Impact resistance**

IK 09, as per IEC 62262

**Shock resistance**

max. 500 m/s<sup>2</sup> according to IEC 60068-2-27

**Degree of pollution**

2, as per EN IEC 60947-1

## Pushbutton

### **Vibration resistance**

10 ... 55 Hz, amplitude 1.5 mm p-p according to IEC 60068-2-6

### **Climate resistance**

Damp heat, 21 days according to IEC 60512-11

Saline mist, 96 hours according to IEC 60512-11

### **Approvals**

#### **Approbations**

CB

UL

CCC

#### **Declaration of conformity**

CE

## X-ON Electronics

Largest Supplier of Electrical and Electronic Components

*Click to view similar products for [Pushbutton Switches](#) category:*

*Click to view products by [EAO](#) manufacturer:*

Other Similar products are found below :

[LW1L-M1C10V-A](#) [LW2L-A1C20M-GD](#) [LW2L-M1C20M-A](#) [60324L](#) [M7E-HRN2](#) [67021K512](#) [67081K512X](#) [701PB580](#) [719-5504-000](#)  
[MDPSSGLFS](#) [810KSV30B](#) [MML23KA3AC05K-001](#) [MML23KW3AA01W](#) [8418K2](#) [8646AB6X718UL](#) [8646ABUL](#) [FSDWH](#) [9001KXRK](#)  
[9001T8BK](#) [9533CD4+U574+U4922](#) [1203MRA](#) [A22EM01S](#) [A595](#) [1202A6](#) [12037A2ULCSA](#) [1203A2UL](#) [ABD122N-B](#) [1211390004](#)  
[ABN111-Y](#) [1211500044](#) [1211580012](#) [1212MRA](#) [1232A6NF](#) [RA3CSH6A](#) [1241.1183.7047](#) [1241.2511](#) [1241.3428](#) [1223A2ULCSA](#)  
[1223MRA](#) [1232AX2119](#) [1241.1183.8000](#) [1241.1183.8029](#) [1241.2506](#) [1241.2606](#) [12MA6](#) [1301940184](#) [RELBARF6X10\(PLASTIC\)](#)  
[13435AG](#) [13440AD2G25X822+U4546](#) [13445A4GX768](#)