

# CHAIN TERMINAL

## SRT series <Made in Belgium>

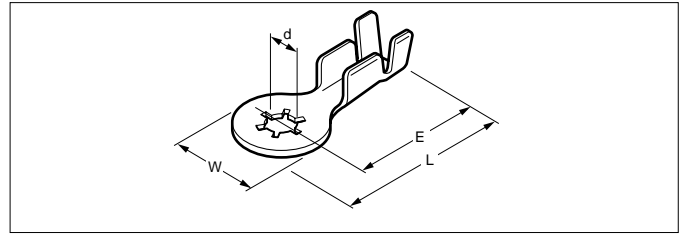

Model No.	Standard	Applicable wire			Material	Finish	Dimensions mm(in.)					Q'ty / reel
		mm <sup>2</sup>	AWG #	Insulation O.D. mm(in.)			W	L	E	d (dia.)	Material thickness	
SRT-1.0T-M5S		0.5 to 1.0	20 to 18	2.0 to 3.3(.079 to .130)	Steel	Tin-plated	9.5	21.75	17.0	5.3	0.6	4,000
SRT-2.5T-M5S		1.0 to 2.5	18 to 14	2.7 to 4.3(.106 to .169)			(.374)	(.856)	(.669)	(.209)	(.024)	

## SPC series (Splice) <Made in Belgium>

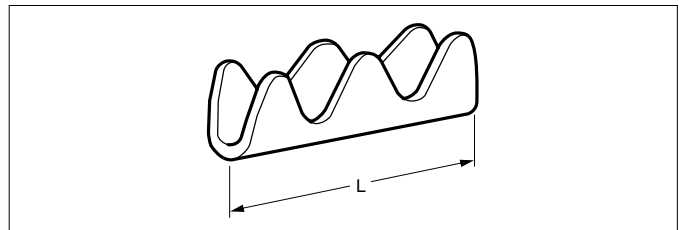

Model No.	Standard	Applicable wire		Material	Finish	Dimensions mm(in.)		Q'ty / reel
		mm <sup>2</sup>	AWG #			L	Material thickness	
SPC-1.0		0.5 to 1.0	20 to 18	Brass	—	6.0(.236)	0.25(.010)	30,000
SPC-1.0T					Tin-plated			
SPC-2.5	1.0 to 2.5	18 to 14	—		7.0(.276)			
SPC-2.5T			Tin-plated					

Note: The applicable wire size (total sectional area) above serves as a basic guideline. Before use, the performance of this connector must be tested with the wire that is to be used.

## Applicator for the semi-automatic press AP-K2N

Contact	Crimp applicator MK-L/MK-L-PC	
	with safety cover	without safety cover
SRT-1.0T/N-M5S	APLMK SRT1.0-M5	APLNC SRT1.0-M5
SRT-2.5T/N-M5S	APLMK SRT2.5-M5	APLNC SRT2.5-M5
SPC-1.0(T)	APLMK SPC1.0	APLNC SPC1.0
SPC-2.5(T)	APLMK SPC2.5	APLNC SPC2.5

## X-ON Electronics

Largest Supplier of Electrical and Electronic Components

*Click to view similar products for [jst manufacturer](#):*

Other Similar products are found below :

[B02B-JWPF-SK-R](#) [B3B-ZR](#) [B4B-ZR](#) [B5B-XH-A](#) [B5B-ZR](#) [B5PS-VH](#) [B6B-ZR-SM4-TF](#) [B6P-VH](#) [B7B-XH-A](#) [B8B-XH-A](#) [B8B-ZR](#) [B8P-VH](#) [BM02B-SRSS-TB](#) [BM06B-SRSS-TB](#) [BM10B-SRSS-TB](#) [B04P-NV](#) [B2B-PH-K-S](#) [B2B-ZR-SM4-TF](#) [B34B-PHDSS-B\(LF\)\(SN\)](#) [B3B-ZR-SM4-TF](#) [B5B-ZR-SM4-TF](#) [B6B-XH-A](#) [B6PS-VH](#) [B7B-ZR-SM4-TF](#) [B7PS-VH](#) [B8B-ZR-SM4-TF](#) [B8PS-VH](#) [BM04B-SRSS-TB](#) [BM05B-SRSS-TB](#) [IDH-KR-12](#) [WC-ZE2426](#) [WC-691](#) [B6PS-VH\(LF\)\(SN\)](#) [FNGS12-6](#) [TWE0.5-8](#) [WC-GVH2630](#) [WC-PUD2](#) [S10B-PH-SM4-TB\(LF\)\(SN\)](#) [B2B-EH-A-TW \(LF\)\(SN\)](#) [B4B-EH-A-TW \(LF\)\(SN\)](#) [B4B-XH-TW \(LF\)\(SN\)](#) [B6B-EH-A-TW \(LF\)\(SN\)](#) [B6P-VH-TW \(LF\)\(SN\)](#) [B8B-XH-TW \(LF\)\(SN\)](#) [B9B-XH-A](#) [BM02B-GHS-TBT](#) [BM03B-GHS-TBT](#) [BM04B-GHS-TBT](#) [BM06B-GHS-TBT](#) [BM08B-GHS-TBT](#)